

NOTE: Temporary Asphalt to be constructed by Vantage Homes. St. Charles County will replace asphalt with Concrete at the time that O'Fallon Rd is Reconstructed.

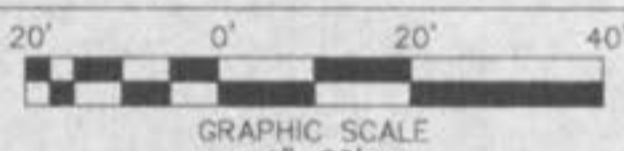
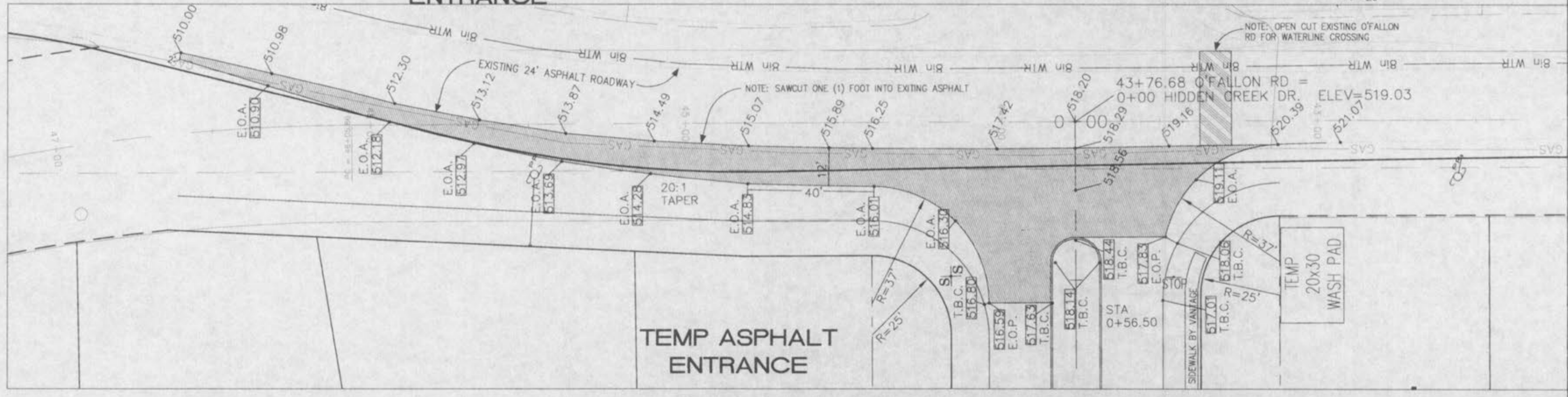
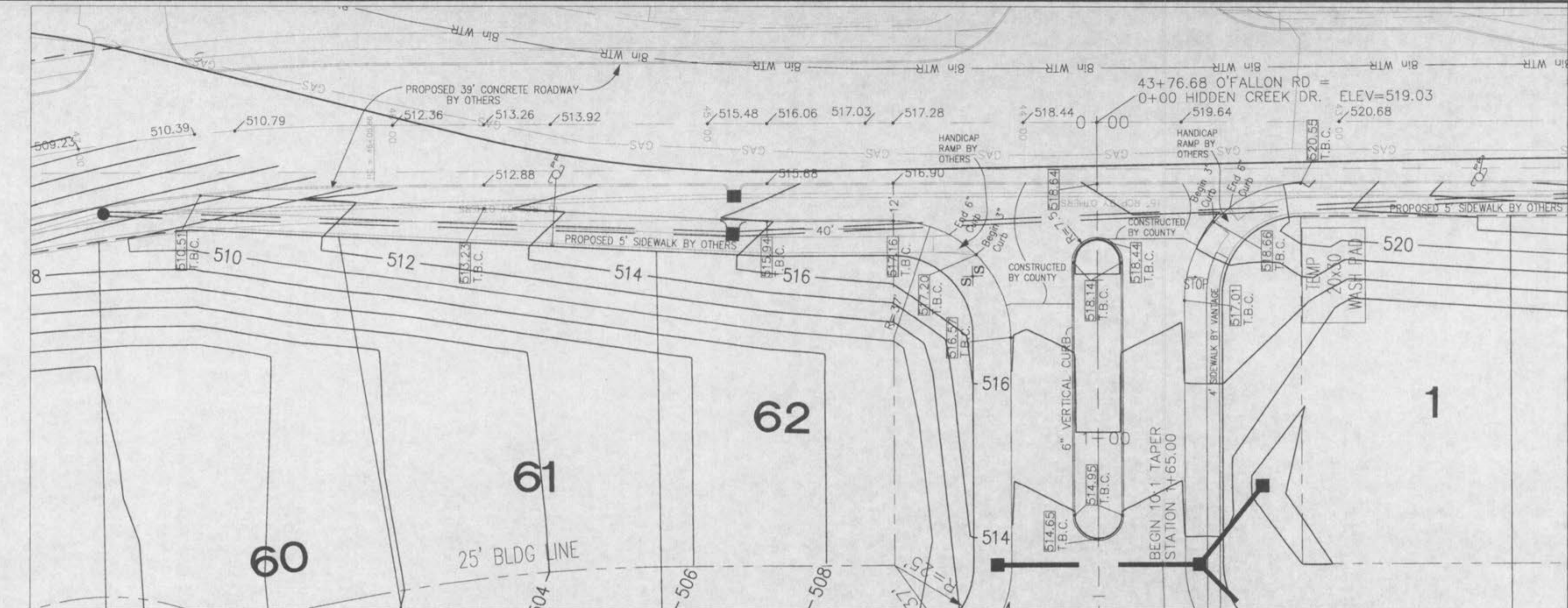
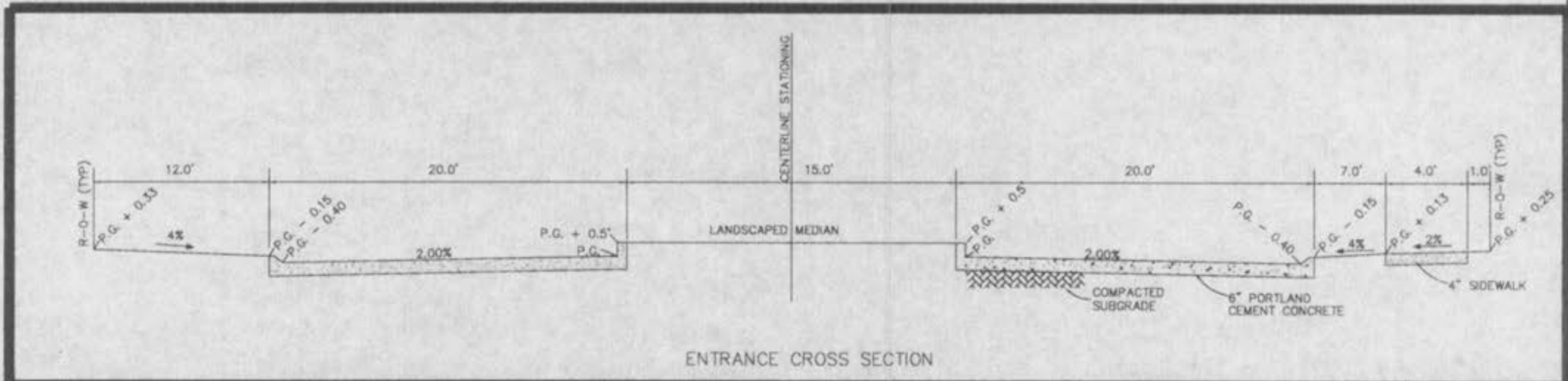
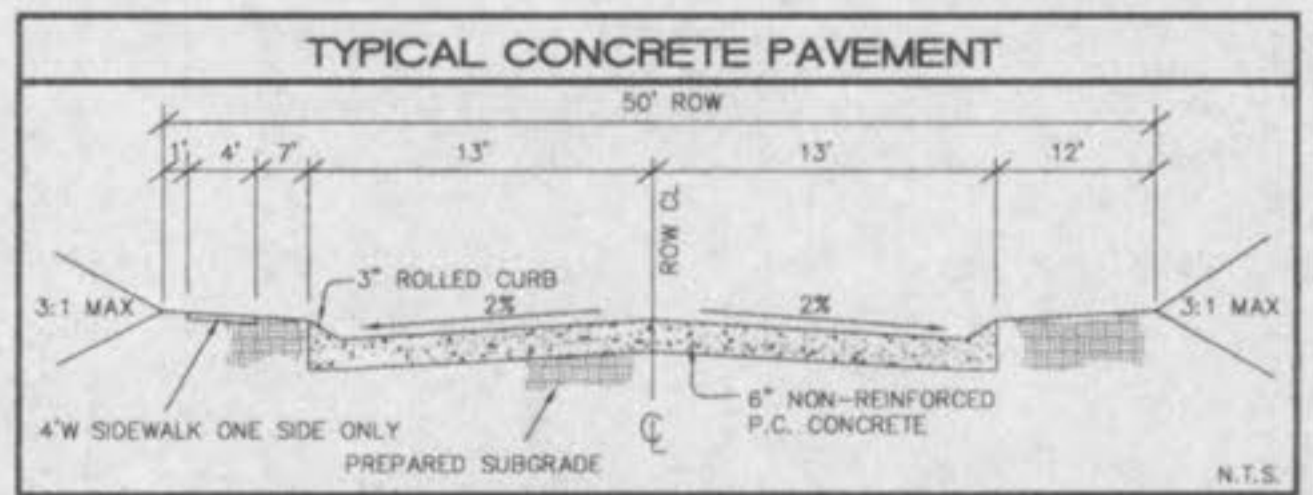
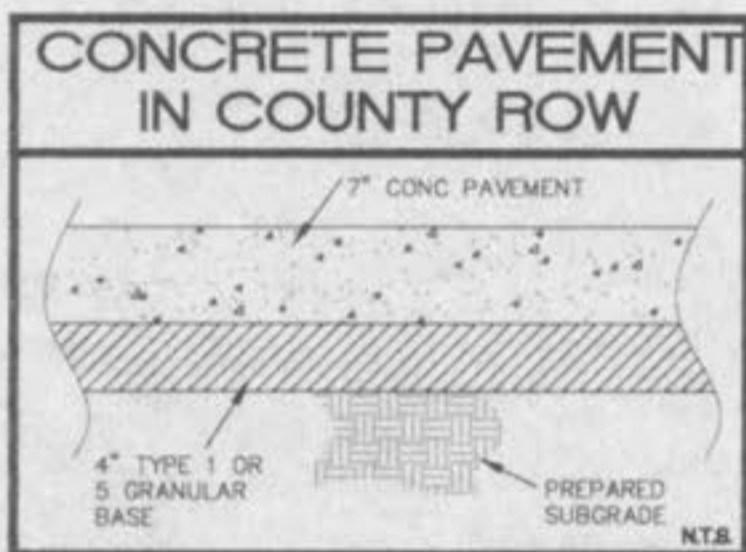
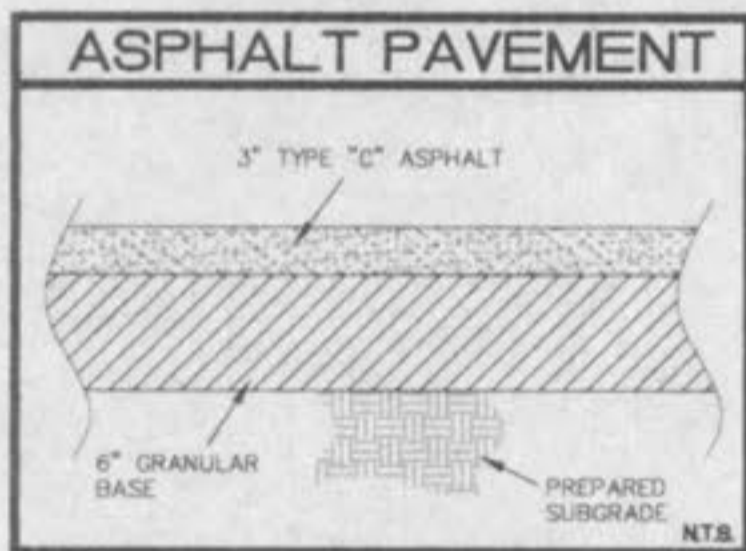

O'Fallon File Number 1002.02

ENTRANCE PLAN  
HIDDEN CREEK  
PHASE 1

ST. CHARLES ENGINEERING & SURVEYING, INC.  
801 S. FIFTH STREET, SUITE 202  
ST. CHARLES, MO 63301  
TEL: (636) 947-0607 FAX: (636) 947-2446

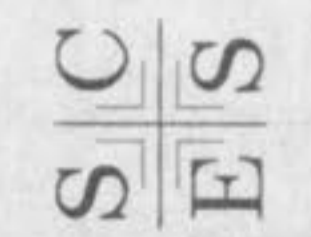

ORDER NO. 02-0162-01  
DATE 03/21/08  
7