

WOODED CREEK DRIVE

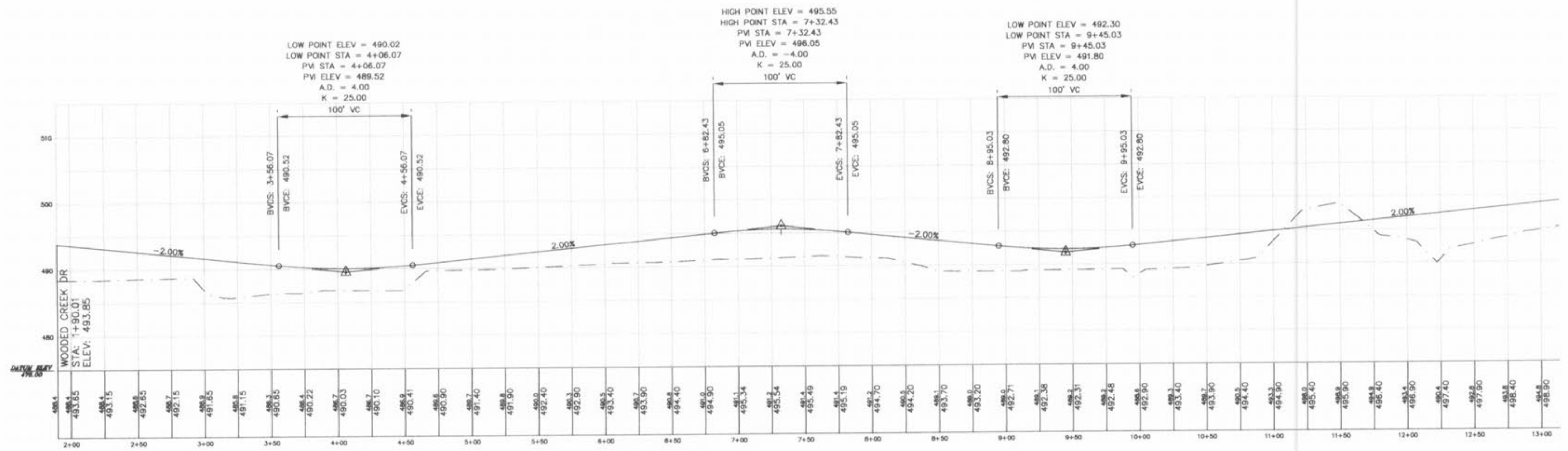

WOODED CREEK DRIVE

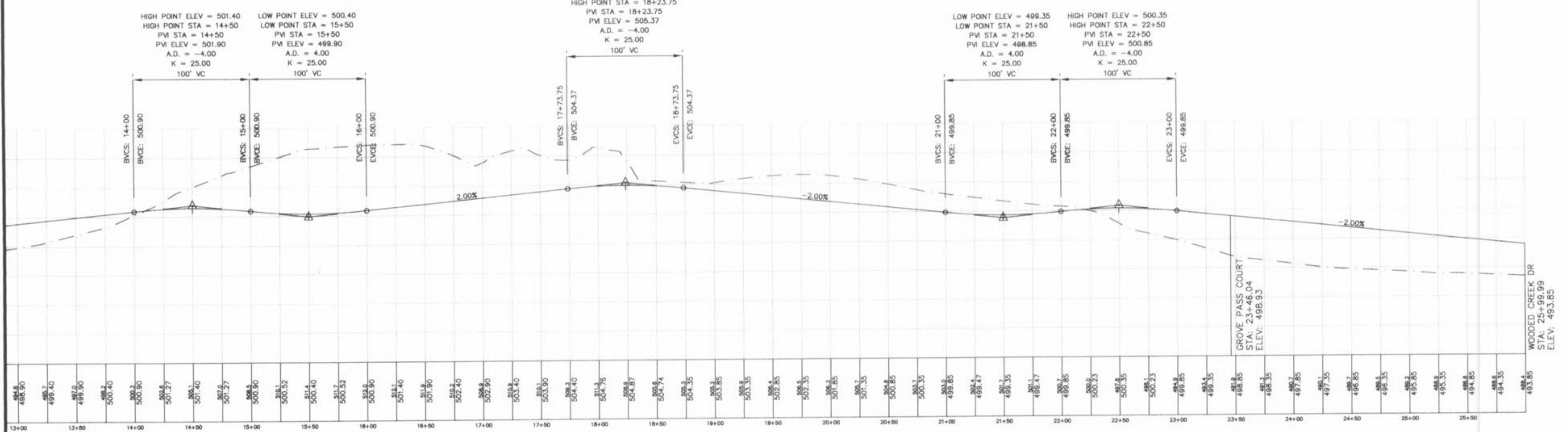

WOODED CREEK DRIVE

VERT.
 1" = 10'
 HORIZ.
 1" = 50'
 SCALE:

O'FALLON FILE
 NUMBER 1002.02

02/19/04 REVISED AS PER COMMENTS

**STREET PROFILES
 HIDDEN CREEK
 PHASE 2**

ST. CHARLES ENGINEERING & SURVEYING, INC.
 801 S. FIFTH STREET, SUITE 202
 ST. CHARLES, MO 63301
 TEL: (636) 947-0607 FAX: (636) 947-2448

SE

STATE OF MISSOURI
 PUBLIC AUTHORITY
 PROFESSIONAL ENGINEER
 NUMBER
 PE-200391-0035
 02/19/04

ORDER NO.
 02-0162

DATE
 12/16/03

PH2-6