

**HIGHGROVE PLACE  
(SOUTH PORTION)  
ENTRANCE DETAILS**

MAY, 1996 Job No. 95-067  
REVISED 7-10-96 CITY COMMENTS

P.S.D.E. = PERMANENT SIGHT DISTANCE EASEMENT

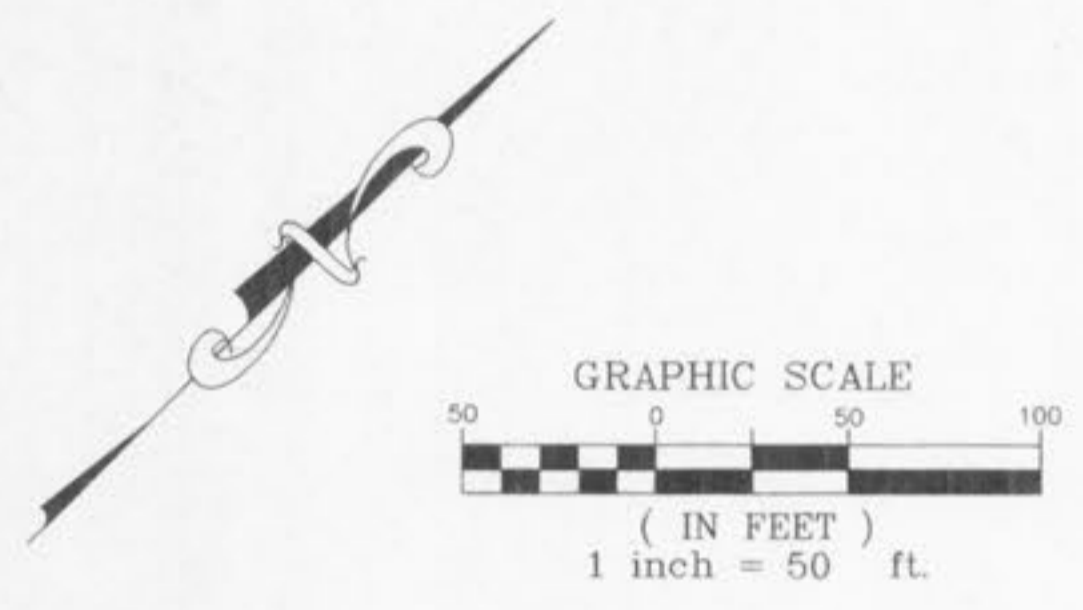
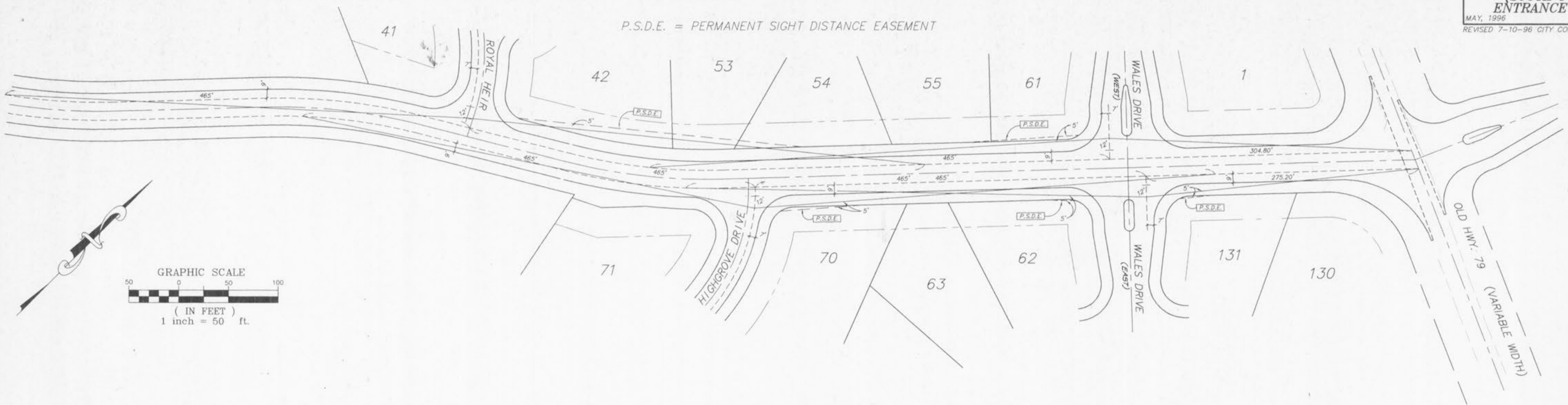

1/2" = 10' VERT.  
 1" = 50' HORIZ.

SCALES :  
 1" = 50' HORIZ.  
 1" = 10' VERT.

Height of Object (ft.)	10'	20'	30'	40'	50'	60'	70'	80'	90'	100'
10	112	143	167	187	205	221	236	250	263	275
20	224	286	334	374	409	441	470	497	522	545
30	336	429	491	541	586	627	665	699	730	758
40	448	581	662	722	772	813	851	885	916	944
50	560	723	814	884	944	995	1043	1087	1128	1166
60	672	875	986	1066	1126	1177	1225	1269	1310	1348
70	784	1027	1148	1238	1298	1349	1397	1441	1482	1520
80	896	1179	1310	1400	1460	1511	1559	1603	1644	1682
90	1008	1331	1472	1562	1622	1673	1721	1765	1806	1844
100	1120	1483	1634	1724	1784	1835	1883	1927	1968	2006

**GENERAL NOTES**

- Do not erect any fence or barrier.
- Sight triangles shall be placed at the intersection of any two streets.
- The existing roadway width shall be maintained as far as possible.
- Do not reduce the sight triangle to less than the minimum required.
- Do not reduce the sight triangle to less than the minimum required.
- Do not reduce the sight triangle to less than the minimum required.
- Do not reduce the sight triangle to less than the minimum required.
- Do not reduce the sight triangle to less than the minimum required.
- Do not reduce the sight triangle to less than the minimum required.
- Do not reduce the sight triangle to less than the minimum required.

**ST. LOUIS COUNTY  
DEPARTMENT OF TRANSPORTATION  
SIGHT DISTANCE AT INTERSECTIONS**

DATE: 08/11/96

