

SCALES :  
1" = 50' HORIZ.  
1" = 10' VERT.

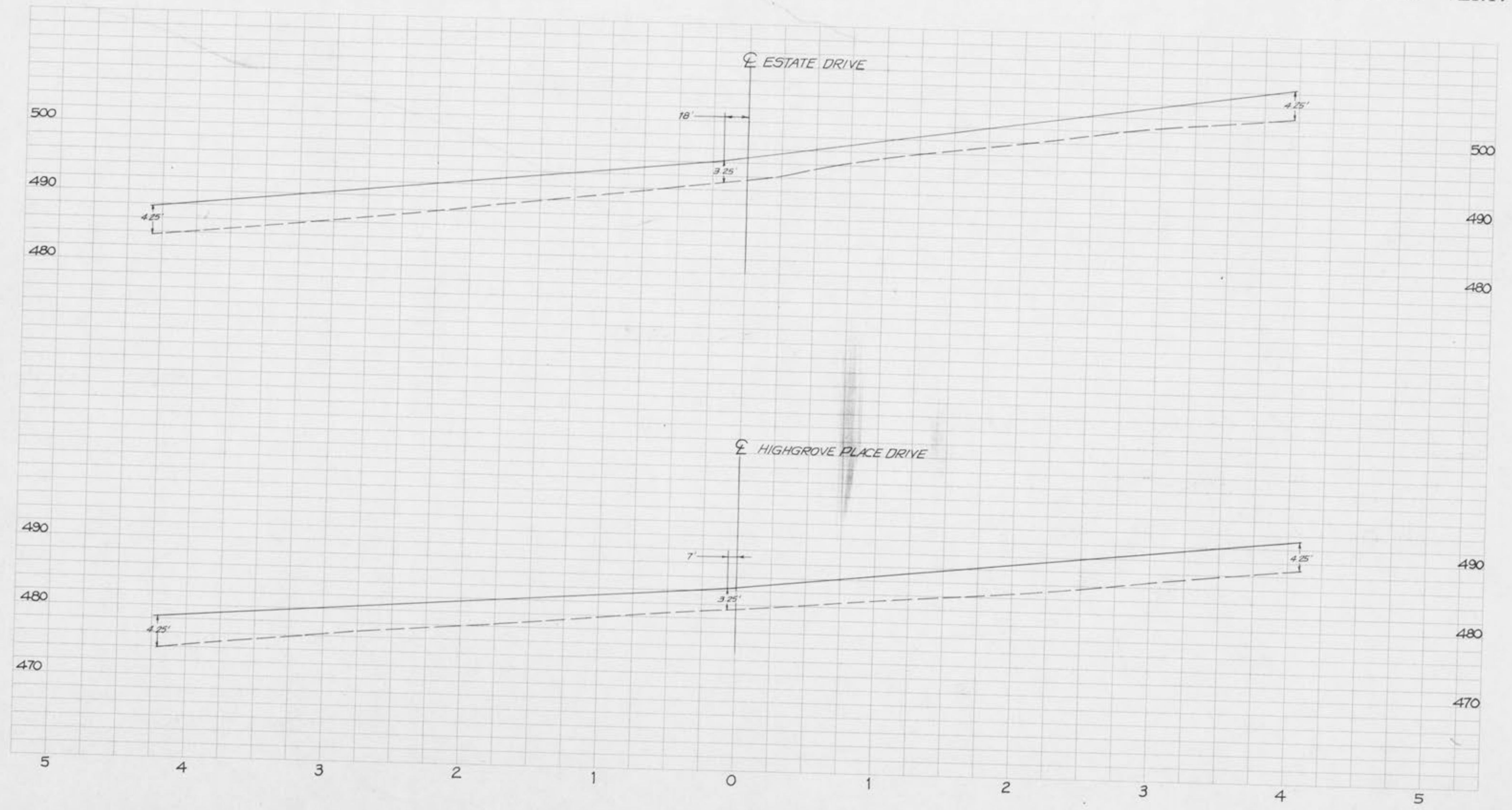

Height of Object (ft.)	Height of Observer (ft.)	Distance to Object (ft.)	Distance to Observer (ft.)	Total Distance (ft.)
10	5.5	100	100	200
15	5.5	150	150	300
20	5.5	200	200	400
25	5.5	250	250	500
30	5.5	300	300	600
35	5.5	350	350	700
40	5.5	400	400	800
45	5.5	450	450	900
50	5.5	500	500	1000
55	5.5	550	550	1100
60	5.5	600	600	1200
65	5.5	650	650	1300
70	5.5	700	700	1400
75	5.5	750	750	1500
80	5.5	800	800	1600
85	5.5	850	850	1700
90	5.5	900	900	1800
95	5.5	950	950	1900
100	5.5	1000	1000	2000

**GENERAL NOTES**

1. See all work including: Elevation, Dimensions, and Area.
2. Sight triangles shall be set out as shown on this plan and shall be maintained at all times.
3. The sight triangles shall be set out as shown on this plan and shall be maintained at all times.
4. The sight triangles shall be set out as shown on this plan and shall be maintained at all times.
5. The sight triangles shall be set out as shown on this plan and shall be maintained at all times.
6. The sight triangles shall be set out as shown on this plan and shall be maintained at all times.
7. The sight triangles shall be set out as shown on this plan and shall be maintained at all times.
8. The sight triangles shall be set out as shown on this plan and shall be maintained at all times.
9. The sight triangles shall be set out as shown on this plan and shall be maintained at all times.
10. The sight triangles shall be set out as shown on this plan and shall be maintained at all times.

**SIGHT DISTANCE AT INTERSECTIONS**

APPROVED: [Signature]

DATE: 08/11/96