

**HIGHGROVE PLACE
(NORTH PORTION)
SANITARY SEWER PROFILES**

MAY, 1996
REV. 6-13-96
0-14
14+94.76
T=489.0
REV. 8-20-96
CITY COMMENTS

FINAL SURVEY
DATE: 05/13/96
BY: [Redacted]
CHECKED: [Redacted]
APPROVED: [Redacted]

ORIGINAL SURVEY
DATE: 05/13/96
BY: [Redacted]
CHECKED: [Redacted]
APPROVED: [Redacted]

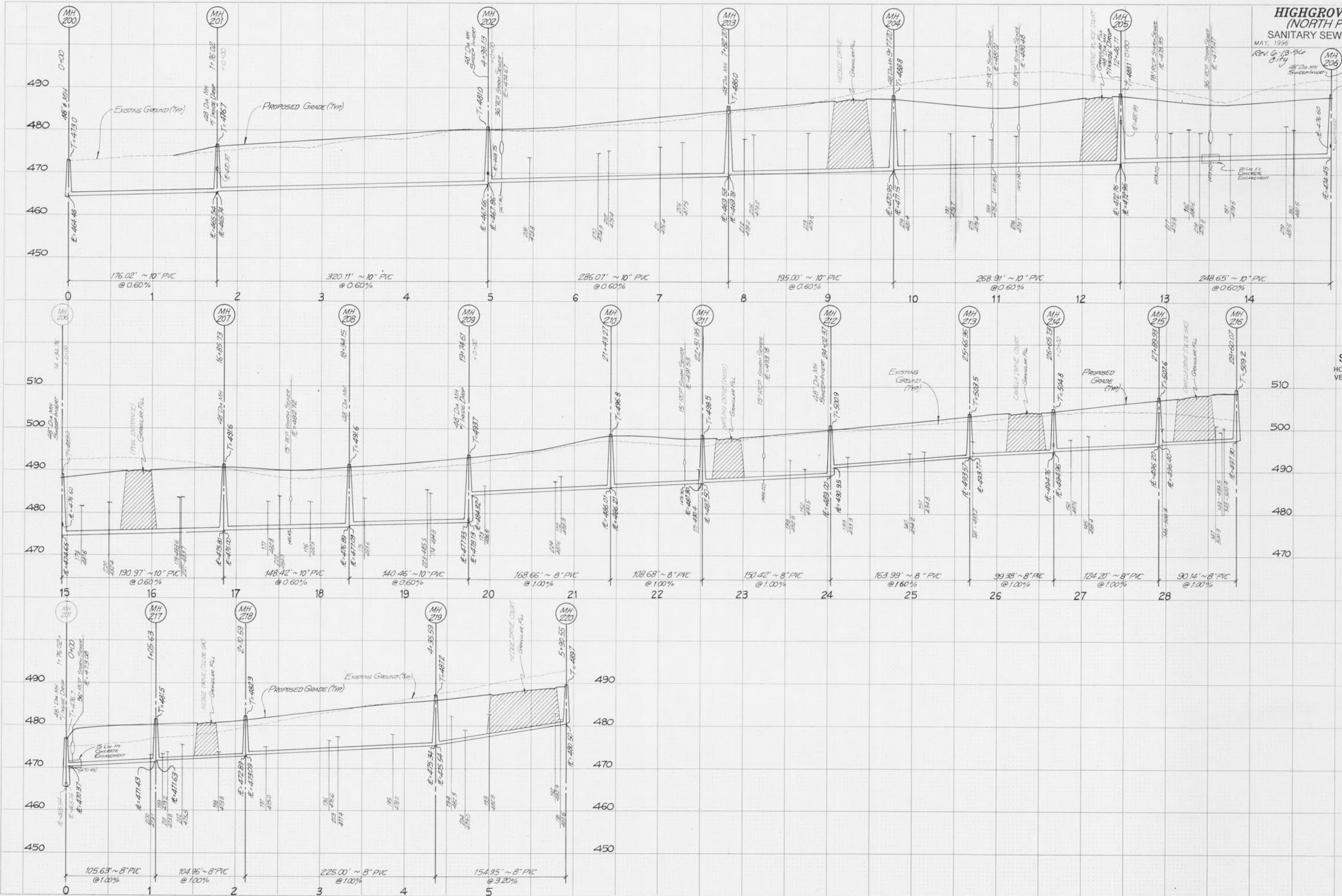

SCALE
HORIZ 1" = 50'
VERT 1" = 10'