

SEWER CONSTRUCTION NOTES:

- ALL STORM AND SANITARY SEWER CONSTRUCTION METHODS TO CONFORM TO LATEST STANDARDS AND SPECIFICATIONS OF THE APPLICABLE CODES AND SHALL CONFORM TO ALL APPROPRIATE CITY OF O'FALLON STANDARDS.
- ALL SANITARY SEWER STRUCTURES AND APPURTENANCES TO CONFORM TO THE STANDARD DETAILS AND CONSTRUCTION SPECIFICATIONS PER CITY OF O'FALLON.
- AFTER ALL SEWERS AND APPURTENANCES ARE COMPLETED, INSPECTED AND ACCEPTED, THE CONTRACTOR WILL BE PERMITTED TO CONNECT THE SEWER EXTENSION INTO THE EXISTING SYSTEM, IN THE PRESENCE OF AN INSPECTOR.
- DRAINAGE PIPE SHALL BE REINFORCED CONCRETE CLASS III (ASTM C76) EXCEPT AS NOTED ON PLANS. INSTALLATION SHALL CONFORM TO MSD 1992 "STANDARD CONSTRUCTION SPECIFICATIONS FOR SEWERS AND DRAINAGE FACILITIES."
- ALL PVC SANITARY SEWER PIPE SHALL CONFORM TO THE REQUIREMENTS OF ASTM D-3034 STANDARD SPECIFICATION FOR PSM POLYVINYL CHLORIDE SEWER PIPE, SDR-35 OR EQUAL, WITH "CLEAN" 1/2 INCH TO 1 INCH GRANULAR STONE BEDDING UNIFORMLY GRADED. THIS BEDDING SHALL EXTEND FROM 4 INCHES BELOW THE PIPE TO SPRINGLINE OF PIPE. IMMEDIATE BACKFILL OVER PIPE SHALL CONSIST OF SAME SIZE "CLEAN" OR "MINUS" STONE FROM SPRINGLINE OF PIPE TO 12 INCHES ABOVE THE TOP OF PIPE. ALL SEWER LATERALS TO BE 4" PVC. CLEAN-OUT TO BE PROVIDED WHEN LATERAL EXCEEDS 100' IN LENGTH.
- MANHOLE FRAMES AND COVERS SHALL BE STANDARD FRAMES AND COVERS AS APPROVED BY THE GOVERNING AUTHORITY.
- TRENCHES UNDER EXISTING PAVEMENT AND UNDER AREAS TO BE PAVED SHALL BE BACKFILLED WITH 3/4" MINUS CRUSHED LIMESTONE AND COMPACTED TO 90% OF THE MAXIMUM DRY DENSITY AS DETERMINED BY THE "MODIFIED AASHTO T-180 COMPACTION TEST" (ASTM D-1557).
- IN ALL AREAS WHERE SEWER AND APPURTENANCES ARE TO BE CONSTRUCTED IN FILLED GROUND, THE FILL WILL BE PLACED TO APPROXIMATE FINISH GRADE AND COMPACTED TO 90% OF MAXIMUM DRY DENSITY AS DETERMINED BY THE "MODIFIED AASHTO T-180 COMPACTION TEST" (ASTM D-1557), PRIOR TO THE EXCAVATING AND INSTALLING OF PIPE. (SEE NOTE 13)
- THE SEWER CONTRACTOR MAY CONSTRUCT THE BUILDING SEWER LATERALS IN CONJUNCTION WITH THE SANITARY MAIN, TRUNK OR LATERAL SEWERS, WITHIN THE DEVELOPMENT, PROVIDED THAT THE BUILDING SEWER LATERAL TERMINATES FIVE (5) FEET, OR MORE, OUTSIDE THE PROPOSED OR EXISTING BUILDING LINE OR FOUNDATION WALL.
- ALL MANHOLE AND INLET TOPS BUILT WITHOUT ELEVATIONS FURNISHED BY THE ENGINEER WILL BE THE RESPONSIBILITY OF THE SEWER CONTRACTOR. AT THE TIME OF CONSTRUCTION STAKE-OUT OF THE SEWER LINES, ALL CURB AND GRATE INLETS WILL BE FACE STAKED, PROVIDED SAID STAKES DO NOT FALL IN THE DITCH LINE. IF STAKES FALL WITHIN THE SEWER COMPANY OR JOB SUPERINTENDENT SHALL NOTIFY THE ENGINEER THAT STAKES ARE NEEDED AND ALLOW 48 HOURS FOR CUTS. TOPS OF MANHOLES, INLETS, VALVE BOXES, ETC., SHALL CONFORM TO FINISHED GRADE.
- ALL STANDARD STREET CURB INLETS TO HAVE FRONT OF INLET (2.25') BEHIND ROLLED CURB AND VERTICAL CURB. ALL AREA INLETS ARE OPENED 4 SIDES EXCEPT AS NOTED ON PLAN.
- ALL SANITARY BUILDING CONNECTIONS HAVE BEEN DESIGNED SO THAT THE MINIMUM VERTICAL DISTANCE FROM THE LOW POINT OF THE BASEMENT FLOOR TO THE FLOW LINE OF A SANITARY SEWER AT THE CORRESPONDING BUILDING CONNECTION IS NOT LESS THAN THE DIAMETER OF THE PIPE PLUS A VERTICAL DISTANCE OF 2.50 FEET.
- ALL FILLED AREAS, INCLUDING TRENCH BACKFILLS, UNDER BUILDINGS, PROPOSED STORM AND SANITARY SEWERS LINES, AND/OR PAVED AREAS INCLUDING TRENCH BACKFILLS WITHIN AND OFF THE ROAD RIGHT-OF-WAY SHALL BE PLACED IN A MAXIMUM OF 9" LIFTS AND COMPACTED TO A MINIMUM OF 90% OF MAXIMUM DRY DENSITY AS DETERMINED BY THE "MODIFIED AASHTO T-180 COMPACTION TEST" (ASTM D-1557). TESTS SHALL BE TAKEN AT A MAXIMUM OF 50 FOOT INTERVALS ALONG THE ROUTE OF THE PIPE, AT A MAXIMUM OF TWO FOOT VERTICALLY, AND STARTING AT THE BOTTOM OF THE FILL AND CONTINUING THROUGH THE FILL TO THE TOP OF THE PIPE AT 5 FOOT INTERVALS AND LATERALLY ON EACH SIDE OF THE PIPE FOR A DISTANCE EQUAL TO THE DEPTH OF FILL FROM THE TOP OF PIPE TO VIRGIN SOIL. ALL TEST SHALL BE VERIFIED BY THE SOILS ENGINEER CONCURRENT WITH GRADING AND BACKFILLING OPERATIONS.
- WHEN P.V.C. PIPE IS USED, APPROPRIATE RUBBER SEAL WATERSTOP, AS APPROVED BY THE SEWER DISTRICT, SHALL BE INSTALLED BETWEEN P.V.C. PIPE AND MASONRY (CONCRETE & BRICK) STRUCTURE.
- IT IS THE CONTRACTOR'S RESPONSIBILITY TO CONFIRM THE LOCATION OF EXISTING UTILITIES AND/OR UNDERGROUND FACILITIES BY NOTIFYING UTILITY COMPANIES PRIOR TO CONSTRUCTION.
- GAS, WATER AND OTHER UNDERGROUND UTILITIES SHALL NOT CONFLICT WITH THE DEPTH OR HORIZONTAL LOCATION OF EXISTING AND PROPOSED SANITARY AND STORM SEWERS INCLUDING BUILDING LATERALS.
- ALL CONSTRUCTION METHODS AND MATERIALS USED SHALL CONFORM TO CURRENT APPLICABLE STANDARDS.
- SHOP DRAWINGS ARE REQUIRED FOR CONSTRUCTION OF NON-STANDARD REINFORCED CONCRETE STRUCTURES.
- THE CONTRACTOR SHALL PREVENT ALL STORM, SURFACE WATER, MUD AND CONSTRUCTION DEBRIS FROM ENTERING THE EXISTING SANITARY SEWER SYSTEM.
- THE CITY OF O'FALLON SEWER DISTRICT SHALL BE NOTIFIED AT LEAST 48 HOURS PRIOR TO CONSTRUCTION FOR COORDINATION OF INSPECTION.
- ALL SANITARY SEWER MANHOLES SHALL BE WATERPROOFED ON THE EXTERIOR IN ACCORDANCE WITH MISSOURI DEPARTMENT OF NATURAL RESOURCES SPECIFICATION 10 CSR-8.120(7)(E).
- ALL PIPES SHALL HAVE POSITIVE DRAINAGE THROUGH MANHOLES. NO FLAT INVERT STRUCTURES ARE ALLOWED.
- IF THE STORM AND SANITARY SEWERS ARE PARALLEL AND IN THE SAME TRENCH OR OVERDIG, THE UPPER PIPE SHALL BE PLACED ON A SHELF AND THE LOWER PIPE SHALL BE BEDDED IN COMPACTED GRANULAR FILL TO THE FLOW LINE OF THE UPPER PIPE.
- ALL SANITARY MANHOLES SHALL HAVE A 31 MIL THICK COAT OF COAL TAR PITCH WATERPROOFING.
- BRICK SHALL NOT BE USED ON SANITARY SEWER MANHOLES.
- EXISTING SANITARY SEWER SERVICE SHALL NOT BE INTERRUPTED.
- PRE-MANUFACTURED ADAPTERS SHALL BE USED AT ALL PVC TO DIP CONNECTIONS. RUBBER BOOT/MISSION-TYPE COUPLINGS WILL NOT BE ALLOWED.
- CONCRETE PIPE JOINTS SHALL BE MSD TYPE "A" APPROVED COMPRESSION-TYPE JOINTS AND SHALL CONFORM TO THE REQUIREMENTS OF THE SPECIFICATIONS FOR JOINTS FOR CIRCULAR CONCRETE SEWER AND CULVERT PIPE, USING FLEXIBLE, WATERTIGHT, RUBBER-TYPE GASKETS, ASTM C443. BAND-TYPE GASKETS DEPENDING ENTIRELY ON CEMENT FOR ADHESION AND RESISTANCE TO DISPLACEMENT DURING JOINTING SHALL NOT BE USED.
- ALL STORM AND SANITARY TRENCH BACKFILLS SHALL BE WATER JETTED.
- MANHOLE FRAME AND COVER SHALL BE CLAY AND BAILEY No. 2008 OR NEENAH R-1736 OR DEETER 1315 OR APPROVED EQUAL.
- A DROP OF 0.2 FEET IS REQUIRED THROUGH EACH SANITARY AND STORM MANHOLE AND INLET UNLESS OTHERWISE NOTED.
- ALL EXISTING WELLS SHALL BE FILLED AND SEPTIC TANKS REMOVED PER THE REQUIREMENTS OF D.N.R.

VILLAS AT HIGHGROVE

A TRACT OF LAND IN SECTION 17, TOWNSHIP 47 NORTH, RANGE 3 EAST, CITY OF O'FALLON, ST. CHARLES COUNTY MISSOURI

IMPROVEMENT PLANS PHASE TWO

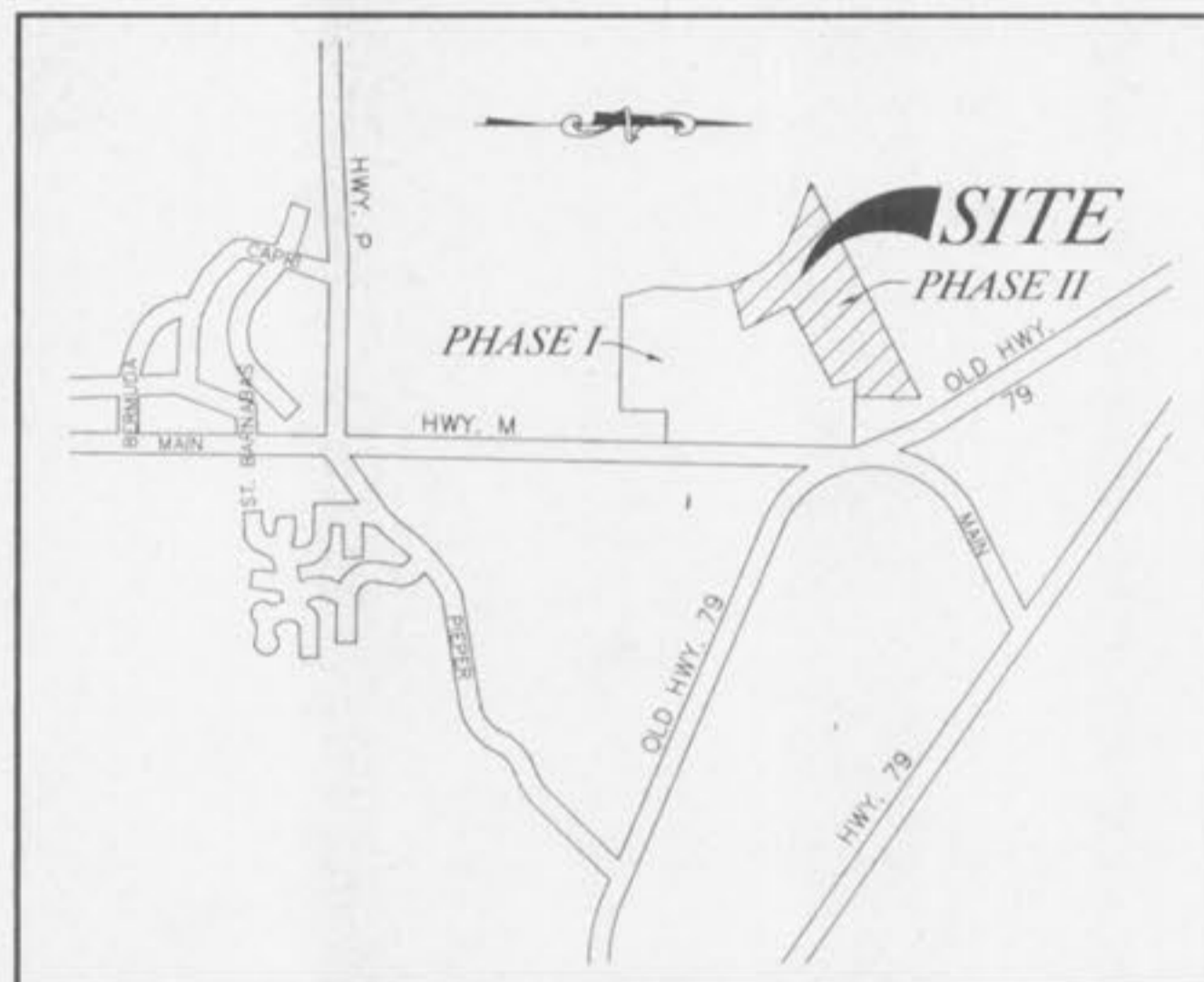

LOCATION MAP
N.T.S.

EXISTING	LEGEND	PROPOSED
(542)	CONTOURS	(542)
536	SPOT ELEVATIONS	(536)
---	CENTER LINE	---
---	BUILDINGS, ETC.	---
---	TREE LINE	---
---	FENCE	---
---	STORM SEWERS	---
---	SANITARY SEWERS	---
---	CURB INLET	---
---	AREA INLET	---
---	GRADED INLET	---
---	STORM MANHOLE	---
---	SANITARY MANHOLE	---
---	FLARED END SECTION	---
---	CLEANOUT	---
---	LATERAL CONNECTION	---
---	UTILITY OR POWER POLE	---
---	FIRE HYDRANT	---
---	TEST HOLE	---
---	PAVEMENT	---
---	GAS MAIN & SIZE	---
---	WATER MAIN & SIZE	---
---	TELEPHONE	---
---	ELECTRIC (U) UNDERGROUND	---
---	ELECTRIC (O) OVERHEAD	---
---	FLOW LINE	---
---	TO BE REMOVED	---
---	TOP OF CURB	---
---	SWALE	---
---	LIGHT STANDARD	---
---	STREET SIGN	---
---	TEST PIT	---
---	SILTATION CONTROL	---

○ DENOTES LOT ADDRESS

PROJECT ZIP CODE 63366

INDEX OF SHEETS

- 1 COVER SHEET
- 2-4 GRADING PLANS
- 5-7 SITE PLANS
- 8 STREET PROFILES
- 9 WARPING DETAILS
- 10 SANITARY SEWER PROFILES
- 11 STORM SEWER PROFILES & HYD.CALCS
- 12-14 DRAINAGE AREA MAP
- 15 DET. STRUC. DETAILS & DET. CALC.'S BASIN #3
- 16-18 WATER PLANS
- CD-1-CD-4 CONSTRUCTION DETAILS
- WD1 WATER SPECIFICATIONS

THIS SITE IS IN THE FOLLOWING UTILITY SERVICE AREAS:
CITY OF O'FALLON - ALLIANCE WATER AND SEWER CO.
LALEDE GAS COMPANY
AMEREN U.E. COMPANY
SOUTHWESTERN BELL TELEPHONE COMPANY

THESE PLANS HAVE BEEN REVIEWED BY BRUCKER EARTH ENGINEERING & TESTING, INC. FOR THEIR COMPLIANCE REGARDING GEOTECHNICAL RECOMMENDATIONS RELATIVE TO SITE DEVELOPMENT. BASED ON THIS REVIEW AND AVAILABLE SUBSURFACE INFORMATION, IT IS OUR OPINION THAT THE SITE MAY BE CONSTRUCTED IN ACCORDANCE WITH THW PLANS, GOOD CONSTRUCTION PRACTICES, AND THE RECOMMENDATIONS GIVEN IN THE GEOTECHNICAL REPORT OF AUGUST, 1998

WE HAVE NOT PREPARED ANY PART OF THESE PLANS AND MY SEAL ON THESE PLANS IS INTENDED ONLY TO CONFIRM MY PERSONAL REVIEW AND APPROVAL OF THE SITE GRADING PLAN AS IT RELATES TO THE STABILITY OF EARTH SLOPES.

BRUCKER EARTH ENGINEERING & TESTING, INC. MUST BE INVOLVED DURING THE CONSTRUCTION PHASE OF THIS PROJECT IN ORDER TO DETERMINE IF SUBSURFACE CONDITIONS ARE AS ANTICIPATED FROM THE FIELD EXPLORATION DATA, THAT OUR RECOMMENDATIONS RELATIVE TO SITE GRADING ARE IMPLEMENTED, AND THAT OTHER GEOTECHNICAL ASPECTS OF SITE DEVELOPMENT ARE PERFORMED IN ACCORDANCE WITH THESE PLANS.

BRUCKER EARTH ENGINEERING & TESTING, INC.

MARLENE D. MAAG, P.E.

GRADING NOTES:

- ALL FILL AREAS ARE TO BE COMPACTED TO A MINIMUM OF 90 PERCENT OF MAXIMUM DRY DENSITY AS DETERMINED BY THE MODIFIED AASHTO T-180 COMPACTION TEST, ASTM D1557-78, OR AS SPECIFIED BY THE SOILS ENGINEER.
- IT SHALL BE THE GRADING CONTRACTORS RESPONSIBILITY TO NOTIFY THE SOILS ENGINEER PRIOR TO WORK IN PROGRESS AND TO COMPLY WITH RECOMMENDATIONS BY THE SOILS ENGINEER WITH REGARDS TO COMPACTION, SURFACE PREPARATION AND PLACEMENT OF FILL.
- IT SHALL BE THE GRADING CONTRACTORS RESPONSIBILITY TO PROVIDE THE LOCATION OF ANY EXISTING UNDERGROUND UTILITIES BY NOTIFYING UTILITY COMPANIES PRIOR TO GRADING OPERATIONS.
- ALL GRADING ADJUSTMENTS SHALL BE SUBMITTED IN WRITING AND APPROVED BY THE CITY OF O'FALLON.
- THE GRADING CONTRACTOR SHALL CUT OR FILL TO SUBGRADE ELEVATION UNDER ALL AREAS TO BE PAVED. SUBGRADE DEPTH IS 0.50 FOOT BELOW PROPOSED FINISHED ELEVATIONS.
- ALL DRAINAGE SWALES SHALL BE SEED OR MULCHED TO PREVENT EROSION.
- ALL STUMPS, LIMBS, AND OTHER DEBRIS IS TO BE REMOVED FROM THE SITE UNLESS, AFTER CONSULTING WITH THE SOILS ENGINEER, THE OWNER APPROVES A DUMP AREA OR BURNING AREA. IF BURNING IS APPROVED, A PERMIT FROM THE LOCAL FIRE DEPARTMENT WILL BE REQUIRED.
- SUBGRADE IS INCLUDED IN THE TOTAL BID YARDAGE. (SUBGRADE IS FIGURED AT PAVEMENT DEPTH.)
- SLOPE TO RECEIVE FILL WHICH ARE STEEPER THAN 5:1 SHOULD BE BENCHED PRIOR TO PLACEMENT OF FILL.
- IF FILL IS TO BE PLACED IN AREAS OF SOFT SOIL, PARTICULARLY IN DRAWS, DRAINAGE CHANNELS AND OTHER LOW LYING AREAS, THE SOFT SOIL SHALL BE EXCAVATED UNTIL FIRM SOIL IS ENCOUNTERED.
- ALL EARTHEN FILLED PLACES WITHIN STATE, COUNTY, OR CITY ROADS (HIGHWAYS) SHALL BE COMPACTED TO 95% OF MAXIMUM DENSITY AS DETERMINED BY THE "STANDARD PROCTOR TEST AASHTO T-99" (ASTM D-698) UNLESS OTHERWISE SPECIFIED BY THE LOCAL GOVERNING AUTHORITY SPECIFICATIONS. THE SOILS ENGINEER WILL VERIFY ALL TESTS.
- NO EARTH SLOPE SHALL EXCEED 3:1 MAX.
- IT IS THE CONTRACTOR RESPONSIBILITY TO VERIFY ACTUAL ROCK DEPTH AND LOCATIONS. ANY ROCK SHOWN ON THESE PLANS ARE APPROXIMATE ONLY AND SHOWN FROM THE AVAILABLE SITE SOILS REPORT.

SILTATION NOTES:

- SILTATION CONTROLS WILL BE INSTALLED PRIOR TO ANY GRADING OR CONSTRUCTION OPERATIONS AND SHALL BE INSPECTED AND MAINTAINED AS NECESSARY TO INSURE THEIR PROPER FUNCTION UNTIL SUFFICIENT VEGETATION HAS BEEN ESTABLISHED TO PREVENT EROSION.
- THE INSTALLATION AND MAINTENANCE OF ALL SILTATION CONTROLS SHALL BE THE RESPONSIBILITY OF THE DEVELOPER.
- ADDITIONAL SILTATION CONTROLS MAY BE REQUIRED AS DIRECTED BY THE LOCAL GOVERNING AUTHORITY.
- EROSION CONTROL DEVICES SHALL PROTECT ALL GRADING AREAS FROM EROSION AND/OR SEEDING AND MULCHING AS REQUIRED BY THE CITY OF O'FALLON.
- WHEN UTILIZED TEMPORARY SILTATION POND (S) AND/OR OUTFALL STRUCTURE SHALL BE COMPLETELY REMOVED FOLLOWING RE-ESTABLISHMENT OF VEGETATION. POND (S) SHALL BE FILLED, COMPACTED AND LEVELED TO PROVIDE POSITIVE DRAINAGE (MIN. 2% SLOPE), AND THEN SEEDED AND MULCHED.
- AS NEEDED, SILTATION FENCE SHALL BE INSTALLED AS A PROTECTIVE BARRIER FOR TREES TO REMAIN.
- EACH CONTRACTOR, SUBCONTRACTOR, AND/OR UTILITY COMPANY SHALL BE RESPONSIBLE FOR THE MAINTENANCE AND PRESERVATION OF ANY SILTATION CONTROL PLACED ON THE DEVELOPMENT BY THE DEVELOPER AND SHALL NOT DISTURB THE SILTATION CONTROL EXCEPT AS ABSOLUTELY NECESSARY. IN THE EVENT OF ANY SUCH DISTURBANCE OF SILTATION CONTROL, THEN THE CONTRACTOR, SUBCONTRACTOR, OR UTILITY COMPANY, AS APPLICABLE, DISTURBING SUCH SILTATION CONTROL SHALL IMMEDIATELY REPLACE THE SAME AT SUCH CONTRACTOR'S, SUBCONTRACTOR'S, AND UTILITY COMPANY'S, AS APPLICABLE, EXPENSE. IN THE EVENT OF ANY FINES OR PENALTIES BEING LEVIED AS A RESULT OF THE DISTURBANCE OF ANY SUCH SILTATION CONTROL, THE PARTY DISTURBING SUCH SILTATION CONTROL SHALL BE LIABLE FOR PAYMENT OF SAME AND SHALL INDEMNIFY AND HOLD WHITTAKER CONSTRUCTION, INCORPORATED, HARMLESS FROM ANY AND ALL LIABILITIES, DAMAGES, DEMANDS, PENALTIES, FINES, FEES, CLAIMS, CAUSES OF ACTION, JUDGMENTS, COSTS AND EXPENSES, INCLUDING, WITHOUT LIMITATION, ATTORNEY'S FEES, ARISING FROM OR IN CONNECTION WITH ANY SUCH DISTURBANCE.
- THESE DEVELOPMENT PLANS ARE PRELIMINARY FIELD CONDITIONS AND THE JUDGMENT OF THE GENERAL CONTRACTOR WILL CAUSE CHANGES FROM THE DEVELOPMENT PLANS, INCLUDING, WITHOUT LIMITATION, GRADES, TERRACES, SLOPES, ELEVATIONS, PLACEMENT OF SEWER LINES, MANHOLES AND INLETS. THE GRADE OF EACH LOT WILL CHANGE FROM THESE PLANS WHEN THE HOME IS PLACED ON THE LOT. YOU MAY NOT RELY UPON THESE PLANS AS BEING FINAL BECAUSE CHANGES WILL OCCUR. IF YOU HAVE QUESTIONS REGARDING THE PLANS, CONTACT THE GENERAL CONTRACTOR IN CHARGE OF DEVELOPMENT OF THE SUBDIVISION.

GENERAL NOTES:

- ALL CONSTRUCTION METHODS, MATERIALS AND PRACTICES SHALL CONFORM TO ALL CURRENT APPLICABLE SPECIFICATIONS OF THE GOVERNING AGENCIES.
 - ANY DESTRUCTION OF EXISTING IMPROVEMENTS OR FEATURES SHALL BE REPAIRED OR REPLACED IN KIND BY THE CONTRACTOR AND SHALL REMAIN THE CONTRACTORS RESPONSIBILITY.
 - UNDERGROUND UTILITIES HAVE BEEN PLOTTED FROM AVAILABLE INFORMATION AND THEREFORE THEIR LOCATIONS MUST BE CONSIDERED APPROXIMATE ONLY. THE VERIFICATION OF THE LOCATION OF ALL UNDERGROUND UTILITIES, EITHER SHOWN OR NOT SHOWN ON THESE PLANS SHALL BE THE RESPONSIBILITY OF THE CONTRACTOR, AND SHALL BE LOCATED PRIOR TO GRADING OR CONSTRUCTION OF IMPROVEMENTS.
 - IT SHALL BE DISTINCTLY UNDERSTOOD THAT FAILURE TO MENTION SPECIALLY ANY WORK, WHICH WOULD NORMALLY BE REQUIRED TO COMPLETE THE PROJECT, SHALL NOT RELIEVE THE CONTRACTOR OF HIS RESPONSIBILITY TO PERFORM SUCH WORK.
 - CONTRACTOR SHALL KEEP ALL STREETS CLEAN OF MUD AND DEBRIS.
 - NO AREAS SHALL BE CLEARED WITH OUT THE PERMISSION OF THE DEVELOPER.
 - ALL EXISTING IMPROVEMENTS TO BE DEMOLISHED WILL BE TRANSPORTED AND DISPOSED OF OFFSITE IN AN AUTHORIZED LANDFILL.
 - THE GRADING AND ELEVATIONS SHOWN ON THE GRADING PLANS ARE FOR CONSTRUCTION PURPOSES ONLY. FINISHED GRADES, SWALES, AND SLOPES WILL VARY FROM THOSE SHOWN ON THE PLANS DEPENDING UPON THE LOCATION, SIZE, AND TYPE OF HOUSE BUILT ON THE LOT. HOWEVER, CARE SHOULD BE TAKEN TO ENSURE THAT FINISHED GRADING CONFORMS TO DRAINAGE AREA MAPS.
 - TREES REQUIRED TO BE REPLACED PER "TREE PRESERVATION ORDINANCE" LANDSCAPING PLAN FOR ESTATES AT HIGHGROVE: (PHASE I AND PHASE II)
- EXISTING TREES: 11.9 ACRES
SAVED TREES: 4.63 ACRES
TOTAL REMOVED: 7.27 ACRES
TOTAL REPLACED: 7.27 X 15 = 109 TREES
TOTAL SAVED: 4.63 X 30 = 139 TREES
STREET TREES: 367 TREES
TREES REQUIRED: 367 + 109 = 476 TREES
TOTAL CREDITED: 367 - 139 = 228 + 109 = 337 TREES
TOTAL TREES REQUIRED: 337 TREES
* LANDSCAPING SHOWN ON THE SITE PLAN FOR THE RECREATION AREA IS REQUIRED IN ADDITION TO THE ABOVE AMOUNT OF TREES.

PROJECT BENCHMARK:

Elev. 478.33 "I" - Chisled square located on the southeast corner of abutment on bridge crossing Prequet Creek on Hwy. "P", 1600ft. west of Hwy. "M".

NO. 15,259
GEORGE J. GOWER, Vice-President
M.D. Reg. E.S. #2336

THE UNDERGROUND UTILITIES SHOWN HEREON WERE PLOTTED FROM AVAILABLE INFORMATION AND DO NOT NECESSARILY REFLECT THE ACTUAL EXISTENCE, NONEXISTENCE, SIZE, TYPE, NUMBER OR LOCATION OF THESE OR OTHER UTILITIES. THE GENERAL CONTRACTOR SHALL BE RESPONSIBLE FOR VERIFYING THE ACTUAL LOCATION OF ALL UNDERGROUND UTILITIES, SHOWN OR NOT SHOWN, AND SAID UTILITIES SHALL BE LOCATED IN THE FIELD PRIOR TO ANY GRADING, EXCAVATION OR CONSTRUCTION OF IMPROVEMENTS. THESE PROVISIONS SHALL IN NO WAY ABSOLVE ANY PARTY FROM COMPLYING WITH THE UNDERGROUND FACILITY SAFETY AND DAMAGE PREVENTION ACT, CHAPTER 319, RSMo.

APPROVED

As Noted
8-3-99
C. J. Gower

REMARKS/DATE
1. Original Issue 05/28/99
2. PER CITY COMMENTS REISSUED 07/02/99

PREPARED FOR:
J.M.B. MILL CREEK L.L.C.
5091 NEW BAUMGARTNER ROAD
ST. LOUIS, MISSOURI 63129
PHONE: (314) 487-8717

PREPARED BY:
the STERLING ENGINEERS, SURVEYORS AND PLANNERS CO.
6055 NEW BAUMGARTNER ROAD
ST. LOUIS, MISSOURI 63129
(314)-487-0440, FAX 487-8844

DRAWN: S.K.
DESIGNED: S.G.H.
CHECKED: S.G.H.

PROJECT: VILLAS AT HIGHGROVE PHASE TWO
SHEET TITLE: COVER SHEET

NO. 98 02 036
M.S.D. SHEET
P# 1
DIGITAL FILE LOCATION: \\SERVER-STERLING-1\DRAWING\PROJECTS\98-02-036
DATE PLOTTED: 07/02/99