

USER: d:\p04\Tab_C7.1 8.35cm
 DRAWING: S:\ARBS\Arb2003\05-340\LDL_05-340.dwg \HWY_N\MODOT PLANS_11-15-06\Current\01_PLAN_C7.1_STRIPING-SCANNING.dwg

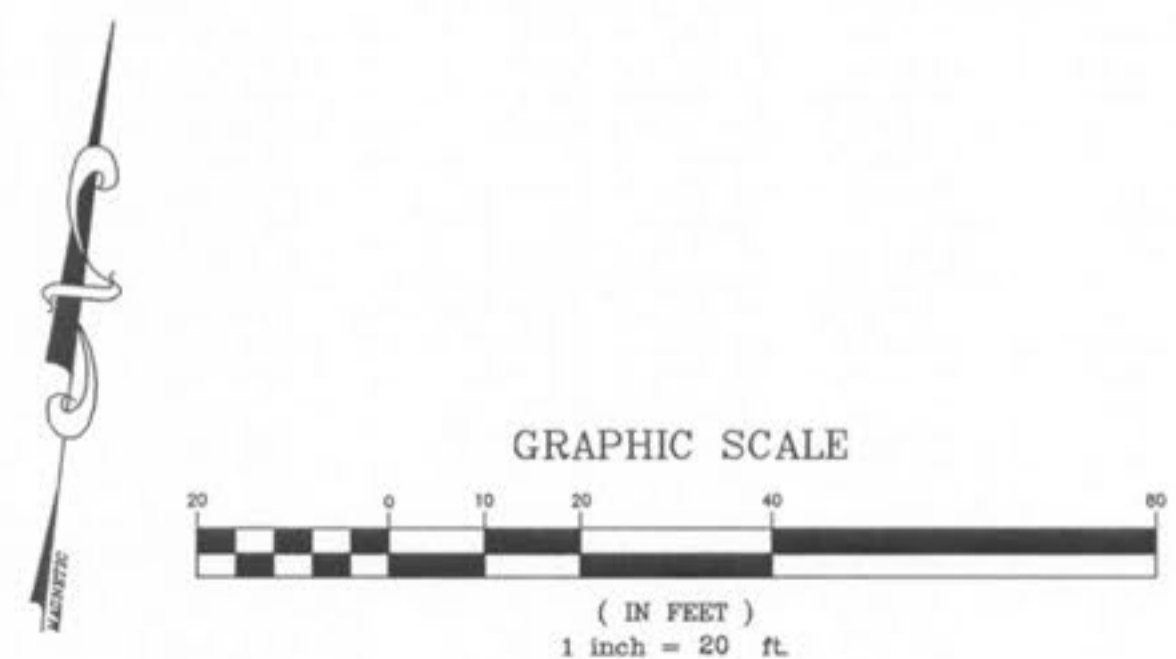
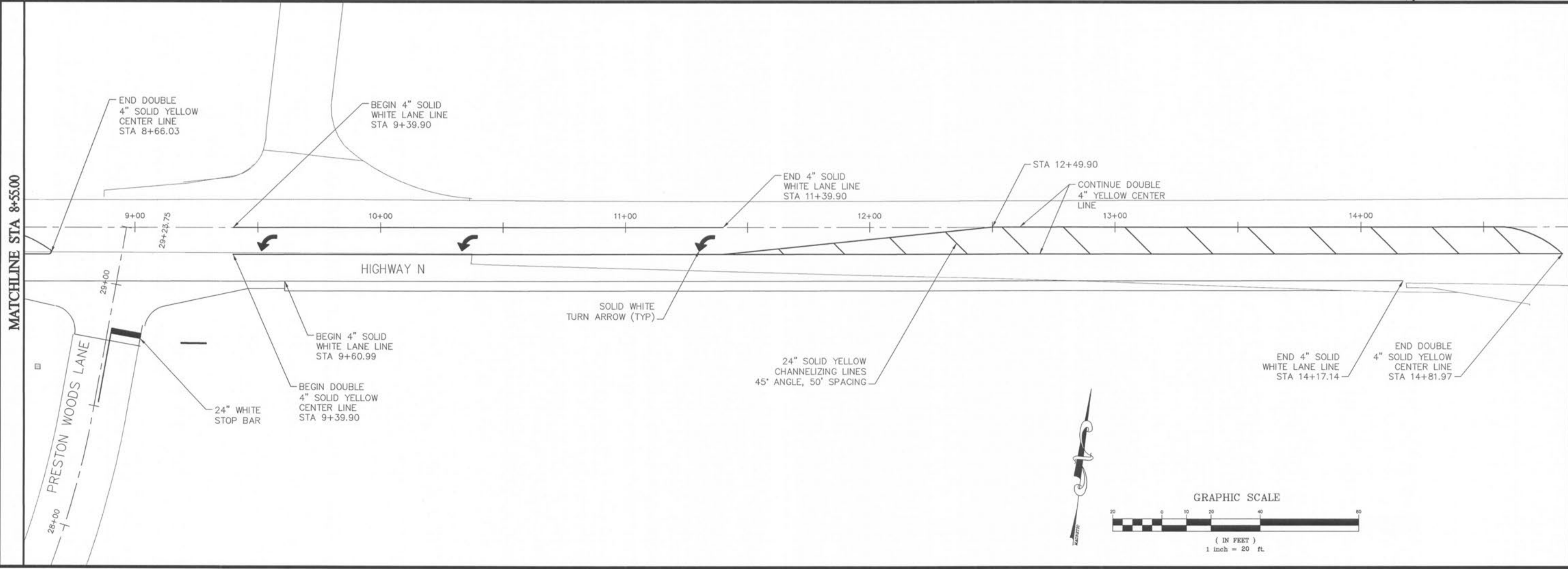
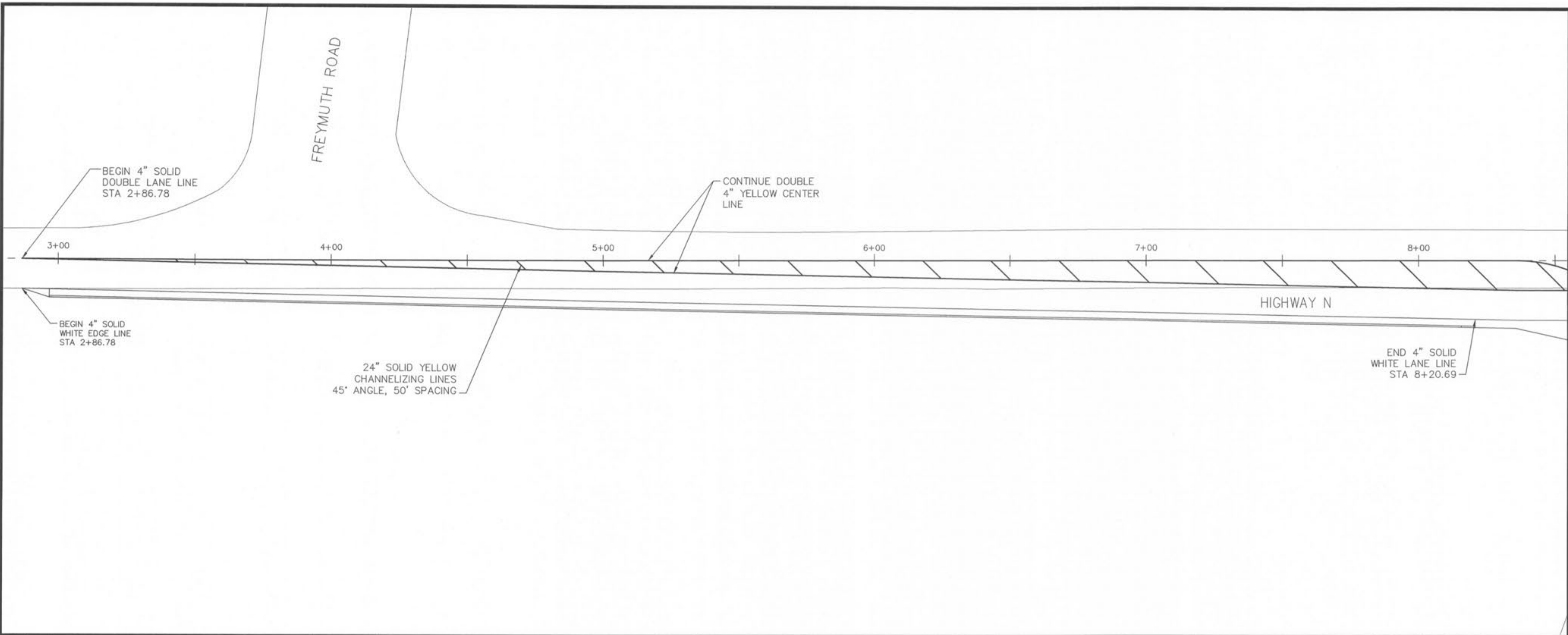

MATCHLINE STA 8+55.00

MATCHLINE STA 8+55.00

REVISIONS DATE: 12/1/06 BY: A DESCRIPTION: MODOT COMMENTS DATE: 2/19/07 BY: A DESCRIPTION: MODOT COMMENTS	
DEVELOPER/OWNER: THE JONES COMPANY HOMES, L.L.C. 16640 CHESTERFIELD GROVE, SUITE 160 CHESTERFIELD, MO 63005 PHONE: (636) 537-7192	
THE PROFESSIONAL ENGINEER'S SEAL AND SIGNATURE ARE NECESSARY TO VALIDATE THIS DESIGN. ANY CHANGES TO THIS DESIGN SHALL BE MADE BY THE PROFESSIONAL ENGINEER. THE PROFESSIONAL ENGINEER'S SEAL AND SIGNATURE ARE NECESSARY TO VALIDATE THIS DESIGN. ANY CHANGES TO THIS DESIGN SHALL BE MADE BY THE PROFESSIONAL ENGINEER.	
HIGHWAY N IMPROVEMENT PLANS O'FALLON, MO. 63366 STRIPING SHEET	
planning • engineering • surveying • landscape architecture Cole and Associates Incorporated 10777 sunset office dr. suite 10 saint louis, missouri 63127 p: 314 984 9887 f: 314 984 0587	
DESIGNED BY: JW DRAWN BY: KK CHECKED BY: JFH DATE: 9/22/06	
Job Number 05-340 Sheet Number C7.1	