

REVISIONS:

LIGHT FIXTURE SCHEDULE - SITE LIGHTING				
FIXTURE TYPE	MANUFACTURER	CATALOG NUMBER	DESCRIPTION	LAMP NUMBER / DESCRIPTION
AUE	GE	P17M	POST-MOUNTED LIGHT FIXTURE WITH 14'-0" HIGH POLE. FIXTURE PROVIDED AND MAINTAINED BY AMEREN UE.	ONE (1) 100 WATT METAL HALIDE
B1	PRESCOLITE	IBK28ICAT	12-RATED, 8" ROUND APERTURE, RECESSED OPEN DOWNLIGHT. VERTICAL LAMP POSITION. ELECTRONIC BALLAST. UL-LISTED FOR DIRECT CONTACT WITH INSULATION. FURNISH WITH #1L64 WHITE ALBRITE FLUSH GLASS LENSED TRIM. UL-LISTED WET LOCATION.	ONE (1) 26 WATT TRIPLE TUBE FLUORESCENT
R	KIM	OFL SERIES SM18	FLOODLIGHT, WIDE FLOOD DISTRIBUTION. ONE PIECE DIE-CAST ALUMINUM HOUSING. DIE-CAST ALUMINUM LENS FRAME WITH CLEAR TEMPERED GLASS LENS AND ONE PIECE STAMPED SILICONE GASKET. DIE-CAST ALUMINUM SWIVEL WITH INTEGRAL LOCKING TEETH AND LOCKOUT. SPECULAR ALZAK REFLECTOR. HIGH POWER FACTOR BALLAST RATED FOR -20°F STARTING. POWDER COAT FINISH AS DIRECTED BY ARCHITECT. UL LISTED WET LOCATION. CAST ALUMINUM STANCHION MOUNT WITH INTERNAL SET SCREW. CAST IN CONCRETE PER MANUFACTURER'S RECOMMENDATIONS. FINISH SAME AS FIXTURE HOUSING.	ONE (1) 70 WATT CERAMIC METAL HALIDE
S	SPAULDING	FRESNO FN1 SERIES	6.75" SQUARE, 42" HIGH LIGHT BOLLARD. EXTRUDED ALUMINUM RISER WITH FLAT TOP. SEALED, ONE-PIECE ACRYLIC LENS. INTEGRAL COLD START, HWP BALLAST. HEAVY CAST ALUMINUM ANCHOR BASE - REFER TO DETAIL ON SITE PLAN FOR ADDITIONAL BASE WORK. DARK BRONZE FINISH.	ONE (1) 70 WATT METAL HALIDE
T	SAVOY HOUSE	5-3803	DECORATIVE, WALL-MOUNTED LIGHT FIXTURE. 12" WIDE x 38.5" HIGH COMPOSITE HOUSING WITH TUSCAN GLASS LENS. ENERGY STAR CERTIFIED. WALNUT PATINA FINISH.	ONE (1) 18 WATT FLUORESCENT
T1	SAVOY HOUSE	5-3801	DECORATIVE, WALL-MOUNTED LIGHT FIXTURE. 8" WIDE x 21" HIGH COMPOSITE HOUSING WITH TUSCAN GLASS LENS. ENERGY STAR CERTIFIED. WALNUT PATINA FINISH.	ONE (1) 13 WATT FLUORESCENT
U	WILLIAMS	MH75	7.5" ROUND APERTURE RECESSED LENSED DOWNLIGHT. SELF-FLANGED, SEM-SPECULAR LOW IRIDESCENT FINISH ALUMINUM REFLECTOR. CLEAR TEMPERED GLASS LENS. UL-LISTED WET LOCATION UNDER COVERED CEILING.	ONE (1) 100 WATT ED17 CERAMIC METAL HALIDE

PHOTOMETRIC PLAN NOTES

- NUMBERS INDICATE FOOTCANDLE LEVELS AT GRADE.
- CALCULATIONS PERFORMED USING VISUAL 2.05.
- THERE SHALL BE NO DIRECT ILLUMINATION OF RESIDENTIAL PROPERTIES ADJACENT TO THIS PROPERTY OR ACROSS PUBLIC RIGHT-OF-WAY.

DISCLAIMER

LAYOUT AND DESIGN FOR TYPE "AUE" FIXTURES PROVIDED BY AMEREN UE. PKMR ENGINEERS ARE ONLY PROVIDING PHOTOMETRIC CALCULATIONS FOR SAME TO MEET CITY REQUIREMENTS FOR A PHOTOMETRIC PLAN, AND DO NOT TAKE ANY RESPONSIBILITY FOR THE PORTION OF THE PARKING LOT LIGHTING DESIGN ASSOCIATED WITH THESE FIXTURES.

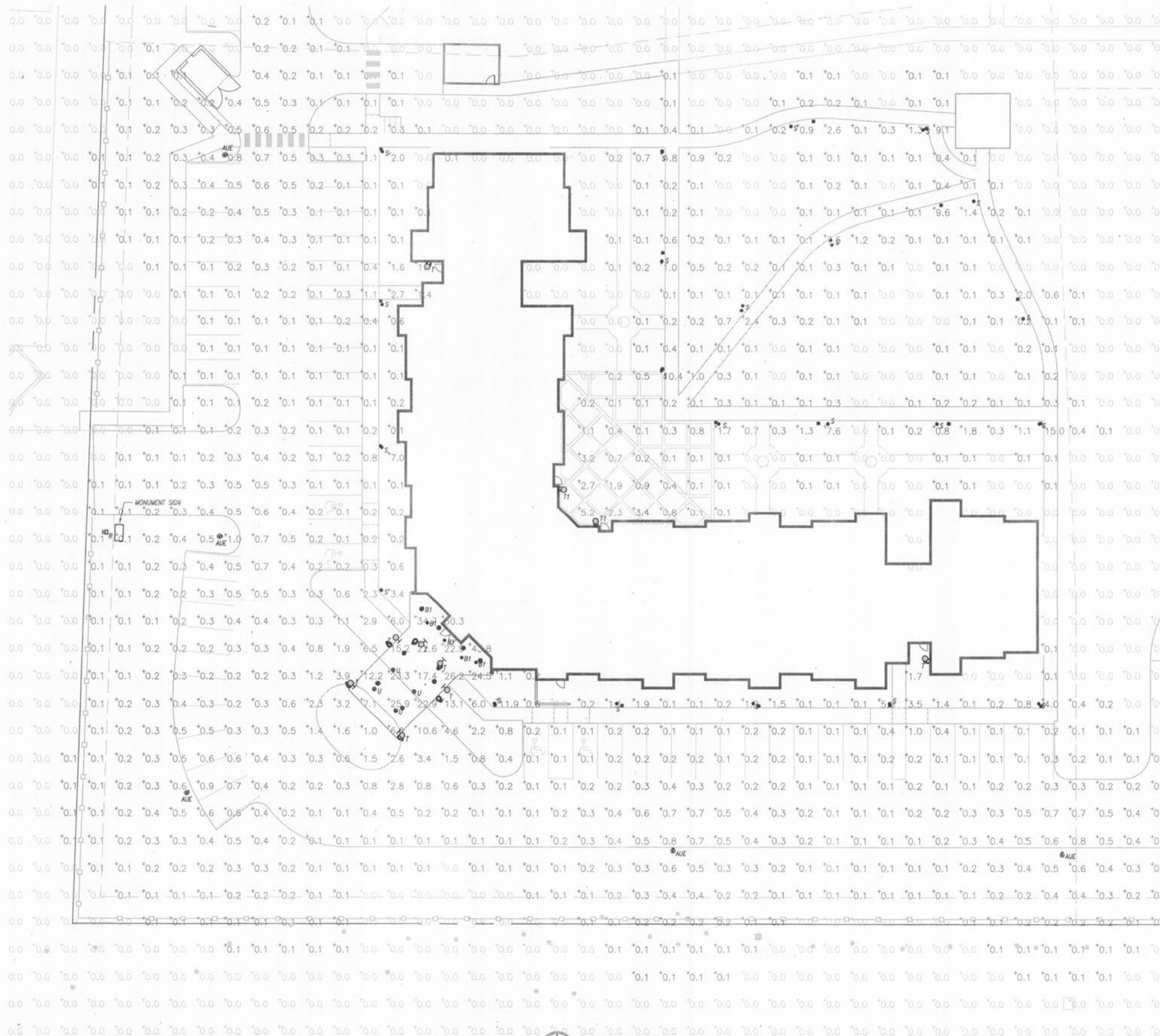

SITE PLAN
1" = 20'-0"



ROEMANN & ASSOCIATES, P.C.
architecture
interior design
engineering
planning

1526 Grand Boulevard
Kansas City, MO 64108-1404
p: 816.472.1448
f: 816.472.4702
e: design@roemann.com
w: www.roemann.com
© 2010 Roemann & Associates, P.C.
Kansas City, MO • St. Louis, MO



HILLMANN PLACE
Southwest Corner Of Governor's Run
Court & Mexico Road
O'Fallon, MO
MHDC NUMBER: 10-923

SHEET TITLE
ELECTRICAL
PHOTOMETRIC PLAN

PROJECT NUMBER: 10014
FILENAME: -

SHEET NUMBER

E-001

DRAWN BY: CHECKED BY:

