



Engineering Surveys and Services
 Consulting Engineers, Scientists and Land Surveyors
 Analytical and Material Laboratories
 1113 Fox Street, Columbia, Missouri 65201
 573-449-2646 | www.es-svc.com

Other Offices:
 Jefferson City, Missouri - Sedalia, Missouri
 Missouri Engineering Corporation # 204060018

HILLMANN PLACE - PHASE II
 OF FALLON, ST. CHARLES COUNTY, MISSOURI



MATTHEW A. KRIETE
 PROFESSIONAL ENGINEER
 PE-2007002811

THIS DOCUMENT WAS INTENDED TO BE DIGITALLY SIGNED. IF SIGNATURE AND VALIDATION ARE NOT PRESENT THIS MEDIA SHOULD NOT BE CONSIDERED A CERTIFIED DOCUMENT.

Date
MARCH 25, 2016

Revised
 ② MAY 12, 2016
 ③ JULY 26, 2016

Design: RMJ Drawn: MJS

UTILITY PLAN

Sheet

C6.01

ES&S PROJECT NO. 13189

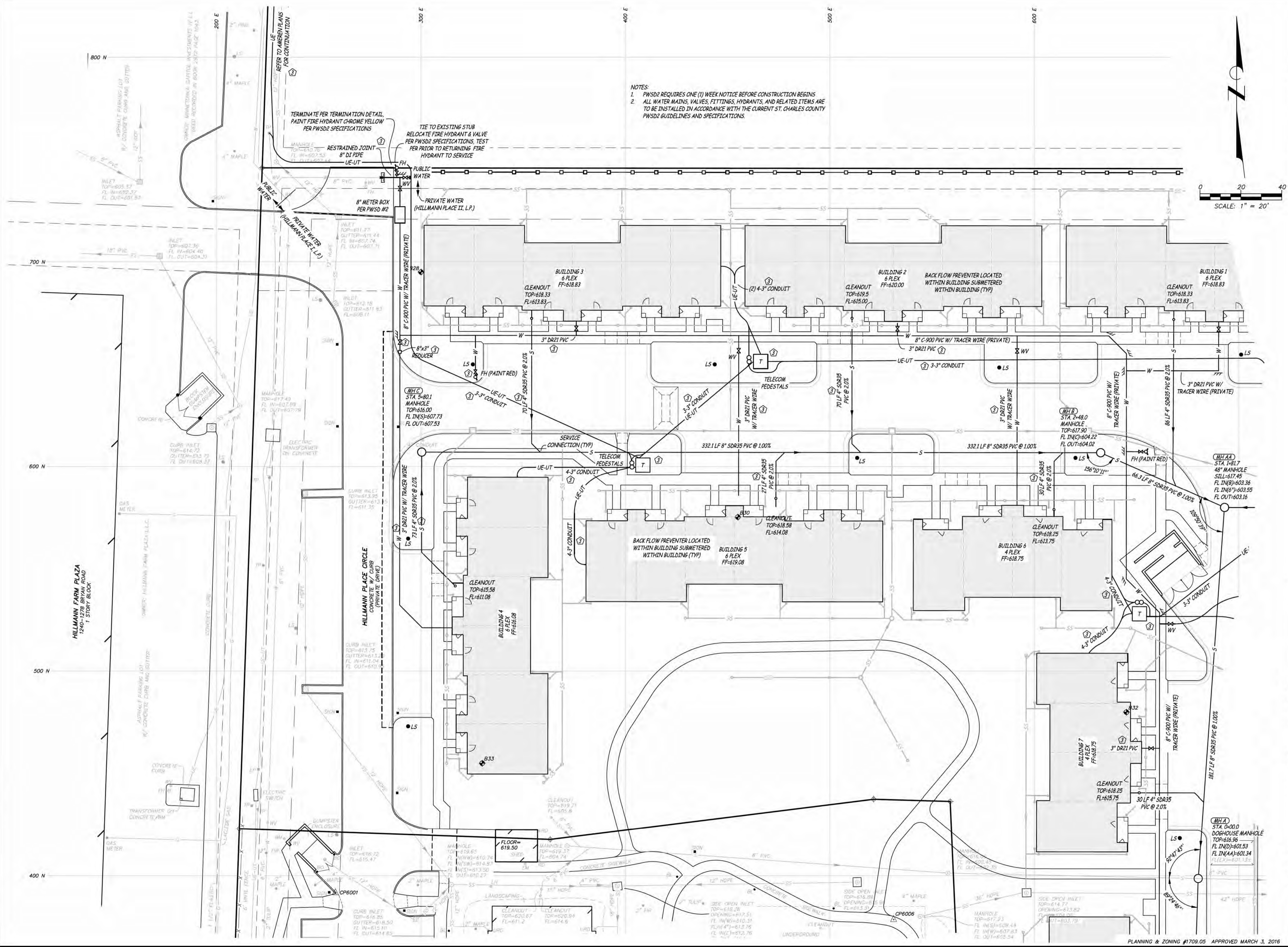

- NOTES:
1. PWS#2 REQUIRES ONE (1) WEEK NOTICE BEFORE CONSTRUCTION BEGINS
 2. ALL WATER MAINS, VALVES, FITTINGS, HYDRANTS, AND RELATED ITEMS ARE TO BE INSTALLED IN ACCORDANCE WITH THE CURRENT ST. CHARLES COUNTY PWS#2 GUIDELINES AND SPECIFICATIONS.

