

**LEGEND**

	EXISTING	PROPOSED
MANHOLE	○	○
CLEAN OUT	○	○
DOWN SPOUT	⊕	⊕
PARKING STOP	—	—
WATERLINE	— W —	— W —
UNDERGROUND GAS LINE	— G —	— G —
UNDERGROUND ELECTRIC	— UGE —	— UGE —
FORCE MAIN	— FM —	— FM —
STORM MAIN	— STM —	— STM —
SPOT ELEVATIONS	+	+
AREA INLET	■	■
STORM DRAIN	—	—
CONTOURS	— 556 —	— (556) —
CLEANOUT	•	•
SUBDRAIN	— SD —	— SD —
USE IN PLACE	(UIP)	(UIP)
TO BE REMOVED & REPLACED	(TBR&R)	(TBR&R)

**CHURCH STREET (40'W.)**

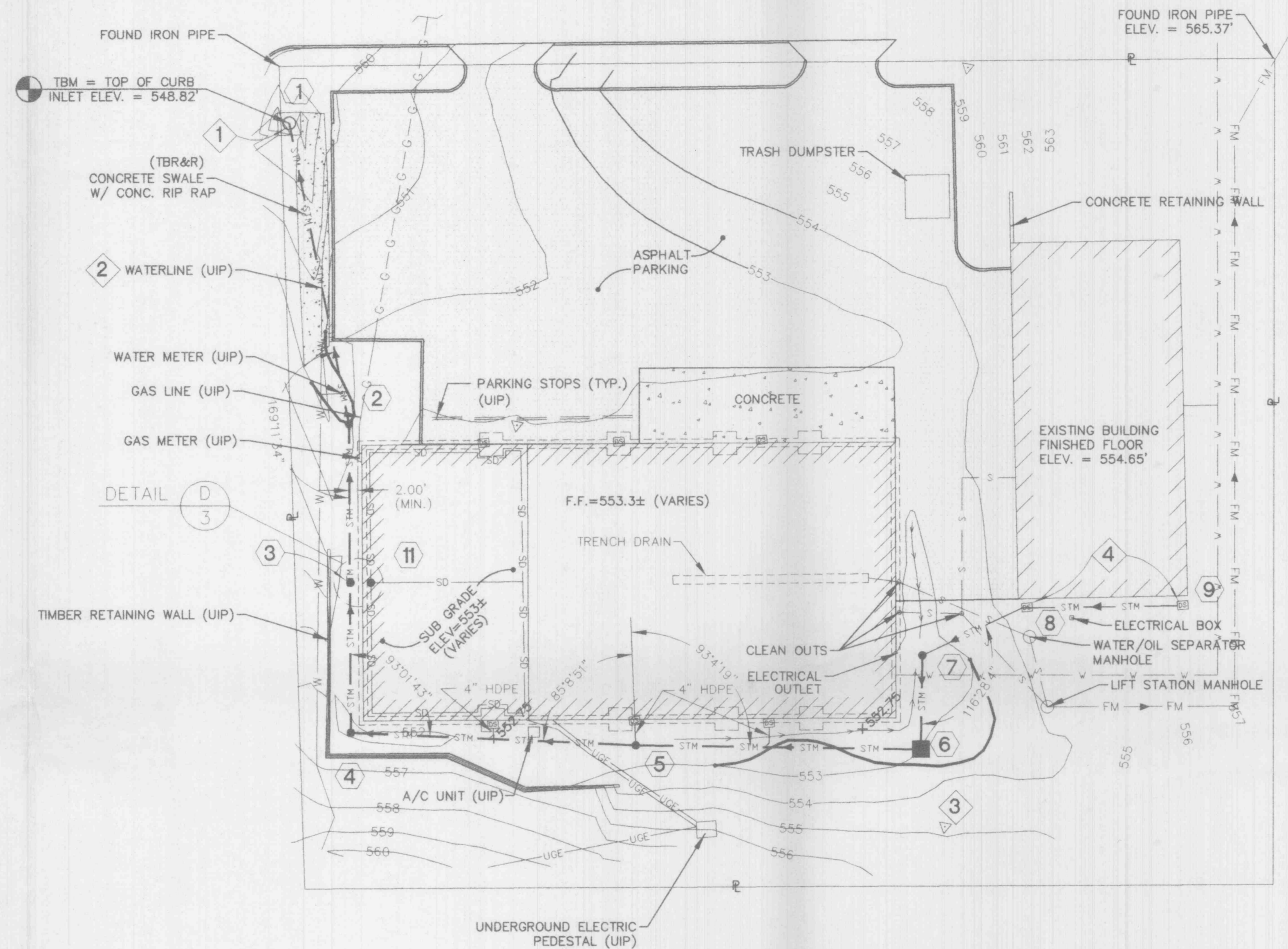

- GENERAL NOTES**
- THE PROFESSIONAL WHOSE SIGNATURE AND PERSONAL SEAL APPEARS HEREON ASSUMES RESPONSIBILITY ONLY FOR WHAT APPEARS ON THIS DRAWING AND DISCLAIMS (PURSUANT TO SECTION 327.411 RSMO) ANY RESPONSIBILITY FOR ALL OTHER DRAWINGS, SPECIFICATIONS, ESTIMATES, REPORTS, SURVEYS OR OTHER DOCUMENTS OR INSTRUMENTS NOT SEALED BY THE UNDERSIGNED PROFESSIONAL.
  - UNDERGROUND FACILITIES, STRUCTURES AND UTILITIES HAVE BEEN PLOTTED FROM AVAILABLE SURVEYS AND RECORDS AND, THEREFORE, THEIR LOCATIONS MUST BE CONSIDERED APPROXIMATE ONLY. THERE MAY BE OTHERS, THE EXISTENCE OF WHICH IS PRESENTLY NOT KNOWN. IT SHALL BE THE CONTRACTOR'S RESPONSIBILITY TO VERIFY THE LOCATION OF ALL UNDERGROUND FACILITIES, STRUCTURES AND UTILITIES BEFORE DOING ANY WORK AT THIS SITE. THESE PROVISIONS SHALL IN NO WAY ABSOLVE ANY PARTY FROM COMPLYING WITH THE UNDERGROUND FACILITIES SAFETY AND DAMAGE PREVENTION ACT (CHAPTER 319 RSMo).
  - FEATURES SHOWN TO EXIST AT THE SITE WERE TAKEN FROM AVAILABLE RECORD DATA, AND A TOPOGRAPHIC SURVEY CONDUCTED BY LUNDAN CORPORATION, DATED 26OCT98. IT SHALL BE THE CONTRACTOR'S RESPONSIBILITY TO VERIFY ALL FEATURES RELATED TO THE PROPOSED WORK PRIOR TO BEGINNING CONSTRUCTION ON ANY RESPECTIVE PORTION. DISCREPANCIES FOUND SHALL BE REPORTED TO THE ENGINEER.
  - PIPE & FITTINGS, HDPE: HIGH DENSITY POLYETHYLENE CORRUGATED CIRCULAR PIPE WITH AN INTEGRALLY FORMED SMOOTH WATERWAY; CORRUGATIONS MAY BE ANNULAR OR SPIRAL; AASHTO M252 AND M294, CLASSIFICATION TYPE D, AS MANUFACTURED BY ADVANCED DRAINAGE SYSTEMS "ADS N-12" OR EQUAL.
  - PIPE & FITTINGS, SUBDRAIN: 18" X 1" HIGH DENSITY POLYETHYLENE CORRUGATED OBLONG PIPE; AS MANUFACTURED BY ADVANCED DRAINAGE SYSTEMS ADS "ADVANEDGE" OR EQUAL.
  - POLY VINYL CHLORIDE (PVC) PLASTIC DRAIN BASINS/INLINE DRAINS: ASTM D3034 OR D679; AS MANUFACTURED BY NYOPLAST USA, INC. OR EQUAL.
  - INSTALLATION: CONFORM TO ASTM D2321.
  - PRECAST REINFORCED CONCRETE SEWER STRUCTURES: CONFORM TO ASTM C478; TYPE II PORTLAND CEMENT; 4000 PSI MINIMUM CONCRETE COMPRESSIVE STRENGTH.
  - GRAY IRON CASTINGS: CONFORM TO ASTM A48, CLASS 30B.

**KEYED NOTES**

- BREAK INTO EXISTING INLET; INSTALL HDPE; REPAIR/PATCH INLET WALL TO SATISFACTION OF THE CITY OF O'FALLON; PRIOR TO BEGINNING THE INSTALLATION, CONTACT THE CITY OF O'FALLON (MR. FRANK GODWIN) AT 314/240-2000; CITY MUST BE PRESENT DURING HDPE INSTALLATION.
- CONTRACTOR SHALL VERIFY THE HORIZONTAL & VERTICAL LOCATION OF THE EXISTING WATER LINE PRIOR TO COMMENCING CONSTRUCTION OPERATIONS; REPORT DISCREPANCIES FOUND TO ENGINEER.
- ADJUST GRADES TO PROVIDE POSITIVE DRAINAGE TO INLETS & DRAIN BASINS.
- FURNISH & INSTALL DOWNSPOUT; MATCH EXISTING GUTTER SYSTEM.

NO.	DATE	REVISIONS
1		
2		
3		
4		
5		
6		
7		

**Lundan Corporation**  
 Engineering & Land Surveying  
 2536 Old Hwy. 94 So., Ste. 216  
 St. Charles, Missouri 63303  
 314 / 936-2128  
 1098-7

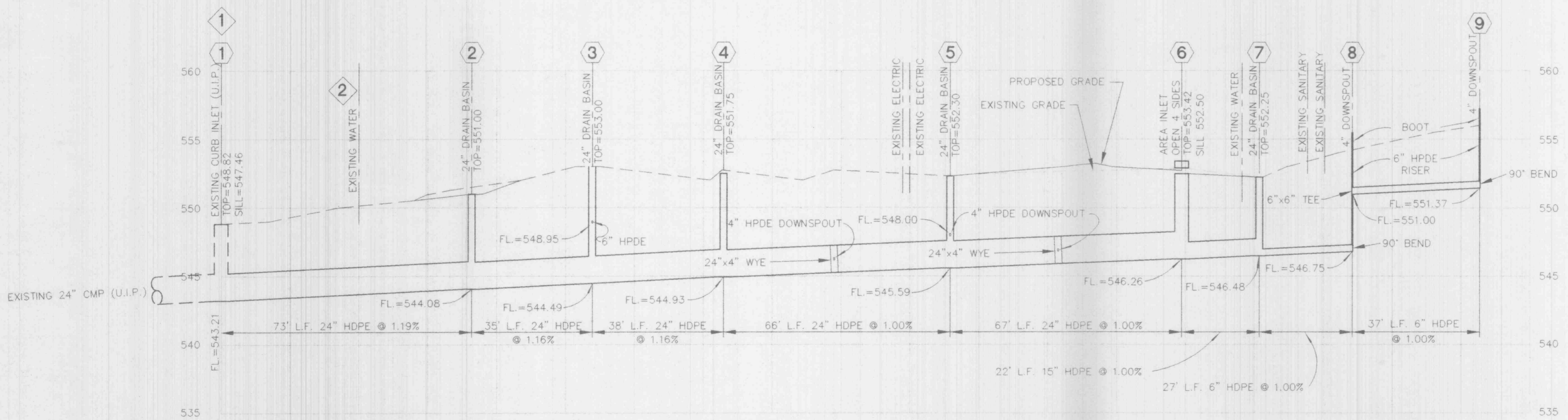
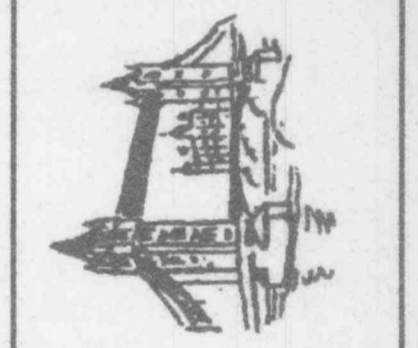

**STORM SEWER PROFILE**  
 SCALE: 1" = 20' HORIZ.  
 1" = 5' VERT.

*Buildings APPROVED*  
 11/23/98  
 Jan Collins

**PLAN & PROFILE**  
 HILLSIDE AUTO REPAIR  
 STORM WATER IMPROVEMENTS  
 ST. CHARLES COUNTY, MISSOURI

Date: 10/30/98  
 Designed by: P.M.M.  
 Drawn by: J.P.P./D.G.C.  
 Checked by: P.M.M.