

HOLLY COURT STREET PROFILE

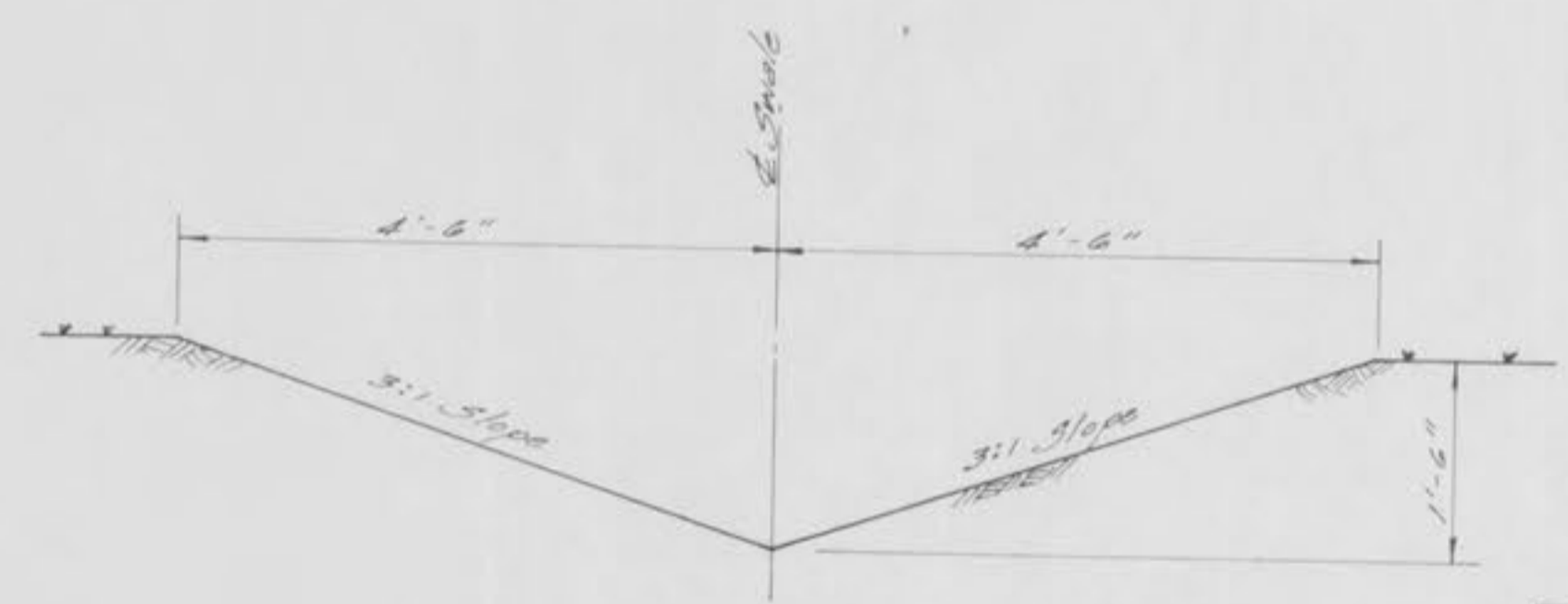
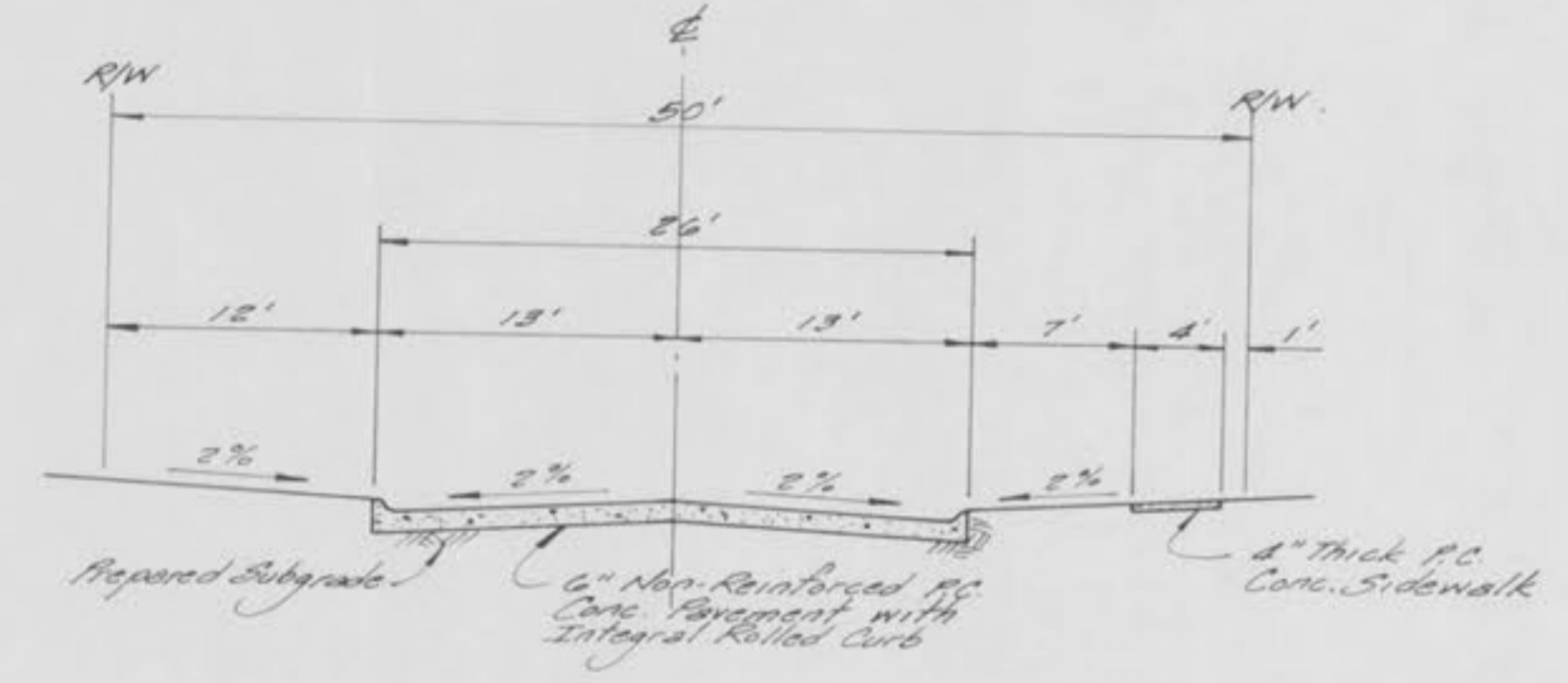
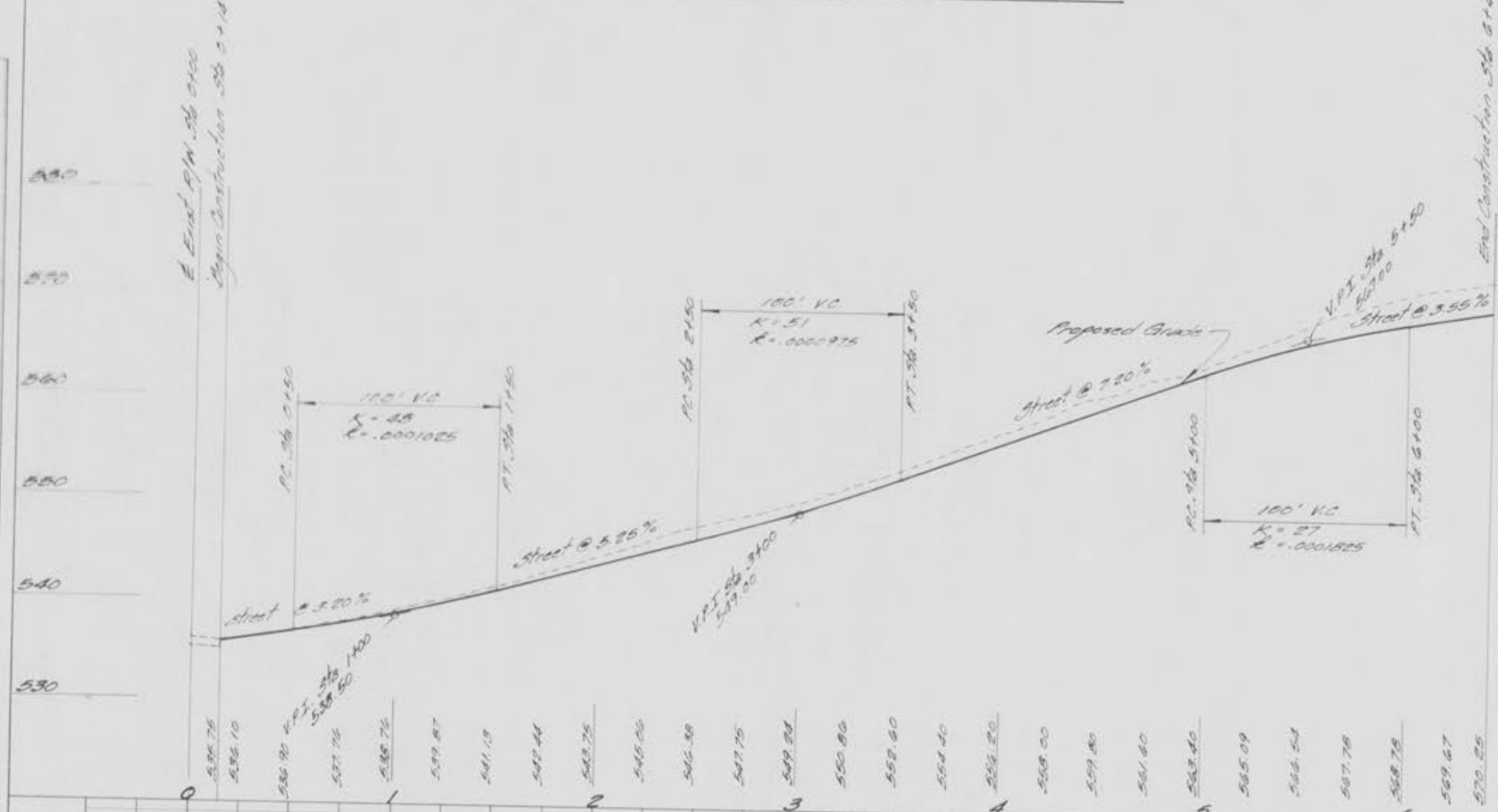

BAX ENGINEERING CO., INC.
 530 Madison Street St. Charles, MO, 63301
 946-6588 724-3330
 Date: March 6, 1985 Order No.: 85-1789

Scale: 1" = 50' Horiz
 1" = 10' Vert

NOTE: Replace damaged North ends of the two (2) existing 24" C.M.P.'s, approx 6' each, and connect to Double Inlet #1.

NOTE: Packmeister Rd. shall be cored in accordance with St. Charles County Highway Department Standards.

