

SILTATION SCREEN FOR SEDIMENT CONTROL  
N.T.S.

NOTE: REFER TO CRAWFORD, BUNTE AND BRAMMEIER PLANS FOR ALL IMPROVEMENTS EXCEPT GRADING WITHIN THE FUTURE RIGHT-OF-WAY.

**GENERAL NOTES**

REFER TO GEOTECHNICAL REPORT DATED JANUARY 27, 1999, PREPARED BY GEOTECHNOLOGY, INC. AND ANY ADDENDUMS THERETO FOR ADDITIONAL GEOTECHNICAL REQUIREMENTS. COORDINATE START-UP AND ALL WORK WITH THE OWNER.

FILL SHALL BE PLACED IN MAXIMUM LIFTS OF TEN (10) INCHES OF LOOSE MATERIAL AND SHOULD BE COMPACTED AT A MOISTURE CONTENT COMPATIBLE WITH THE REQUIRED DENSITY. IF WATER MUST BE ADDED, IT SHOULD BE UNIFORMLY APPLIED AND THOROUGHLY MIXED INTO THE SOIL BY DISKING OR SCARIFYING.

ALL OFFSITE AND UTILITY WORK SHALL BE PERFORMED IN COOPERATION WITH AND IN ACCORDANCE WITH REGULATIONS OF THE JURISDICTIONAL AUTHORITIES.

ALL LANDSCAPED ISLANDS SHALL BE BACKFILLED WITH TOPSOIL. ALL AREAS TO BE SEEDDED SHALL HAVE MINIMUM OF 4" OF TOP SOIL. IF ADEQUATE TOPSOIL IS NOT AVAILABLE ON SITE, THE CONTRACTOR SHALL PROVIDE TOPSOIL APPROVED BY THE OWNER, AS NEEDED. THE AREAS SHALL THEN BE SEEDDED, FERTILIZED, MULCHED, WATERED AND MAINTAINED UNTIL HARDY GRASS GROWTH IS ESTABLISHED IN ALL AREAS. ANY AREAS DISTURBED FOR ANY REASON PRIOR TO FINAL ACCEPTANCE OF THE JOB SHALL BE CORRECTED BY THE CONTRACTOR AT NO ADDITIONAL COST TO THE OWNER. ALL EARTHEN AREAS WILL BE GRASSED EXCEPT AS SHOWN ON THE LANDSCAPING PLAN.

CONSTRUCTION METHODS AND MATERIALS NOT SPECIFIED IN THESE PLANS SHALL BE PERFORMED IN ACCORDANCE WITH HOME DEPOT SITEWORK SPECIFICATIONS. IN CASES OF CONFLICT BETWEEN THESE PLANS AND THE GEOTECHNICAL REPORT, THE GEOTECHNICAL REPORT WILL GOVERN.

THE CONTRACTOR SHALL BE RESPONSIBLE FOR THE CONTROL OF DUST AND DRIFT AND LIME CLOUDS (IF LIME STABILIZATION IS UTILIZED) RISING AND SCATTERING IN THE AIR DURING CONSTRUCTION AND SHALL PROVIDE WATER SPRINKLING OR OTHER SUITABLE METHODS OF CONTROL. THE CONTRACTOR SHALL COMPLY WITH ALL GOVERNING REGULATIONS PERTAINING TO ENVIRONMENTAL PROTECTION.

ADDITIONAL SILT CONTROL MAY BE REQUIRED BY THE CITY OF O'FALLON.

SEDIMENT CONTROL SHALL FOLLOW THE GUIDELINES OF THE MODEL SEDIMENT AND EROSION CONTROL REGULATIONS BY THE ST. CHARLES SOIL AND WATER CONSERVATION DISTRICT.

CONTRACTOR SHALL MAINTAIN POSITIVE DRAINAGE AT ALL TIMES. THIS MAY REQUIRE TEMPORARY STORM PIPES OR DITCHES IN LOW AREAS TO PROMOTE DRAINAGE.

ALL GRADING OPERATIONS SHALL BE MONITORED BY A GEOTECHNICAL ENGINEER FOR COMPLIANCE WITH THE PLANS AND SPECIFICATIONS.

THE CONTRACTOR IS MADE AWARE OF A CONDITION OF THE CORPS OF ENGINEERS 404 PERMIT FOR THIS PROJECT REQUIRING A 30 DAY PERIOD FROM THE TIME THE MULCH CUTTINGS ARE PLANTED AND THE BANK SEEDS WITHIN THE RELOCATED CREEK CHANNEL AND THE TIME THAT THE EXISTING CREEK DRAINAGE IS ROUTED INTO THE NEW CREEK. NOTHING IN THIS REQUIREMENT OR ELSEWHERE IN THE PERMIT SHALL BE CONSTRUED TO LIMIT THE CONTRACTORS ABILITY TO TEMPORARILY RELOCATE OR PIPE THE CREEK OUTSIDE THE CONSERVATION EASEMENT.

THE CONTRACTOR IS MADE AWARE THAT THE EXISTING SANITARY SEWER MAIN BISECTING THE SITE MUST REMAIN IN PLACE AND OPERATIONAL UNTIL SUCH TIME THAT THE NEW MAIN IS CONSTRUCTED AND APPROVED. THE CONTRACTOR SHALL INCLUDE IN HIS BID THE TEMPORARY RAISING OF THE MANHOLES IF NECESSARY.

CONTRACTOR IS MADE AWARE OF THE EXISTENCE OF AN 8" GAS MAIN WHICH ACCORDING TO LACLEDE GAS IS PARALLEL TO AND APPROXIMATELY 10' INSIDE OF MODOT ROW. THE INTENT OF THESE GRADING CONTOURS IS TO NOT REDUCE THE COVER OVER THE GAS MAIN SO AS NOT TO RELOCATE THE MAIN.

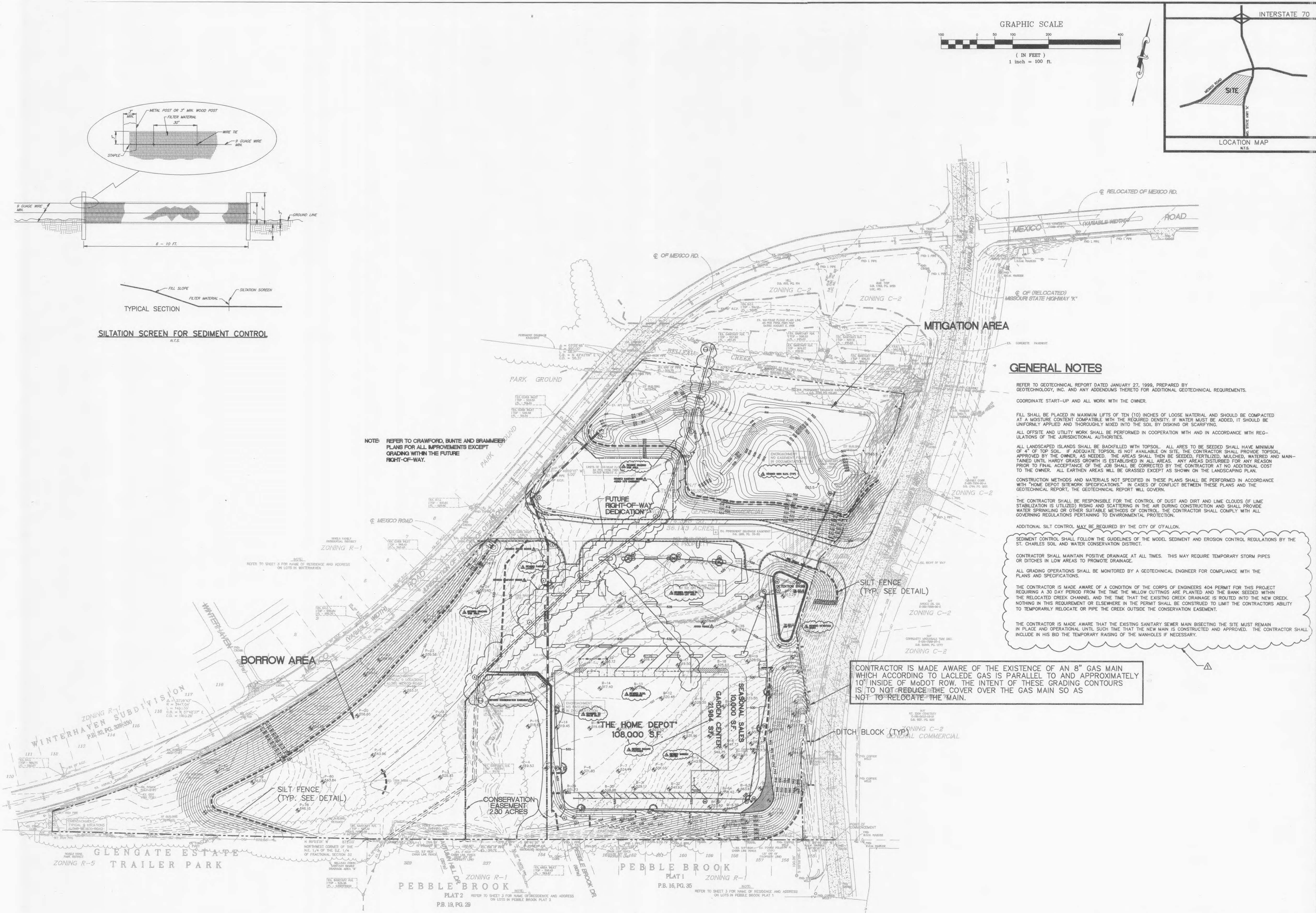

THIS SHEET IS FOR INFORMATION ONLY  
CONTRACTOR IS TO REFER TO SHEETS C4.2, C4.3  
AND C4.4 FOR CONSTRUCTIONS DETAILS

THE PROFESSIONAL WHOSE SIGNATURE AND PERSONAL SEAL APPEARS ON THIS DRAWING ASSUMES RESPONSIBILITY ONLY FOR WHAT APPEARS ON THIS DRAWING AND DISCLAIMS (PURSUANT TO SECTION 324.411 RSMo) ANY RESPONSIBILITY FOR ALL OTHER PLANS, SPECIFICATIONS, ESTIMATES, REPORTS OR OTHER DOCUMENTS OR INSTRUMENTS NOT SEALED BY UNDERSIGNED PROFESSIONAL ENGINEER OR INTENDED TO BE USED FOR ANY PART OR PARTS OF THE PROJECT TO WHICH THIS DRAWING REFERS.

*James B. Becker*  
JAMES B. BECKER  
REGISTERED PROFESSIONAL ENGINEER  
5-411

**OVERALL GRADING AND SILTATION CONTROL PLAN**

DATE	07/27/99	REVISED
	04/08/99	REVISED
	04/08/99	REVISED
	04/23/99	REVISED
DEVELOPER	THE HOME DEPOT SOUTHWEST DIVISION 2800 FOREST LANE DALLAS, TX. 75234	
CONSULTING ENGINEERS	James B. Becker	
	ST. LOUIS, MISSOURI 63123	
PROJECT	THE HOME DEPOT O'FALLON, MISSOURI	
	DRAWN BY: DATE: TMM 10/19/98	
SCALE:	1" = 100'	
	JOB NUMBER: 4625	
SHEET NUMBER:	C4.1	
	ISSUE DATE: 05/03/99	