

SEE DETAILS SHEET 5

HYLAND GREEN PLAT 5

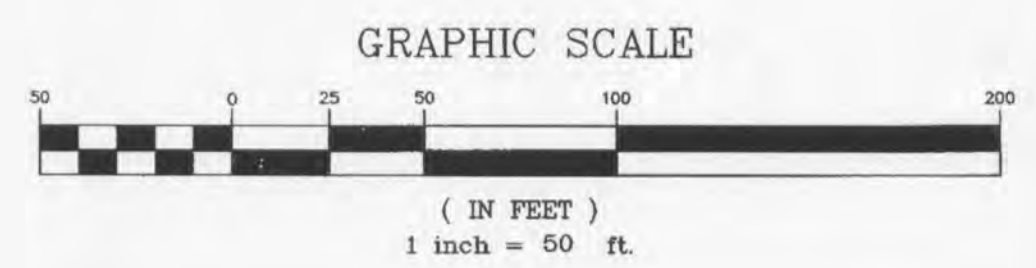

SEE DETAIL SHEET 5

HYLAND GREEN PLAT 5

HYLAND GREEN FUTURE DEVELOPMENT

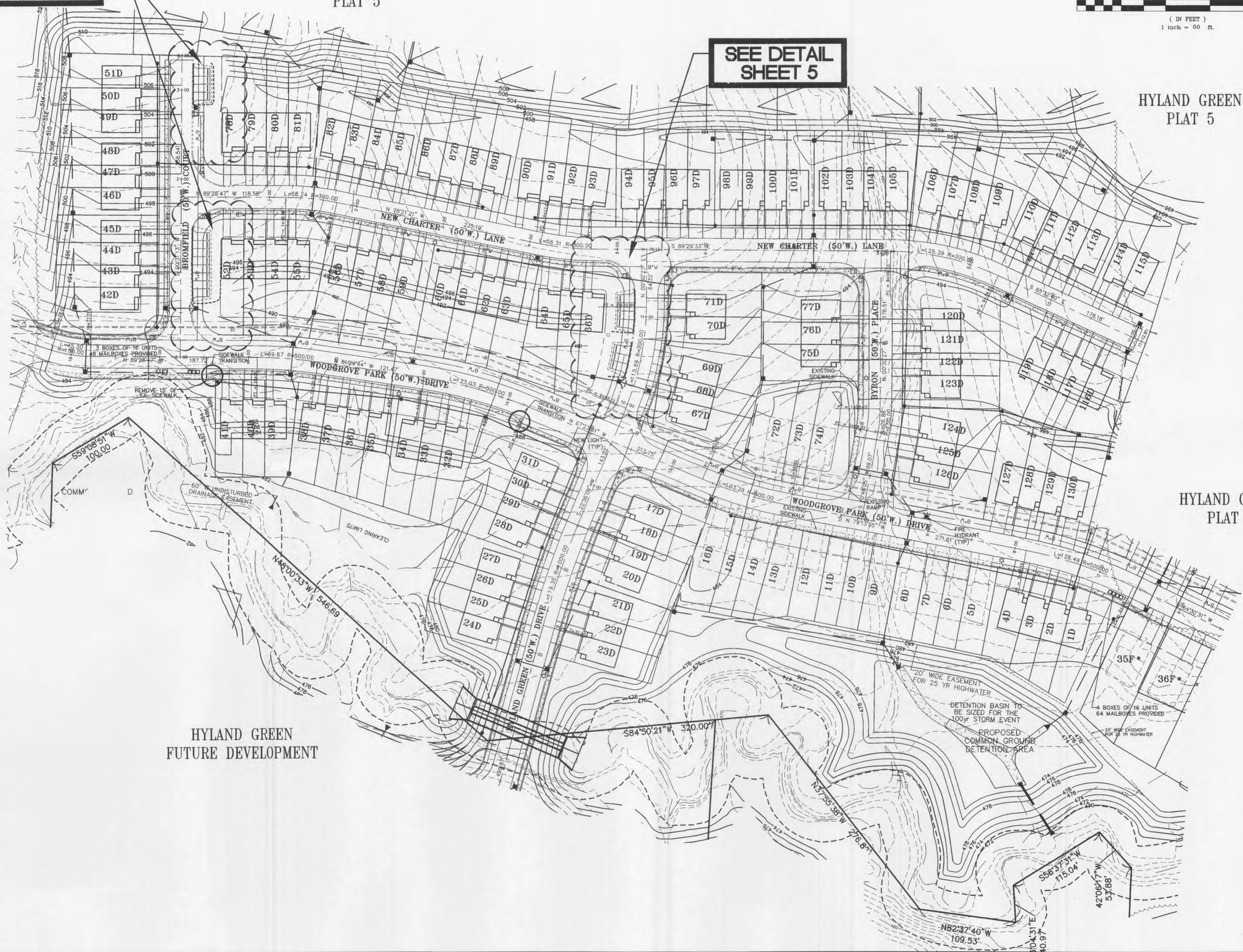

HYLAND GREEN FUTURE DEVELOPMENT

HYLAND GREEN PLAT 6

PROJECT TITLE:

HYLAND GREEN VILLAGE D

Box Project # 88-102563 Issue Date: 06/21/2018

ENGINEERING SURVEYING
221 Poincote West Blvd.
St. Charles, MO 63301
636-608-5522
FAX 636-608-1718



DISCLAIMER OF RESPONSIBILITY
I hereby specify that the documents intended to be authorized by my seal are limited to this sheet, and I hereby disclaim any responsibility for all other drawings, specifications, estimates, reports or other documents or instruments relating to or intended to be used for any part or parts of the architectural or engineering project or survey.



Copyright © 2013
Box Engineering Company, Inc.
Engineering Authority No. 000655
Surveying Authority No. 000144
All Rights Reserved

REVISIONS

DATE	REVISION
07/17/13	CITY COMMENTS
08/07/13	CITY COMMENTS
08/29/13	CITY COMMENTS

Developer / Owner:

McBride and Sons Homes
16091 Swingley Ridge Road, Suite 300
Chesterfield, MO 63017
(314) 336-0248

GRADING PLAN

P+Z No. #1303.10 - June 6, 2013

City No. #

Page No. 4 of 6