

RAIN GARDEN MAINTENANCE PLAN

Maintenance Schedule
 Post Construction BMP - Rain Garden

• All other Storm or Sanitary Sewer Details will be by M.S.D. 2007 Standards and Specifications.

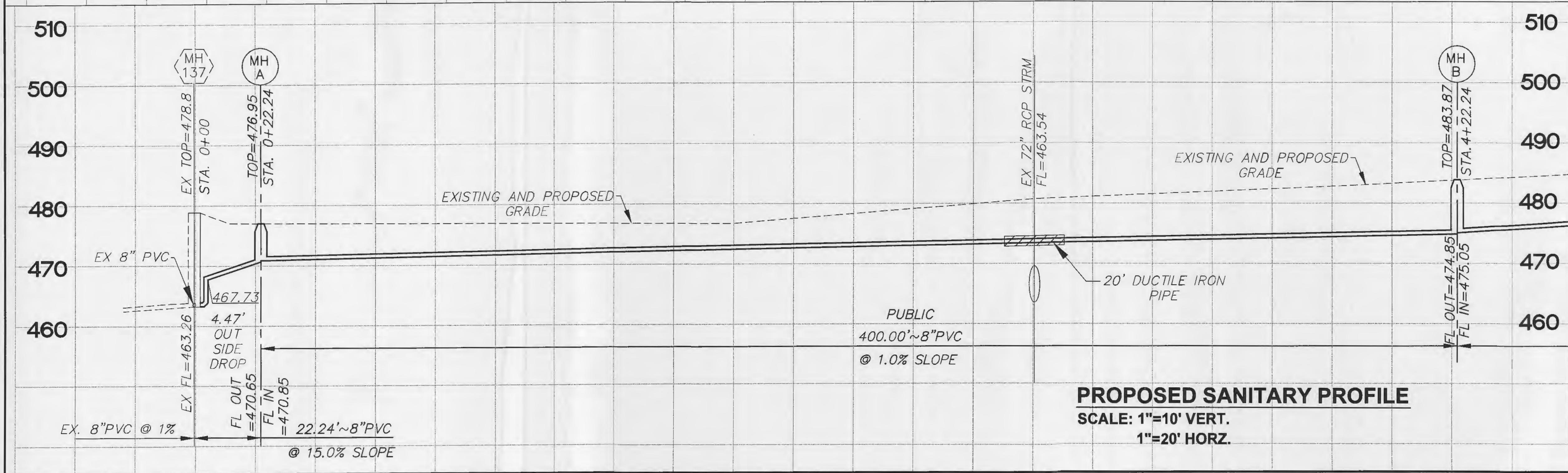

II. CLEANING OF FACILITIES

The stormwater and facility shall be cleaned shortly after the project is completed and erosion control has been removed and vegetation has been established.

All silt and debris should be removed from the storm sewer structures and storm sewer lines before reaching the detention facilities. All sediment removed from the site shall be disposed of according to current erosion and sediment control regulations.

ITG EYECARE OFFICE
 1138 TOM GINNEVER AVE.
 O'FALLON, MISSOURI 63376

PICKETT, RAY & SILVER, INC.
 CIVIL ENGINEERING, LAND SURVEYING,
 AND NATURAL RESOURCES SERVICES
 Branson, MO
 3027 W. Hwy 76, Suite B
 St. Peters, MO 65376
 Phone (636) 397-1211 Fax (636) 397-1104
 www.prs.com 1-800-708-3918

ENGINEERS AUTHENTICATION
 THE RESPONSIBILITY FOR PROFESSIONAL ENGINEERING LIABILITY ON THIS PROJECT IS HEREBY LIMITED TO THE SET OF PLANS AUTHENTICATED BY THE SEAL, SIGNATURE, & DATE HEREINAFTER ATTACHED. RESPONSIBILITY IS DISCLAIMED FOR ALL OTHER ENGINEERING PLANS INVOLVED IN THIS PROJECT AND SPECIFICALLY EXCLUDES REVISIONS AFTER THIS DATE UNLESS RE-AUTHENTICATED.
 PICKETT, RAY & SILVER, INC.
 MO LICENSE #0003225

STATE OF MISSOURI
 REGISTERED PROFESSIONAL ENGINEER
 CHRISTINE ANN LOCK
 No. 150337
 PROFESSIONAL ENGINEER LICENSE 2009/150037

Developer / Owner Information
 CONTACT: MR. DOUG CROSS
 ADDRESS: 17258 LOST CABIN ROAD
 WILDWOOD, MO 63025
 PHONE: (314) 651-3489

PAVEMENT DETAILS AND PROFILES

P+Z No. Approval Date 06-06-2013
 City No.
 Page No.

SHEET 8 OF 11

City of O'Fallon Standard Commercial Notes and Details - June 2010