

STORM SEWER PROFILES  
INDIAN SPRINGS

3-12-97 96-8861

REVISED 4-07-97  
REVISED 6-17-97  
REVISED 7-01-97

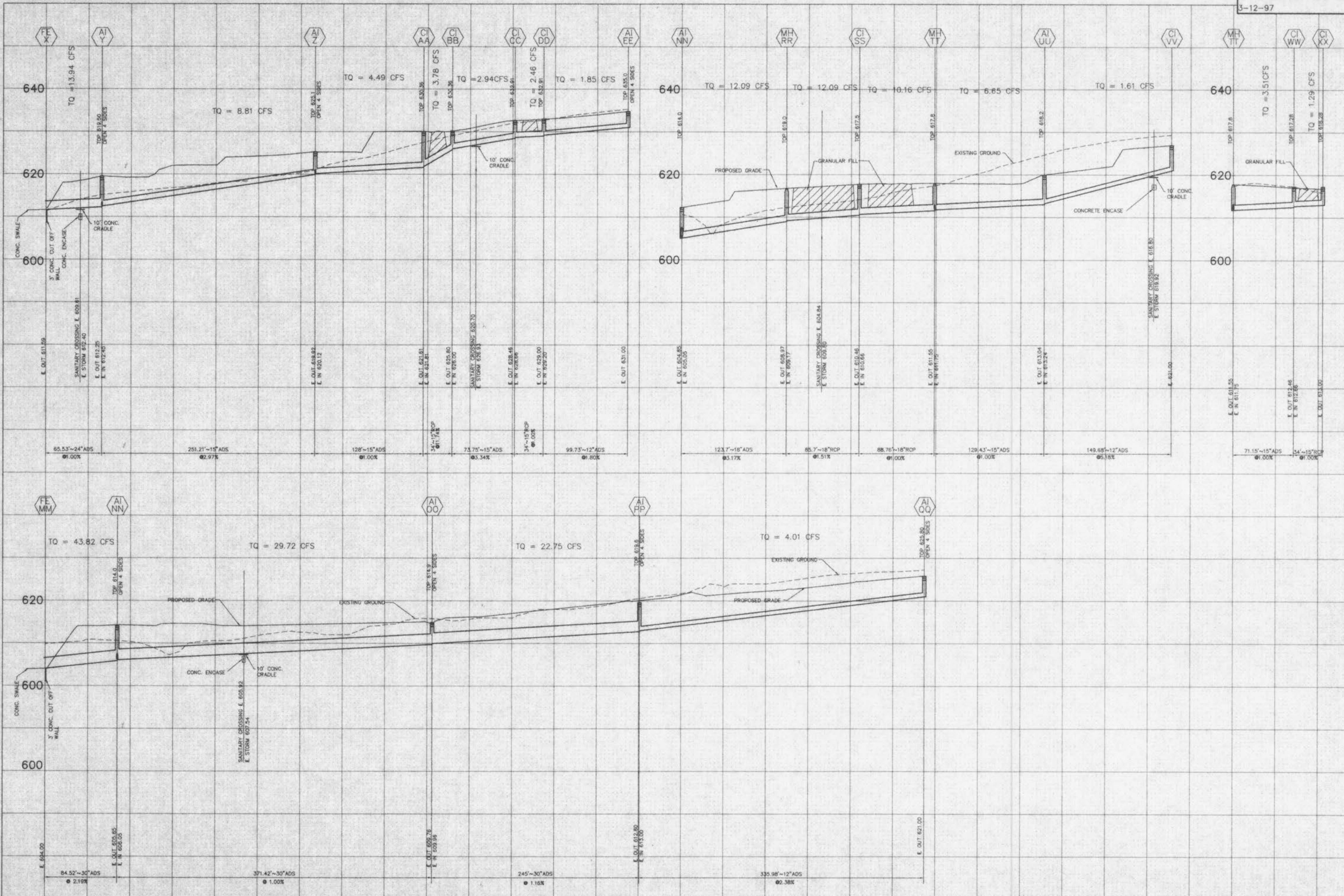

1" = 50' HORIZONTAL  
1" = 10' VERTICAL

C:\DWG\8861\CON Tue Jul 22 13:25:31 1997 STATION 30