

H:\CAD\24400\22449\22450\mp\Drawings\22450 - C23 Storm Sewer.dgn - Master Model - 3/7/2022 - 2:46:59 PM - Plotted by jenkins - Plot Scale: 50.000000 - / in. Plot Driver: volz5 PDF.plt; Pen Table: volz5 PDF.tbl

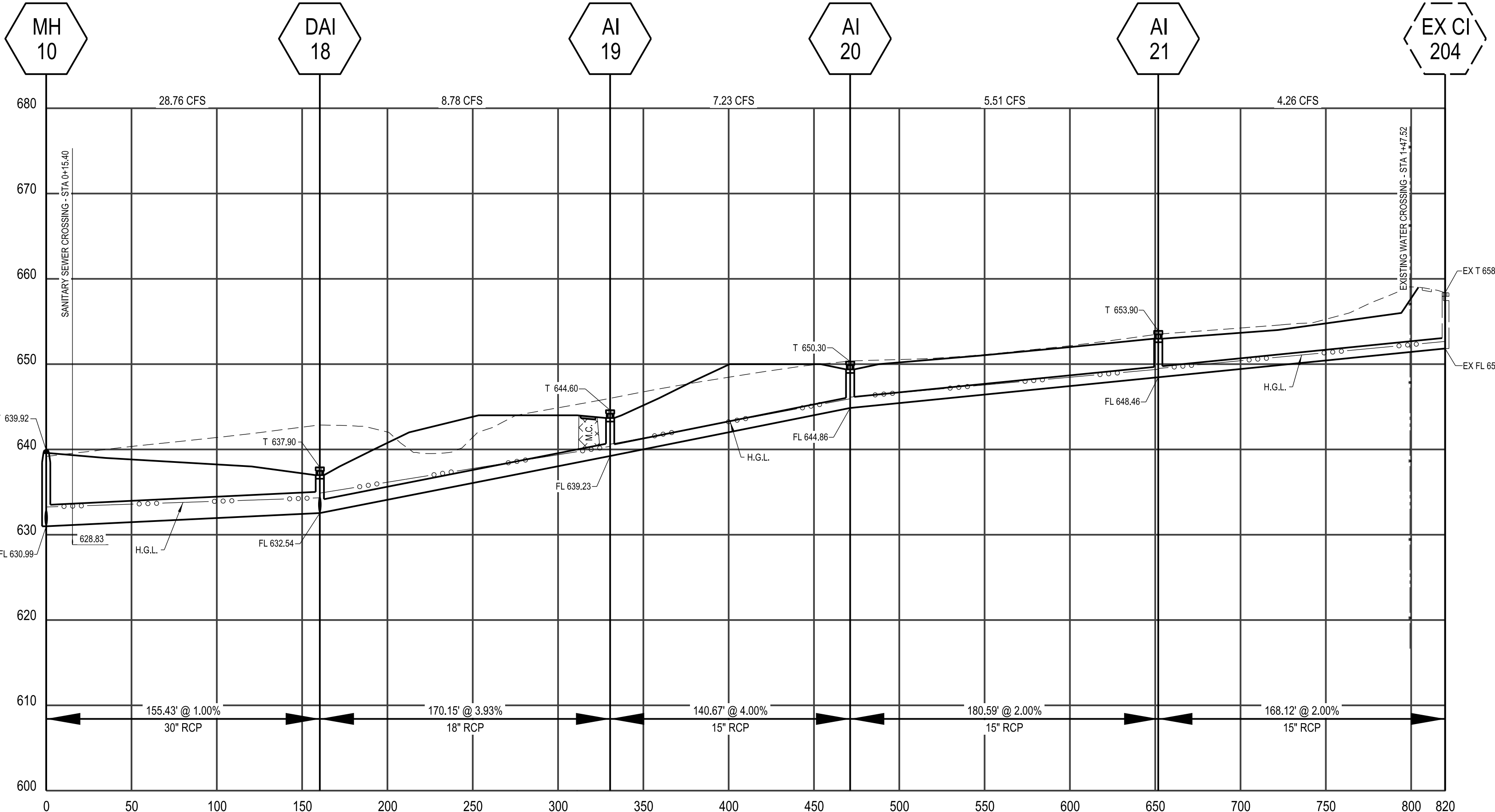

**VOLZ Incorporated**  
 ENGINEERS  
 LAND PLANNING  
 LAND SURVEYING  
 TRANSPORTATION MANAGEMENT  
 10848 Indian Head Trl. Bldg.  
 St. Louis, Missouri 63132  
 314.426.0212 Main  
 www.volzinc.com  
 Authority #203

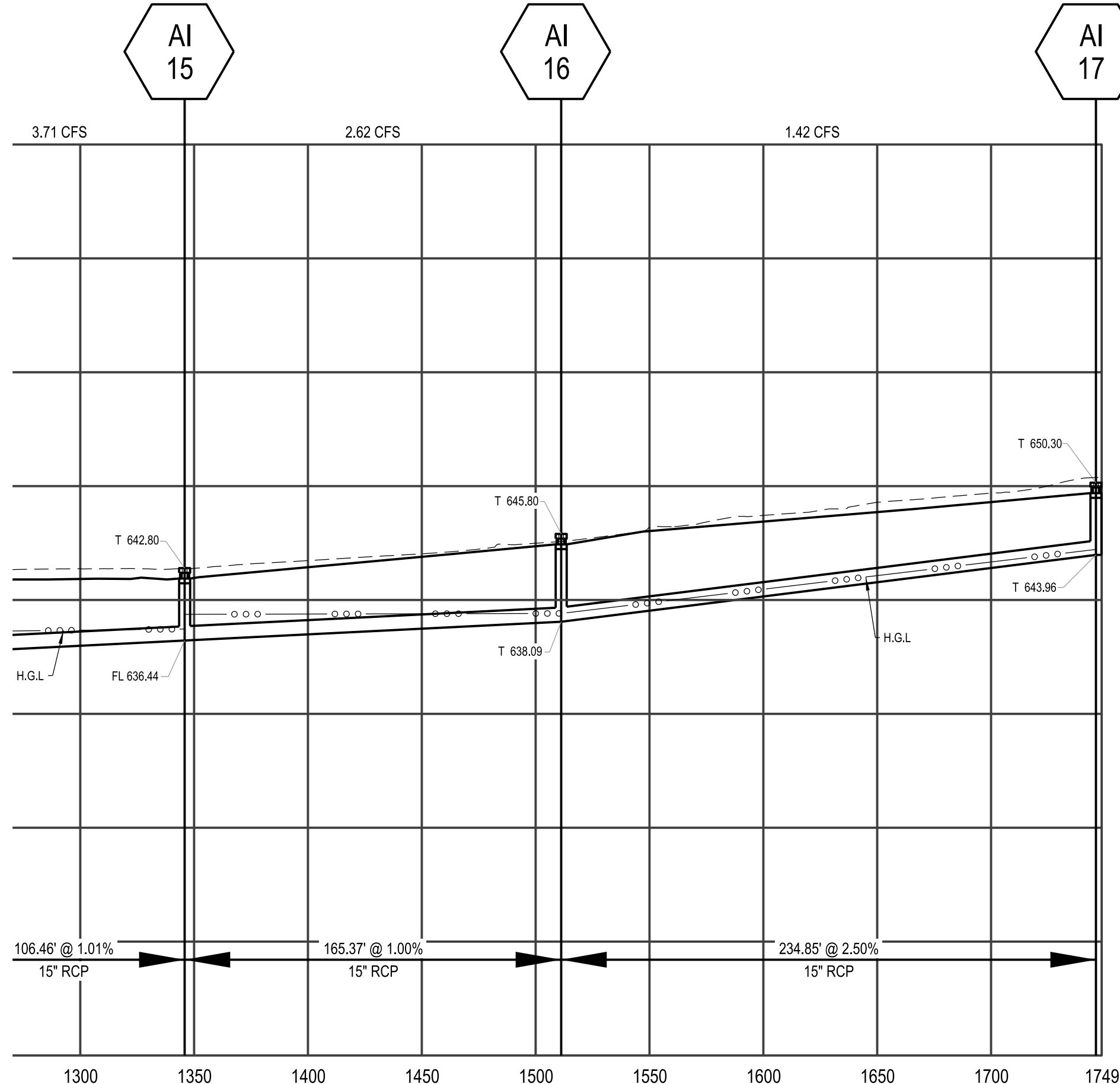
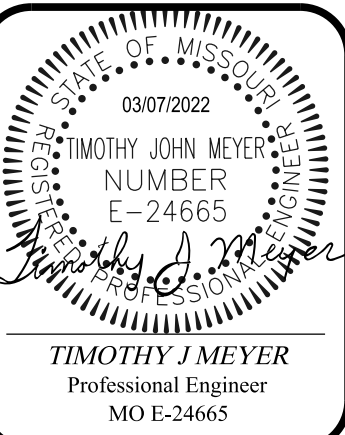

TIMOTHY J. MEYER  
Professional Engineer  
MO E-24665

# INVERNESS

STORM SEWER  
 1575 BRYAN RD.  
 PHASE 3  
 Project # 22450

01/20/2022  
**C23**