

10'
 10'
 SCALE

EXTEND FOOTING
 AS NEEDED

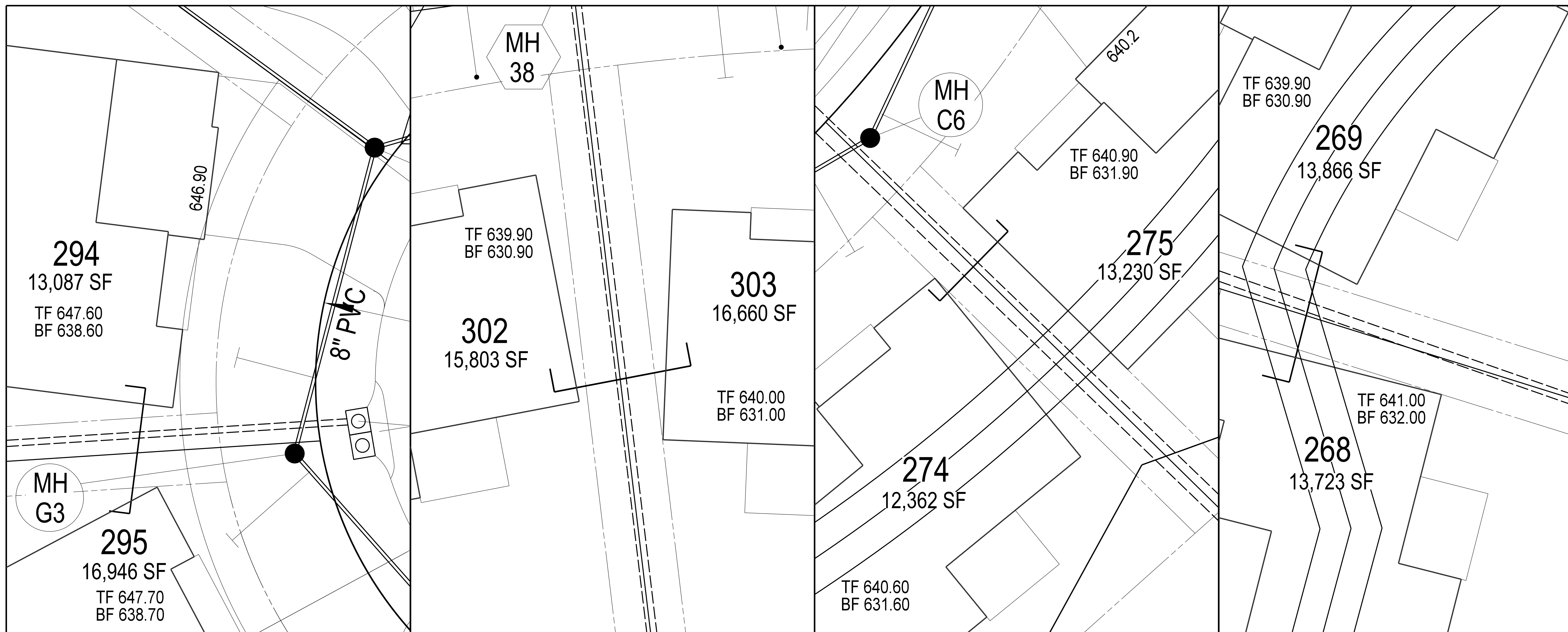

MCKELVEY
HOMES
 Building A Tradition Of Excellence Since 1898
 218 CHESTERFIELD TOWNE CENTRE
 CHESTERFIELD, MISSOURI 63015
 (636) 535-5900

VOLZ
 Incorporated
 ENGINEERS
 LAND PLANNING
 LAND SURVEYING
 TRANSPORTATION
 MANAGEMENT
 10849 Indian Head Trl. Bldg.
 St. Louis, Missouri 63132
 314-426-6212 Main
 www.volzinc.com
 Authority #203

STATE OF MISSOURI
 03/07/2022
 TIMOTHY J MEYER
 NUMBER
 E-24665
 TIMOTHY J MEYER
 Professional Engineer
 MO E-24665

INVERNESS

SEWER INFLUENCE
 PHASE 3
 1575 BRYAN RD.
 Project # 22450
 01/20/2022
C28