

DATE	DLM	SALSBUry	1010 E. 62nd Street Los Angeles, CA 90001 Phone: (800) 624-5289 Fax: (800) 624-5299	CLUSTER BOX UNITS 3300 SERIES "T" CBUs AVAILABLE FOR USPS ACCESS OR PRIVATE ACCESS	3316
SCALE	4 1/2" / 20'0"	email: engineering@mailboxes.com			CAD_3316

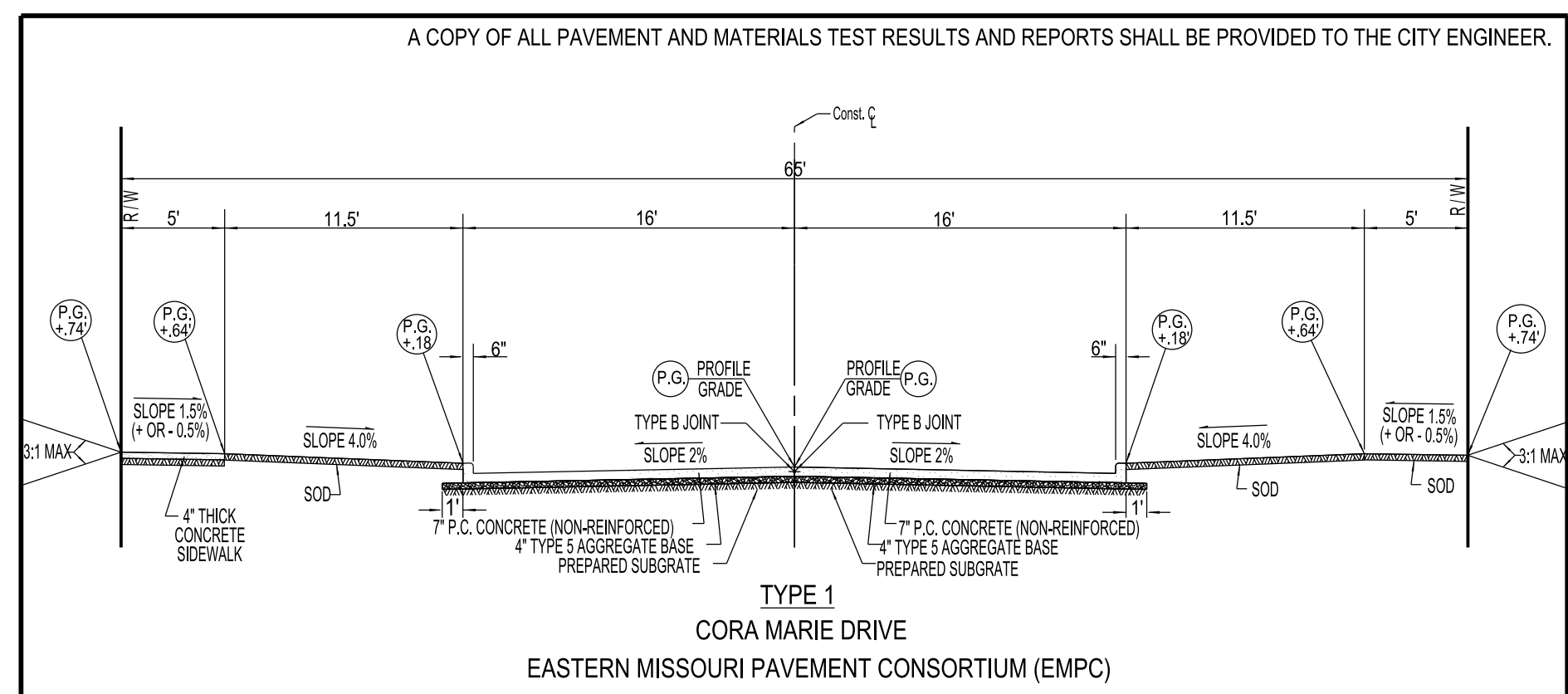

PAVEMENT SHOULD CONFORM TO ST. CHARLES COUNTY STANDARDS DETAILS AND SPECIFICATIONS

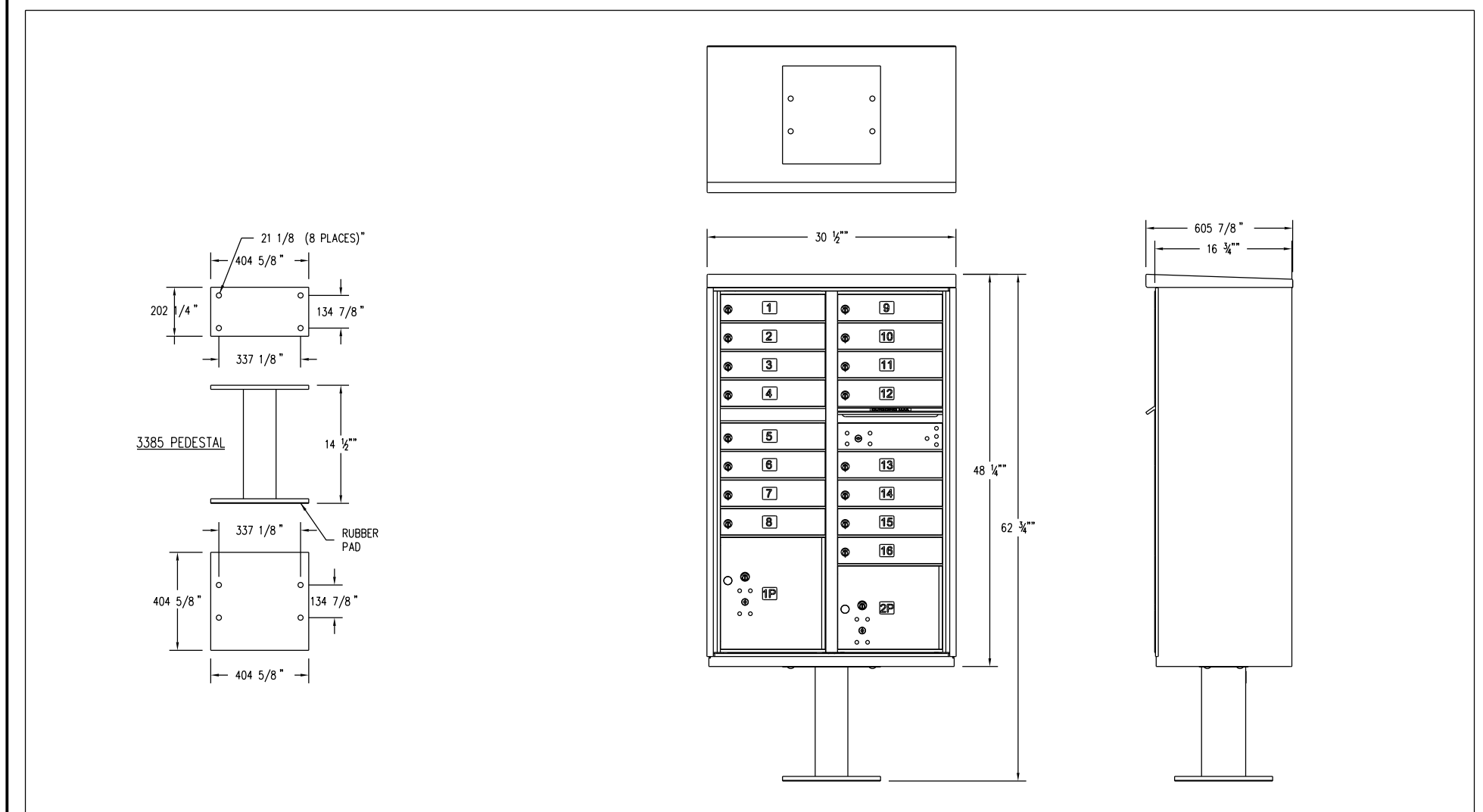
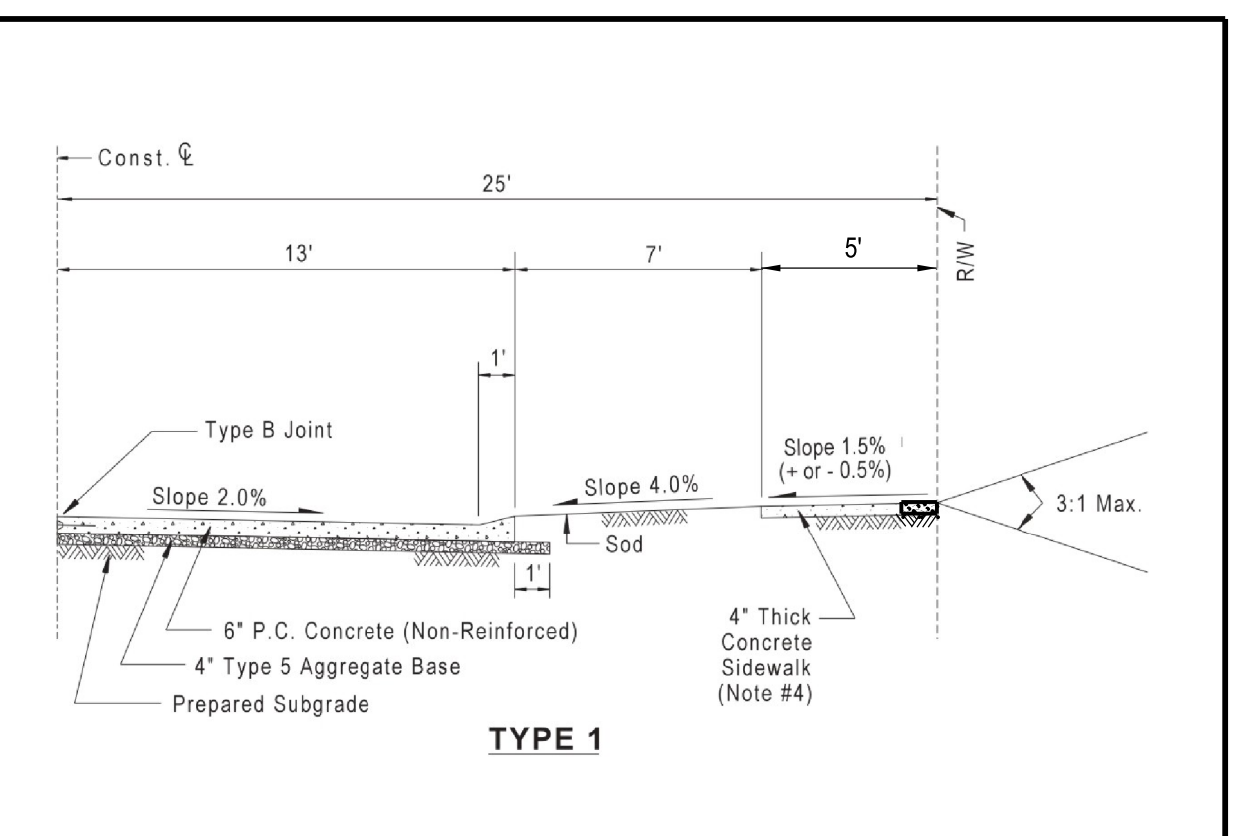

INTERNAL STREETS EASTERN MISSOURI PAVEMENT CONSORTIUM (EMPC) A COPY OF ALL PAVEMENT AND MATERIALS TEST RESULTS AND REPORTS SHALL BE PROVIDED TO THE CITY ENGINEER.

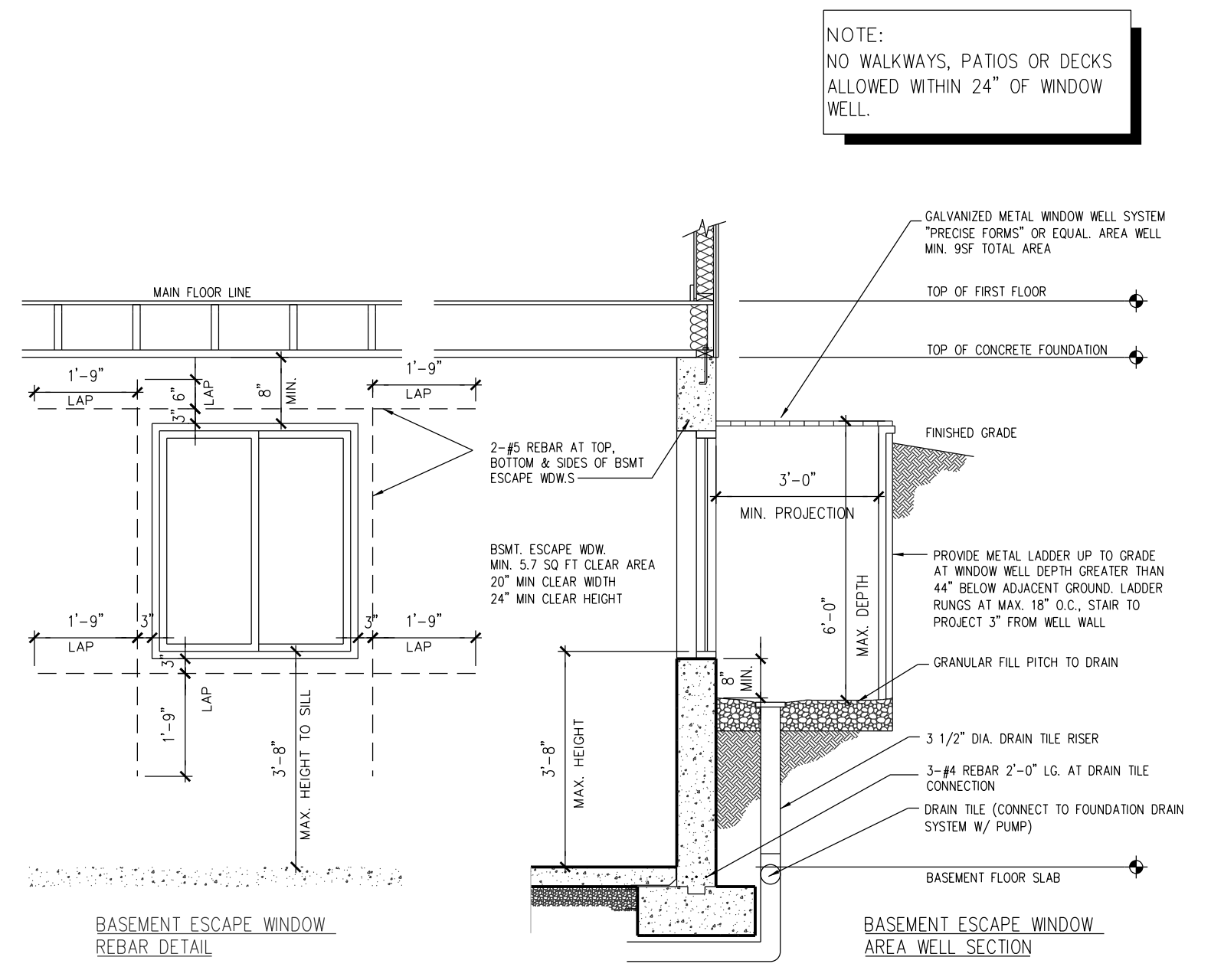

N.T.S BASEMENT ESCAPE WINDOW DETAIL

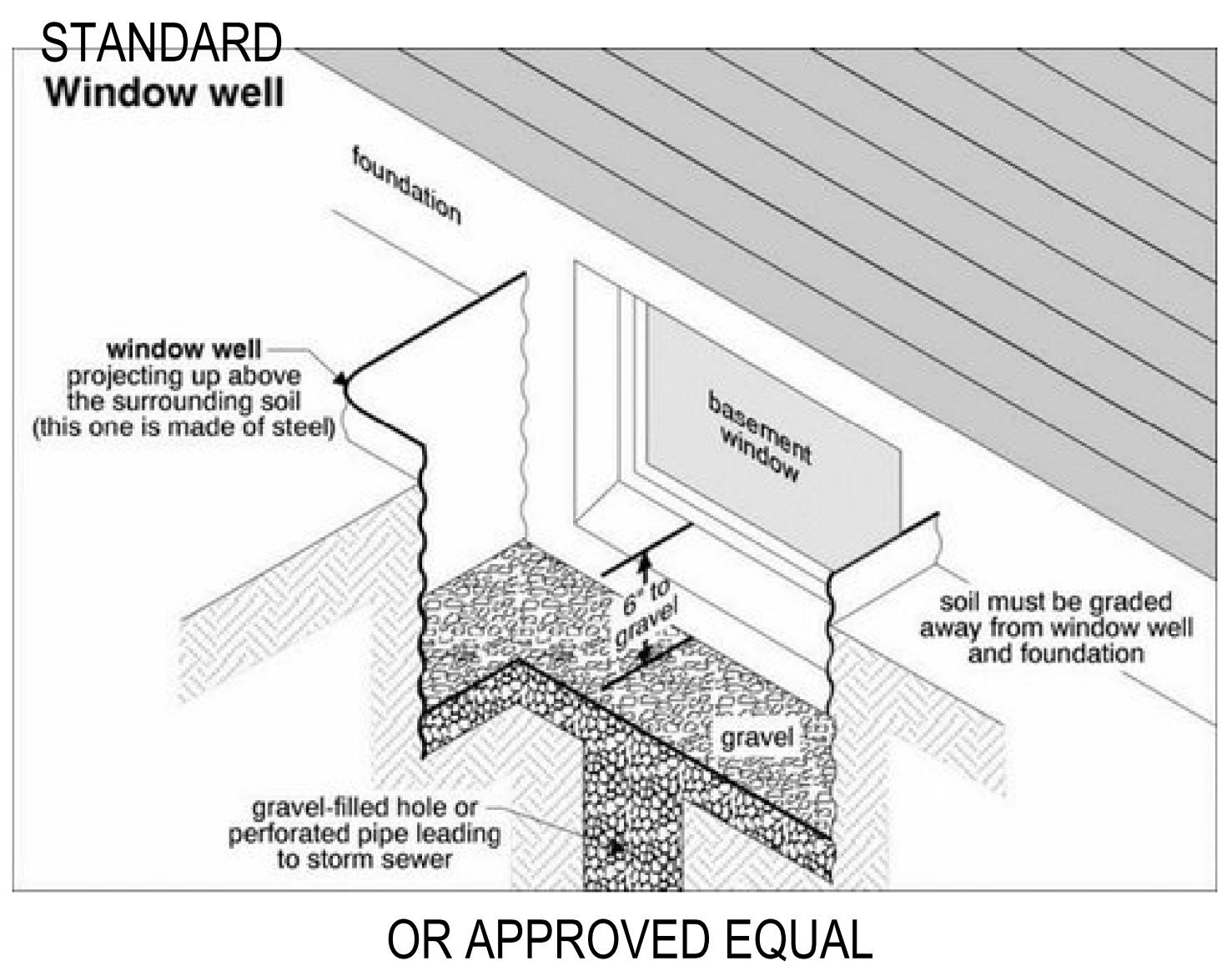

OR APPROVED EQUAL



25 M.P.H. SPEED LIMIT SIGN



ROUND-A-BOU T AHEAD / 20 M.P.H. SIGN



END OF PAVEMENT SIGN



KEEP RIGHT AHEAD SIGN



ENGINEERS
LAND PLANNING
LAND SURVEYING
TRANSPORTATION
MANAGEMENT
10848 Indian Head Trl. Blvd.
St. Louis, Missouri 63132
314-426-0212 Main
www.volzinco.com
Authority #203

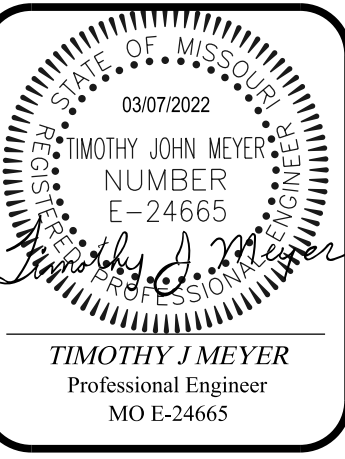

TIMOTHY J MEYER
Professional Engineer
MO E-24665

INVERNESS

CONSTRUCTION DETAILS
1575 BRYAN RD.
Project # 22450

01/20/2022
C45

PHASE 3