

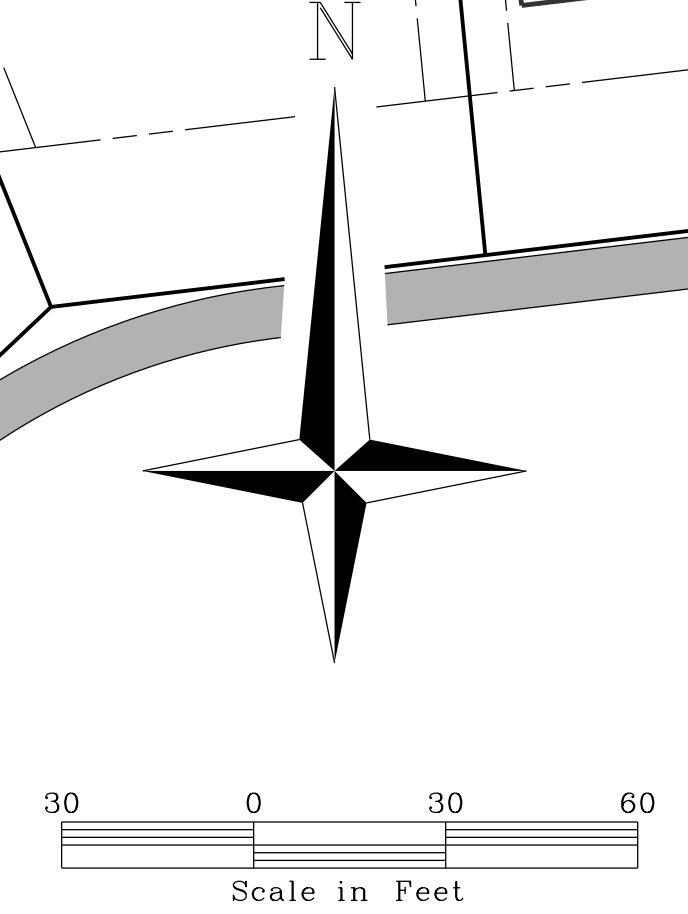

THE UNDERGROUND UTILITIES SHOWN HEREIN WERE PLOTTED FROM AVAILABLE INFORMATION AND FIELD MARKINGS PROVIDED BY THE MEMBER UTILITIES OF THE MISSOURI ONE CALL SYSTEM (800-345-3871) AND DO NOT NECESSARILY REFLECT THE LOCATION OF THESE OR OTHER UTILITIES. NOR THE ABILITY TO SERVICE THE EXISTING OR INTENDED USES OF THIS OR ADJACENT SITES. THE GENERAL CONTRACTOR SHALL BE RESPONSIBLE FOR VERIFYING THE ACTUAL LOCATION OF ALL UNDERGROUND UTILITIES. NO CONSTRUCTION OF IMPROVEMENTS, THESE PROVISIONS SHALL IN NO WAY ABSOLVE ANY PARTY FROM COMPLYING WITH THE UNDERGROUND FACILITY SAFETY AND DAMAGE PREVENTION ACT, CHAPTER 319, RSMO.



**MCKELVEY**  
**HOMES**  
 Building A Tradition Of Excellence Since 1898  
 218 CHESTERFIELD TOWNE CENTRE  
 CHESTERFIELD, MISSOURI 63105  
 (636) 235-9260

**VOLZ Incorporated**  
 ENGINEERS  
 LAND PLANNING  
 LAND SURVEYING  
 TRANSPORTATION MANAGEMENT  
 10848 Indian Head Inlet Blvd.  
 St. Louis, Missouri 63112  
 314-426-0212 Main  
 www.volzinc.com  
 Authority #203

**TIMOTHY J MEYER**  
 Professional Engineer  
 MO E-24665

# INVERNESS

**STREET SIGN - SCHEMATIC PLAN**  
 PHASE 3  
 1575 BRYAN RD.  
 Project # 22450  
 01/10/2022  
**C58**