

REVISIONS
 11/10/03 DUCKETT CREEK
 11/11/03 CITY COMMENTS
 12/09/03 DUCKETT CREEK & CITY
 02/06/04 ENTRANCE CHANGE

A SITE PLAN FOR
**JEFFERSON BANK
 AND TRUST**

98-9713EA 09-09-03

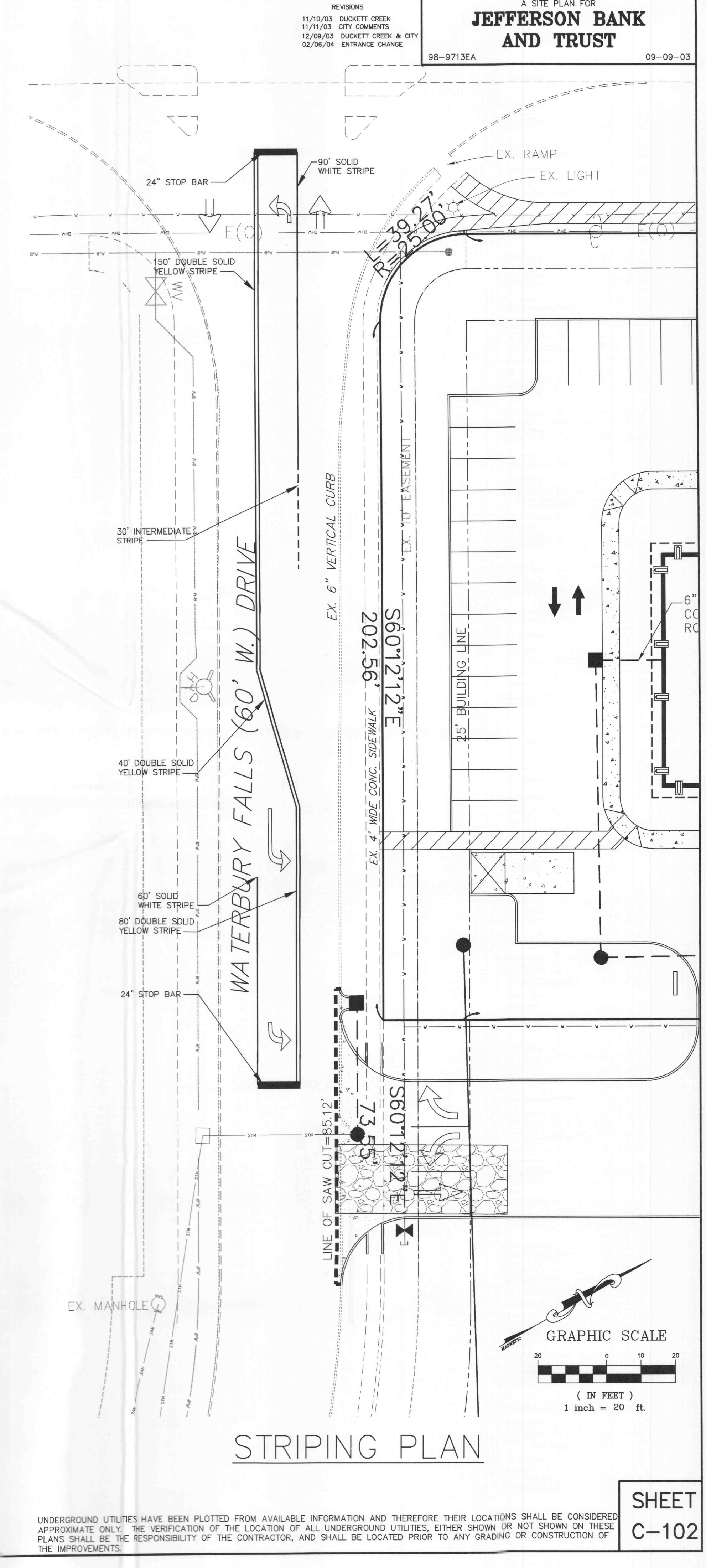
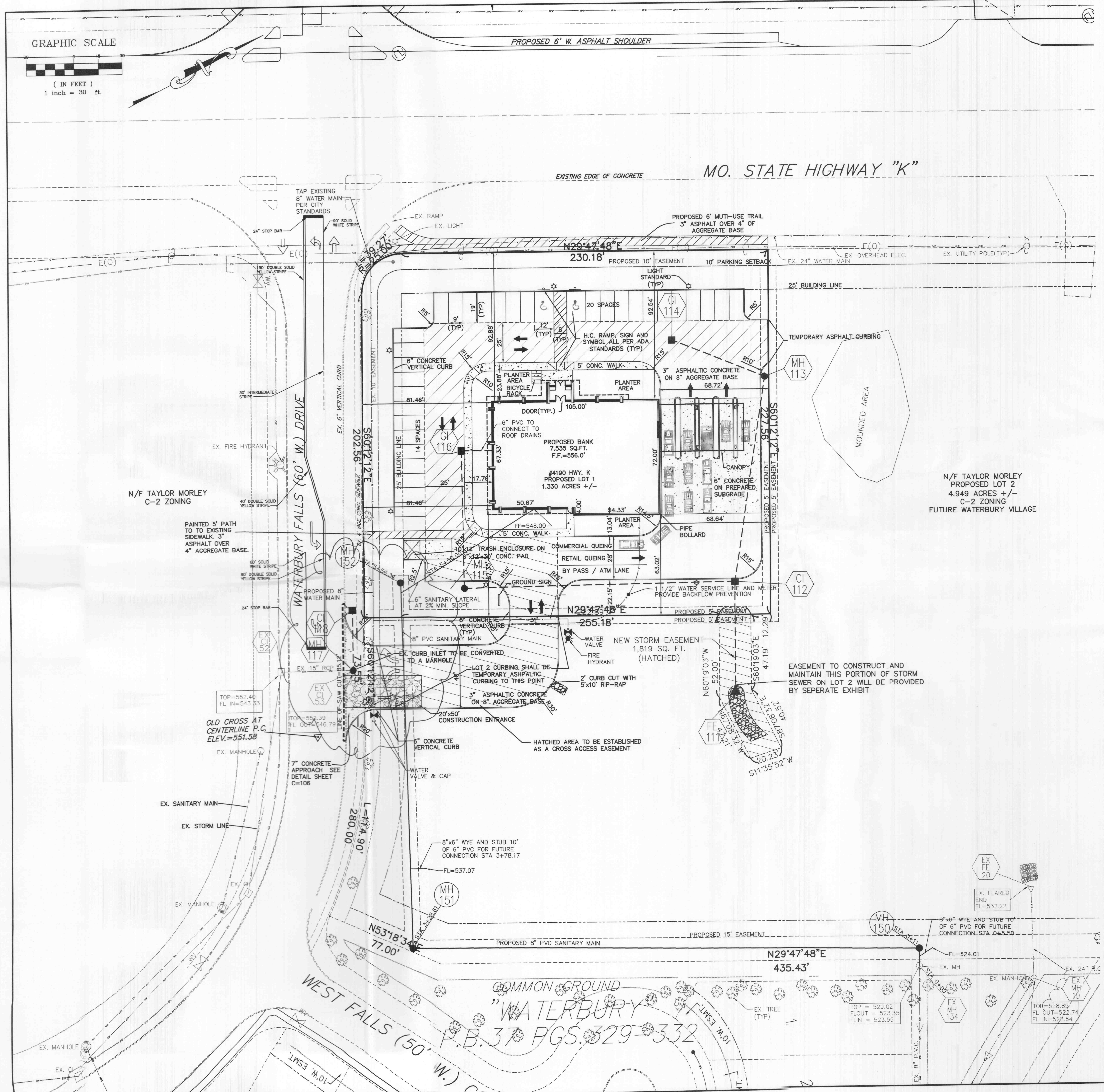
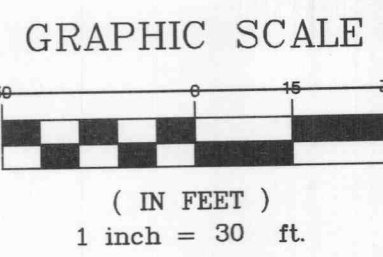

N/F TAYLOR MORLEY
 PROPOSED LOT 2
 4.949 ACRES +/-
 C-2 ZONING
 FUTURE WATERBURY VILLAGE

EASEMENT TO CONSTRUCT AND
 MAINTAIN THIS PORTION OF STORM
 SEWER ON LOT 2 WILL BE PROVIDED
 BY SEPARATE EXHIBIT

\DWG\9500PLUS\9713EA JEFFERSON BANK CONSTRUCTION\9713EA.CON.dwg, SITE PLAN(2), 2/12/2004 8:06:12 AM, Station 25 LDW

UNDERGROUND UTILITIES HAVE BEEN PLOTTED FROM AVAILABLE INFORMATION AND THEREFORE THEIR LOCATIONS SHALL BE CONSIDERED APPROXIMATE ONLY. THE VERIFICATION OF THE LOCATION OF ALL UNDERGROUND UTILITIES, EITHER SHOWN OR NOT SHOWN ON THESE PLANS SHALL BE THE RESPONSIBILITY OF THE CONTRACTOR, AND SHALL BE LOCATED PRIOR TO ANY GRADING OR CONSTRUCTION OF THE IMPROVEMENTS.