

REVISIONS
 11/10/03 DUCKETT CREEK
 11/11/03 CITY COMMENTS
 12/09/03 DUCKETT CREEK & CITY
 02/06/04 ENTRANCE CHANGE

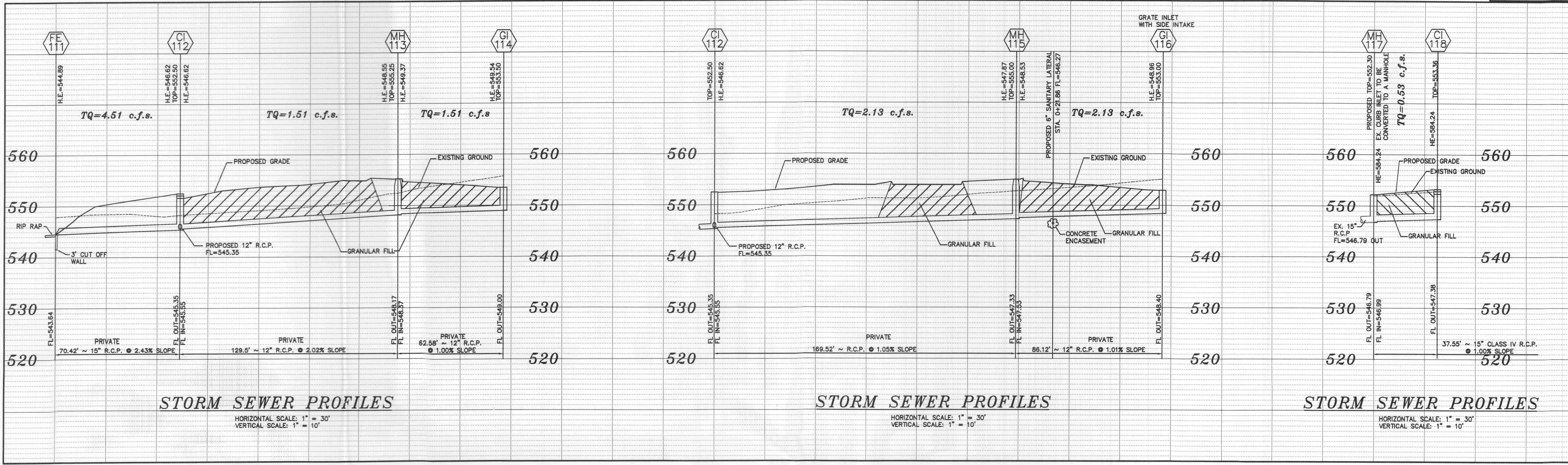

UPP STR	LOW STR	L	DIA	UPPER FL LN	LOWER FL LN	PS	UPPER ST EL	DEPTH HY GR	UPPER HY EL	LOWER HY EL	HYDR GRADE	FR HEAD	VEL	VEL HEAD	JUNC LOSS	TURN LOSS	TQ	PIPE CAP	REMARKS
GI 116	MH 115	86	12	548.40	547.53	1.01	552.70	3.74	548.96*	548.53	.00360	0.31	2.71	0.11	0.11	0.00	2.13	3.58	1
MH 115	CI 112	170	12	547.33	545.55	1.05	555.00	7.13	547.87*	546.55	.00360	0.61	2.71	0.11	0.08	0.08	2.13	3.65	2
GI 114	MH 113	63	12	549.00	548.37	1.01	553.50	3.96	549.54	549.37	.00180	0.11	1.92	0.06	0.06	0.00	1.51	3.57	3
MH 113	CI 112	130	12	548.17	545.55	2.02	555.25	6.71	548.55*	546.55	.00180	0.23	1.92	0.06	0.04	0.04	1.51	5.07	4
CI 112	FE 111	73	15	545.35	543.64	2.33	552.50	6.56	545.94*	544.89	.00490	0.36	3.68	0.21	0.18	0.08	4.51	9.87	5
CI 118	MH 117	38	15	547.38	546.99	1.04	553.36	5.12	548.24	548.24	.00010	0.00	0.43	0.00	0.00	0.00	0.53	6.58	6
MH 117	EX CI	45	15	546.79	543.33	7.67	552.30	5.39	546.92*	544.58	.00010	0.00	0.43	0.00	0.00	0.00	0.53	17.89	7

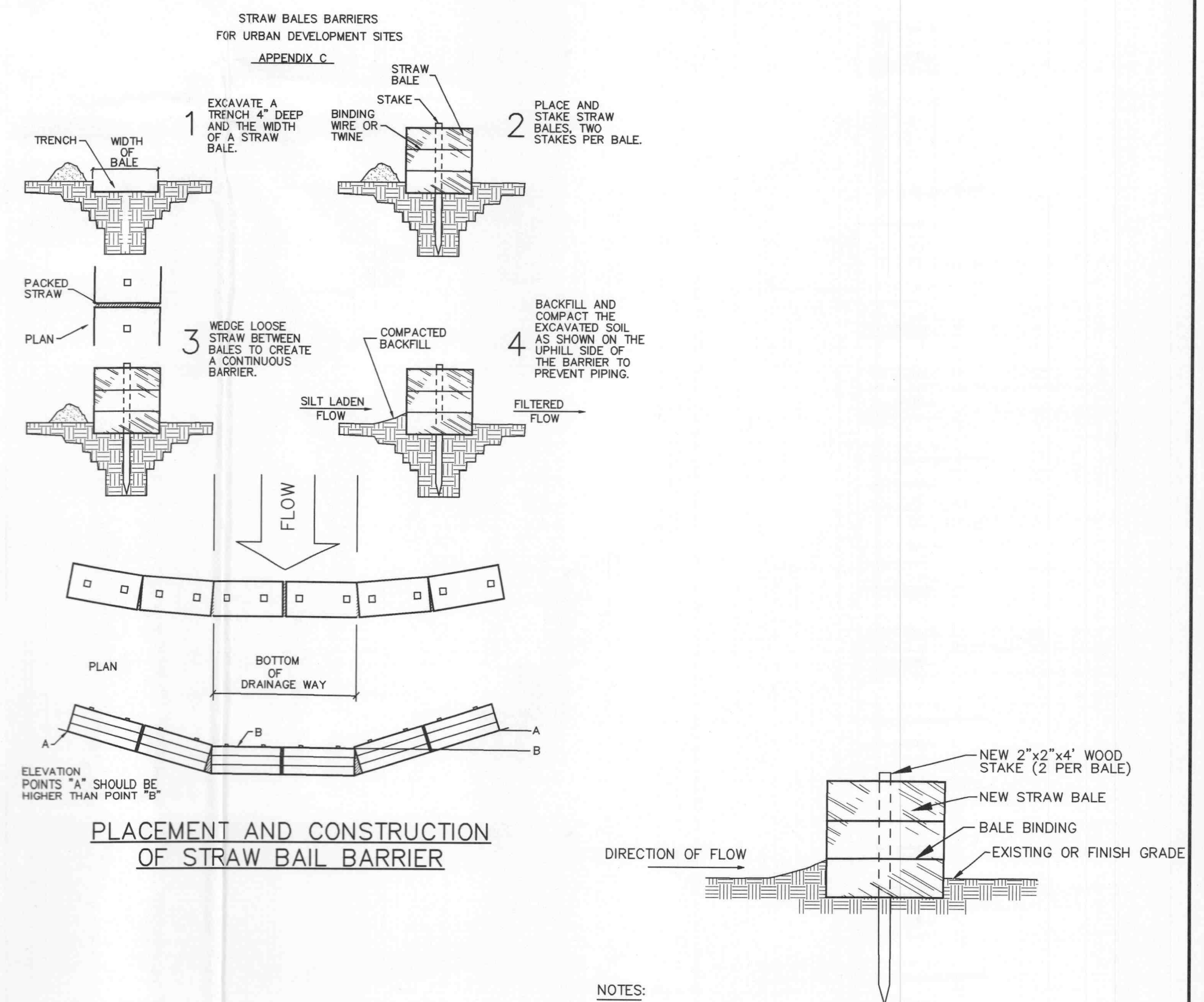
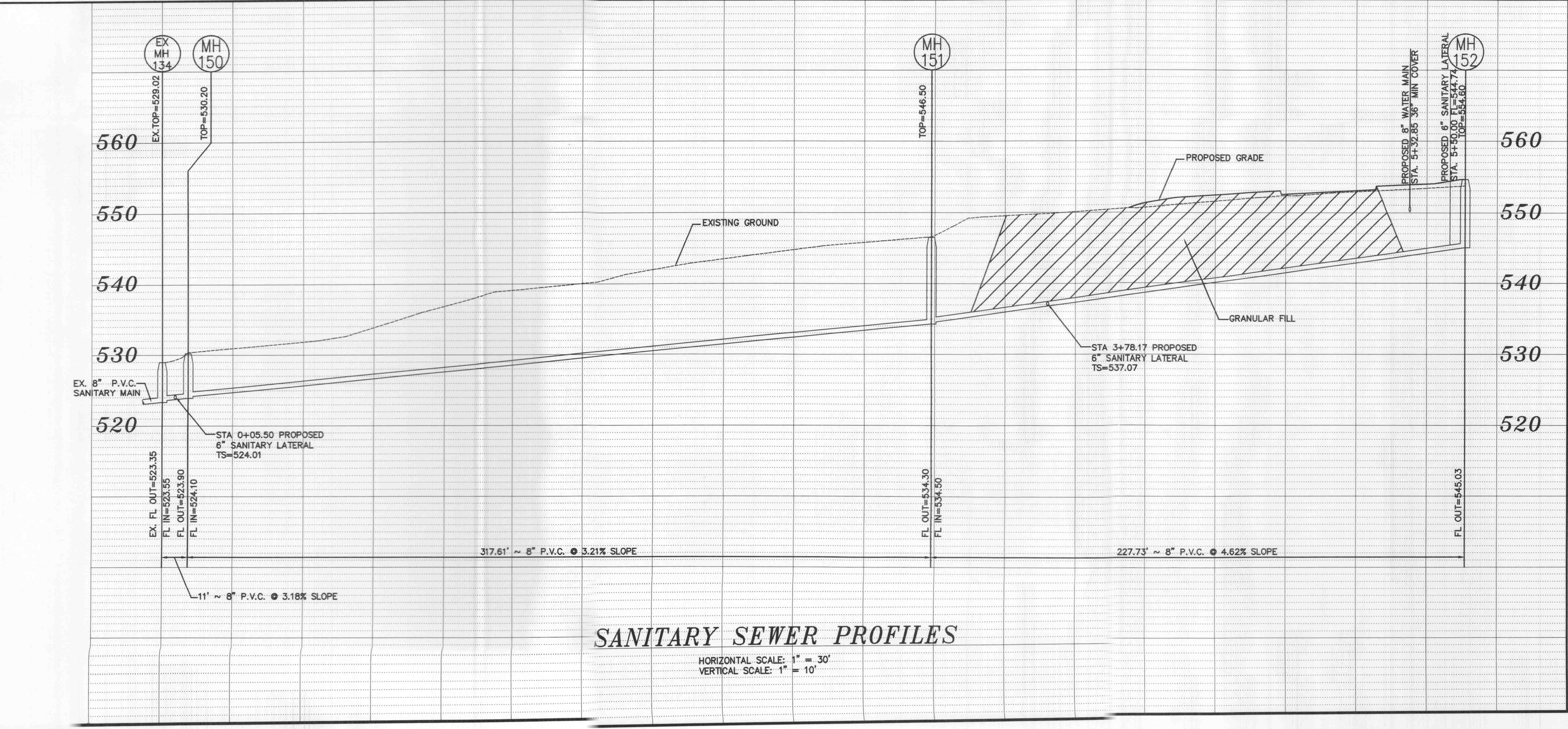

UNDERGROUND UTILITIES HAVE BEEN PLOTTED FROM AVAILABLE INFORMATION AND THEREFORE THEIR LOCATION(S) SHALL BE CONSIDERED APPROXIMATE ONLY. THE VERIFICATION OF THE LOCATION OF ALL UNDERGROUND UTILITIES, EITHER SHOWN OR NOT SHOWN ON THESE PLANS SHALL BE THE RESPONSIBILITY OF THE CONTRACTOR, AND SHALL BE LOCATED PRIOR TO ANY GRADING OR CONSTRUCTION OF THE IMPROVEMENTS.