

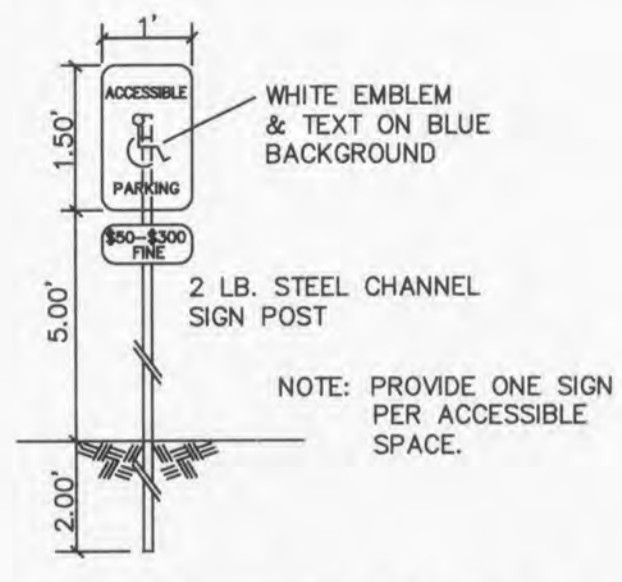

HANDICAP SIGN DETAIL
(N.T.S.)

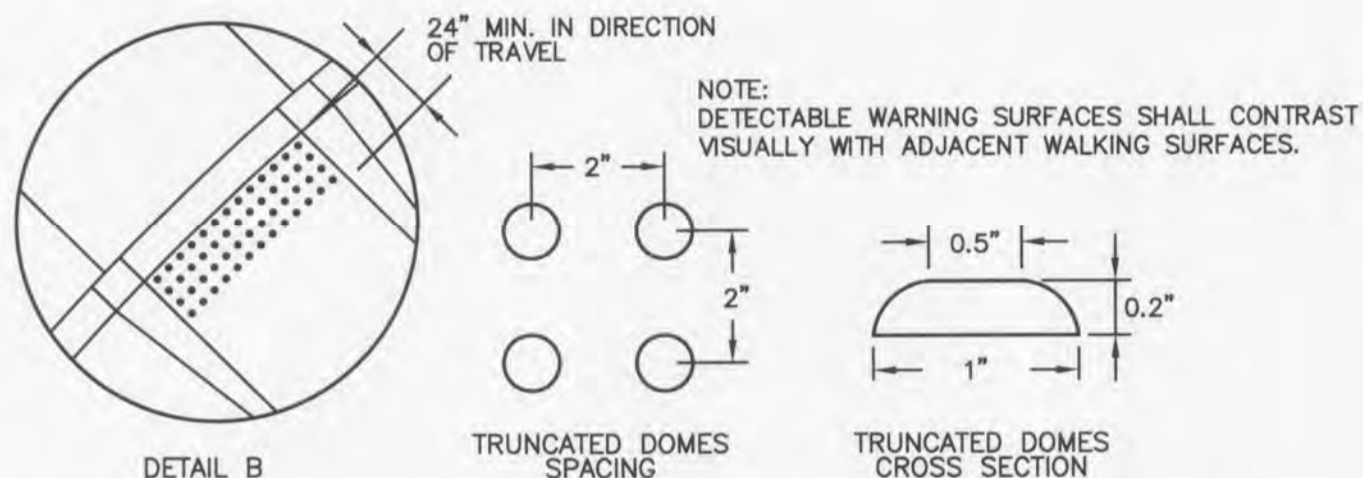

HANDICAP PARKING SIGN DETAIL
(N.T.S.)



DETECTABLE WARNING AT SIDEWALK RAMPS

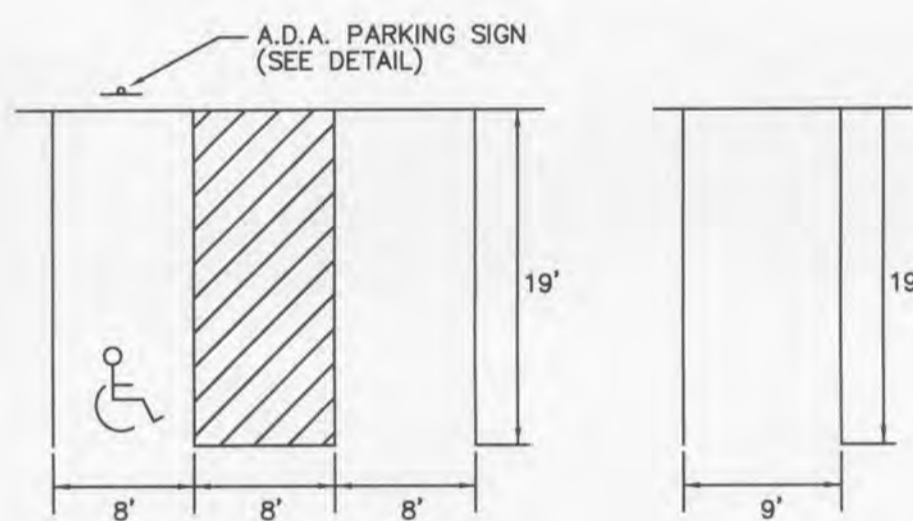

STANDARD PARKING STALLS DETAIL
(N.T.S.)

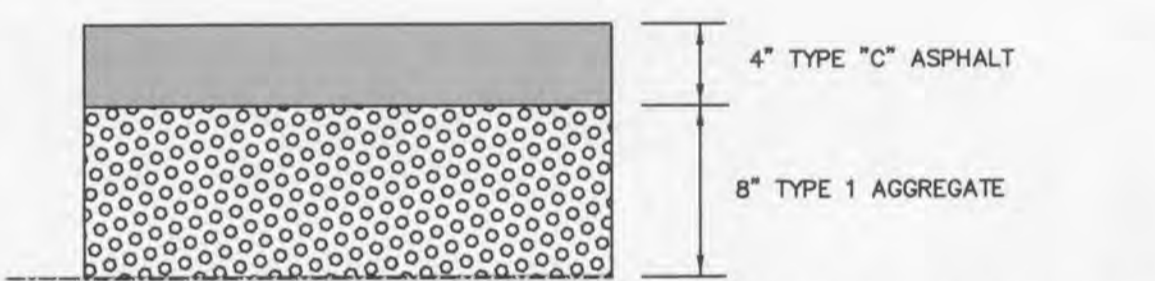

ASPHALT PAVEMENT DETAIL
(HEAVY DUTY - DRIVE AISLES)
(N.T.S.)

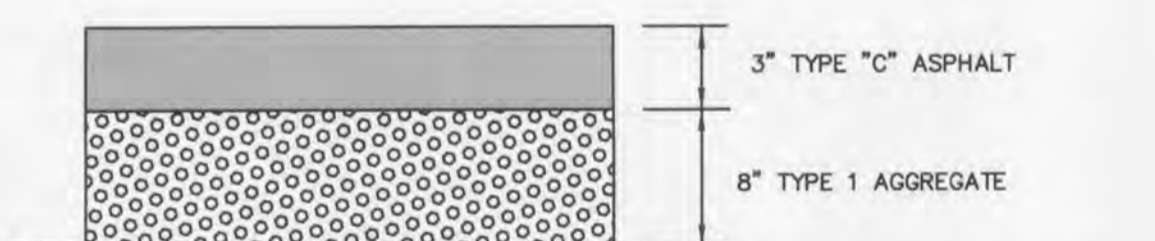

ASPHALT PAVEMENT DETAIL
(LIGHT DUTY - CAR PARKING)
(N.T.S.)

- NOTE:**
- 1.) ALL NON-REINFORCED CONCRETE SHALL BE 4000 PSI AT 28 DAYS
 - 2.) ALL ASPHALT SURFACES SHALL BE COMPACTED TO 98% MAXIMUM DENSITY.

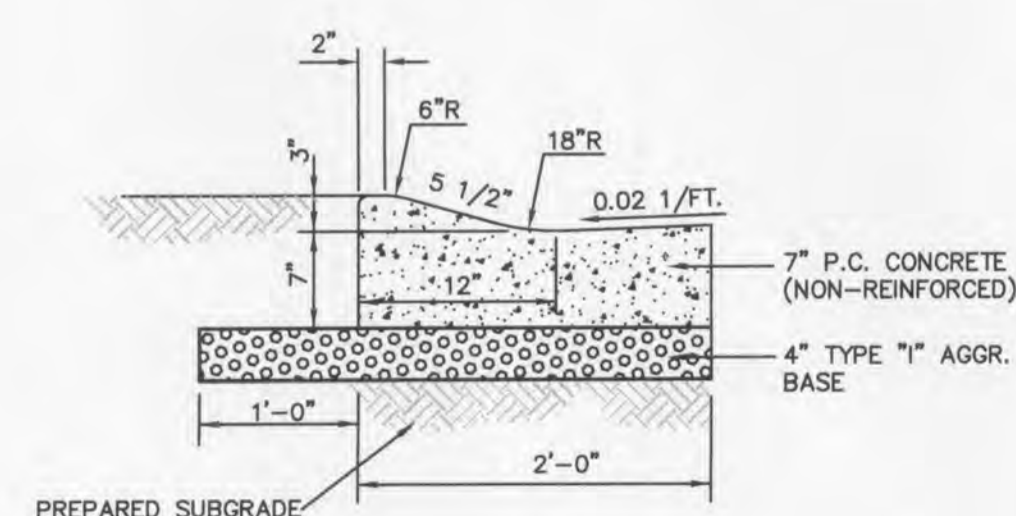

ROLLED CURB AND GUTTER DETAIL
(N.T.S.)

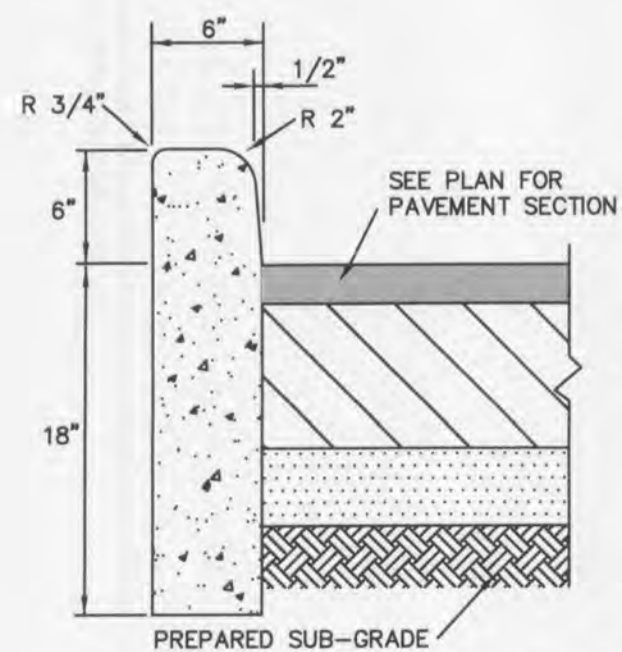

TYPE S CONCRETE CURB
(N.T.S.)

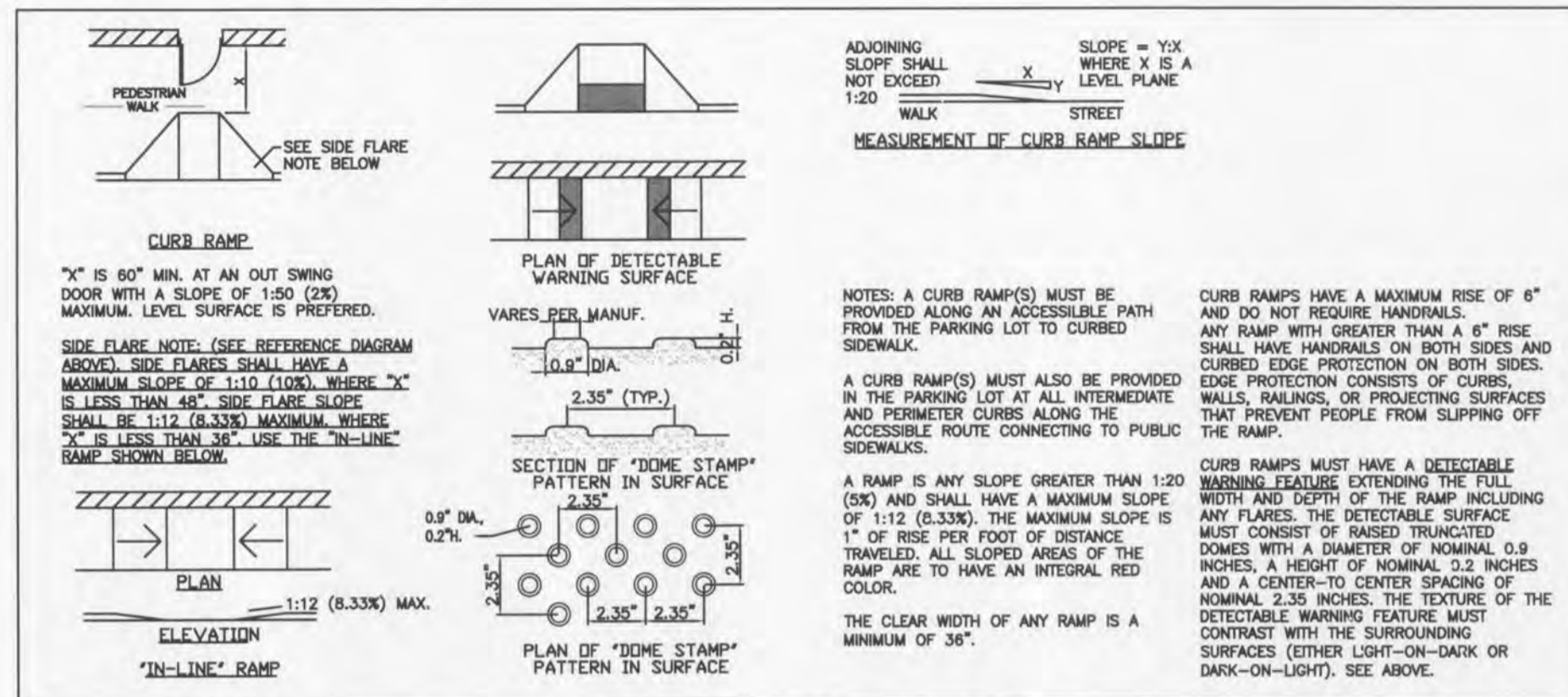

HANDICAP RAMP DETAILS

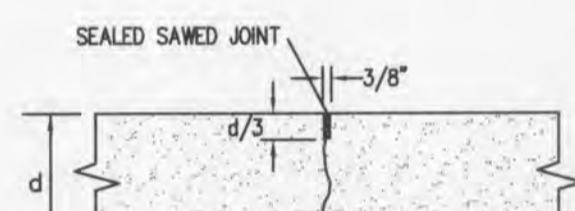

CONTROL JOINT

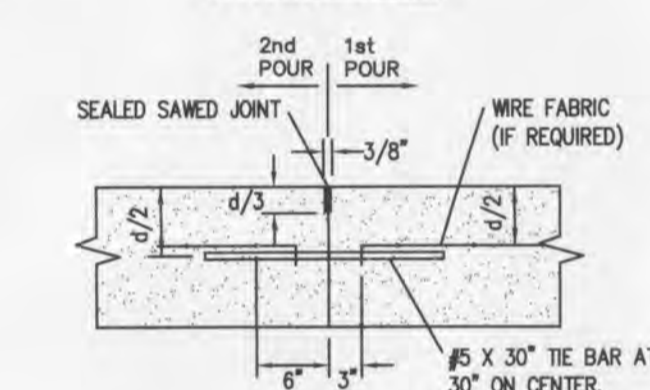

LONGITUDINAL JOINT

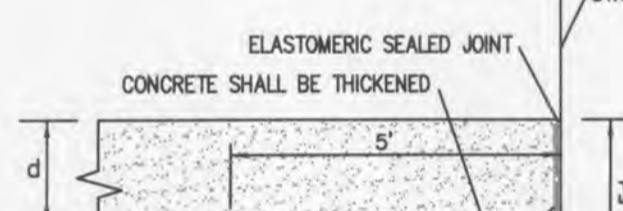

ISOLATION JOINT

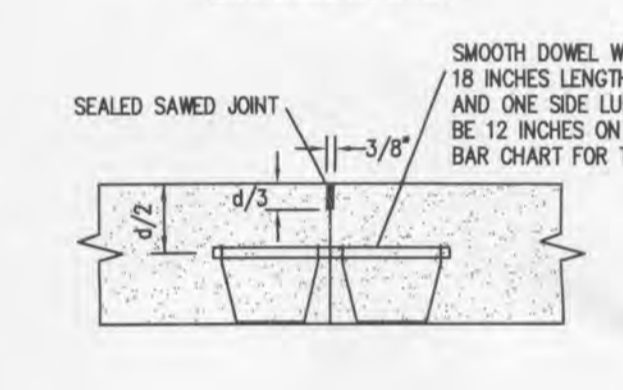

CONSTRUCTION JOINT

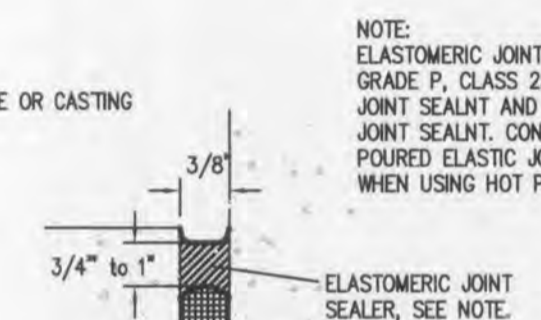

ISOLATION JOINT DETAIL

CONSTRUCTION, CONTROL AND LONGITUDINAL JOINT DETAIL

JOINT DETAILS
(N.T.S.)

PAVEMENT THICKNESS	BAR SIZE	
	DIAMETER	LENGTH
7 INCHES	1 INCH	18 INCHES
8 INCHES	1 INCH	18 INCHES
9 INCHES	1-1/4 INCHES	18 INCHES
10 INCHES	1-1/4 INCHES	18 INCHES
11 INCHES or <	1-1/2 INCHES	18 INCHES

NOTE: PAVEMENT SECTIONS TO BE VERIFIED BY GEOTECHNICAL ENGINEER

CONCRETE PAVEMENT DETAIL
(ALTERNATE HEAVY DUTY - DRIVE AISLES)
(TRASH DUMPSTER PAD)
(N.T.S.)

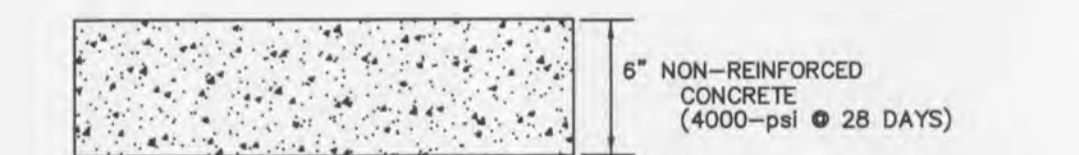

CONCRETE PAVEMENT DETAIL
(ALTERNATE LIGHT DUTY - CAR PARKING)
(N.T.S.)

NOTE: PAVEMENT SECTIONS TO BE VERIFIED BY GEOTECHNICAL ENGINEER

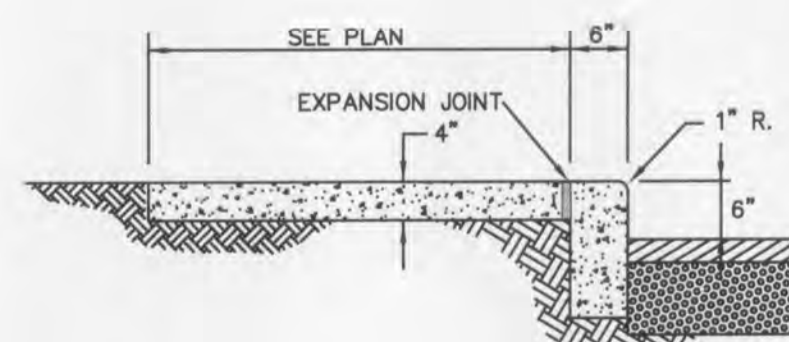

- NOTES:**
1. ALL CONCRETE SHALL BE MIN. FC=3000 P.S.I. (UNLESS OTHERWISE NOTED)
 2. ANY UNSUITABLE SOIL (AS DETERMINED BY SOILS ENGINEER) BELOW STRUCTURE SHALL BE REMOVED AND REPLACED WITH SELECT EARTHEN MATERIAL COMPACTED IN PLACE WITH VIBRATORY TAMPER.
 3. ALL EXPOSED CONCRETE EDGES TO HAVE 3/4" CHAMFER.
 4. DIMENSIONS SHOWN ARE TO FACE OF CURBS.
 5. EXPANSION JOINT MATERIAL SHALL BE INSTALLED IN THE WALK FOR ITS FULL WIDTH AND DEPTH AT INTERVALS OF APPROX. 15'. CONTROL JOINTS AT INTERVALS OF 1.5 TIMES ITS WIDTH.
 6. REFER TO ARCHITECTURAL LANDSCAPE PLAN FOR ADDITIONAL DECORATIVE JOINTING DETAIL AND FINISH INFORMATION.

INTEGRAL CONCRETE SIDEWALK & CURB
(N.T.S.)

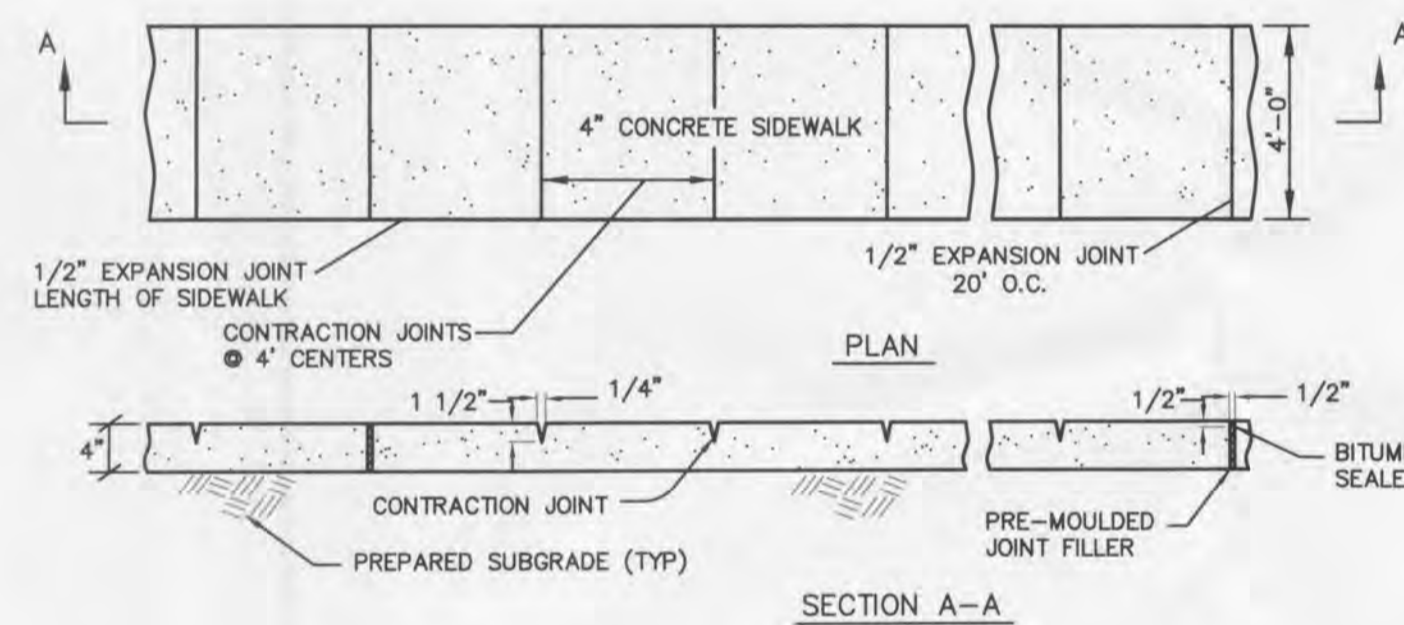

CONCRETE SIDEWALK DETAIL
(N.T.S.)

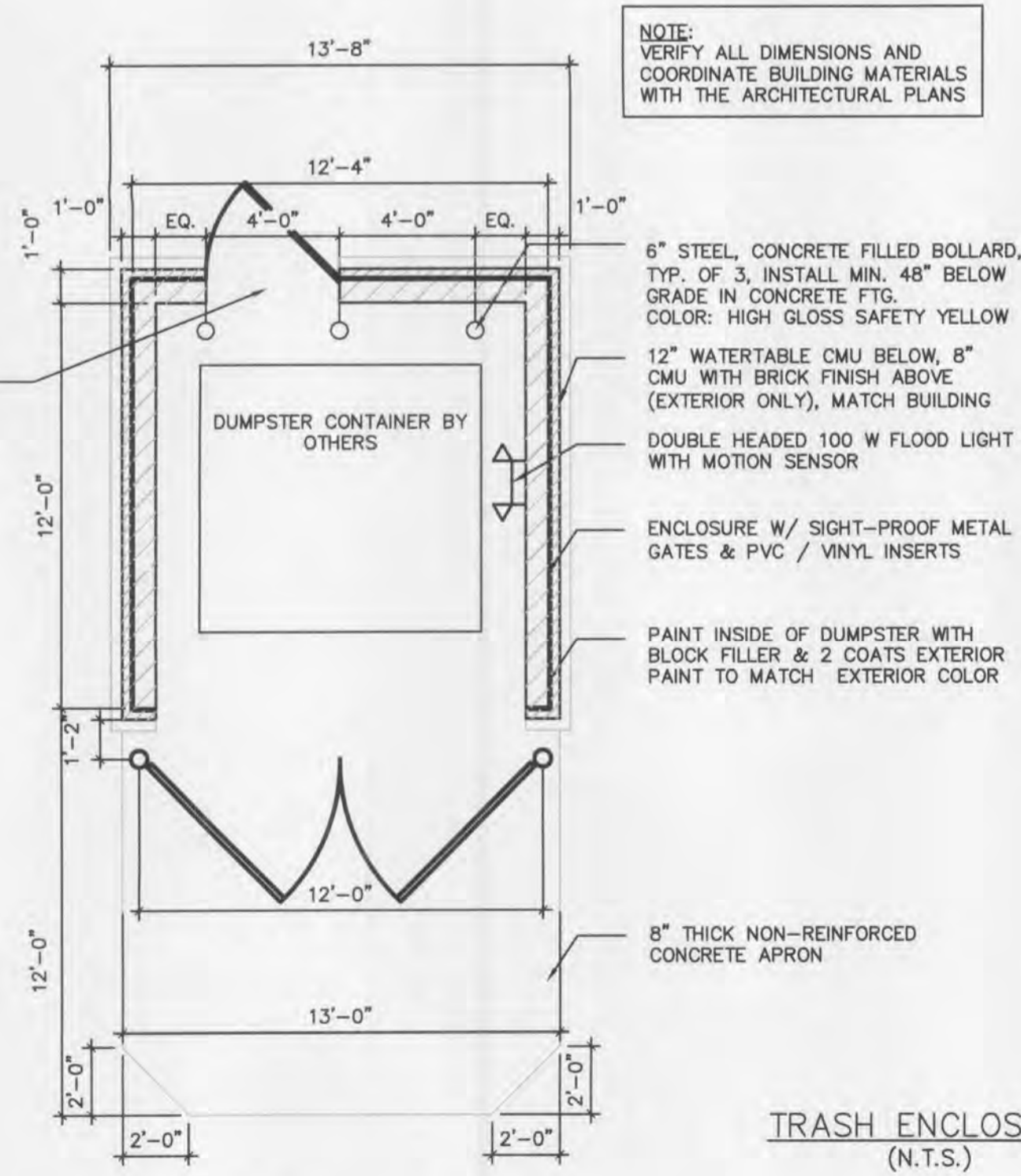

PLAN VIEW

TRASH ENCLOSURE
(N.T.S.)

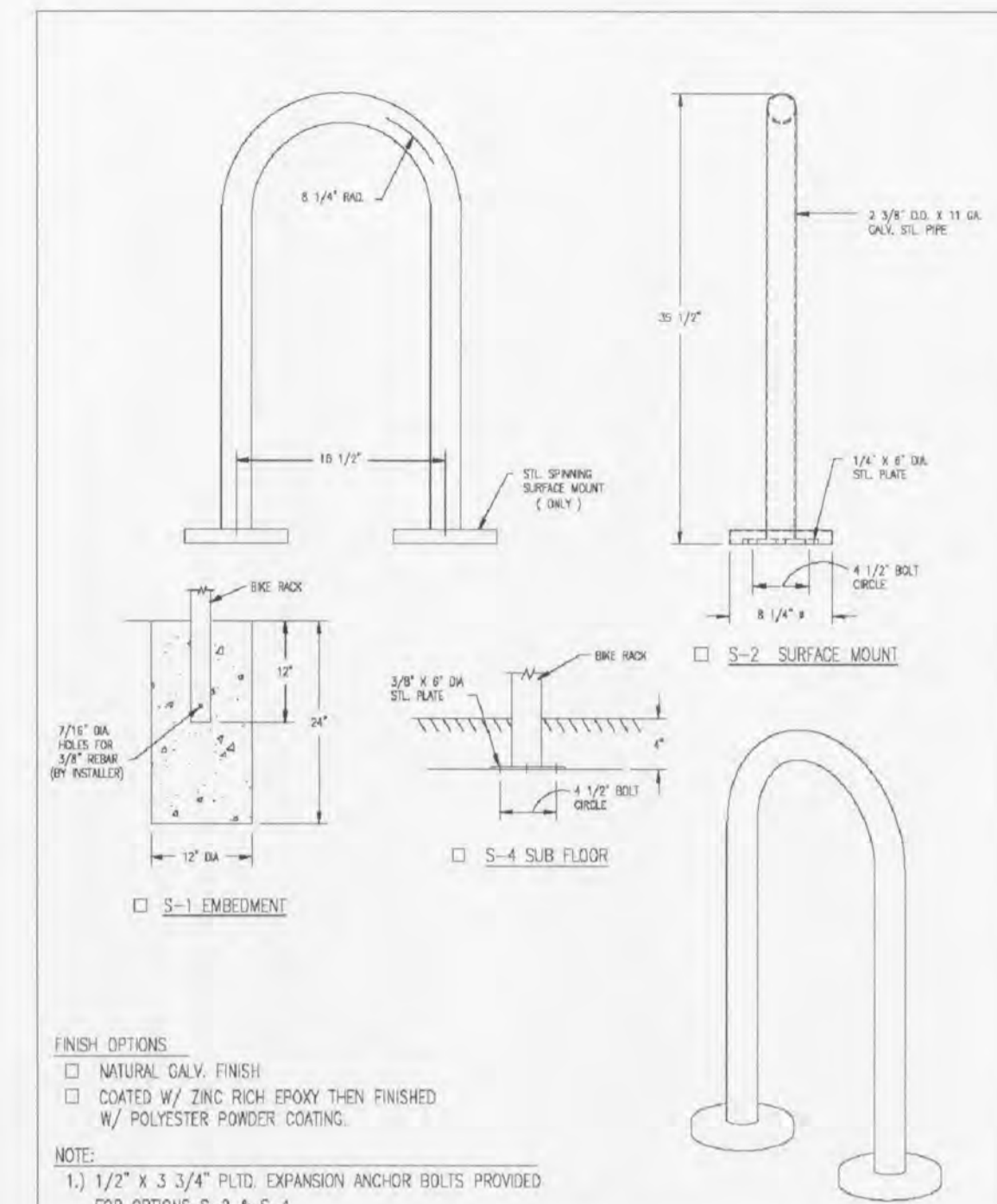

BIKE RACK DETAIL
(N.T.S.)

FINISH OPTIONS:

- NATURAL GALV. FINISH
- COATED W/ ZINC RICH EPOXY THEN FINISHED W/ POLYESTER POWDER COATING.

NOTE:
1.) 1/2" x 3/4" PLTD. EXPANSION ANCHOR BOLTS PROVIDED FOR OPTIONS S-2 & S-4.

SCALE:	TITLE:
NONE	LOOP BIKE RACK
DATE DRAWN: 3/22/14	DATE REV: 3/22/14
DATE APPR: 3/22/14	DATE APPR: 3/22/14

DuMar, inc.
P.O. Box 142 Millersville, PA 17559-0142

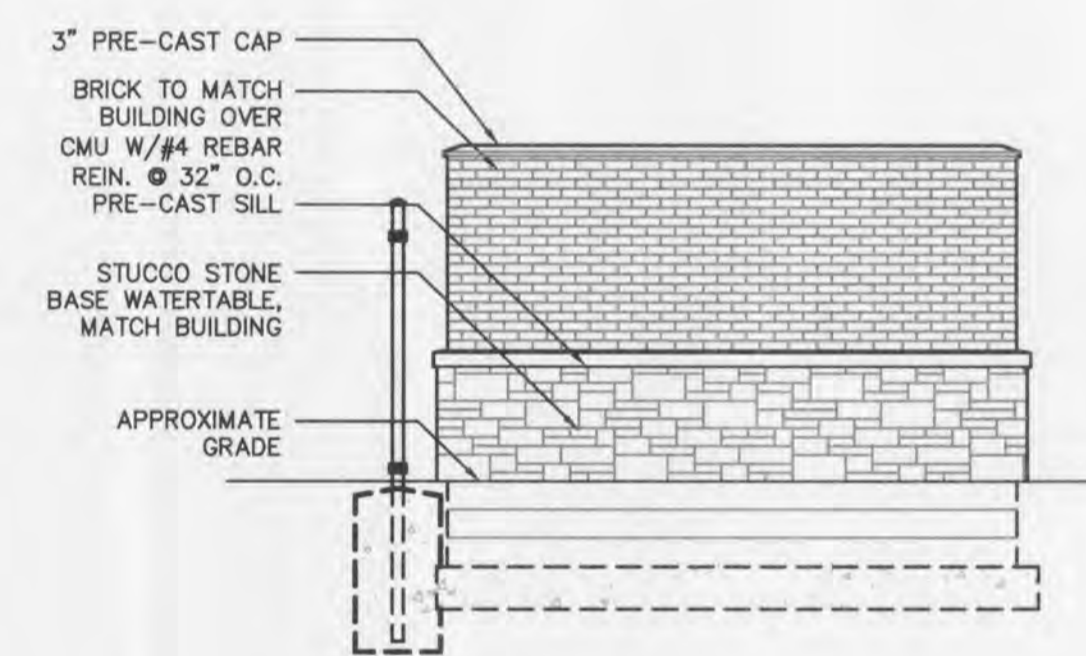

SIDE ELEVATION

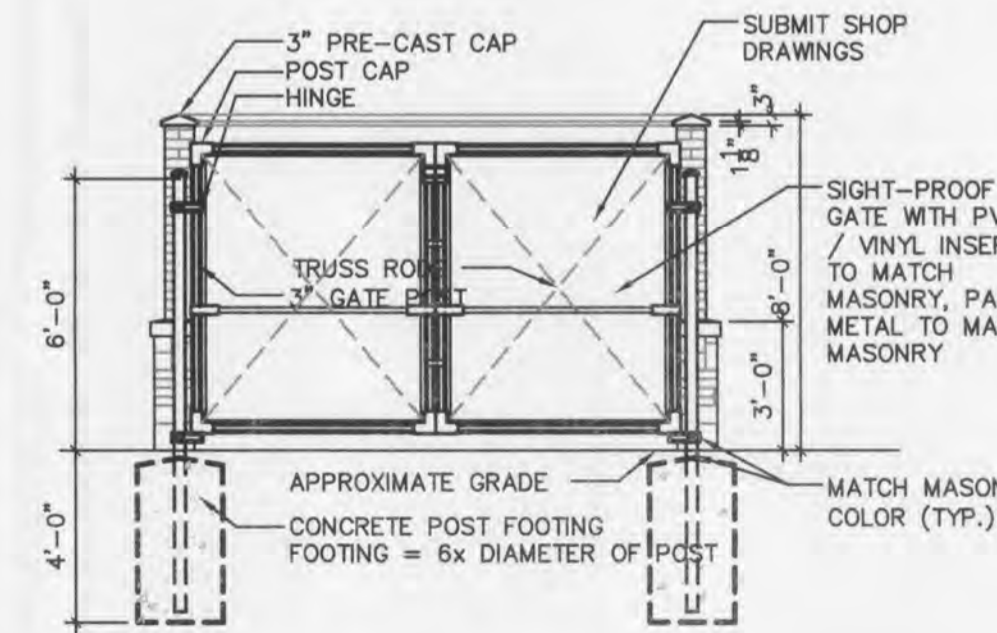

FRONT ELEVATION

- NOTES:**
1. ALL FOOTINGS SHALL BE 3000 P.S.I. CONCRETE.
 2. INSTALL PVC / VINYL INSERTS ON GATE FRAME TO MATCH BRICK & MAKE GATE SIGHT-PROOF.
 3. INTERMEDIATE RAIL REQUIRED FOR GATE.
 4. GATE & ALL HARDWARE TO BE PROVIDED PER ARCHITECTURAL DRAWINGS. SEE APPROVED ARCHITECTURAL PLANS.
 5. CONTRACTOR TO VERIFY APPROVAL OF ALL MATERIALS WITH DEVELOPER & BUILDING DEPARTMENT PRIOR TO CONSTRUCTION.

Kiddie Academy
LOTS 2 & 3 OF LAKEVIEW SHOPPING CENTER
4088 WINGHAVEN BLVD.
STATE OF MISSOURI

STOCK & ASSOCIATES
Consulting Engineers, Inc.
257 Chesterfield Business Parkway
St. Louis, MO 63105 PH: (636) 530-9000 FAX: (636) 530-9180
e-mail: general@stockassoc.com
Web: www.stockassoc.com



GEORGE M. STOCK E-25116
CIVIL ENGINEER
CERTIFICATE OF AUTHORITY
NUMBER: 000996

Developer / Owner (Under Contract)
Chesterfield Childcare Properties, LLC
23 Boop Lane
St. Louis, Mo 63131

Facility Operator
Concord Properties, LLC
23 Boop Lane
St. Louis, Mo 63131

DATE:	BY:	REVISIONS:
01/15/13	A.C.D.	G.M.S.
REVISIONS:		
1	02/05/13	- CITY/WATER REVISIONS
2	03/12/13	- CITY REVISIONS
3	03/26/13	- CITY REQUIRED SETS

P+Z No. 9831.41.04
(APPROVED JANUARY 4, 2013)

City No.

Page No.
C7.0

CONSTRUCTION DETAILS