

FRANCHISEE
Tom Keller

MEP ENGINEER



DAVID W. MULLEN, PE
143 E MAIN STREET - SUITE 201
COLUMBUS, OHIO 43215
614-225-1580
dave@emengineeringgroup.com

All drawings and written material appearing herein constitute the original and unpublished work of the Architect and may not be duplicated, used, or disclosed without the prior written consent of the Architect.
© 2013 HAROLD C. BAKER, AIA.

This document is released for the sole purpose of Owner Review, Bidding & Permitting under the authority of Harold C. Baker, AIA on 02/08/13. It is not intended to be used for construction purposes until permits are issued.
Electronic (AutoCAD) files including: Architectural, Structural, Fire Protection, HVAC, Plumbing, & Electrical, will not be made available for use by the general contractor or the general contractor's subcontractors.

All contractors shall review all drawings and specifications. Contractors and subcontractors are responsible for complete review. Items affecting all trades are placed throughout the set of drawings. No "extras" for missed items in other sections will be permitted. The contractor shall promptly notify the Architect of any ambiguity, inconsistency or error which they discover upon examination of the contract documents, the site, or local conditions. General contractor shall distribute complete sets of drawings to all subcontractors. Do not separate drawings by discipline.
DO NOT SCALE DRAWINGS. USE DIMENSIONS PROVIDED ON DRAWINGS.

MARK	REVISION	REVISION DESCRIPTION
△	03/19/13	Code comments & misc. revisions

MARK	ADDENDUM	ADDENDUM DESCRIPTION
△	11/30/12	SCHEMATIC DESIGN 02/08/13 PERMIT
△		30% OWNER REV. 02/08/13 BIDDING
△		CITY SUBMISSION 03/21/13 CONSTRUCTION
△	02/08/13	KA & OWNER REV. RECORD



4088 WINGHAVEN BOULEVARD
O'FALLON, MO 63368

SITE PHOTOMETRIC PLAN



HAROLD C. BAKER, AIA
ARCHITECT

673 High Street, Suite 204, Worthington, Ohio 43085 614.436.0555
email: baker@bakerarchitects.com

	Drawn By: JM
	Checked By: JE
	Project Number: 1221 SP201
	Scale: AS NOTED

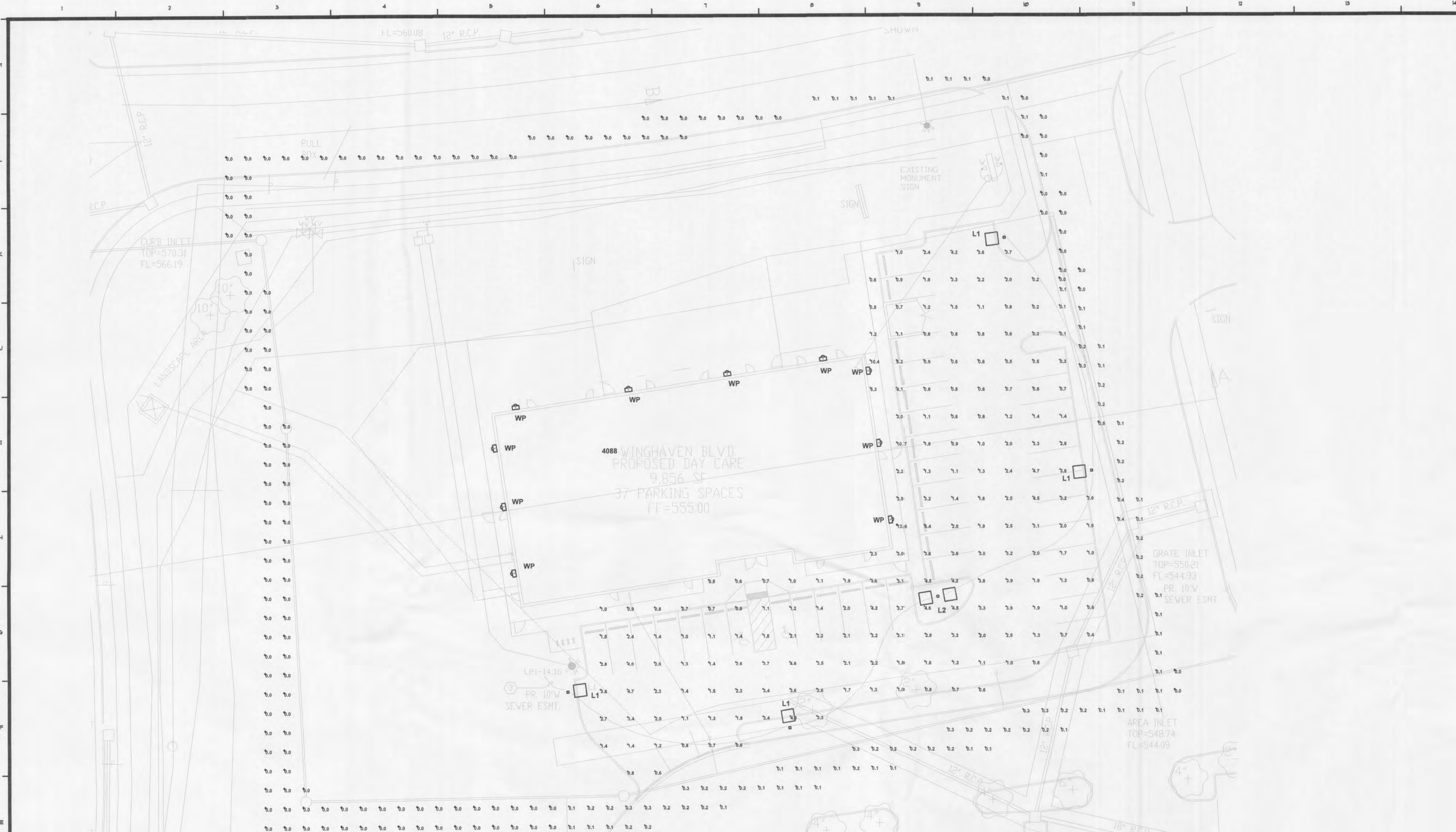

(APPROXIMATE LOCATION FIELD LOCATED) STORM SEWER STUB
A SITE ELECTRICAL PLAN
1"=20'-0"

Symbol	Label	Qty	Catalog Number	Description	Lamp	File	Lumens	LLF	Watts
□	L1	4	KSF2 250M R4SC (PULSE START)	Specification Area Luminaire, 250W Metal Halide, R4SC Sharp Cutoff Reflector, Full Cutoff MEETS THE 'NIGHTTIME FRIENDLY' CRITERIA	ONE (1) 250 WATT CLEAR BT28 PULSE START METAL HALIDE LAMP IN HORIZONTAL POSITION	KSF2_250M_R ASC_(PULSE_START).ies	22500	0.81	288
□	L2	1	KSF2 250M R4SC (PULSE START)	Specification Area Luminaire, 250W Metal Halide, R4SC Sharp Cutoff Reflector, Full Cutoff MEETS THE 'NIGHTTIME FRIENDLY' CRITERIA	ONE (1) 250 WATT CLEAR BT28 PULSE START METAL HALIDE LAMP IN HORIZONTAL POSITION	KSF2_250M_R ASC_(PULSE_START).ies	22500	0.81	576
⌂	WP	6	TWAC 100M	SPECIFICATION BUILDING MOUNTED LUMINAIRE, 100W MH, W/CLEAR LAMP.	ONE 100-WATT CLEAR ED-17 METAL HALIDE, HORIZONTAL POSITION.	TWAC_100M.L es	8500	0.81	140

STATISTICS						
Description	Symbol	Avg	Max	Min	Max/Min	Avg/Min
Parking Lot	+	2.1 fc	13.6 fc	0.0 fc	N / A	N / A
Property Line	+	0.1 fc	0.5 fc	0.0 fc	N / A	N / A