

GRADING NOTES

- All straw bales must be countersunk a minimum of 3" and additional straw bales shall be placed at the direction of the city.
- The contractor shall restore offsite construction areas to an equal or better condition than existed prior to commencement of construction.
- Earth subgrade for paved areas must be compacted to 90% of maximum dry density as determined by a "Modified Proctor Test," (ASTM D-1557), and must be inspected and approved by a City Representative, before paving may commence.
- Earth subgrade for building areas must be compacted to 90% of maximum dry density as determined by a "Modified Proctor Test," (ASTM D-1557).
- All grade shall be within 0.2 feet more or less of those shown on the grading plan.
- No slope shall be greater than 3:1 and shall be either sodded or seeded or mulched.
- All grading for this development shall conform to the recommendations contained in the report titled "Exploration of Subsurface Conditions and Foundation Recommendations", KIDS R KIDS DAYCARE FACILITY, prepared by Soils Consultants Inc., dated July, 1998.

NOTE:
ALL ELEVATIONS AND CONTOURS SHOWN ON THIS PLAN ARE TO TOP OF FINISHED GROUND OR PAVEMENT.

EXISTING ADJACENT ELEVATIONS AS SHOWN HAVE BEEN TAKEN FROM IMPROVEMENT PLANS PREPARED FOR THE PREVIOUS ADJACENT PROJECTS. IF DISCREPANCIES ARE FOUND CONTACT THE ENGINEER PRIOR TO PROCEEDING WITH WORK THAT MAY BE AFFECTED.

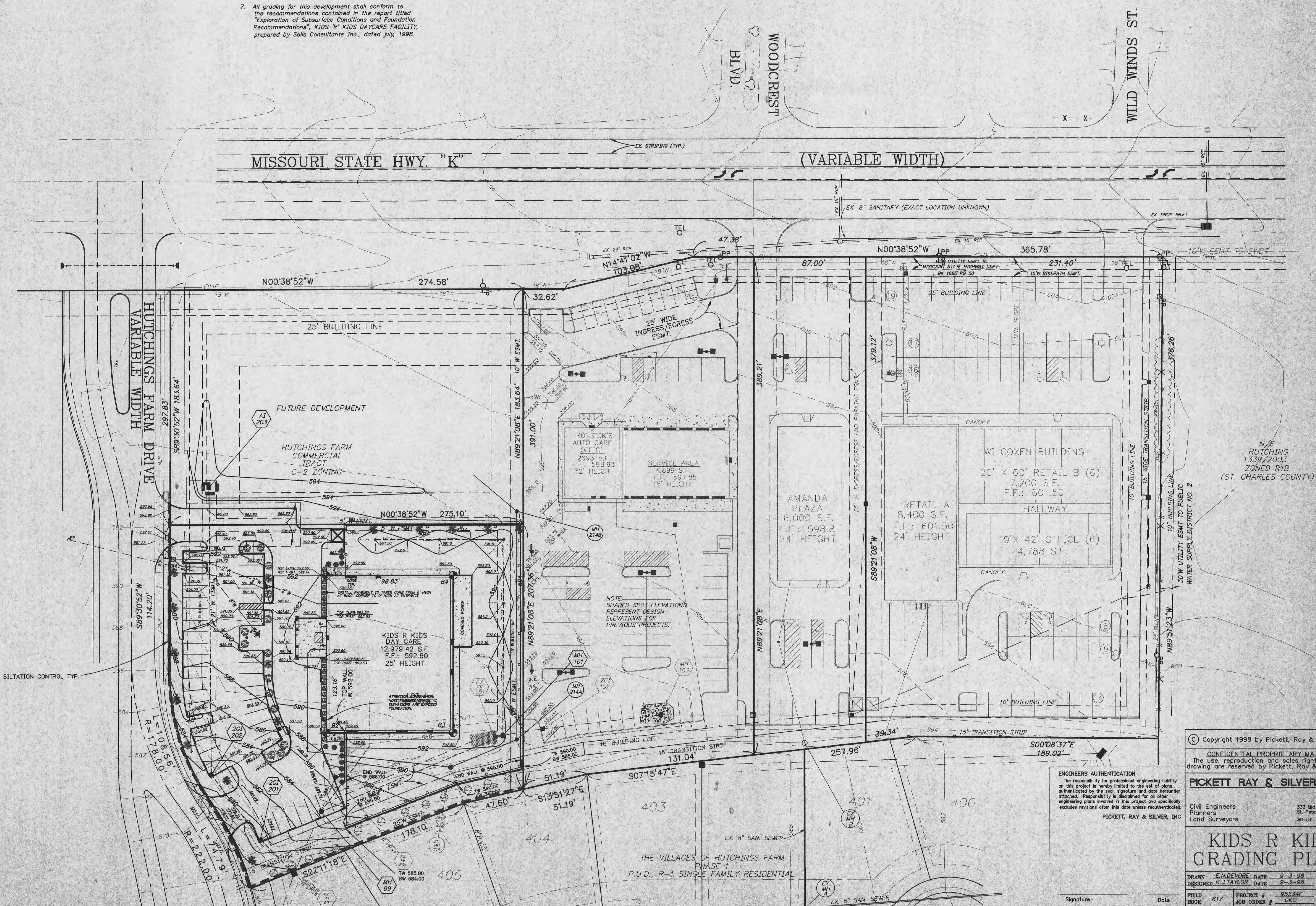
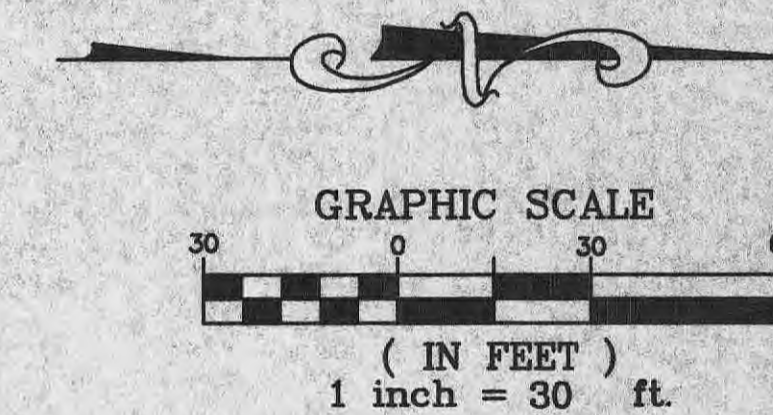

© Copyright 1998 by Pickett, Roy & Silver Inc.
CONFIDENTIAL PROPRIETARY MATERIAL
The use, reproduction and sales rights of this drawing are reserved by Pickett, Roy & Silver Inc.

PICKETT ROY & SILVER
Civil Engineers
Land Surveyors
333 Mid Rivers Mall Dr.
St. Peters, MO 63376
392-1211 FAX 397-1194

KIDS R KIDS GRADING PLAN

ENGINEERS AUTHENTICATION
The responsibility for professional engineering liability on this project is hereby limited to the set of plans authorized by the seal, signature and date hereunder attached. Responsibility is declined for all other engineering plans involved in this project and specifically excludes revisions other than those noted hereunder.

PICKETT, ROY & SILVER, INC.
Signature _____ Date _____

FIELD BOOK 617 PROJECT # 92234E JOB ORDER # DKO

3 5