

NOTE: SPOT ELEVATIONS ARE TO BACK OF CURB

T.o.P. = TOP OF PAVEMENT

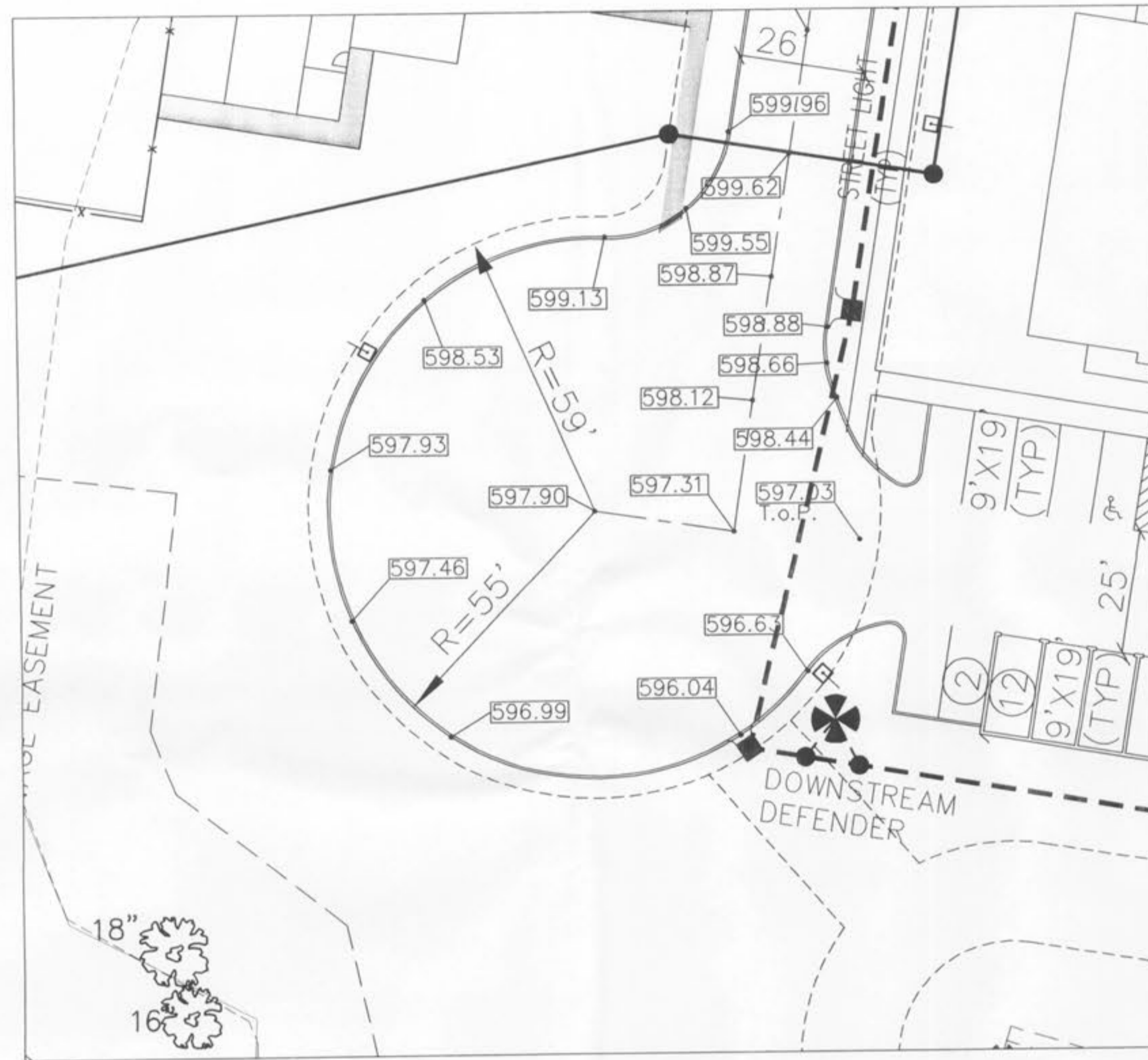

CUL-DE-SAC



ROUND-A-BOUT

12/24/07 revised per City comments
1/29/08 revised per City comments

WARPINGS
KING ARTHUR'S
HIGHLAND TERRACE
IMPROVEMENT PLANS

S C ST. CHARLES ENGINEERING & SURVEYING, INC.
801 S. FIFTH STREET, SUITE 202
ST. CHARLES, MO 63301
TEL: (636) 947-0607 FAX: (636) 947-2448

KARIM

ORDER NO.
07-0059-01
DATE
06/05/07