

EXISTING DRAINAGE AREA
SCALE: 1" = 40'

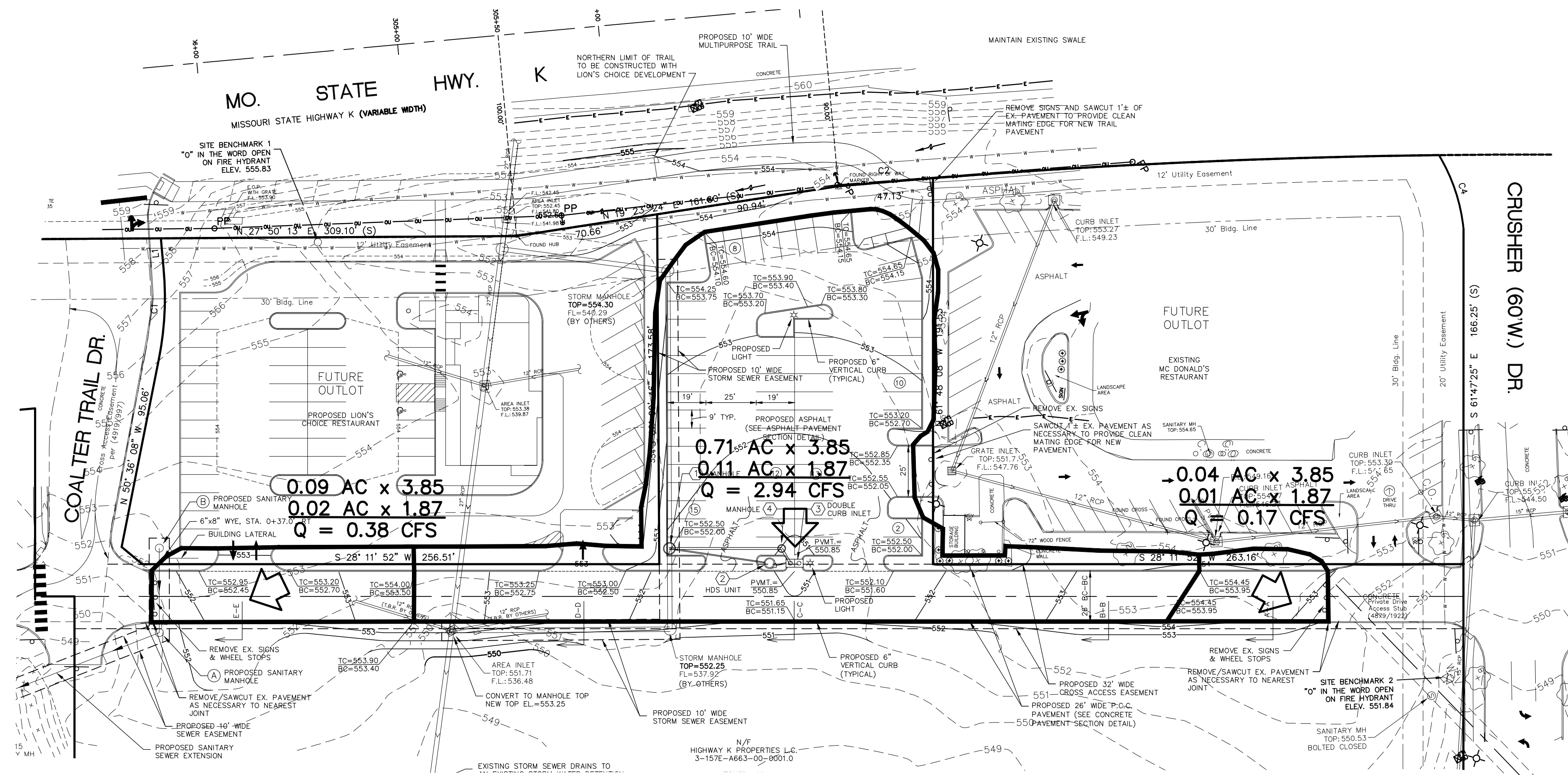
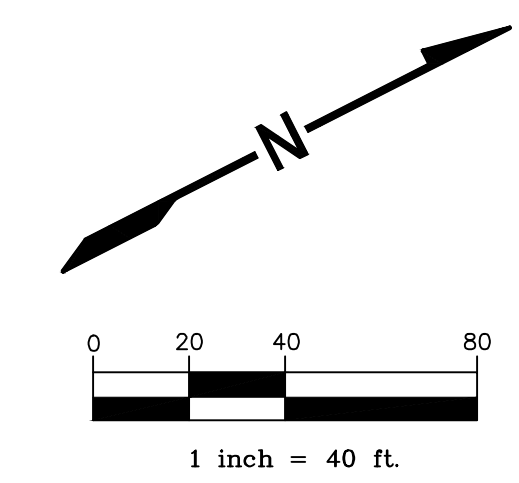

PROPOSED DRAINAGE AREA
SCALE: 1" = 40'

DIFFERENTIAL RUNOFF

| EXISTING CONDITIONS | |
|-----------------------|-----------------------------------|
| GRASS AREA: | 0.98 AC x 1.87 CFS/AC = 1.83 CFS |
| TOTAL: | 1.83 CFS |
| PROPOSED CONDITIONS | |
| PAVED SURFACE AREA: | 0.85 AC x 3.85 CFS/AC = 3.27 CFS |
| GRASS AREA: | 0.13 AC x 1.87 CFS/AC = 0.24 CFS |
| TOTAL: | 3.51 CFS |
| DIFFERENTIAL RUNOFF = | 3.51 - 1.83 = 1.68 CFS (INCREASE) |

CITY OF OFALLON
PUBLIC WORKS DEPARTMENT
ACCEPTED FOR CONSTRUCTION
BY: *James Hewitt* DATE: **09/18/2017**
PROFESSIONAL ENGINEER'S SEAL
INDICATES RESPONSIBILITY FOR DESIGN

FOR DRAINAGE AREAS ONLY - NOT FOR CONSTRUCTION

VANCE ENGINEERING, INC.
 MISSOURI STATE CERTIFICATE OF AUTHORITY NO. 2003022194
Vance Engineering, Inc.
 10537 Lackland Road
 St. Louis, MO 63114
 P: 314.427.1800
Highway K Properties L.C.
 14151 Clayton Road
 Town and Country, MO 63017

KINGSMILL CROSSING
DRAINAGE AREAS

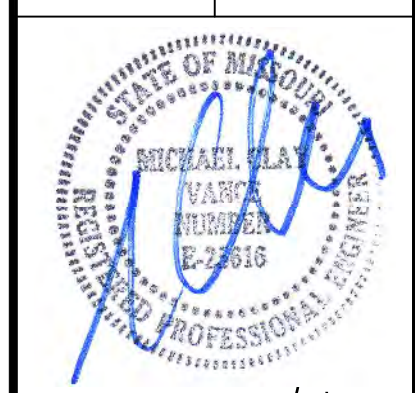

9/18/17
 MICHAEL CLAY VANCE, P.E.
 E-25616
 REVISED
 08/04/17 CITY
16078
 06/30/17
7/7
 COPYRIGHT 2017