

## Trash Guard® Installation Instructions

Trash Guard® can be installed in a variety of catch basin configurations (or field conditions). In general the Trash Guard® is mounted on the catch basin wall, centered over the outlet pipe.

Before installing Trash Guard®, a hydraulic calculation should be performed to determine maximum flow rate based on depth of the catch basin and size of Trash Guard® used. This calculated model will determine maximum flow rate with no obstructions or varying amounts of trash build up, and determine drainage area required to support the calculated flow rate. Allowable trash build up and drainage area required for trash build up will determine maintenance frequency.

If catch basin conditions allow and increased flow rate and additional vertical capacity are desired, a model can be calculated to determine flow rate when extending Trash Guard® from one inch to seven inches from the catch basin wall. As above, this calculated model will determine maximum flow rate with no obstructions or varying amounts of trash build up. Contact Trash Guard® for assistance in determining flow rate and drainage areas under varying field conditions.

The following instructions are organized in sections described as follows:

- Section 1 – Trash Guard® installed on a flat perpendicular wall with a flat bottom
- Section 2 – Bottom Plate installed on an inverted bottom
- Section 3 – Trash Guard® installed on a flat perpendicular wall with an inverted bottom
- Section 4 – Trash Guard® installed on tiered brick wall escalating width from top to bottom with an inverted or flat bottom.
- Section 5 – Trash Guard® installed on concave wall reasonable flat at top and bottom with an inverted or flat bottom.
- Section 6 – Trash Guard® installed extended from wall to increase flow capacity with an inverted or flat bottom.

### EXAMPLES OF FLAT AND INVERTED BOTTOMS

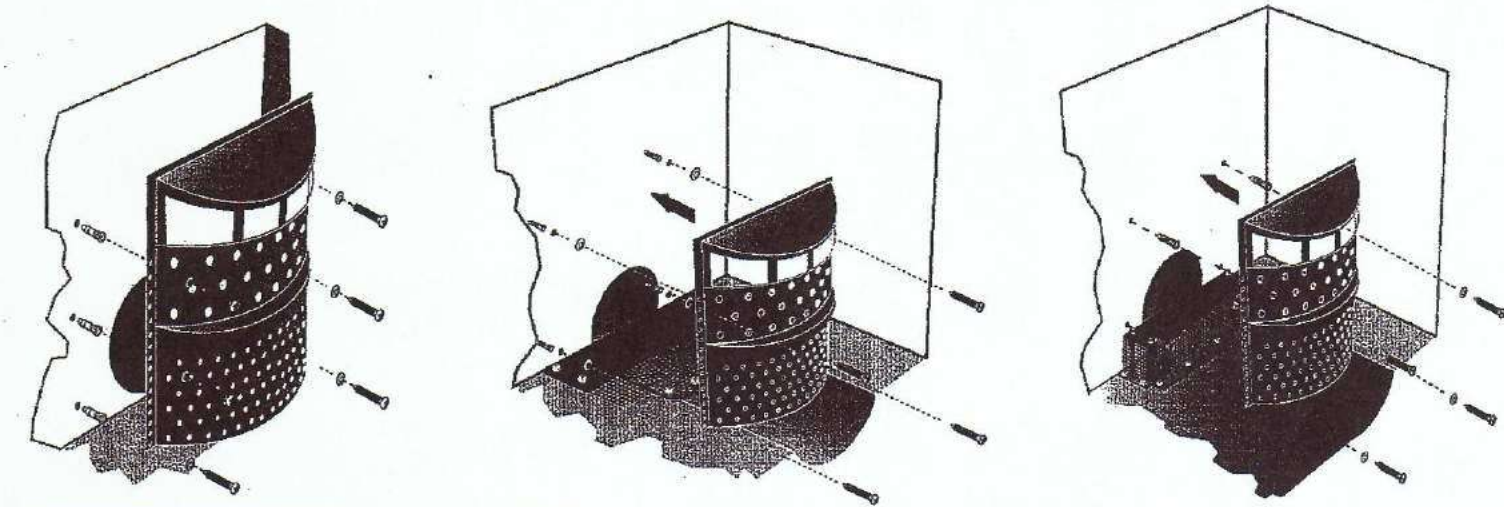

**WARNING:** Improper installation of the Trash Guard® or failure to keep the area around the Trash Guard® free from sediment, debris and litter after installation may result in clogging of the storm water drainage system and increase the risk of flooding during times of heavy rainfall. It is important to clear sediment, debris and litter from around the Trash Guard® at least four (4) times a year and more frequently in areas with large amounts of vegetation or litter. Please contact your local Trash Guard® distributor with any questions regarding the installation or regular maintenance requirements of the Trash Guard®.

### Section 1 (Diagram I)

- Items Included:
  - Trash Guard® (Chosen Size)
  - Seven Plastic Anchors
  - Seven Flat Washers
  - Seven 1.75" x .25" Stainless Steel Phillips Screws
- Tools Needed:
  - Cordless Hammer Drill
  - 5/16" Masonry Drill Bit
  - Phillips Screwdriver

### Installation Instructions

- Can be attached with or without retaining rails.
1. Place Trash Guard over outlet pipe.
  2. Drill 5/16" hole top and bottom each side.
  3. Insert plastic anchor and attach washer and phillips screws as shown in diagram.

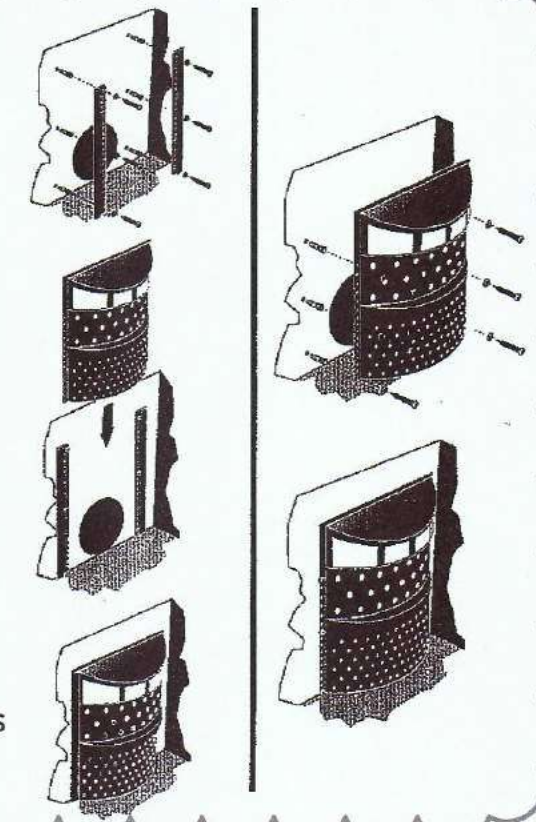

### Section 2 (Diagram A & B)

- Items Included for A:
  - Bottom Plate with plastic netting attached
  - Seven Plastic Anchors
  - Seven Flat Washers
  - Seven 1.75" x .25" Stainless Steel Phillips Screws
- Tools Needed:
  - Cordless Hammer Drill
  - 5/16" Masonry Drill Bit
  - Phillips Screwdriver

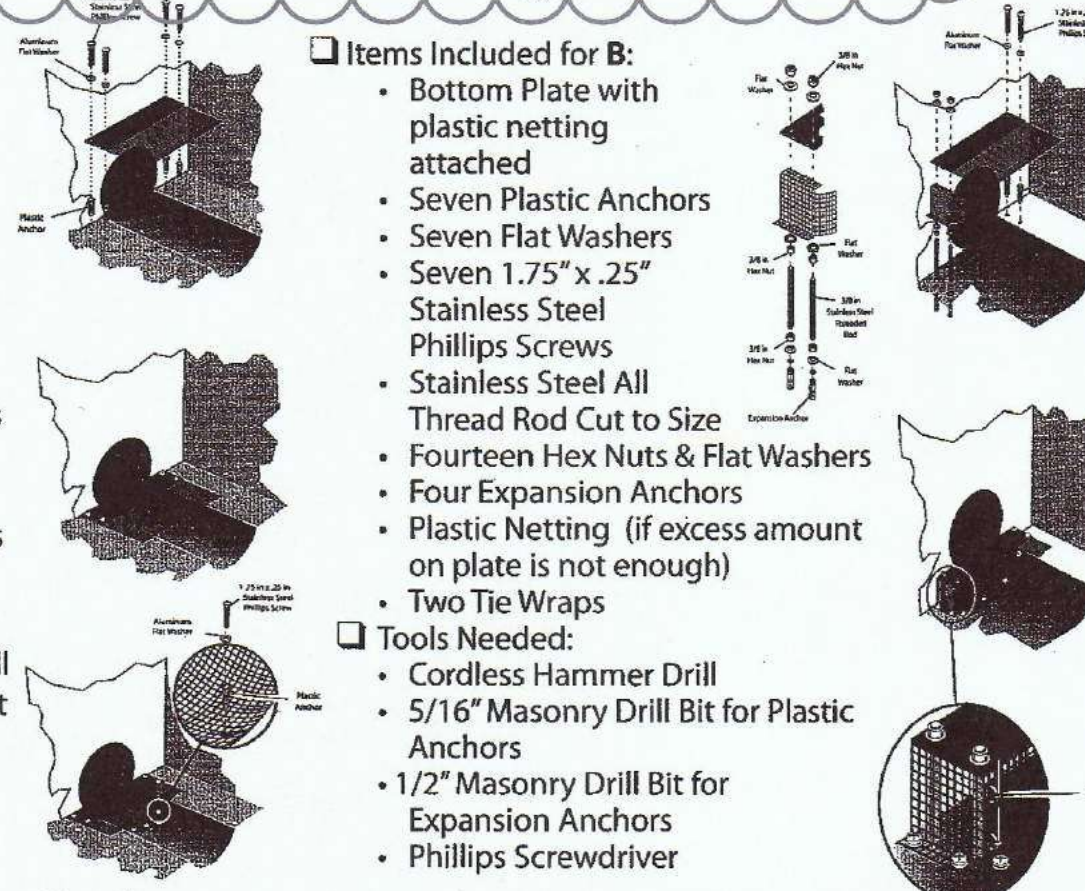

### Installation Instructions For A

1. Place bottom plate over inverted bottom with level sides. (Front and Back)
2. Drill 5/16" holes as shown in diagram.
3. Insert plastic wall anchors as shown in diagram A.
4. Attach with washer and screw as shown.

### Installation Instructions For B

1. Follow instructions A if one side is level.
2. Drill 1/2" holes to accommodate expansion anchors.
3. Cut stainless steel rod to desired length. (Allow 1" inside expansion anchor and 1" through bottom plate)
4. Attach washers and hex nuts as shown in diagram A.
5. Attach netting as shown in diagram.

# TRASH GUARD "PLUS" SPECIFICATION

INLET PROTECTION

### Trash Guard "Plus"® Specification

- 1.0 This work shall consist of furnishing, installing, and maintaining the Trash Guard "Plus"® inlet filter.
- 2.0 Trash Guard "Plus"® is manufactured using 100% recycled HDPE material by Trash Guard "Plus"® Incorporated, Trash Guard Inc.P.O. Box 10 Roseboro, NC. 28382 .
- 3.0 Trash Guard "Plus"® is distributed exclusively by ACF Environmental, 2831 Cardwell Road, Richmond, VA. 23234. 800-448-3636.

### 4.0 Materials

Trash Guard "Plus"® is a catch basin filter device manufactured from 100% recycled HDPE.

### 5.0 Installation

Trash Guard shall be installed over the outlet pipe within the catch basin according the various installation applications provided in the Trash Guard "Plus"® Installation Guide.

Trash Guard "Plus"® shall be installed in such a manner that that the unit is securely fastened to the sidewall of the catch basin and completely covers the outlet pipe.

Trash Guard "Plus"® comes in 3 Standard Sizes:

23" unit for pipe diameters ≤ 15" (TGRD-23x24)

28" unit for pipe diameters ≤ 18" (TGRD 28x30)

34" unit for pipe diameters ≤ 24" (TGRD-34x36)

### 6.0 Maintenance

Trash Guard "Plus"® shall be inspected on a quarterly basis to determine when maintenance is necessary. If sediment and debris build up is covering over half of the unit, removal of debris is recommended. Some installations may require more inspections and maintenance according to loads.

For more information about Inlet Protection, contact Inside Sales at 800.448.3636 email at info@acfenv.com

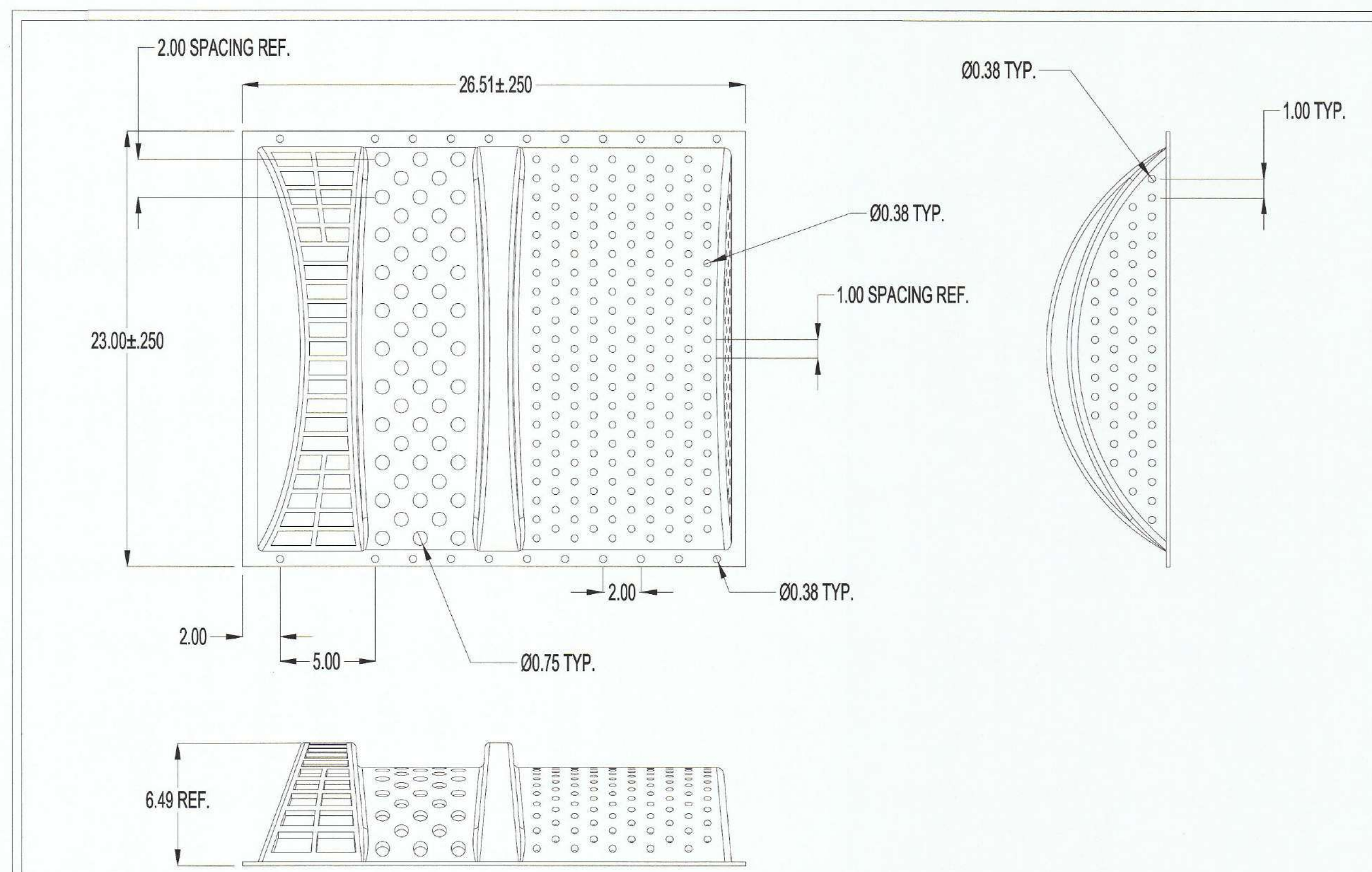

## TRASHGUARD PLUS 23" TGRD23X24

FOR ADDITIONAL INFORMATION PLEASE CONTACT: ACF ENVIRONMENTAL, 1-800-448-3636, www.acfenvironmental.com

9/15

REVISED

DEVELOPER / OWNER INFORMATION:

Knights of Columbus - O'Fallon  
202 W. 3rd St.  
O'Fallon, MO 63366

TRASH GUARD BMP DETAILS

P&Z NO. 17-011060

CITY NO.

DATE: 08/09/2018

PAGE NO.

C18

PROJECT TITLE

KNIGHTS OF COLUMBUS  
- O'FALLON

SITE ADDRESS: 202 W. 3RD ST., O'FALLON, MO 63366  
PERMIT NO. CSP18-000025

ENGINEERING COMPANY'S INFORMATION

ENGINEERS  
LAND PLANNING  
LAND SURVEYING  
TRANSPORTATION  
CONSULTING  
MANAGEMENT

**VOLZ**  
Incorporated

10849 Indian Head Indl. Blvd.  
St. Louis, Missouri 63132  
314.426.6212 Main  
314.890.1250 Fax  
www.volzinc.com  
Authority #203

ORDER # 11344

ENGINEER SIGNATURE BLOCK

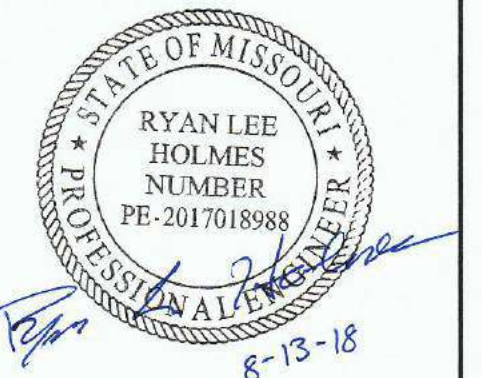

Ryan L. Holmes  
Professional Engineer  
PE-2017018988