

CINNAMON TEAL DRIVE
CUL-DE-SAC #1 WARPING
TOP OF CURB ELEVATION

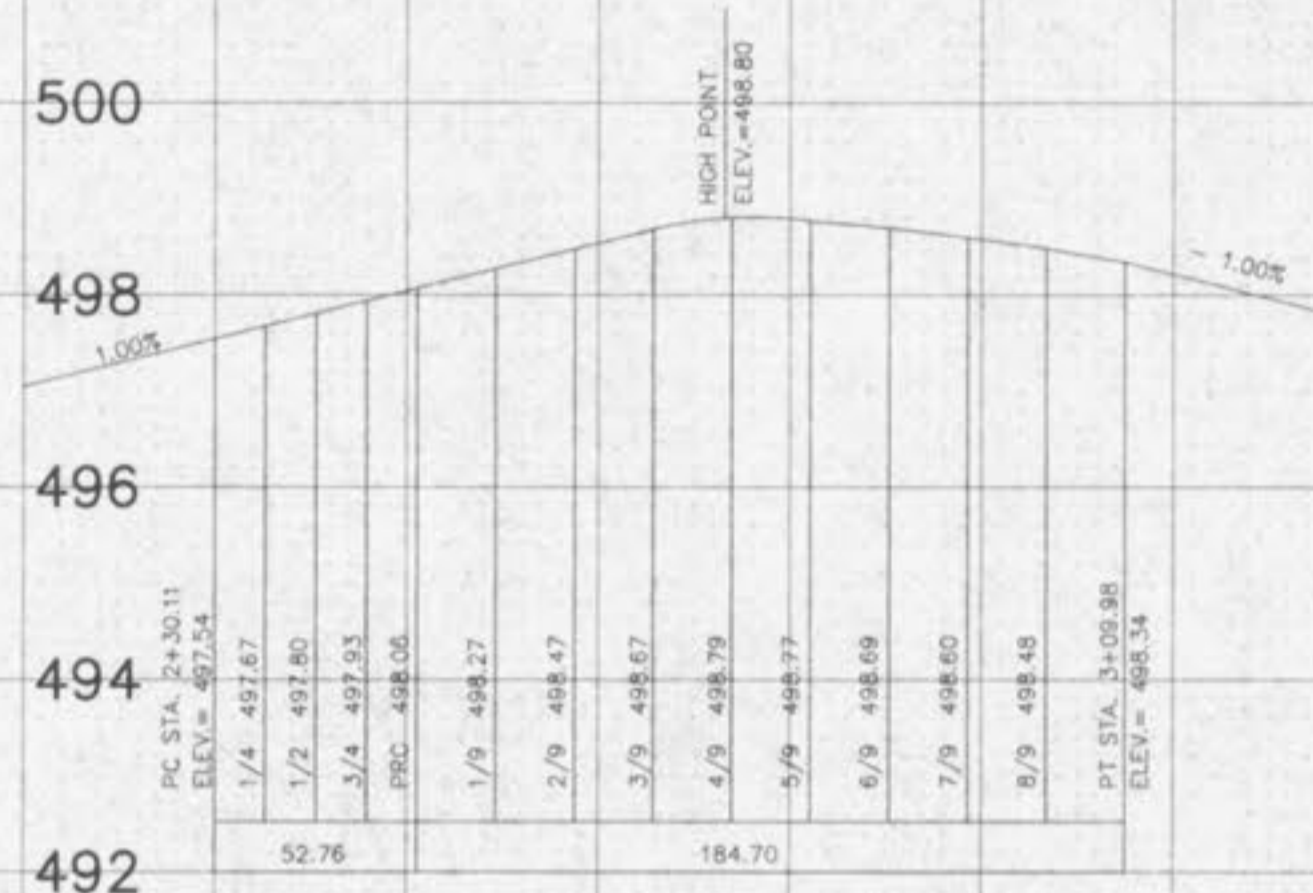

MARINO COURT
CUL-DE-SAC WARPING
TOP OF CURB ELEVATION

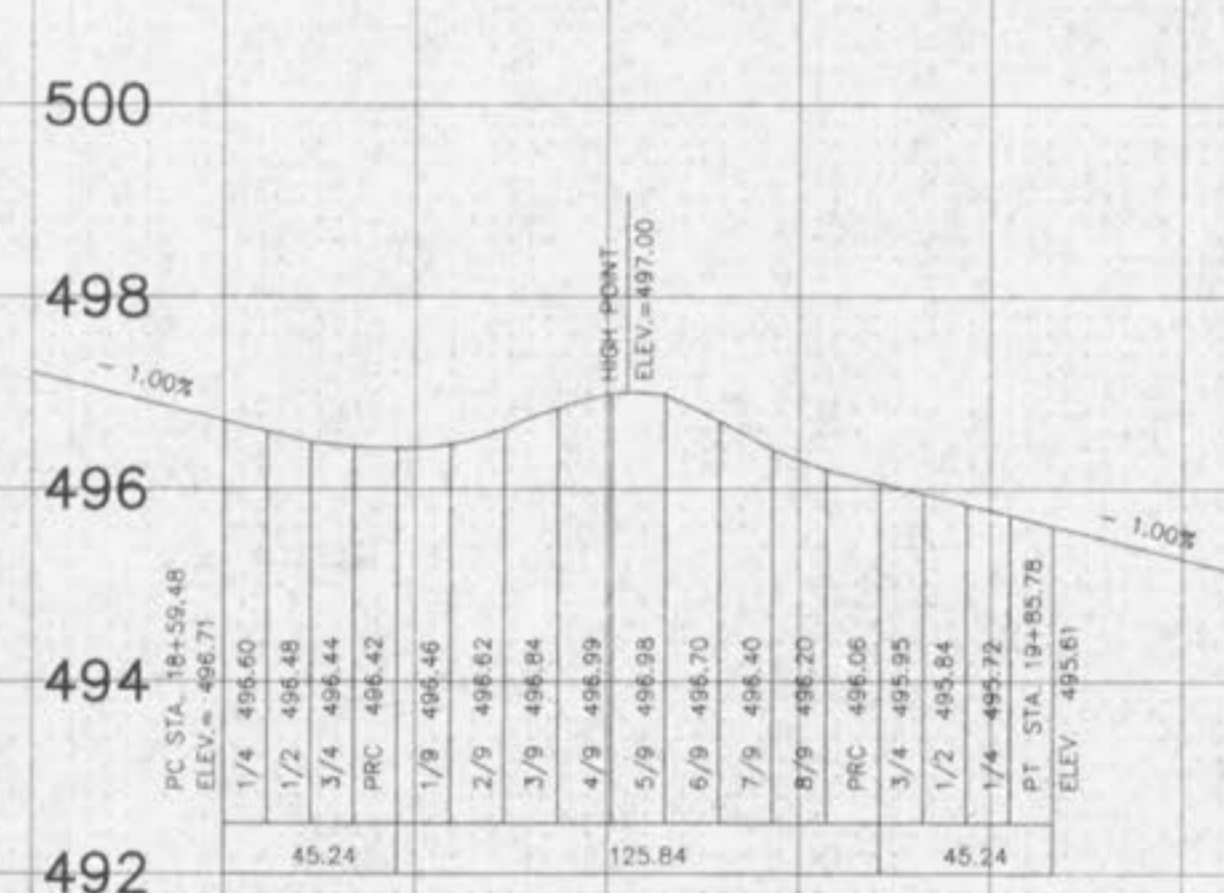

CINNAMON TEAL DRIVE
CUL-DE-SAC #2 WARPING
TOP OF CURB ELEVATION

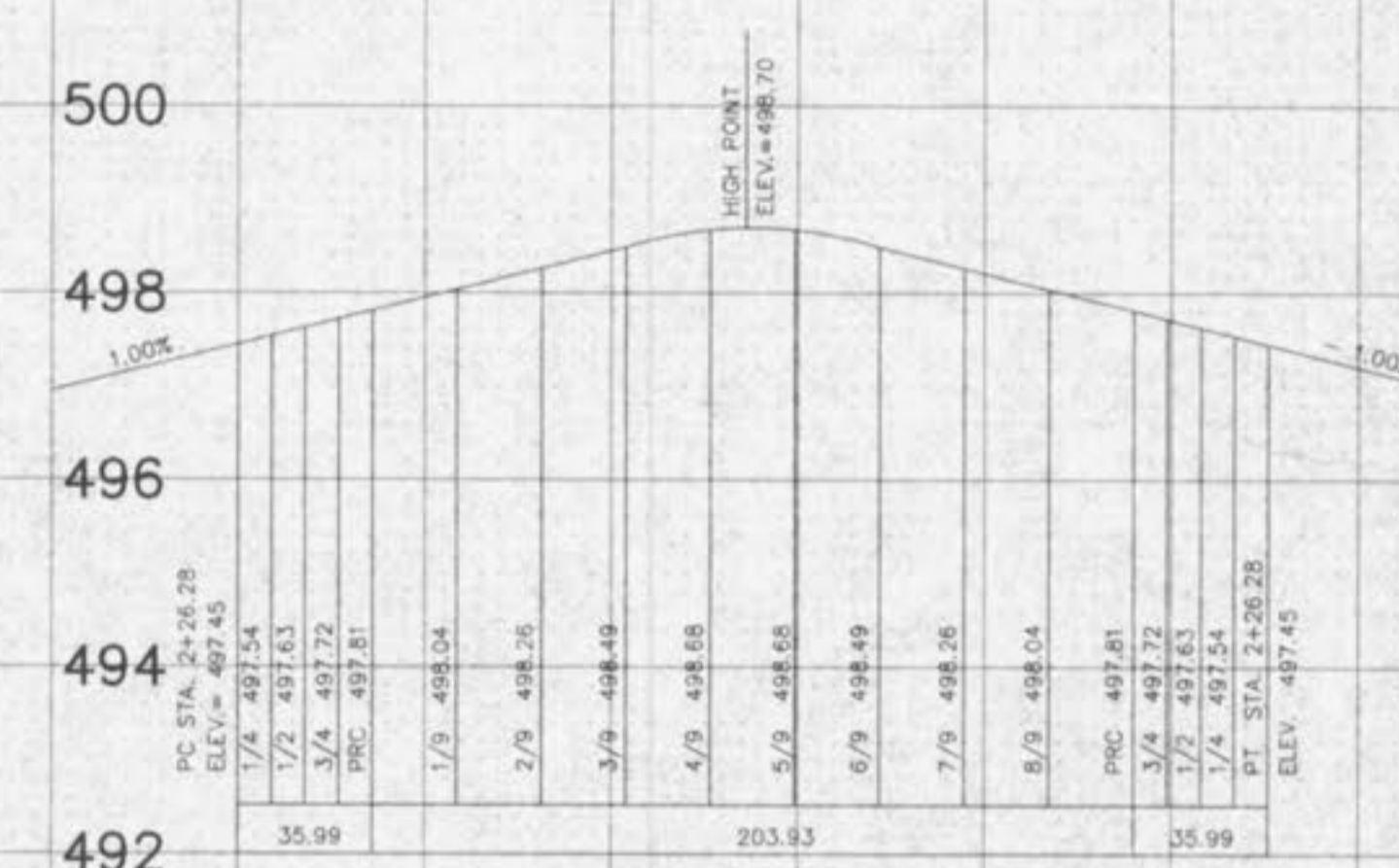

KNOLL CREEK COURT
CUL-DE-SAC WARPING
TOP OF CURB ELEVATION

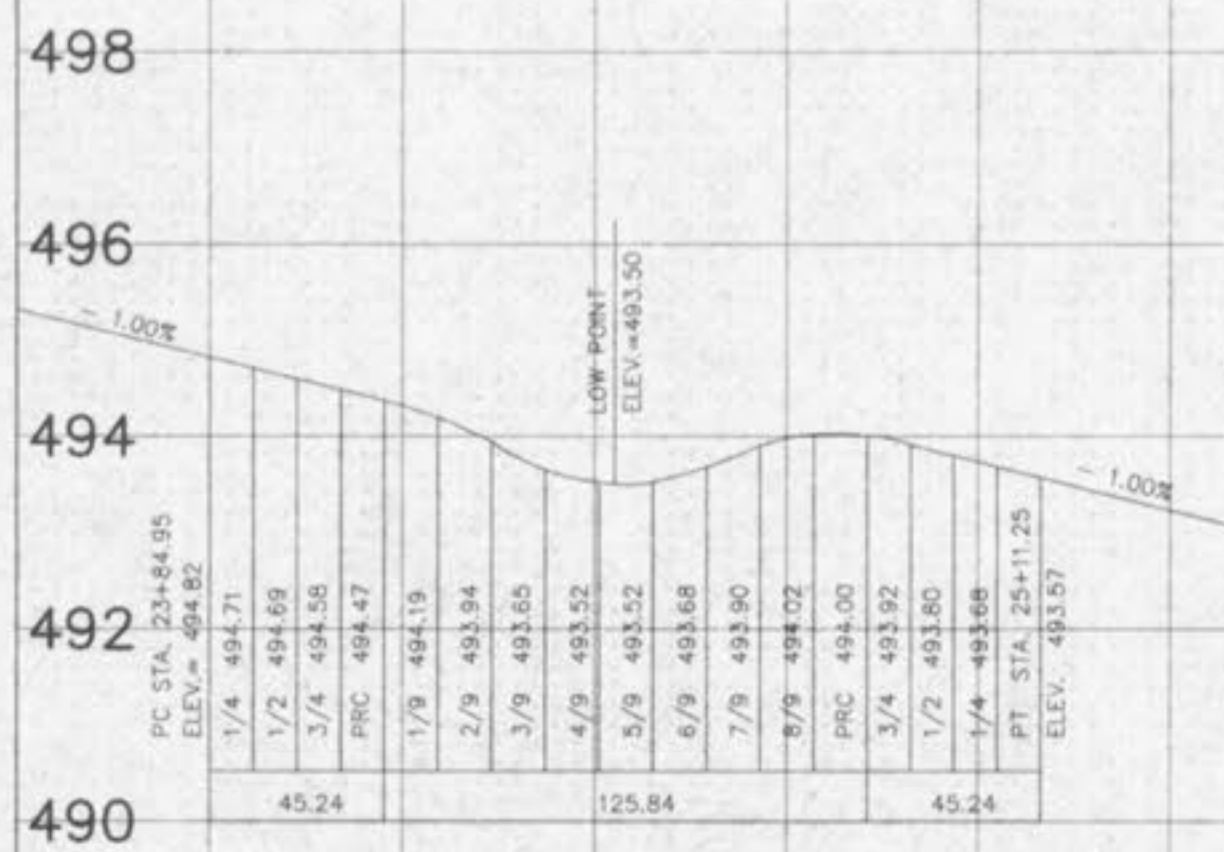

CINNAMON TEAL DRIVE
CUL-DE-SAC #3 WARPING
TOP OF CURB ELEVATION

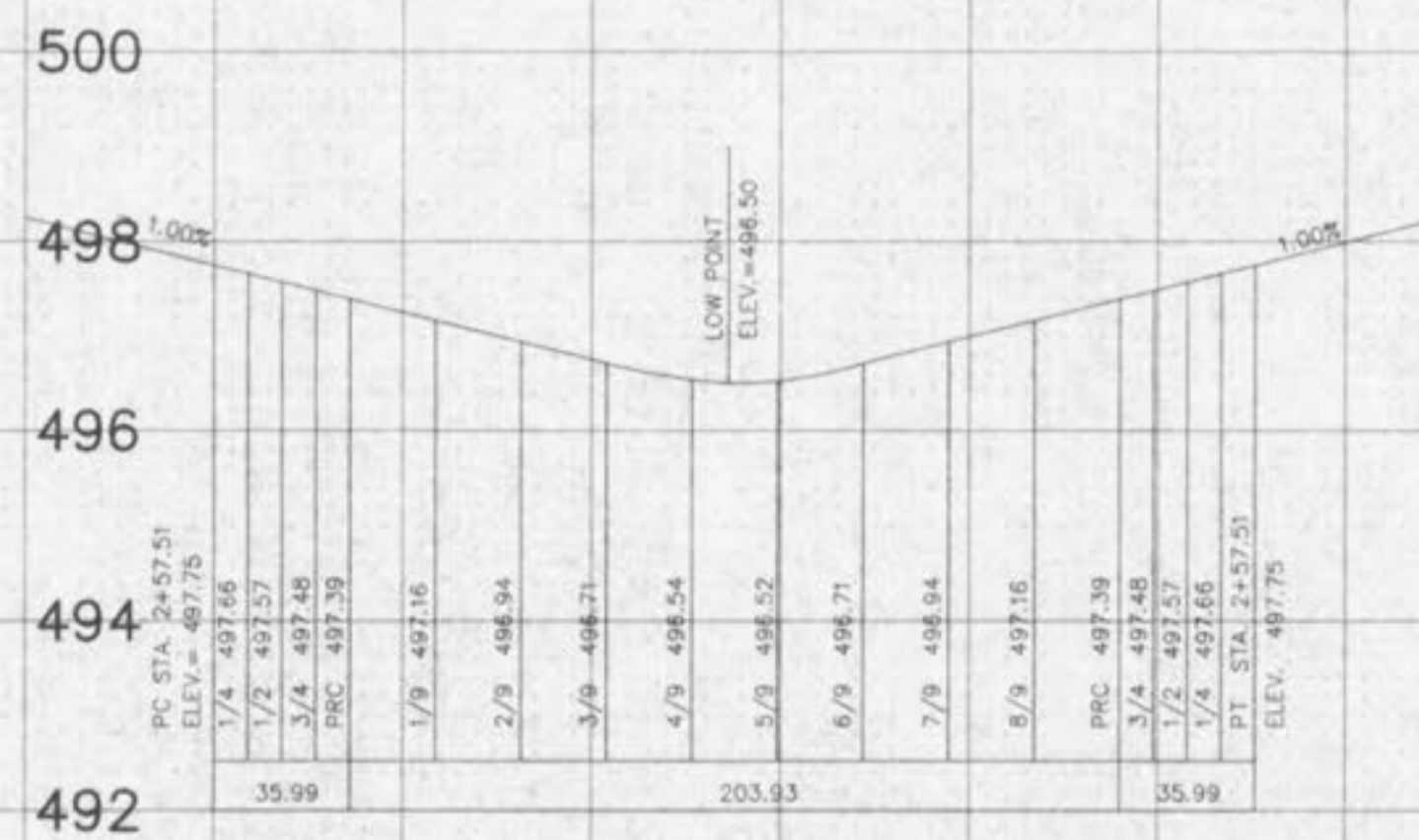

McGWIRE COURT
CUL-DE-SAC WARPING
TOP OF CURB ELEVATION

SCALE: 1"=10' VERTICAL
1"=50' HORIZONTAL