

NOTE: THE STORM SEWER REACH FROM FE#35 TO CI#42 SHOULD BE CONSTRUCTED BEFORE THE SANITARY MAIN DUE TO THE LOCATION AND ELEVATION OF THE HOUSE LATERAL CROSSINGS REGARDING EACH PHASE.

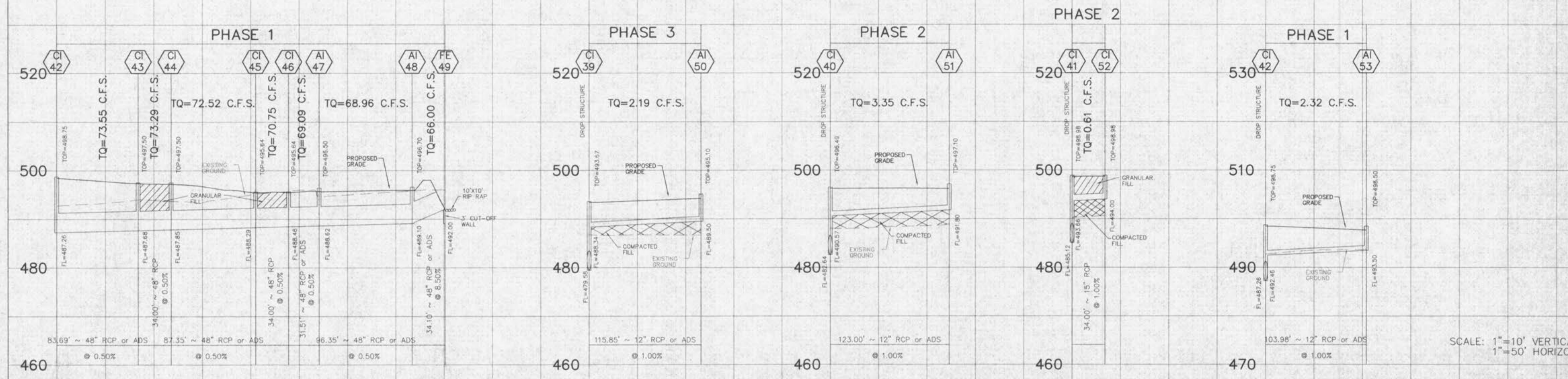
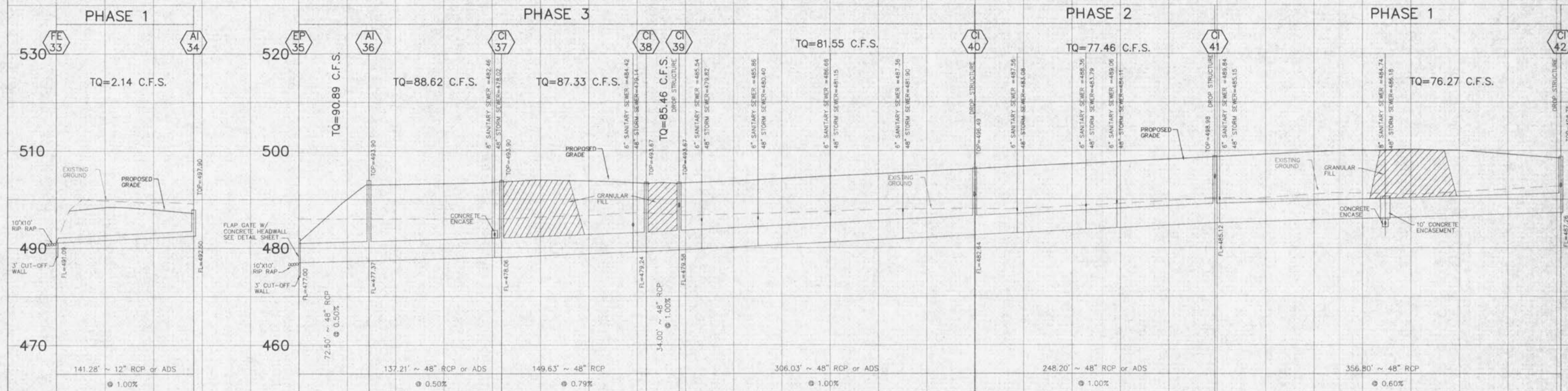

SCALE: 1"=10' VERTICAL
1"=50' HORIZONTAL