

E:\DWG\A10000PL\10203D KOCH RD ALIGN\Koch Road\Construction\10293D-XSEC.dwg, sheet 9, 9/16/2004 9:48:53 AM, Station 67. ER

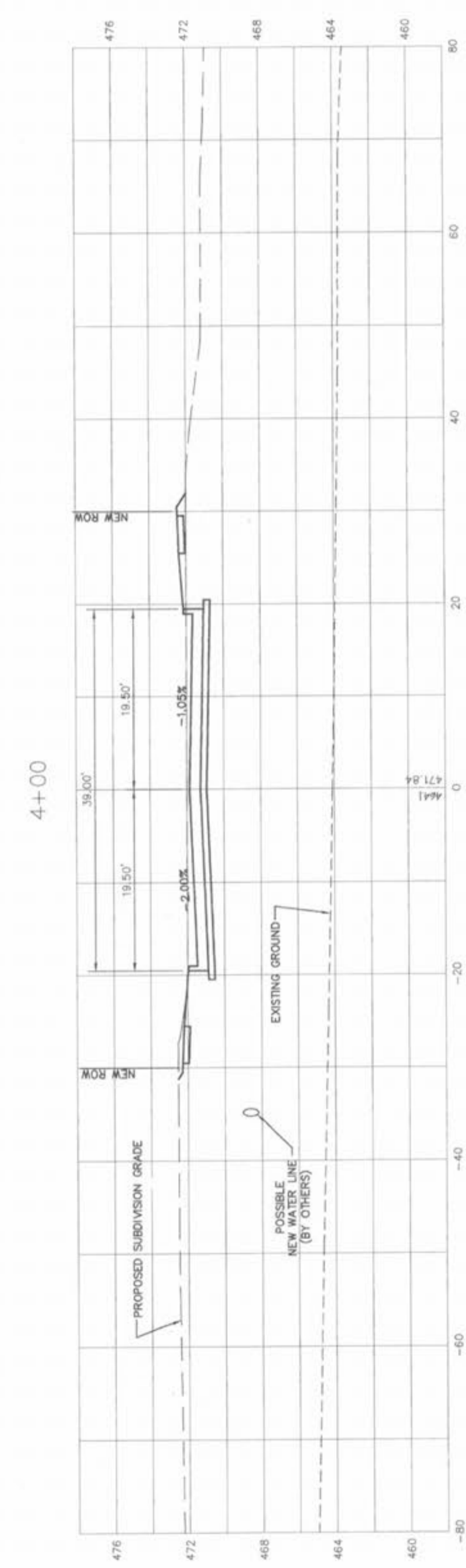

3+51.50

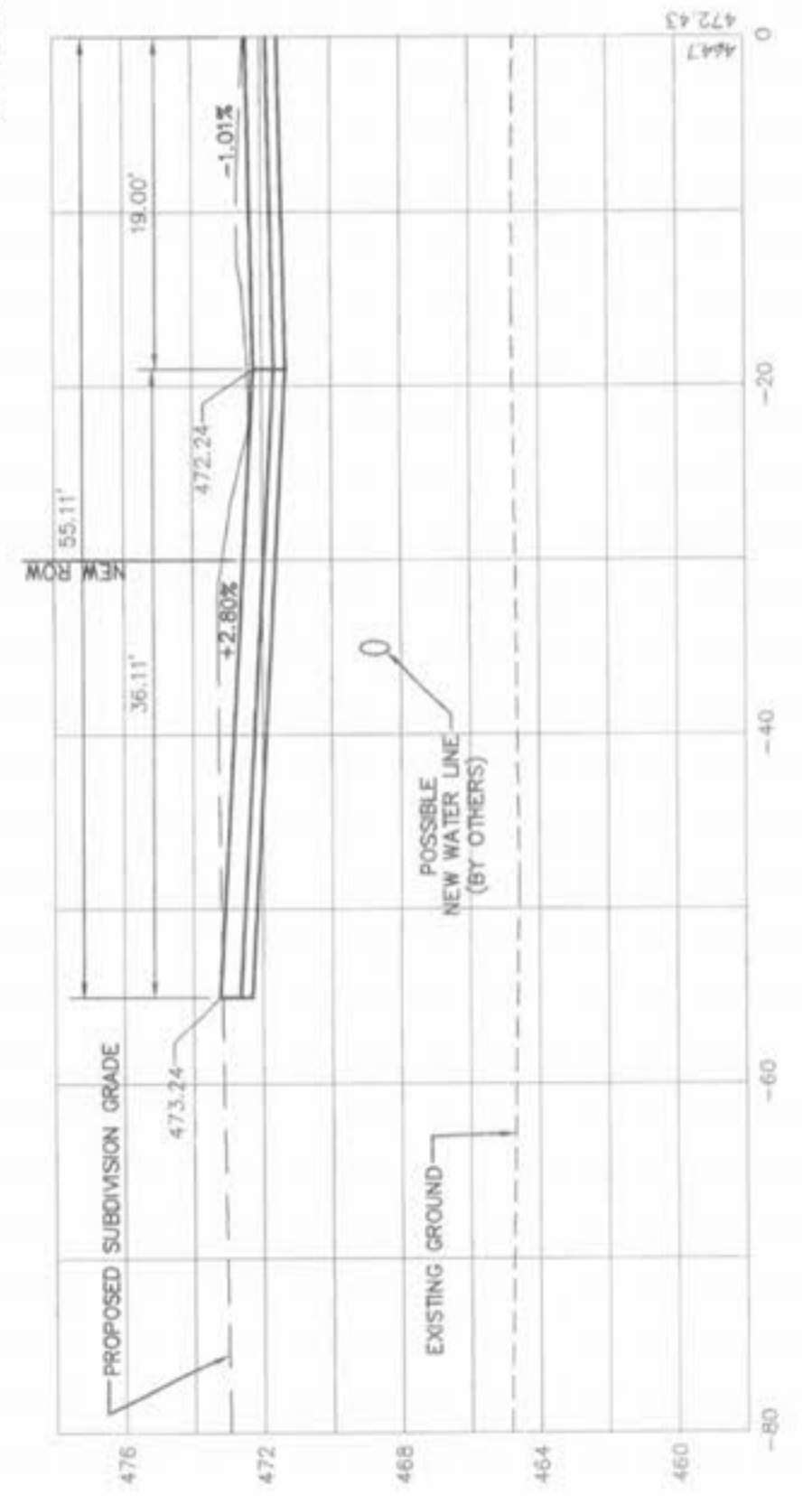

3+50

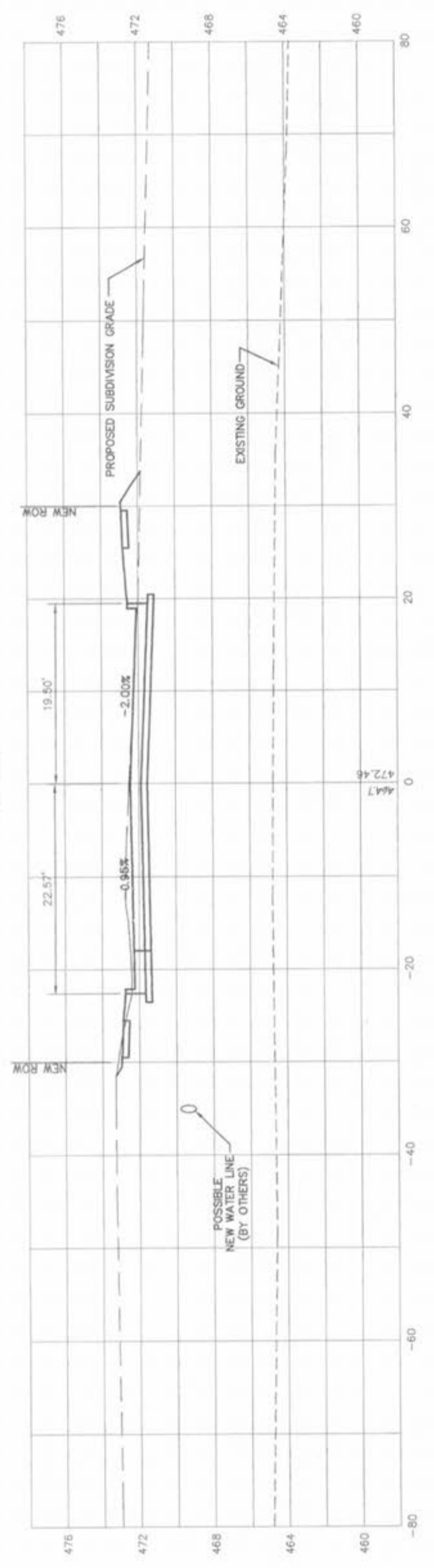

3+00

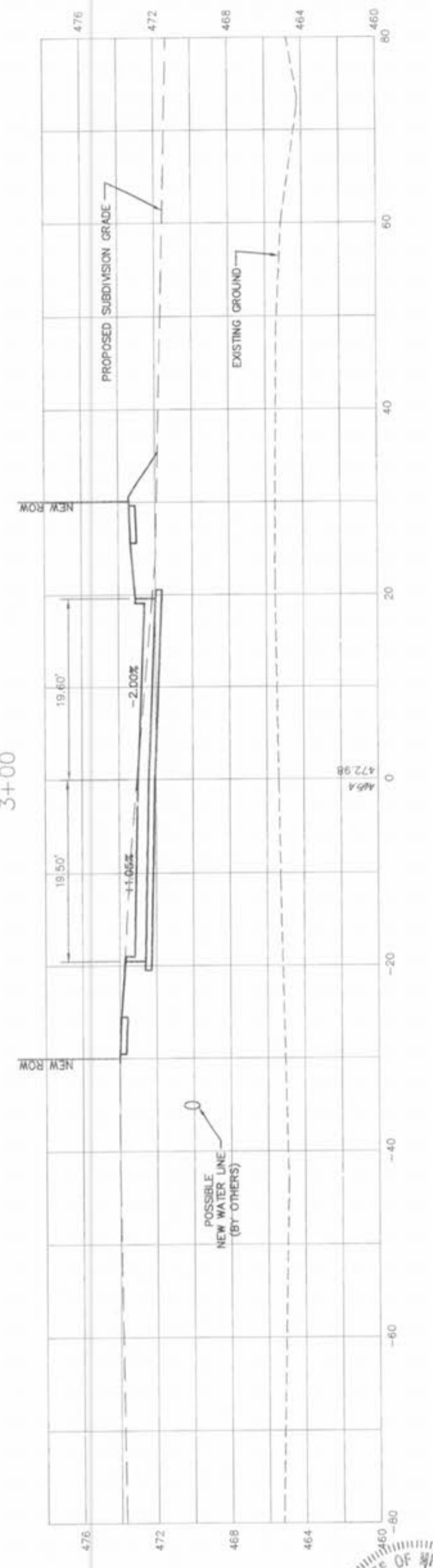

2+50

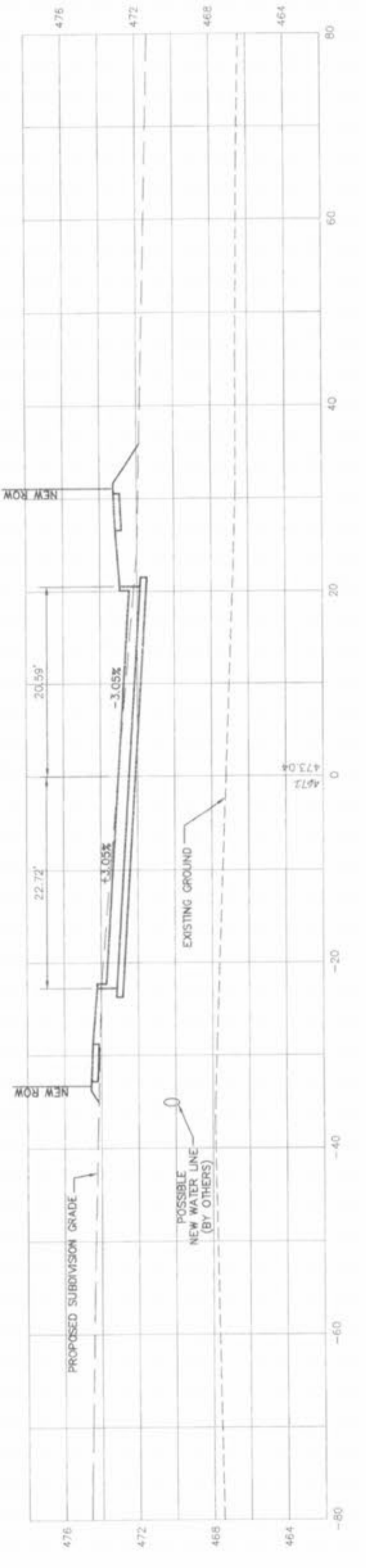

UNDERGROUND UTILITIES HAVE BEEN PLOTTED FROM AVAILABLE INFORMATION AND THEREFORE THEIR LOCATIONS SHALL BE CONSIDERED APPROXIMATE ONLY. THE VERIFICATION OF THE LOCATION OF ALL UNDERGROUND UTILITIES, EITHER SHOWN OR NOT SHOWN ON THESE PLANS SHALL BE THE RESPONSIBILITY OF THE CONTRACTOR, AND SHALL BE LOCATED PRIOR TO ANY GRADING OR CONSTRUCTION OF THE IMPROVEMENTS.

DATE	BY	DESCRIPTION
7-09-04	EB	REVISED PER CITY COMMENTS
7-30-04	EB	REVISED PER CITY COMMENTS
9-9-04	EB	REVISED PER CITY COMMENTS
9-16-04	EB	REVISED PER CITY COMMENTS

DATE	BY	DESCRIPTION

BAX ENGINEERING CO., INC.
 1052 South Cloverleaf Drive
 St. Peters, MO 63376-6445
 Phone: 636-928-5552
 Fax: 636-928-1718

PREPARED FOR:
HYLAND GREEN LLC

PROJECT NAME:
KOCH ROAD RELOCATION
 PROJECT NO.: 98-10293D DATE: 05/20/2004

CROSS SECTIONS
 KOCH ROAD

DISCLAIMER OF RESPONSIBILITY
 I hereby specify that the documents intended to be authorized by my seal are limited to this sheet, and I hereby disclaim any responsibility for all other drawings, specifications, estimates, reports or other documents or instruments relating to or intended to be used for any part or parts of the architectural or engineering project or survey.

Copyright 2004
 Bax Engineering Company, Inc.
 All Rights Reserved.