

**WARPING DETAIL**  
(KOCH ROAD & TOWER PLACE)  
SCALE: 1"=10'

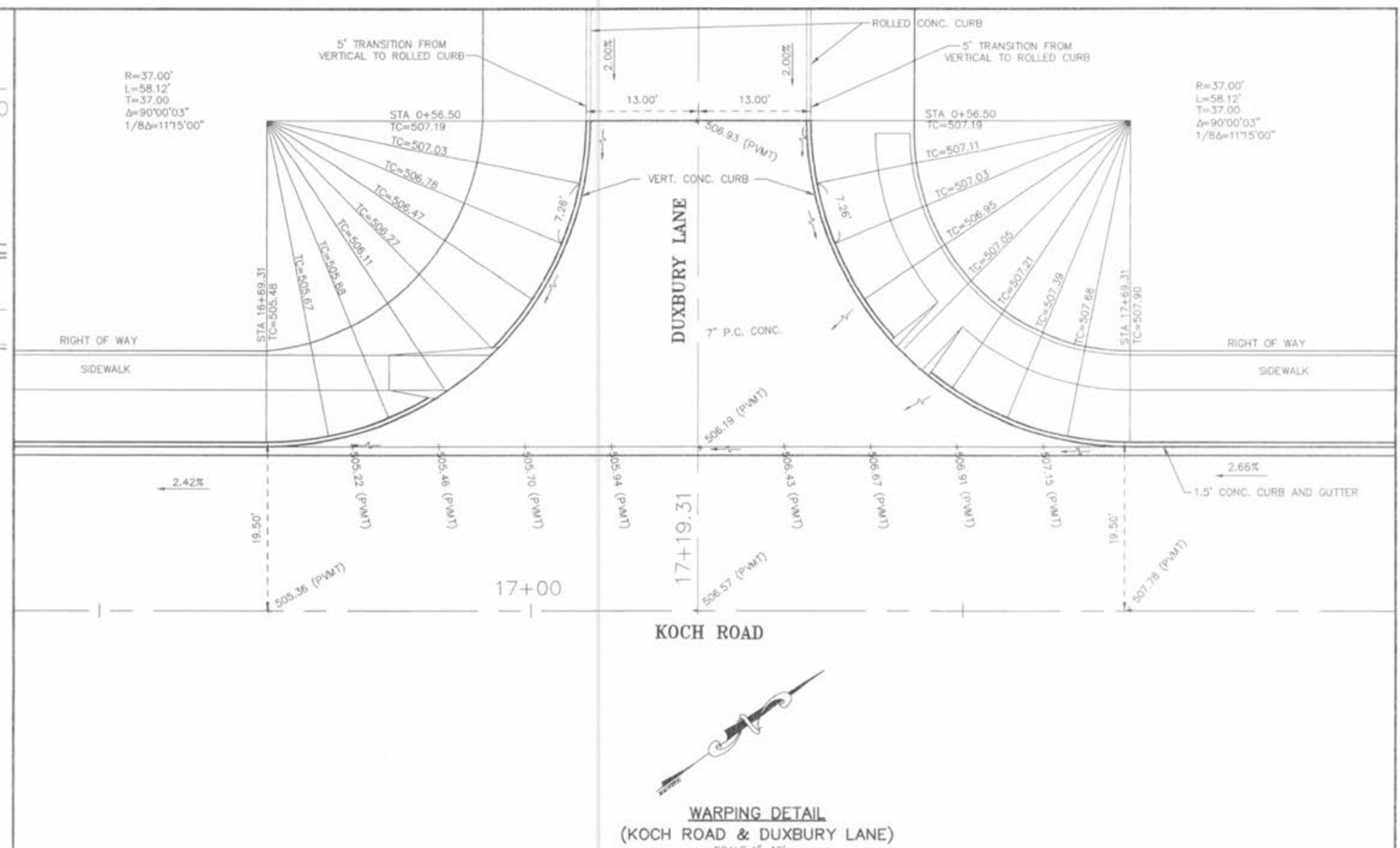

**WARPING DETAIL**  
(KOCH ROAD & DUXBURY LANE)  
SCALE: 1"=10'

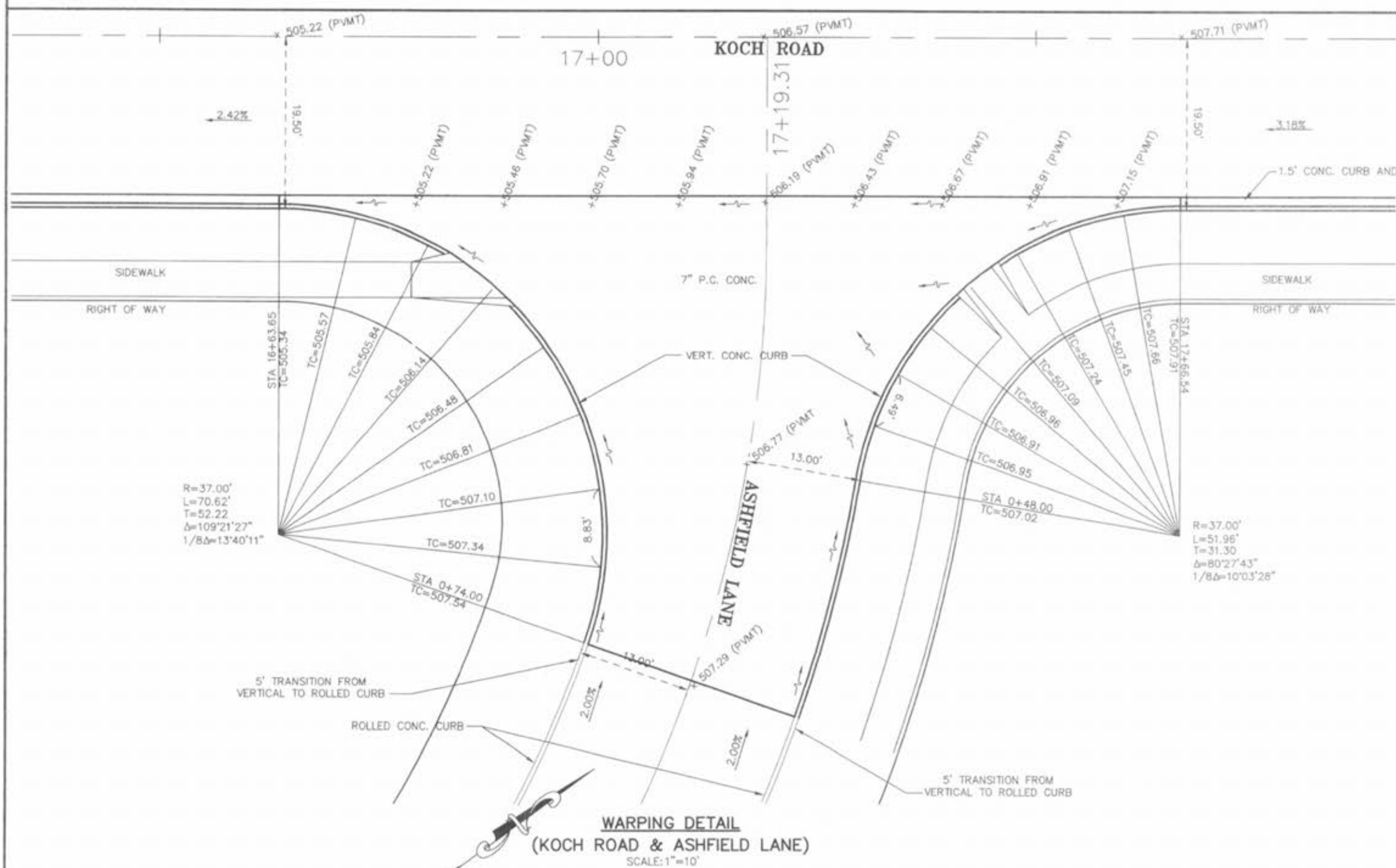

**WARPING DETAIL**  
(KOCH ROAD & ASHFIELD LANE)  
SCALE: 1"=10'

DATE	BY	DESCRIPTION	DATE	BY	DESCRIPTION
7-08-04	EB	REVISED PER CITY COMMENTS			
7-30-04	EB	REVISED PER CITY COMMENTS			
9-9-04	EB	REVISED PER CITY COMMENTS			
9-16-04	EB	REVISED PER CITY COMMENTS			

**BAX ENGINEERING CO., INC.**  
1052 South Cloverleaf Drive  
St. Peters, MO 63376-6445  
Phone: 636-928-5552  
Fax: 636-928-1718

PROJECT NAME: **KOCH ROAD RELOCATION**  
PREPARED FOR: **HYLAND GREEN LLC**  
PROJECT NO.: 98-10293D DATE: 05/20/2004

**WARPING DETAILS**

DISCLAIMER OF RESPONSIBILITY:  
I hereby certify that the documents intended to be authorized by my seal are limited to this sheet, and I hereby disclaim any responsibility for all other drawings, specifications, estimates, reports or other documents or instruments relating to or intended to be used for any part or parts of the architecture or engineering project or survey.

Copyright 2004  
Bax Engineering Company, Inc.  
All Rights Reserved

23  
29



NOTE:  
ALL ELEVATIONS ARE TO THE TOP OF CURB UNLESS OTHERWISE NOTED.