

CONCRETE PAVEMENT DETAIL
HIGHWAY K WIDENING

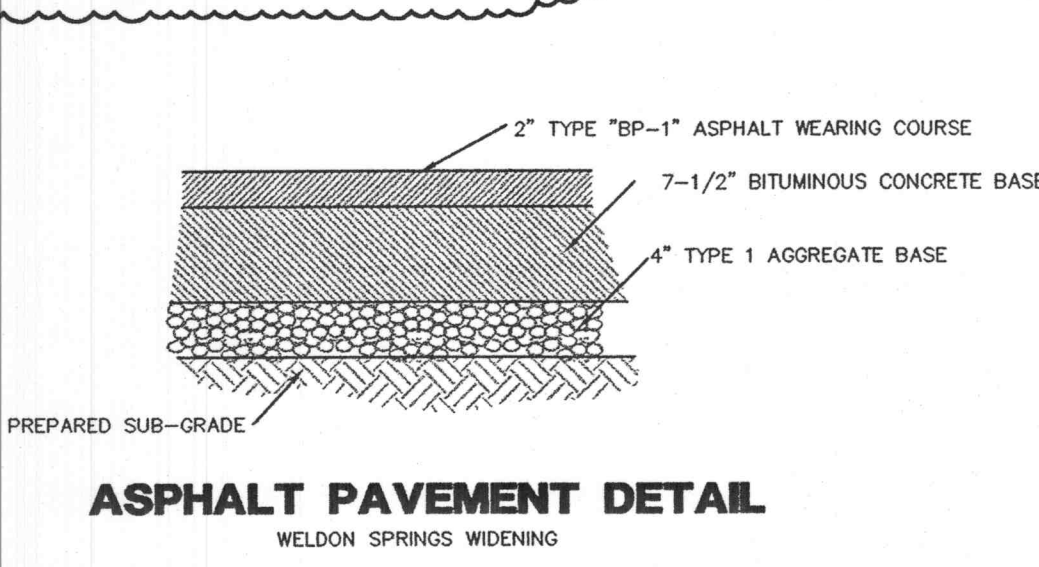

ASPHALT PAVEMENT DETAIL
WELDON SPRINGS WIDENING

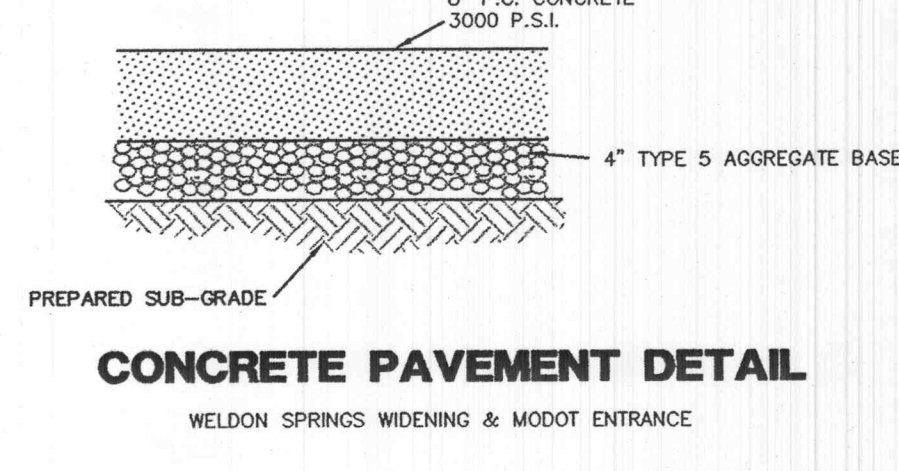

CONCRETE PAVEMENT DETAIL
WELDON SPRINGS WIDENING & MODOT ENTRANCE

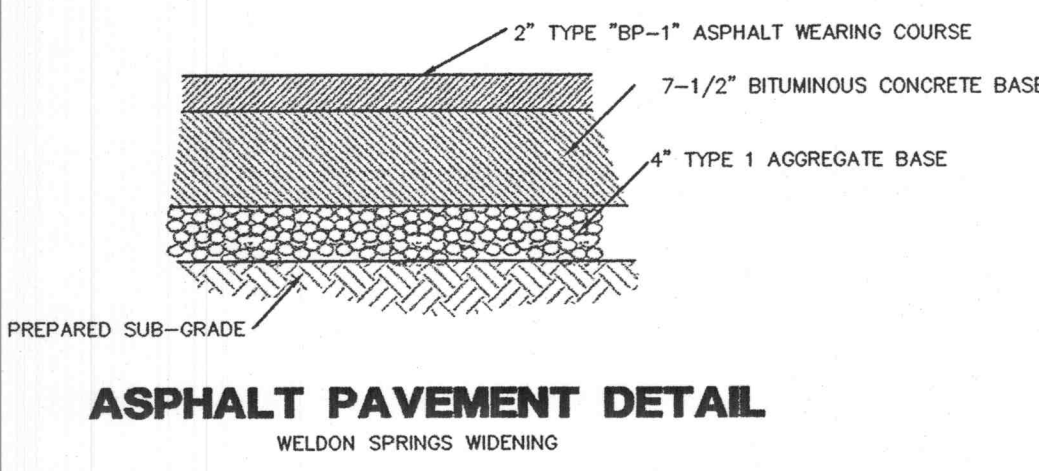

ASPHALT PAVEMENT DETAIL
WELDON SPRINGS WIDENING

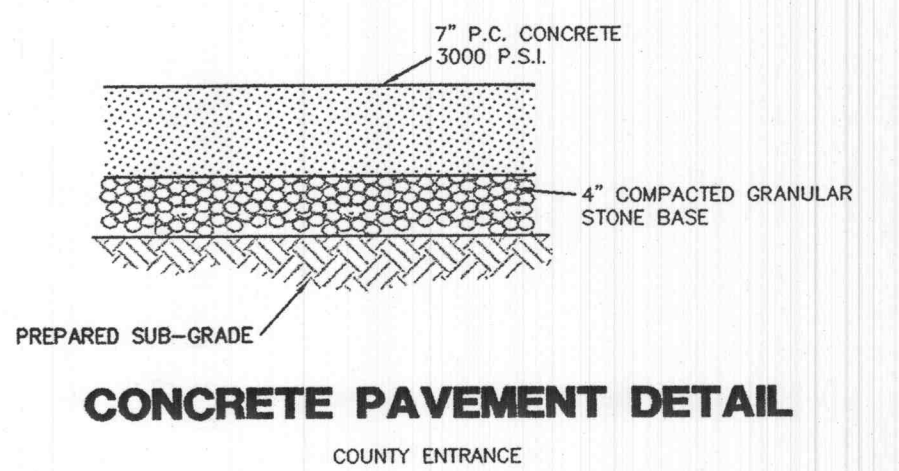

CONCRETE PAVEMENT DETAIL
COUNTY ENTRANCE

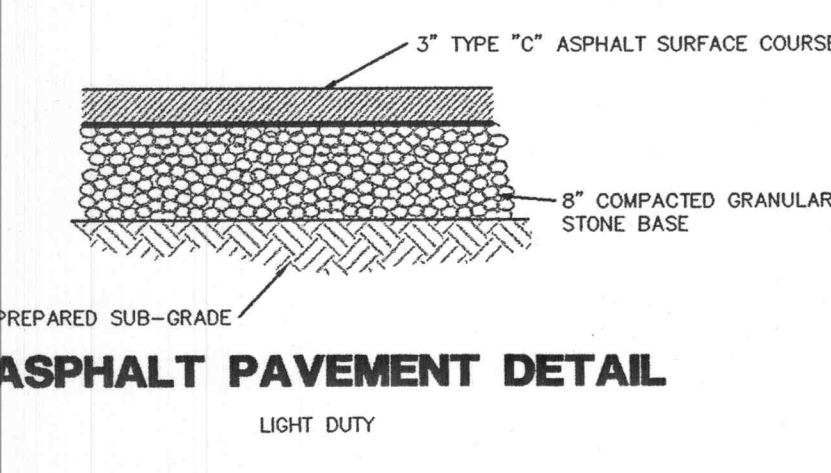

ASPHALT PAVEMENT DETAIL
LIGHT DUTY

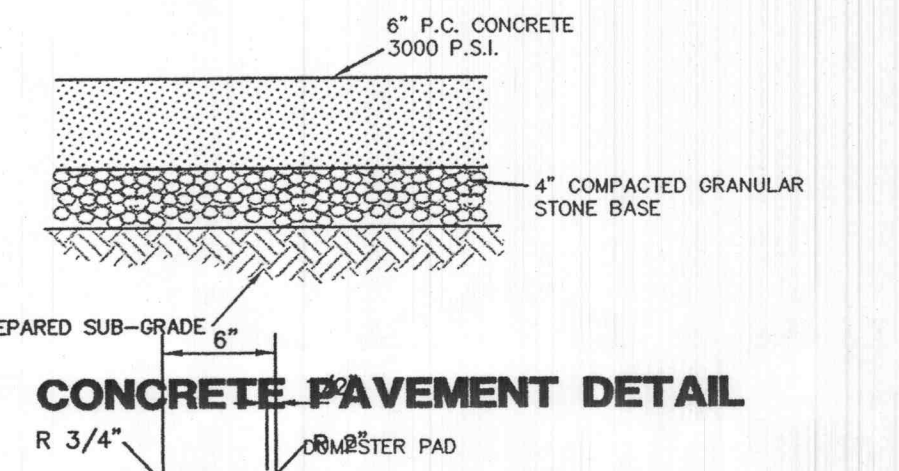

CONCRETE PAVEMENT DETAIL
COUNTY ENTRANCE

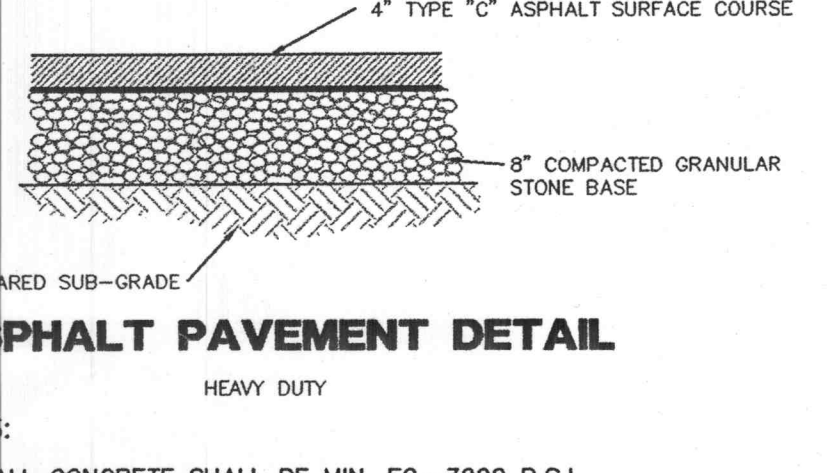

ASPHALT PAVEMENT DETAIL
HEAVY DUTY

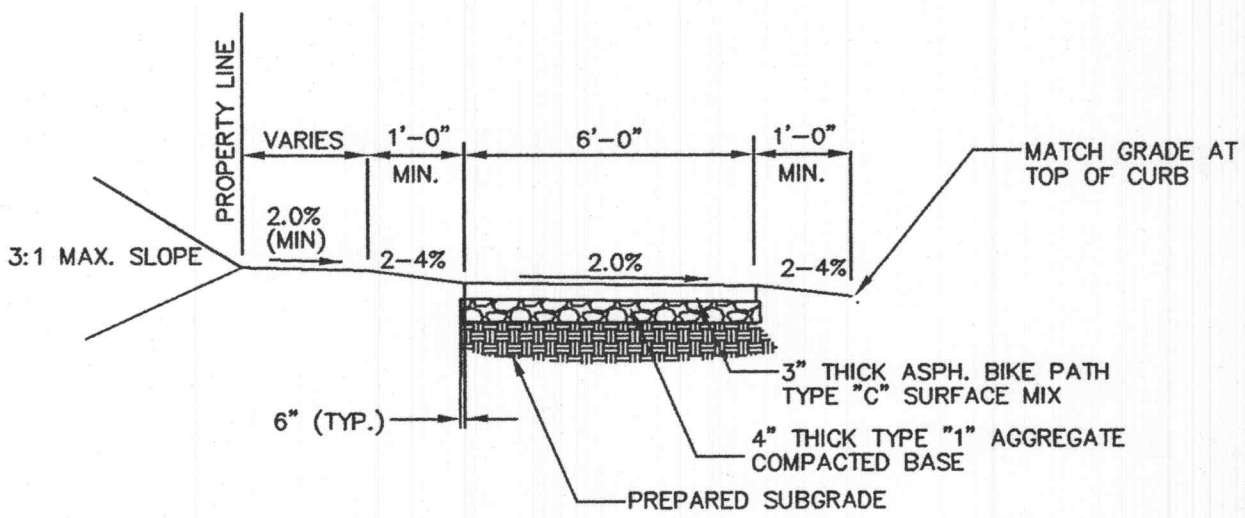

NOTES:
 PROVIDE CONCRETE HANDICAP RAMP WHERE TRAIL INTERSECTS ACCESS DRIVES OR STREETS OR WHERE TRAIL INTERSECTS WITH CURBING (SEE PLAN).
 PROVIDE STRIPING OR A COLORED TEXTURED PAVEMENT THROUGH THE ACCESS DRIVES OR STREETS INTO THE DEVELOPMENT.
 MAXIMUM SLOPE OF THE PATH SHALL NOT EXCEED 8% AND 2% CROSS SLOPE PER CITY OF OFALLON SPECIFICATIONS.
 THE TRAIL SHALL BE CONSTRUCTED WITH A CONSISTENT SLOPE WITH VERTICAL CURVES A MINIMUM OF 50' IN LENGTH. AFTER FINAL COMPRESSION, THE SURFACE SHALL BE SMOOTH AND TRUE TO THE ESTABLISHED CROWN AND GRADE. ANY LOW OR DEFECTIVE PLACES SHALL IMMEDIATELY BE REMEDIED BY CUTTING OUT THE COURSE AT SUCH SPOTS AND REPLACING IT WITH FRESH HOT MIXTURE, WHICH SHALL BE IMMEDIATELY COMPACTED TO CONFORM WITH THE SURROUNDING AREA AND SHALL BE THOROUGHLY BONDED TO IT. THE FINISHED PAVEMENT SHALL BE SET FREE FROM DEPRESSIONS EXCEEDING ONE-EIGHTH INCH AS MEASURED WITH A TEN-FOOT STRAIGHT EDGE PARALLEL TO THE CENTERLINE OF THE TRAIL.

MULTI-USE PATH DETAIL
NTS

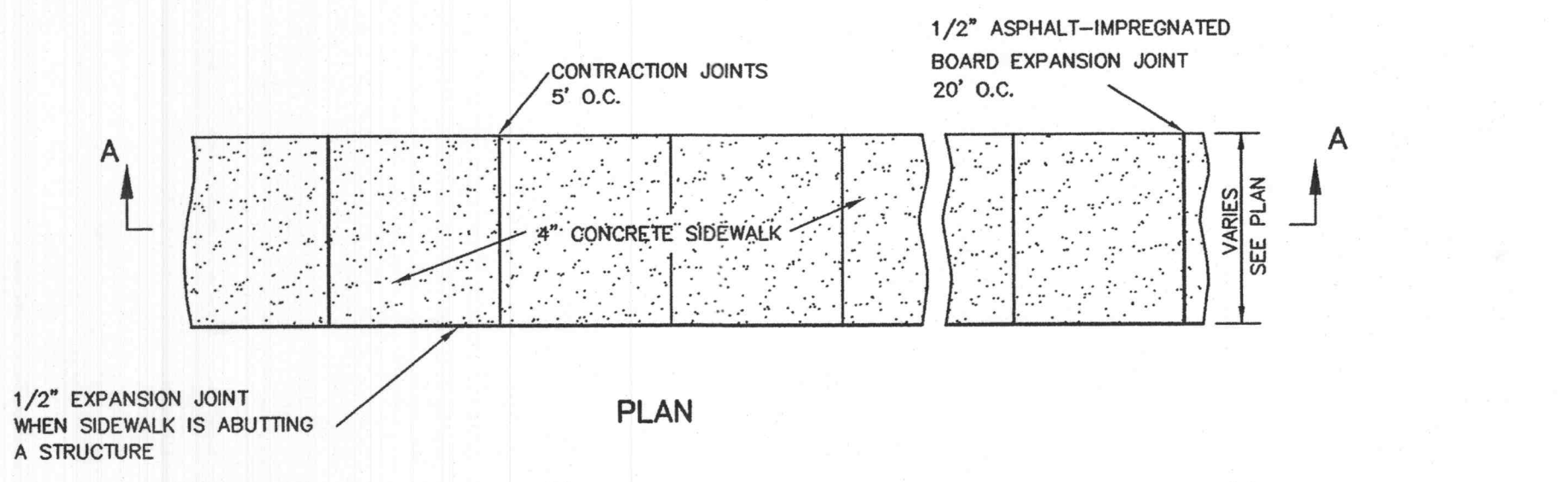

DETAIL OF CONCRETE SIDEWALK

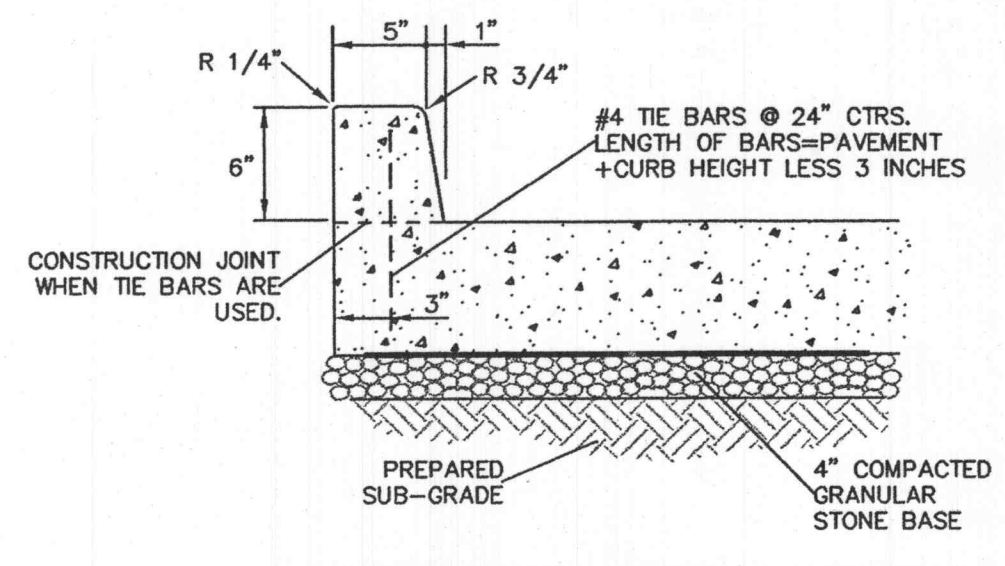
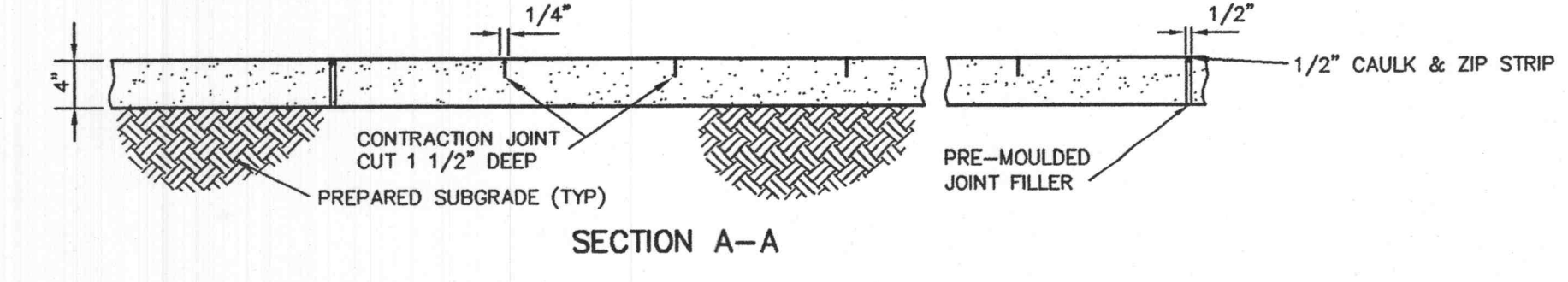

BARRIER CURBING DETAIL
PER STATE SPECIFICATIONS

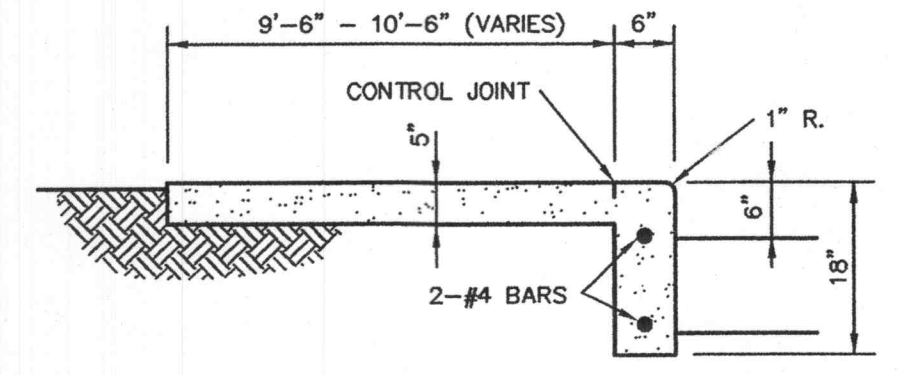

NOTE: EXPANSION JOINT MATERIAL SHALL BE INSTALLED IN THE WALK FOR ITS FULL WIDTH AND DEPTH AT INTERVALS OF APPROX. 50'. CONTROL JOINTS AT INTERVALS OF 1.5' TIMES ITS WIDTH.

INTEGRAL SIDEWALK & CURB

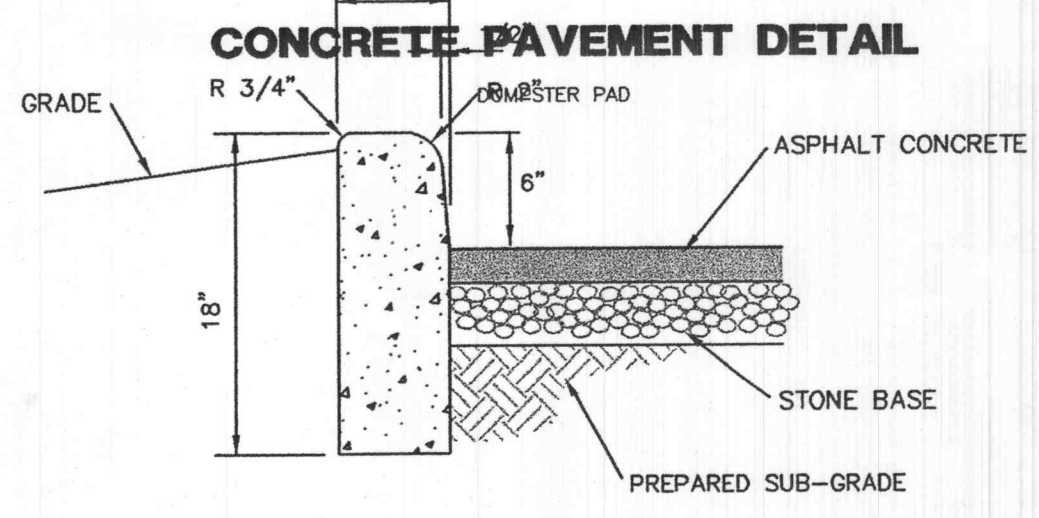

18\"/>

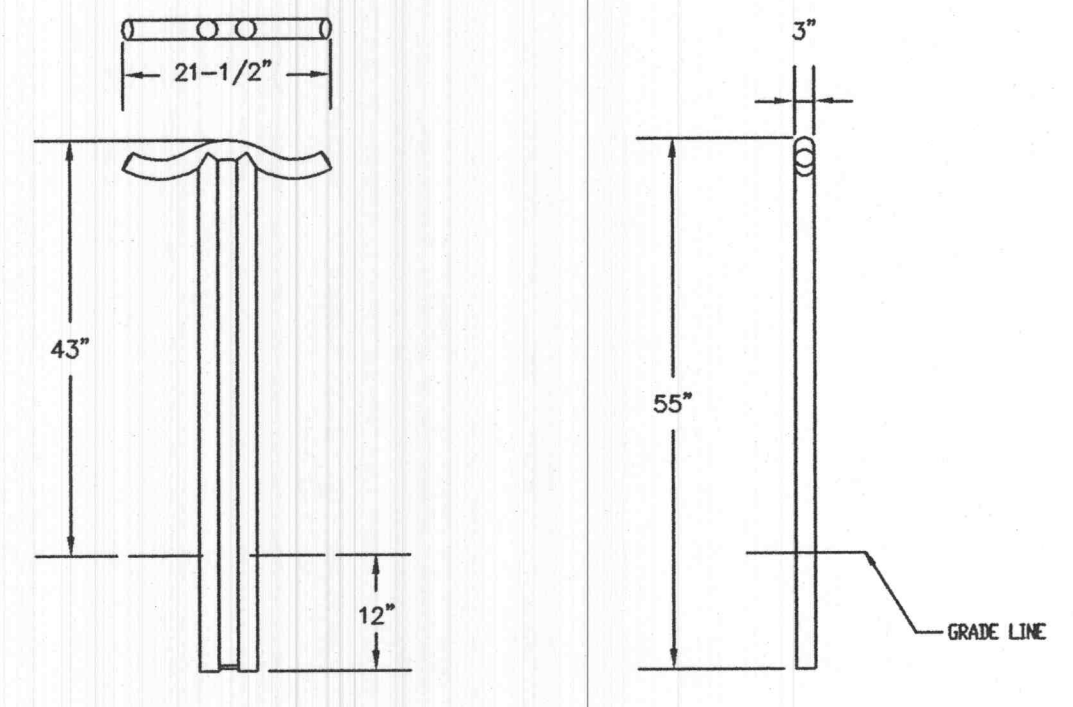

BICYCLE RACK
 TITLE: 21-1/2\"/>

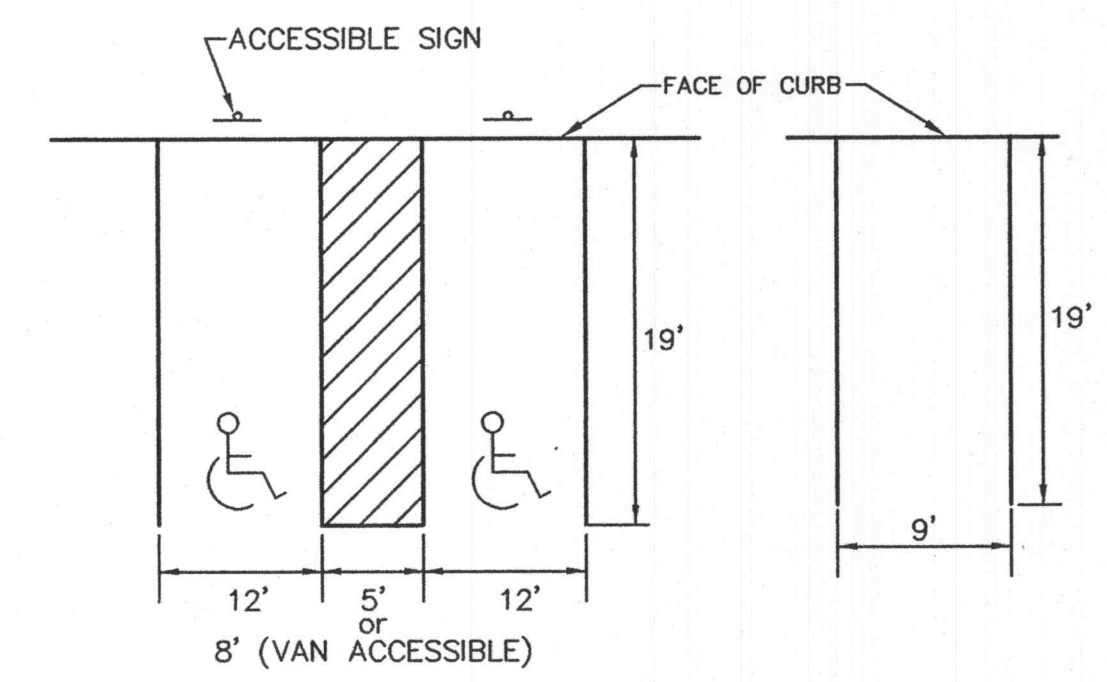

TYPICAL PARKING STALLS

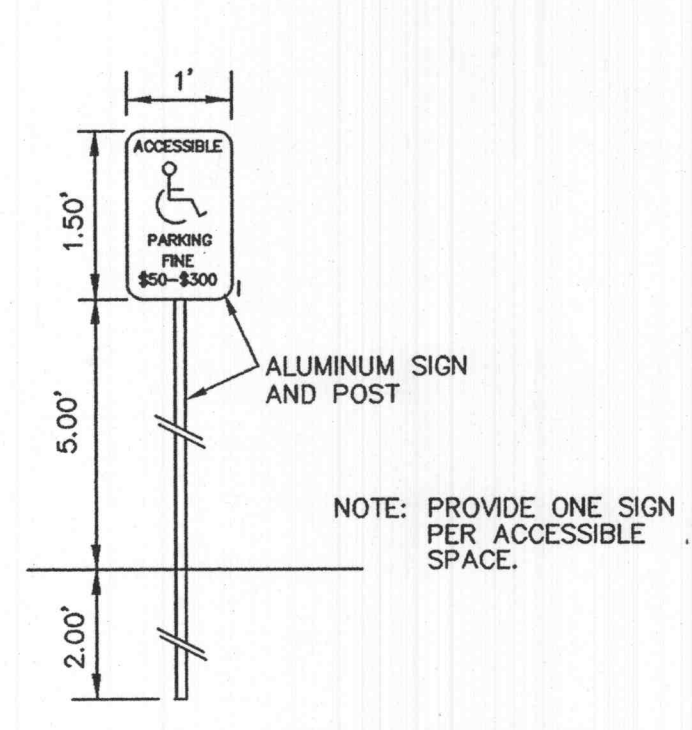

ACCESSIBLE PARKING SIGN

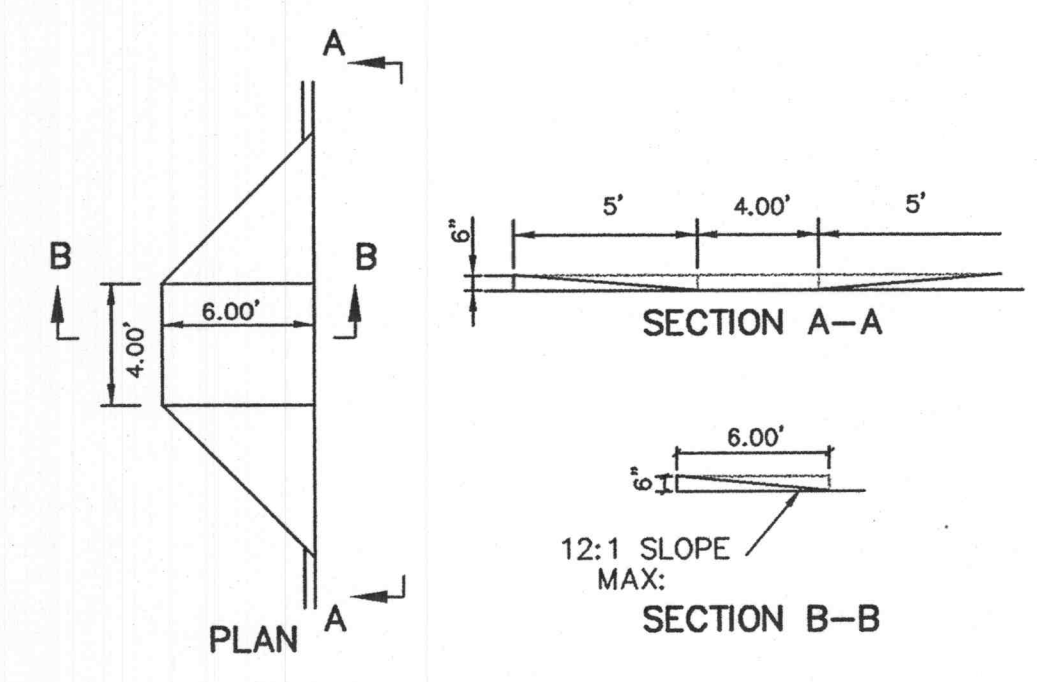

CURB RAMP DETAIL

- NOTES:**
- ALL CONCRETE SHALL BE MIN. FC.=3000 P.S.I.
 - ALL CONSTRUCTION MATERIALS AND METHODS OF CONSTRUCTION SHALL BE IN ACCORDANCE WITH ST. LOUIS COUNTY DEPARTMENT OF HIGHWAYS & TRAFFIC.
 - ANY UNSUITABLE SOIL (AS DETERMINED BY SOILS ENGINEER) BELOW STRUCTURE SHALL BE REMOVED AND REPLACED WITH SELECT EARTHEN MATERIAL COMPACTED IN PLACE WITH VIBRATORY TAMPER.
 - PROVIDE 1/2" EXPANSION JOINTS AT 20' CENTERS.

J:\1004\1004B\PLANS\07_1_PAVE-DETAILS.dwg Mon Apr 05 08:45:51 2004 JTH-w

PREPARED FOR:
 WILLIAM H. ERKER
 35 N. CENTRAL, STE 400
 ST. LOUIS, MO 63105
 PH: (314) 863-6061
 FAX: (314) 863-6146



- GENERAL CONTRACTOR**
 ARCO CONSTRUCTION CO., INC.
- ARCHITECT**
 THOMAS ROOF INC. ARCHITECTS
- STRUCTURAL ENGINEER**
 IBRAHIM ENGINEERING CORP.
- GEOTECHNICAL ENGINEER**
 GEOTECHNOLOGY
- CIVIL ENGINEER**
 J.R. GRIMES CONSULTING ENGINEERS
- MECHANICAL ENGINEER**
 JARRELL MECHANICAL CONTRACTORS
- PLUMBING ENGINEER**
 SYSTEMAIRE, INC.
- ELECTRICAL ENGINEER**
 PAYNE CREST ELECTRIC
- FIRE PROTECTION**
 BI-STATE FIRE PROTECTION



LABOURÉ CENTRE
 4601 HIGHWAY K
 O'FALLON, MISSOURI



THOMAS ROOF INC. ARCHITECTS
 8251 Maryland Ave., Suite 300
 St. Louis, Missouri 63105
 314-726-9990
 Fax: 314-726-9991
 www.thomasroof.com
 © Copyright 2004

DATE: 02/13/04

REVISIONS

PER CITY, DUCKETT CREEK
 & MODOT COMMENTS 04/06/04

DWG. BY: JLW
PROJECT NO.: 1004B
SHEET NO.:

C7.1
 PAVEMENT DETAILS

P&Z FILE # 0704/0704.01