

FINAL SURVEY PLOTTED DATE: BY: SURVEYED BY: DATE: PLOTTED BY: DATE: NOTE BOOK NO. AREAS CHECKED:

ORIGINAL SURVEY PLOTTED DATE: BY: SURVEYED BY: DATE: PLOTTED BY: DATE: NOTE BOOK NO. AREAS CHECKED:

NOTE: The Horizontal And Vertical Locations Of The Centerlines At The Existing Ends Of Pavements Of Oak Knoll Dr. And Oak Forest Dr Shall Be Verified For Continuity With The Information As Shown Upon These Drawings.

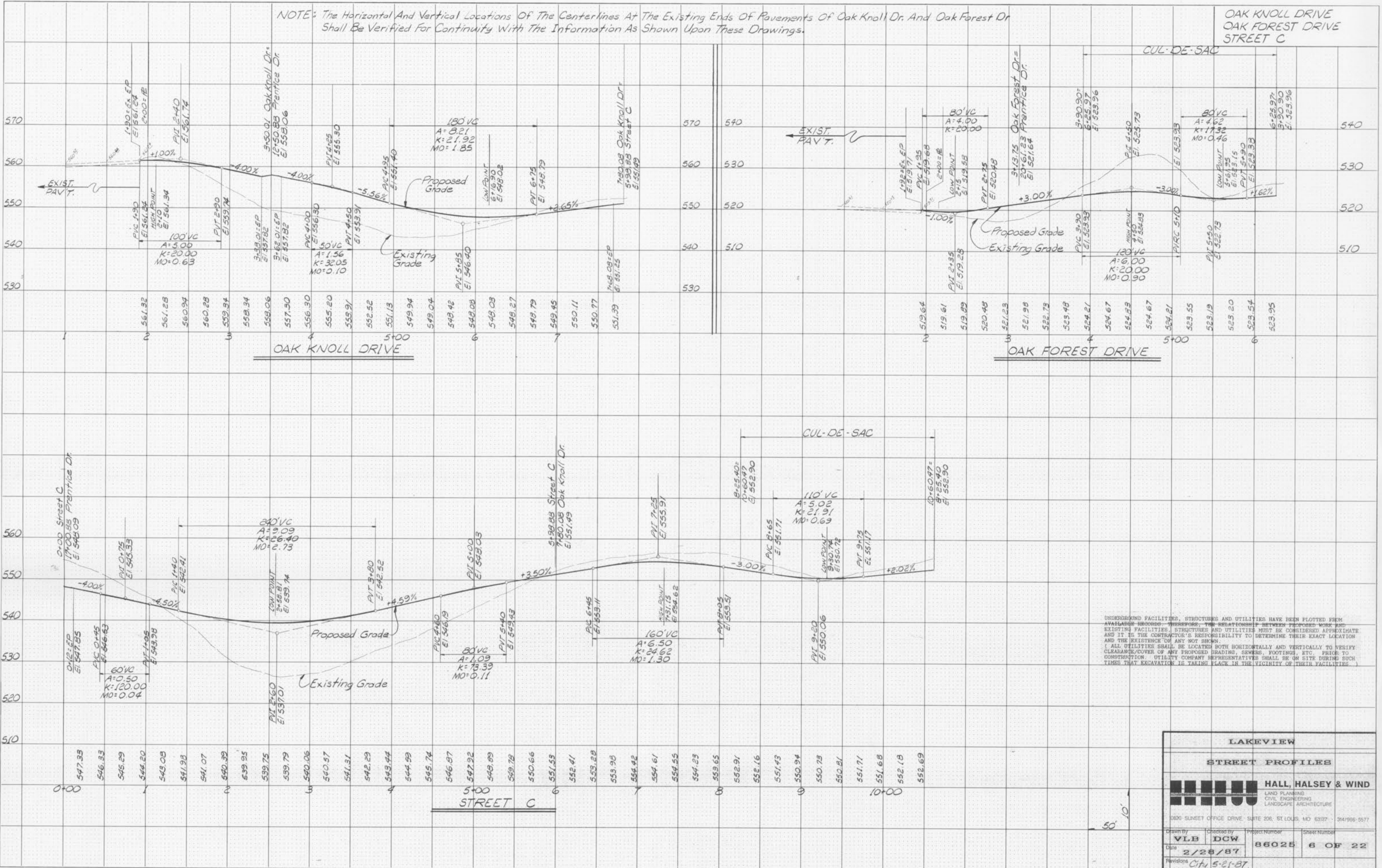

UNDERGROUND FACILITIES, STRUCTURES AND UTILITIES HAVE BEEN PLOTTED FROM AVAILABLE RECORDS - THEREFORE - THE RELATIONSHIP BETWEEN PROPOSED WORK AND EXISTING FACILITIES, STRUCTURES AND UTILITIES MUST BE CONSIDERED APPROXIMATE AND IT IS THE CONTRACTOR'S RESPONSIBILITY TO DETERMINE THEIR EXACT LOCATION AND THE EXISTENCE OF ANY NOT SHOWN. ALL UTILITIES SHALL BE LOCATED BOTH HORIZONTALLY AND VERTICALLY TO VERIFY CLEARANCE/COVER OF ANY PROPOSED GRADES, SEWERS, FOOTINGS, ETC. PRIOR TO CONSTRUCTION. UTILITY COMPANY REPRESENTATIVES SHALL BE ON SITE DURING SUCH TIMES THAT EXCAVATION IS TAKING PLACE IN THE VICINITY OF THEIR FACILITIES.

LAKEVIEW

STREET PROFILES

HALL, HALSEY & WIND

LAND PLANNING
CIVIL ENGINEERING
LANDSCAPE ARCHITECTURE

0820 SUNSET OFFICE DRIVE, SUITE 200, ST. LOUIS, MO 63127 - 314/996-5577

Drawn by VLB	Checked by DCW	Project Number 86025	Sheet Number 6 OF 22
Date 2/28/87			
Revisions City 5-21-87			