

**STORM SEWER PROFILE**  
 SCALES:  
 HORIZ. 1"=50'  
 VERT. 1"=10'

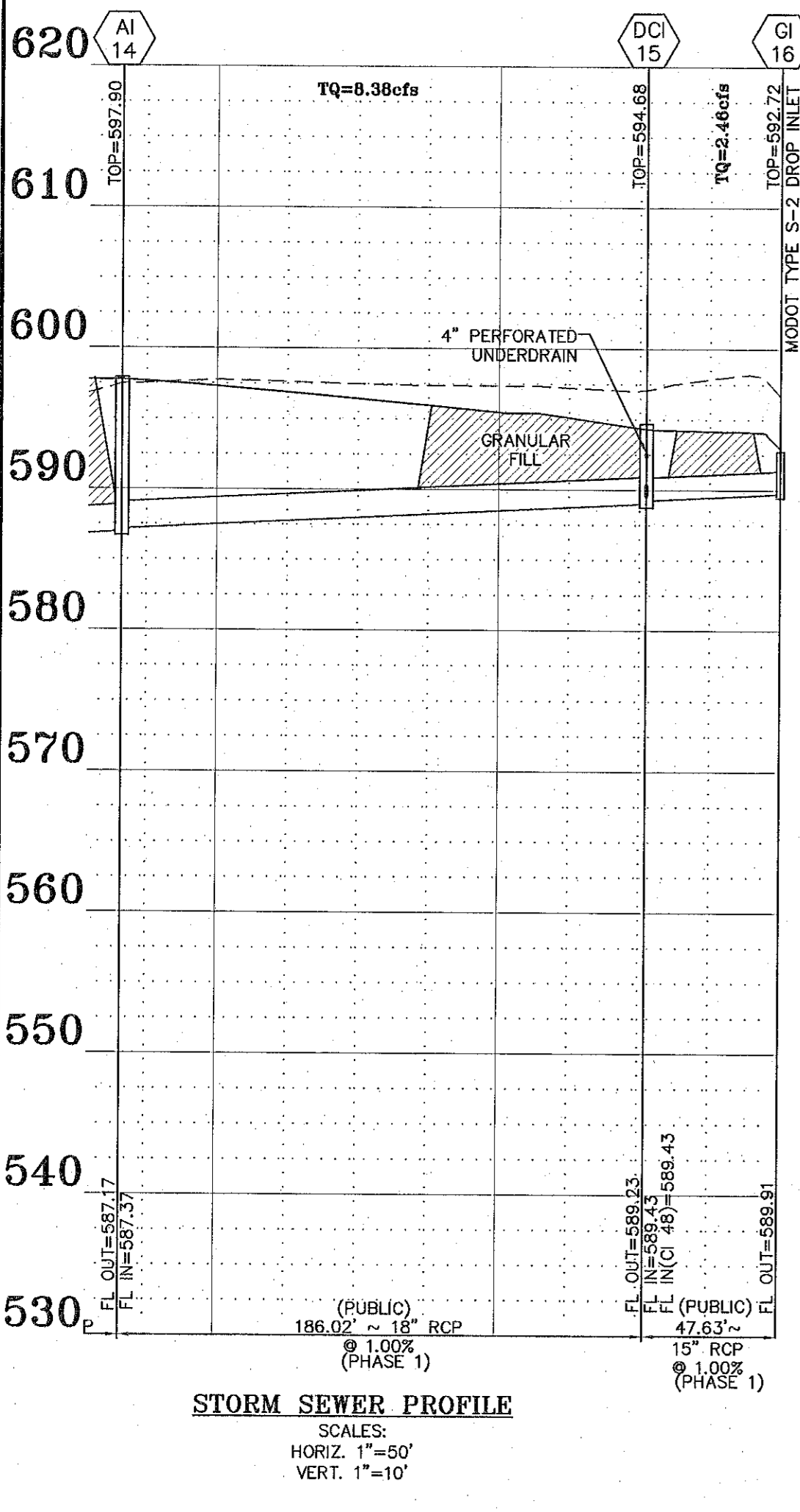

**STORM SEWER PROFILE**  
 SCALES:  
 HORIZ. 1"=50'  
 VERT. 1"=10'

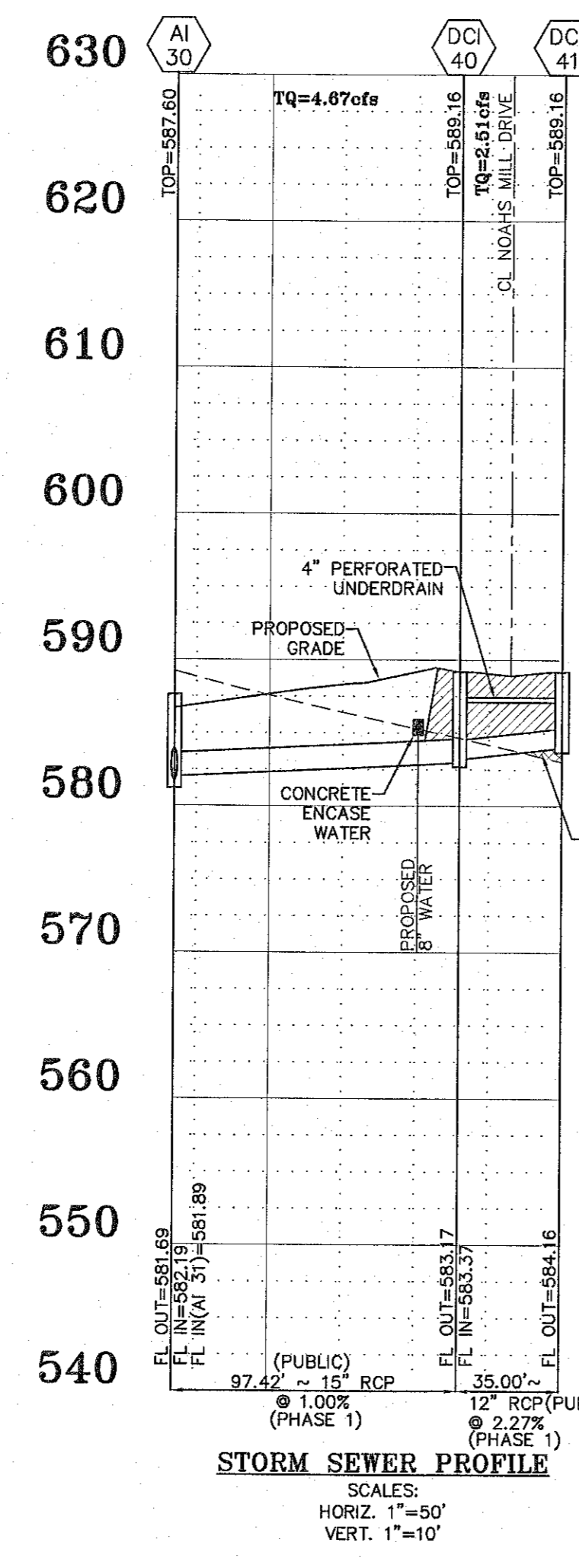

**STORM SEWER PROFILE**  
 SCALES:  
 HORIZ. 1"=50'  
 VERT. 1"=10'

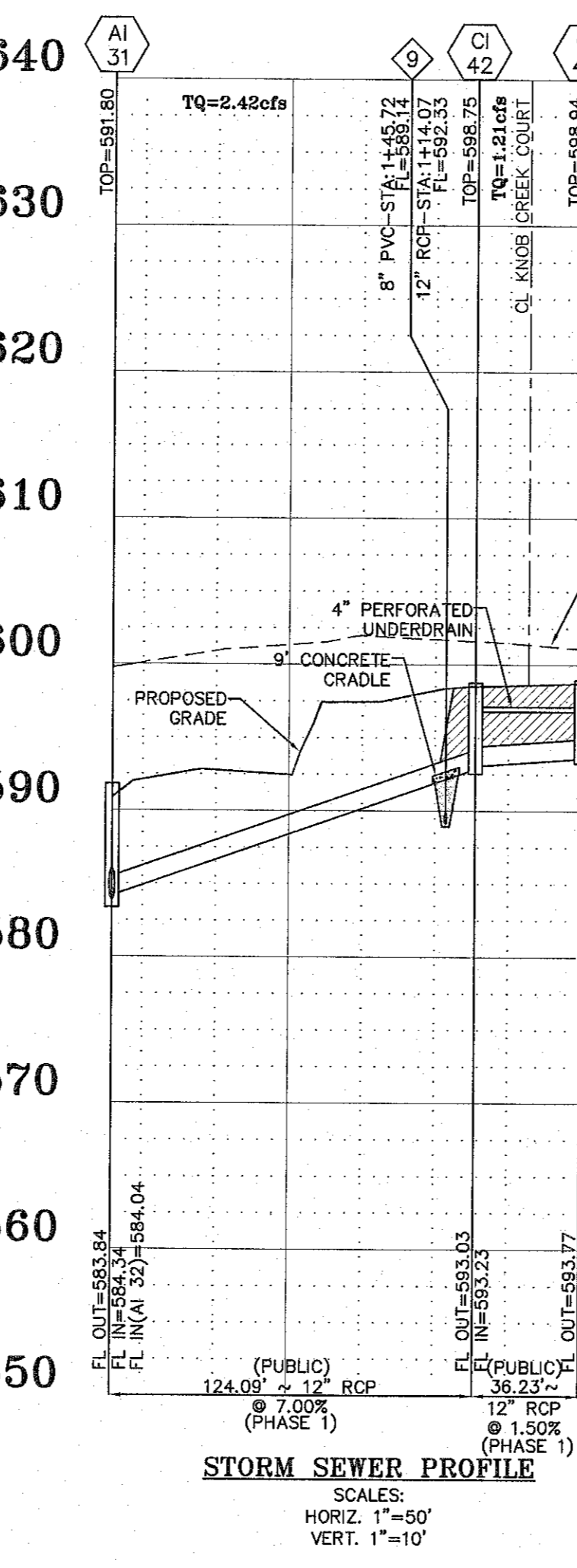

**STORM SEWER PROFILE**  
 SCALES:  
 HORIZ. 1"=50'  
 VERT. 1"=10'

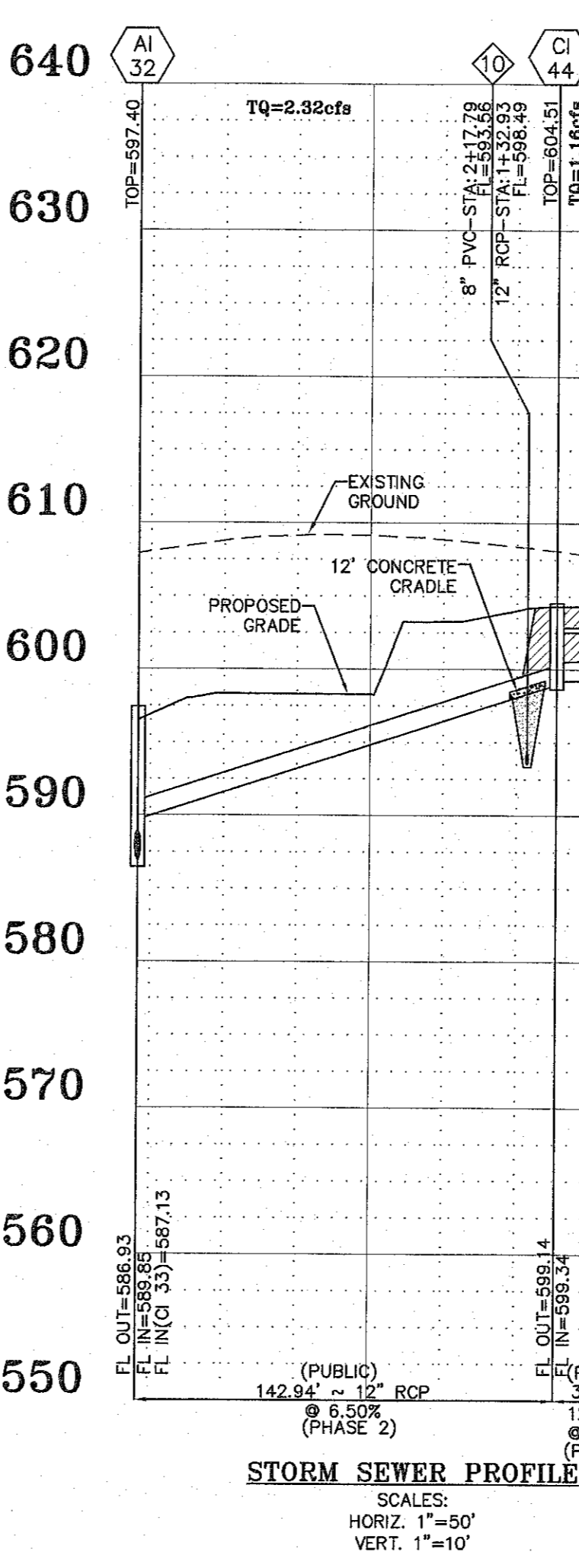

**STORM SEWER PROFILE**  
 SCALES:  
 HORIZ. 1"=50'  
 VERT. 1"=10'

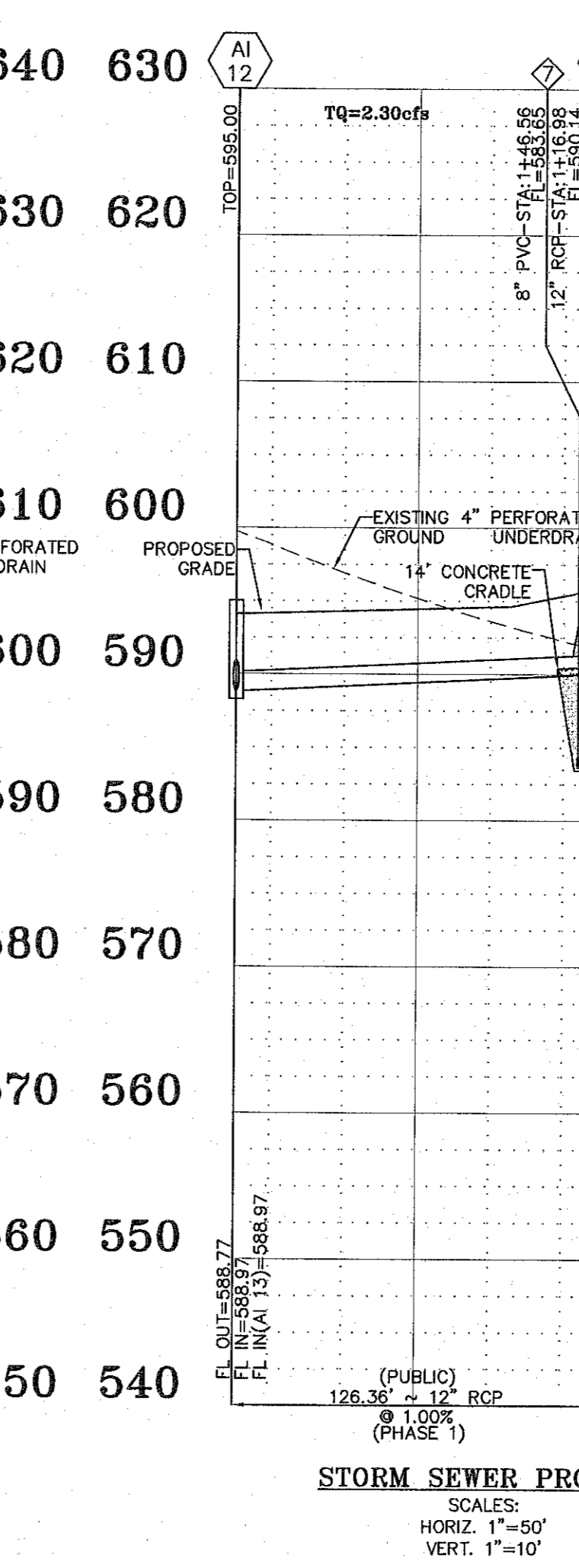

**STORM SEWER PROFILE**  
 SCALES:  
 HORIZ. 1"=50'  
 VERT. 1"=10'

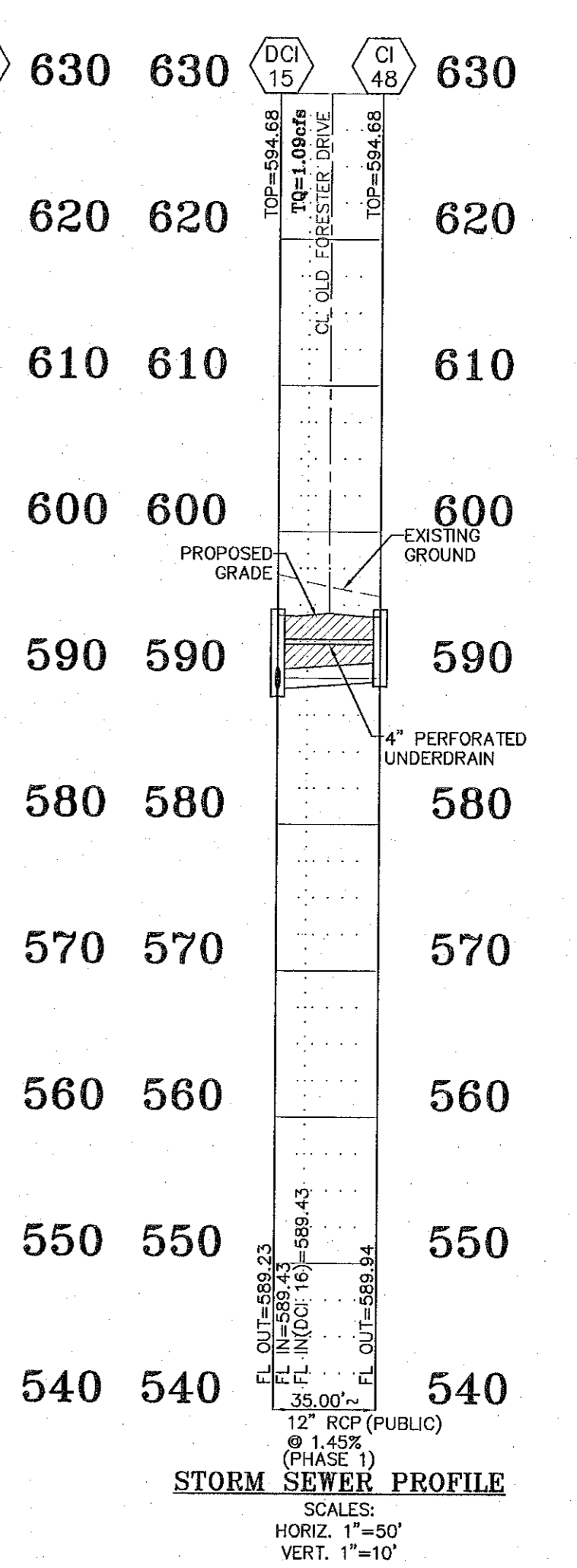

**STORM SEWER PROFILE**  
 SCALES:  
 HORIZ. 1"=50'  
 VERT. 1"=10'

**PROJECT TITLE:**  
**LEGENDS POINTE**  
 (formerly THE VILLAGES  
 AT RHODES FARM)

**ENGINEERING**  
**PLANNING**  
**SURVEYING**  
 221 Point West Blvd.  
 St. Charles, MO 63301  
 636-928-5552  
 FAX 636-928-1718

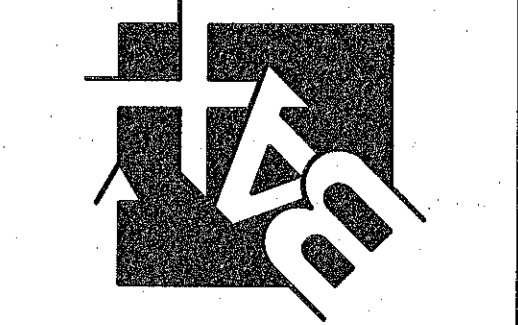

**DISCLAIMER OF RESPONSIBILITY**  
 I hereby certify that the documents intended to be authorized by my seal are limited to this sheet, and I hereby disclaim any responsibility for all other drawings, specifications, estimates, reports or other documents or instruments existing or intended to be used for any part or parts of the architectural or engineering project or survey.

**JEFFREY B. SIMMONS**  
 PROFESSIONAL ENGINEER  
 No. 2007030831  
 2-21-2017  
 Jeffrey B. Simmons  
 CIVIL ENGINEER  
 2007030831  
 Copyright 2017  
 Box Engineering Company, Inc.  
 Authority No. 000655  
 All Rights Reserved

**REVISIONS**

DATE	BY	DESCRIPTION
10/03/17	P.W.S.D./J2	COMMENTS
10/24/17	CLIENT	COMMENTS
10/31/17	DUCKETT	COMMENTS
11/01/17	CLIENT	COMMENTS
11/05/17	CITY	COMMENTS
11/29/17	MODDT	COMMENTS
12/13/17	MODDT	COMMENTS
12/21/17	CLIENT	COMMENTS

**Developer / Owner:**  
 KAPB, L.L.C.  
 410 CRESTVIEW DRIVE  
 OFALLON, MO 63366  
 636-272-4200

**STORM SEWER PROFILES**

**P+Z No.**  
 #27-15.05, 05/11/17

**City No.**  
 #CITY