

**SWPPP BEST MANAGEMENT PRACTICE NOTES:**

- A. PURPOSE:**
- THE PURPOSE OF THE STORM WATER POLLUTION PREVENTION PLAN (SWPPP) SHALL MEET THE FOLLOWING OBJECTIVES:
- PREVENT EROSION WHERE CONSTRUCTION ACTIVITIES SHALL OCCUR.
  - PREVENT POLLUTANTS FROM MIXING WITH STORM WATER.
  - PREVENT POLLUTANTS FROM BEING DISCHARGED BY TRAPPING THEM ON-SITE, BEFORE THEY CAN AFFECT THE RECEIVING WATERS.
- B. PROJECT DESCRIPTION:**
- THE PROJECT IS LOCATED IN THE DARDENE CREEK WATERSHED IN ST. CHARLES COUNTY, MISSOURI. THE PROJECT IS APPROXIMATELY 79.615 ACRES WITH 1.50 ACRES BEING DISTURBED.
- THE PROJECT ACTIVITIES CONSIST OF CLEARING AND EXCAVATING THE SITE TO CONSTRUCT AN ADDITION TO AN EXISTING HIGH SCHOOL. THE SITE WILL BE PROTECTED WITH THE VARIOUS EROSION PROTECTION MEASURES LISTED BELOW:
1. **SILT FENCES:** ALL STORM WATER INLET STRUCTURES SHALL BE PROTECTED WITH SILT FENCES. THESE FENCES WILL BE CONSTRUCTED USING STRAW BALES IN A CIRCULAR PATTERN AROUND ANY INLET DEVICE.
- THE ENTIRE PERIMETER OF THE PROJECT THAT ALLOWS STORM WATER TO EXIT WILL ALSO HAVE SILT FENCES INSTALLED. THESE FENCES SHALL BE COMPOSED OF EITHER STRAW BALES OR A FABRIC MATERIAL. DETAILS OF THESE DEVICES ARE DEPICTED ON THE CONSTRUCTION PLANS PREPARED BY BAX ENGINEERING COMPANY, INC. AND ATTACHED.
  2. **REVEGETATION:** THE SITE WILL CONSIST OF VARYING GROUND SLOPES UPON COMPLETION OF THE GRADING ACTIVITIES AND THE SLOPE PRONE TO EROSION WILL BE SEEDED AND STRAWED TO STABILIZE THE SLOPE AND PREVENT EROSION.

**C. MAINTENANCE AND INSPECTION:**

**REGULAR MAINTENANCE:** BI-MONTHLY INSPECTIONS OF THE PROJECT WILL INCLUDE: (A) THE REPAIR OF ANY SEDIMENT (SILT) FENCE AND/OR STAKED STRAW BALE BARRIERS NOT WELL SHAPED OR OUT OF PLACE; (B) THE REMOVAL OF ANY ACCUMULATED TRASH AND/OR DEBRIS; (C) THE CLEARING OF DEBRIS, WEEDS AND WILD GROWTH AND THE REMOVAL OF VEGETATION WHERE NECESSARY.

**PERIODIC INSPECTIONS:** FOLLOWING EACH RAIN OF MORE THAN HALF AN INCH, THE SITE WILL BE INSPECTED, AND ANY NECESSARY MAINTENANCE WILL BE PROVIDED FOR A PERIOD OF ONE YEAR FOLLOWING THE COMPLETION OF THE ABOVE REMEDIATION MEASURES.

THE FIELD INSPECTIONS WILL BE CONDUCTED IN A SYSTEMATIC MANNER TO MINIMIZE THE POSSIBILITY OF ANY SIGNIFICANT FEATURE BEING OVERLOOKED. PARTICULAR ATTENTION WILL BE GIVEN TO DETECTING EVIDENCE OF EROSION, SLOPE INSTABILITY, UNDESIRABLE SETTLEMENT, DISPLACEMENT, AND TILTING. THE FIELD INSPECTION WILL INCLUDE APPROPRIATE FEATURES AND ITEMS, INCLUDING POTENTIAL HAZARDS TO HUMAN LIFE OR PROPERTY. THE CONDITION OF THE SLOPES AND VEGETATIVE COVER WILL BE EVALUATED AND EXAMINED FOR EROSION.

MEASURES WILL BE TAKEN TO PROMOTE THE GROWTH OF VEGETATION AND REPAIR OF DAMAGE CAUSED BY EROSION AND SEDIMENTATION. THE INSPECTOR WILL ALSO PROVIDE RECOMMENDATIONS FOR MEASURES THAT NEED TO BE UNDERTAKEN IMMEDIATELY, BASED ON THE EXPERIENCE AND JUDGMENT OF THE INSPECTOR. NECESSARY FOLLOW UP INSPECTIONS WILL BE MADE AS NECESSARY TO VERIFY THAT ANY MAINTENANCE, ALTERATION, OR REPAIR MEASURES ARE ACCOMPLISHED BY METHODS ACCEPTABLE BY STANDARD ENGINEERING PRACTICE.

THIS SITE COMPLETES WITH PHASE II ILLICIT STORM WATER DISCHARGE GUIDELINES PER ORDINANCE 5082 BY PROVIDING THE NECESSARY SILTATION CONTROL MEASURES AS OUTLINED ON THE PLAN SET.

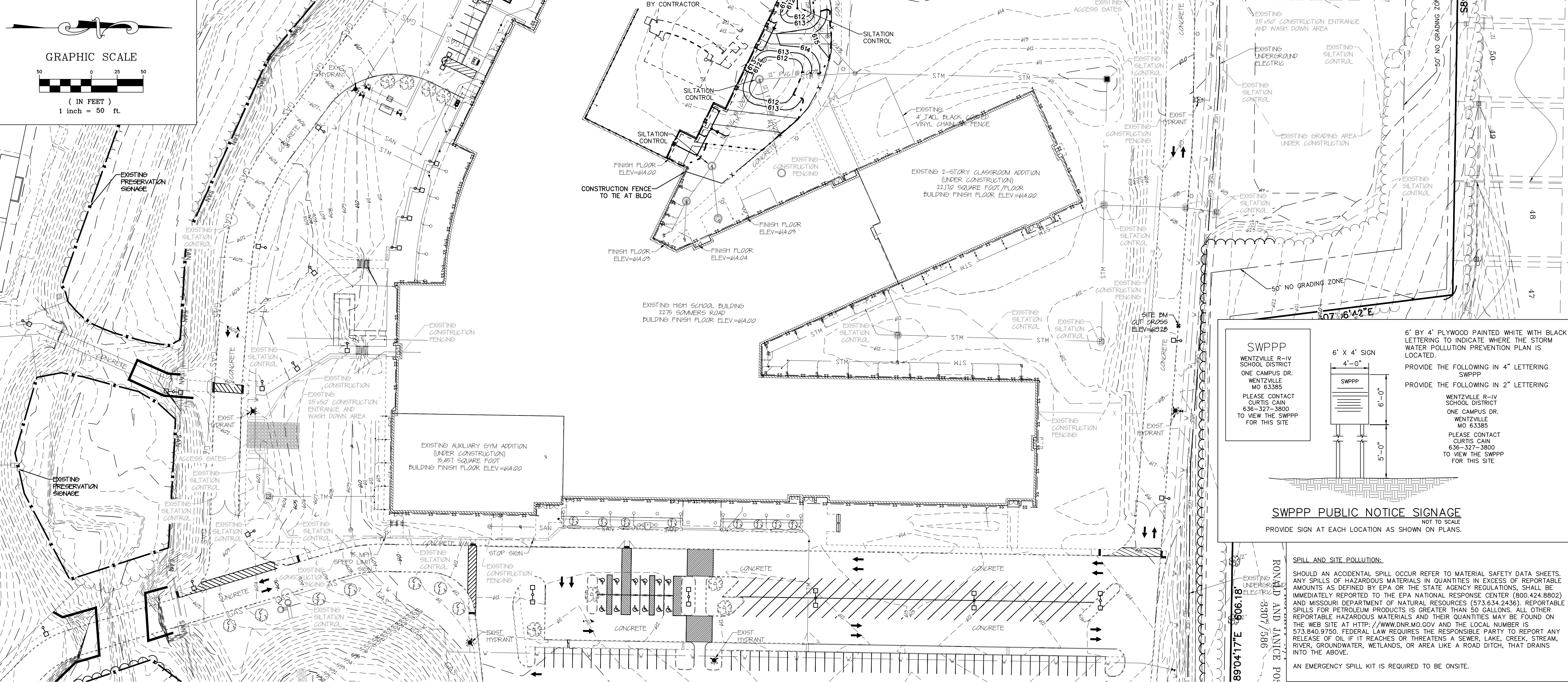
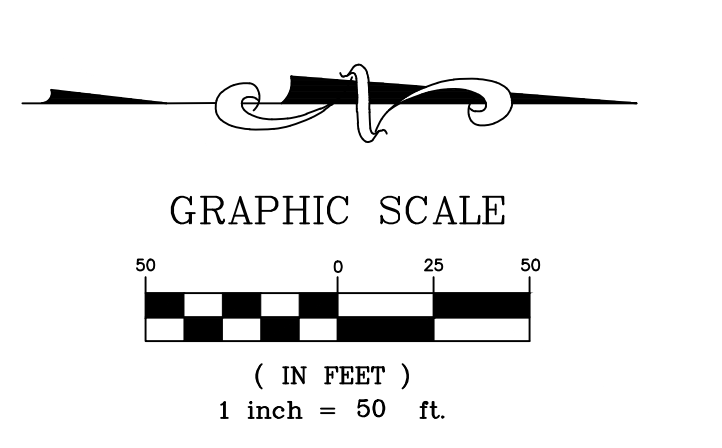

**SWPPP**  
WENTZVILLE R-IV SCHOOL DISTRICT  
ONE CAMPUS DR.  
WENTZVILLE MO 63385  
PLEASE CONTACT CURTIS CAIN 636-327-3800 TO VIEW THE SWPPP FOR THIS SITE

**6' X 4' SIGN**  
4'-0"  
SWPPP  
4'-0"  
5'-0"

**SWPPP PUBLIC NOTICE SIGNAGE**  
NOT TO SCALE  
PROVIDE SIGN AT EACH LOCATION AS SHOWN ON PLANS.

6' BY 4' PLYWOOD PAINTED WHITE WITH BLACK LETTERING TO INDICATE WHERE THE STORM WATER POLLUTION PREVENTION PLAN IS LOCATED.  
PROVIDE THE FOLLOWING IN 4" LETTERING SWPPP  
PROVIDE THE FOLLOWING IN 2" LETTERING

WENTZVILLE R-IV SCHOOL DISTRICT  
ONE CAMPUS DR.  
WENTZVILLE MO 63385  
PLEASE CONTACT CURTIS CAIN 636-327-3800 TO VIEW THE SWPPP FOR THIS SITE

**SPILL AND SITE POLLUTION:**

SHOULD AN ACCIDENTAL SPILL OCCUR REFER TO MATERIAL SAFETY DATA SHEETS. ANY SPILLS OF HAZARDOUS MATERIALS IN QUANTITIES IN EXCESS OF REPORTABLE AMOUNTS AS DEFINED BY EPA OR THE STATE AGENCY REGULATIONS, SHALL BE IMMEDIATELY REPORTED TO THE EPA NATIONAL RESPONSE CENTER (800.424.8802) AND MISSOURI DEPARTMENT OF NATURAL RESOURCES (573.634.2436). REPORTABLE SPILLS FOR PETROLEUM PRODUCTS IS GREATER THAN 50 GALLONS. ALL OTHER REPORTABLE HAZARDOUS MATERIALS AND THEIR QUANTITIES MAY BE FOUND ON THE WEB SITE AT [HTTP://WWW.DNR.MO.GOV](http://www.dnr.mo.gov) AND THE LOCAL NUMBER IS 573.840.9750. FEDERAL LAW REQUIRES THE RESPONSIBLE PARTY TO REPORT ANY RELEASE OF OIL IF IT REACHES OR THREATENS A SEWER, LAKE, CREEK, STREAM, RIVER, GROUNDWATER, WETLANDS, OR AREA LIKE A ROAD DITCH, THAT DRAINS INTO THE ABOVE.

AN EMERGENCY SPILL KIT IS REQUIRED TO BE ONSITE.

**PROJECT TITLE:**  
LIBERTY HIGH SCHOOL AUDITORIUM ADDITION

**Bax Project #10-15036E**



**DISCLAIMER OF RESPONSIBILITY**  
I hereby specify that the documents intended to be authenticated by my seal are limited to this sheet, and I hereby disclaim any responsibility for all other Drawings, Specifications, Estimates, Reports or other documents or instruments relating to or intended to be used for any part or parts of the architectural or engineering project or survey.

CLIFFORD L. HEITMANN  
CIVIL ENGINEER  
E29817  
Copyright 2016  
Bax Engineering Company, Inc.  
Authority No. 000655  
All Rights Reserved.

1-21-16 CITY COMMENTS

**Developer / Owner:**  
WENTZVILLE R-IV SCHOOL DISTRICT  
ONE CAMPUS DRIVE  
WENTZVILLE, MO 63385  
636-327-3800

**SWPPP PLAN/DETAILS**

**P+Z No.** #29-11.05  
**City No.** 16-000216  
**Page No.** 9 of 10