

WEST ENTRANCE WARPING,
PLAN

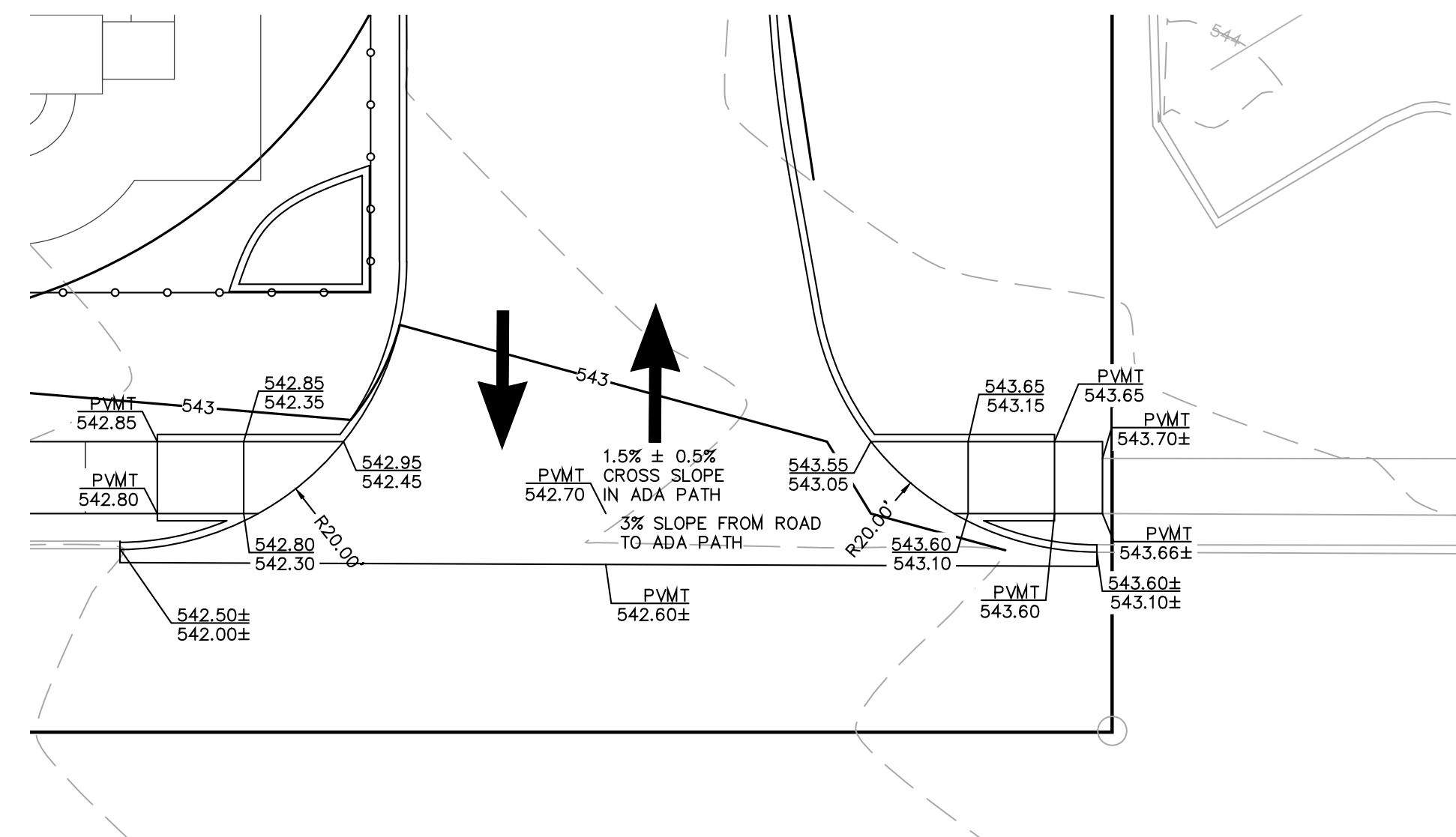

EAST ENTRANCE WARPING,
PLAN

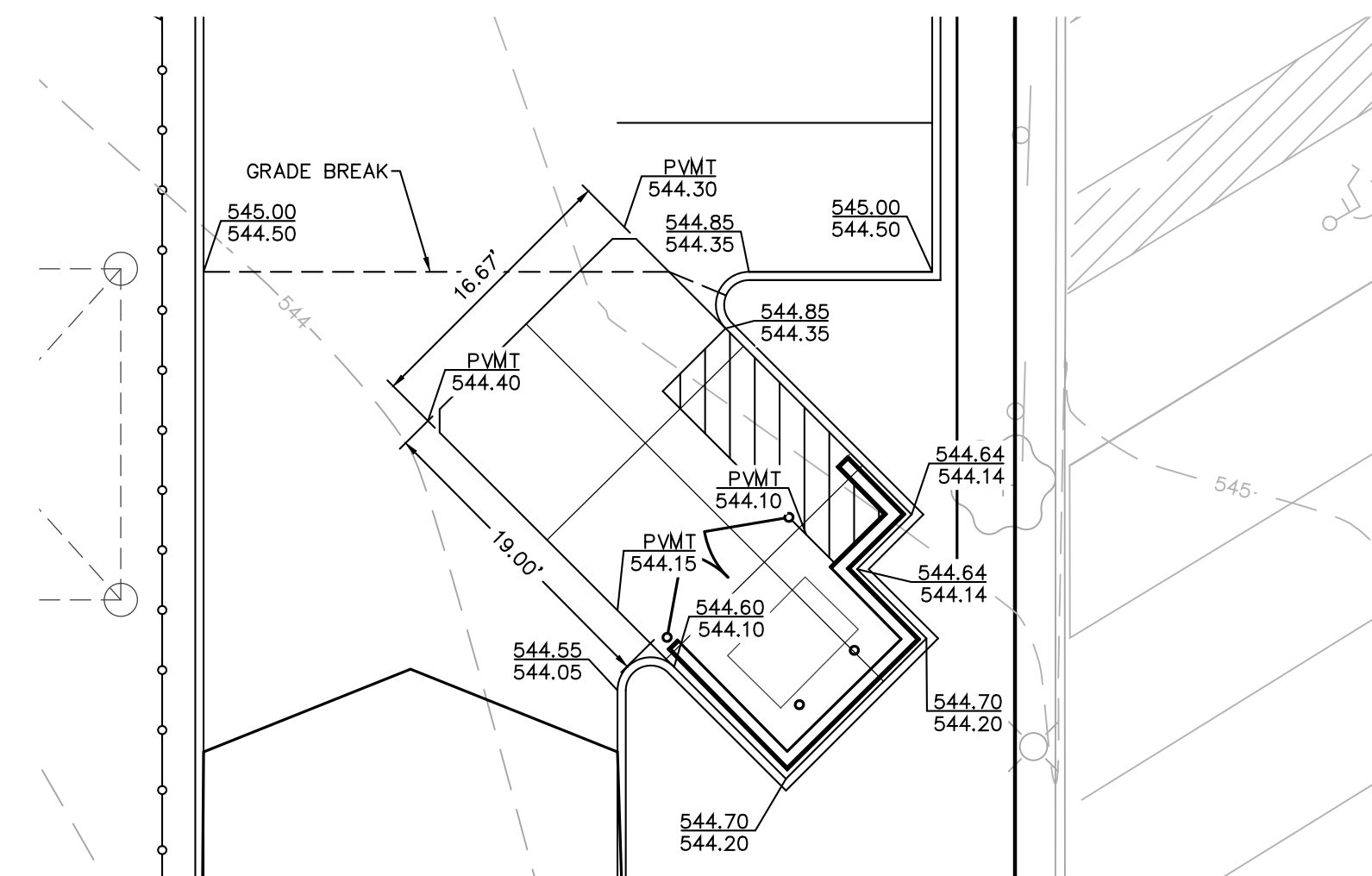

TRASH ENCLOSURE PLAN

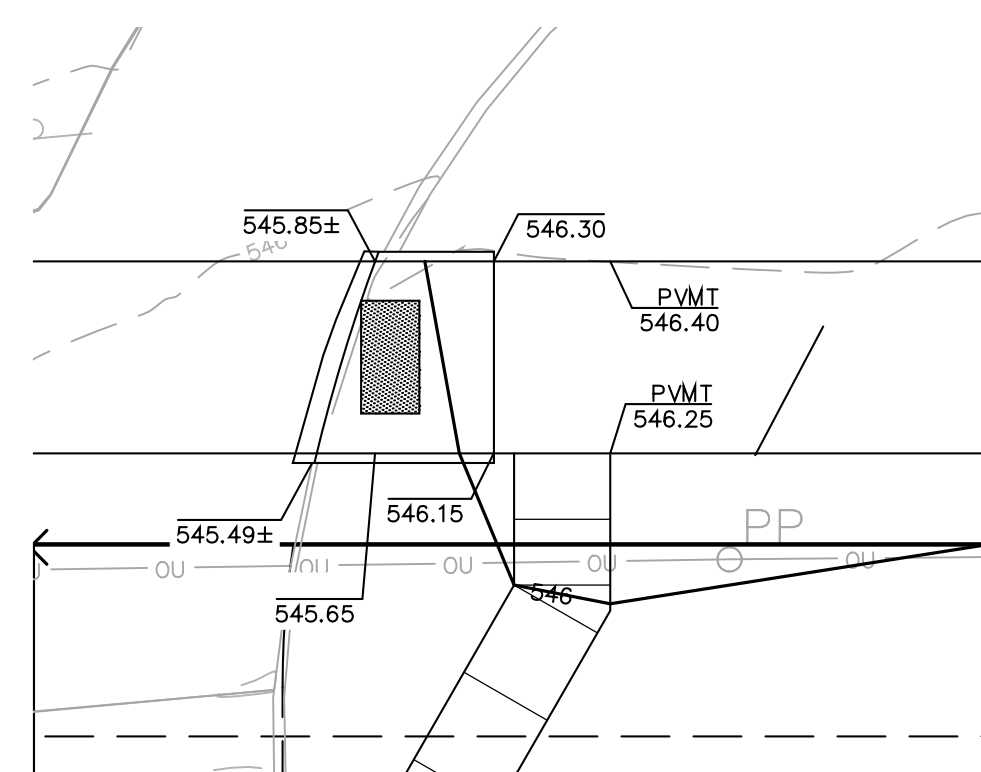

ADA RAMP AT
ASPHALT TRAIL PLAN

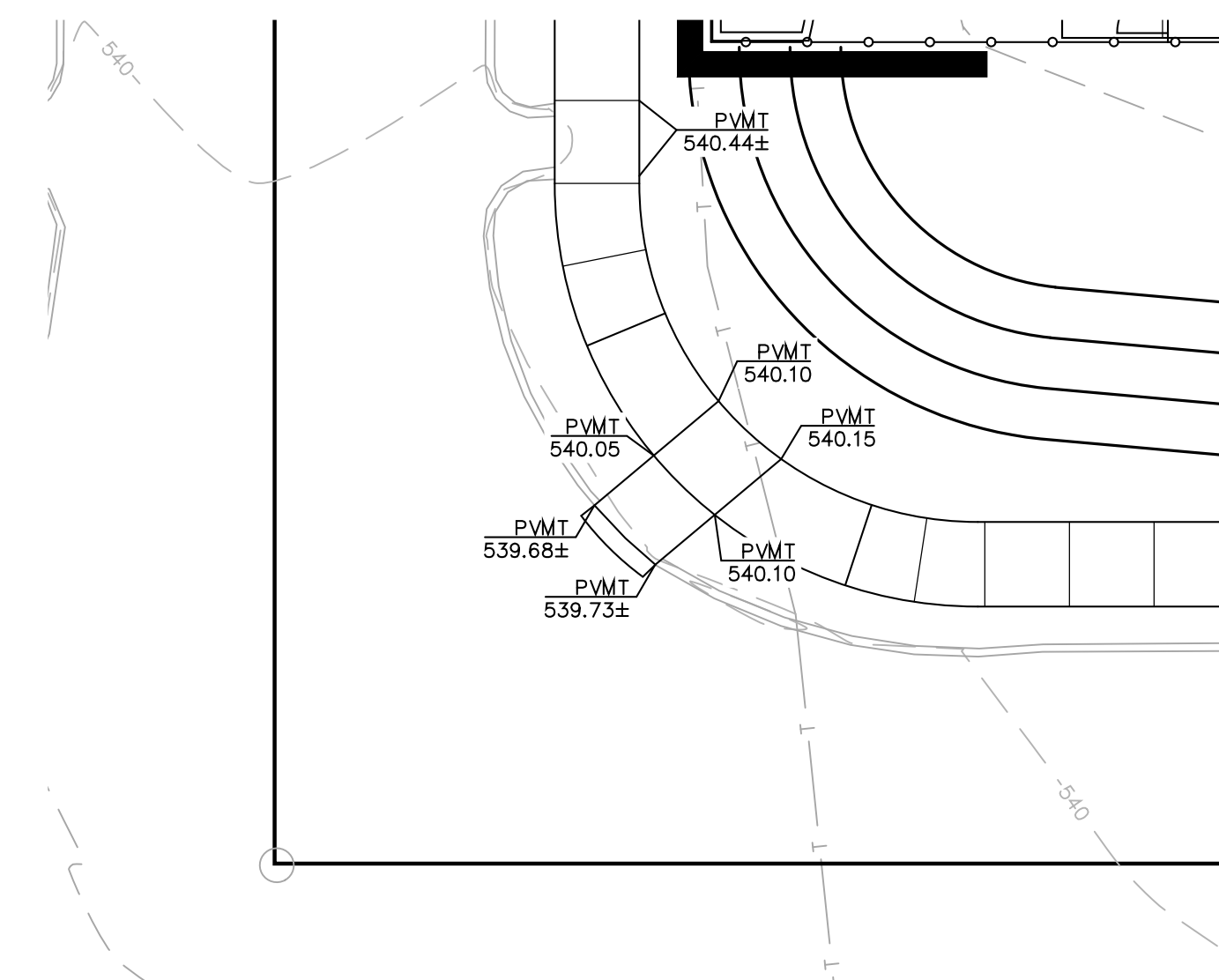

ADA RAMP PLAN
(INTERSECTION OF
DISCOVERY DRIVE &
PRIVATE DRIVE)

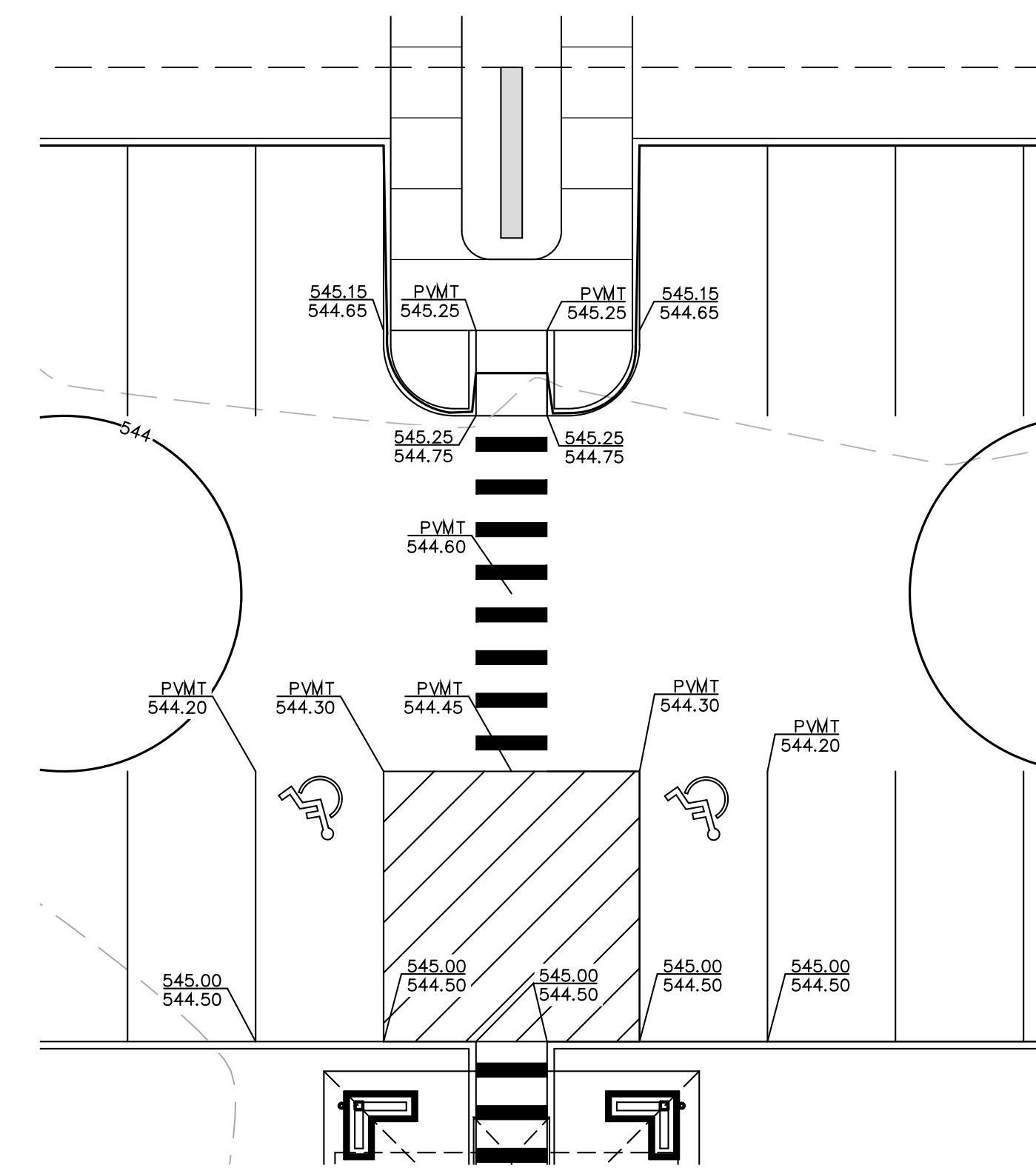

ADA PARKING GRADING PLAN

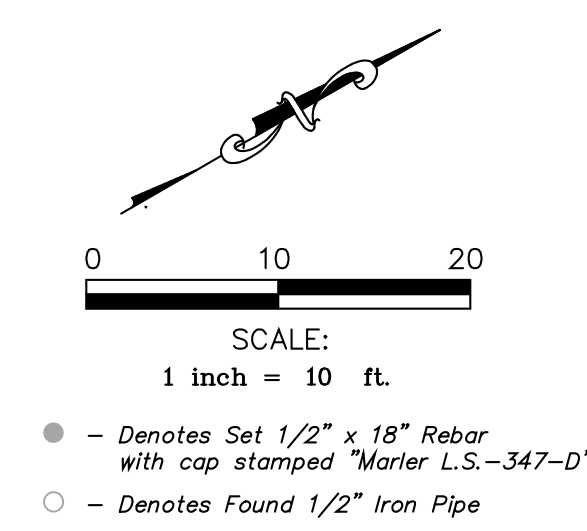

● - Denotes Set 1/2" x 18" Rebar
With cap stamped "Marler L.S.-347-D"
○ - Denotes Found 1/2" Iron Pipe

BRANDON A. HARP, P.E. -28650
PROFESSIONAL ENGINEER
CEDC LICENSE NO.: 2003004674

10820 Sunset Office Drive
Suite 200
Saint Louis, Missouri 63127
314.729.1400
Fax: 314.729.1404
www.cedc.net

CEDC
CIVIL ENGINEERING
DESIGN CONSULTANTS

Site Improvement Plans for
LITTLE SUNSHINE PLAYHOUSE & PRESCHOOL
4220 Highway K
O'Fallon, Missouri 63368

No.	Description	Date
	To Utilities	05/22/18
	Bid Set	05/30/18
	To City	06/21/18
	To City	07/17/18
	To City	08/03/18

ENLARGED SITE
PLAN

C05