

PROPOSED LONGHORN STEAKHOUSE AT THE SHOPS AT LAURA HILL LAURA HILL ROAD & STATE HIGHWAY K O'FALLON, ST. CHARLES COUNTY, MISSOURI

BLDG. CONST. USE
APPROVED
AS NOTED
7-27-99

Chris Linnemphal

UTILITY CONTACT LIST:

<p>GAS:</p> <p>ST. CHARLES GAS CO. 1 WEST BURY SQUARE BUILDING D ST. CHARLES, MO 63301 CONTACT: MR. RICK NELKE PHONE: (314) 946-2422</p>	<p>TELEPHONE:</p> <p>GTE TELEPHONE OPERATIONS M0676EGW NETWORK SERVICES 680 PARR ROAD, BUILDING AA WENTZVILLE, MO 63385 CONTACT: MR. JOE RUNKLES PHONE: (314) 332-7623</p>
<p>ELECTRIC:</p> <p>AMEREN UNION ELECTRIC 200 CALLAHAN ROAD WENTZVILLE, MO 63385 CONTACT: MR. BOB LEHMAN PHONE: (314) 639-8235</p>	<p>DOT:</p> <p>STATE OF MISSOURI DEPARTMENT OF TRANSPORTATION 1590 WOODLAKE DRIVE CHESTERFIELD, MO 63017-5712 CONTACT: MR. TERRY SMITH PHONE: (314) 340-4334</p>
<p>WATER:</p> <p>PUBLIC WATER SUPPLY DISTRICT 2 ST. CHARLES COUNTY 100 WATER DR. P.O. BOX 967 O'FALLON, MO. 63366 CONTACT: MR. JEFF BLECKMAN PHONE: (314) 561-3737 EXT. 120</p>	
<p>SEWER:</p> <p>CITY OF O'FALLON 138 SOUTH MAIN ST. O'FALLON, MO. 63366 CONTACT: MR. FRANK GODWIN PHONE: (314) 240-5555 EXT. 311</p>	

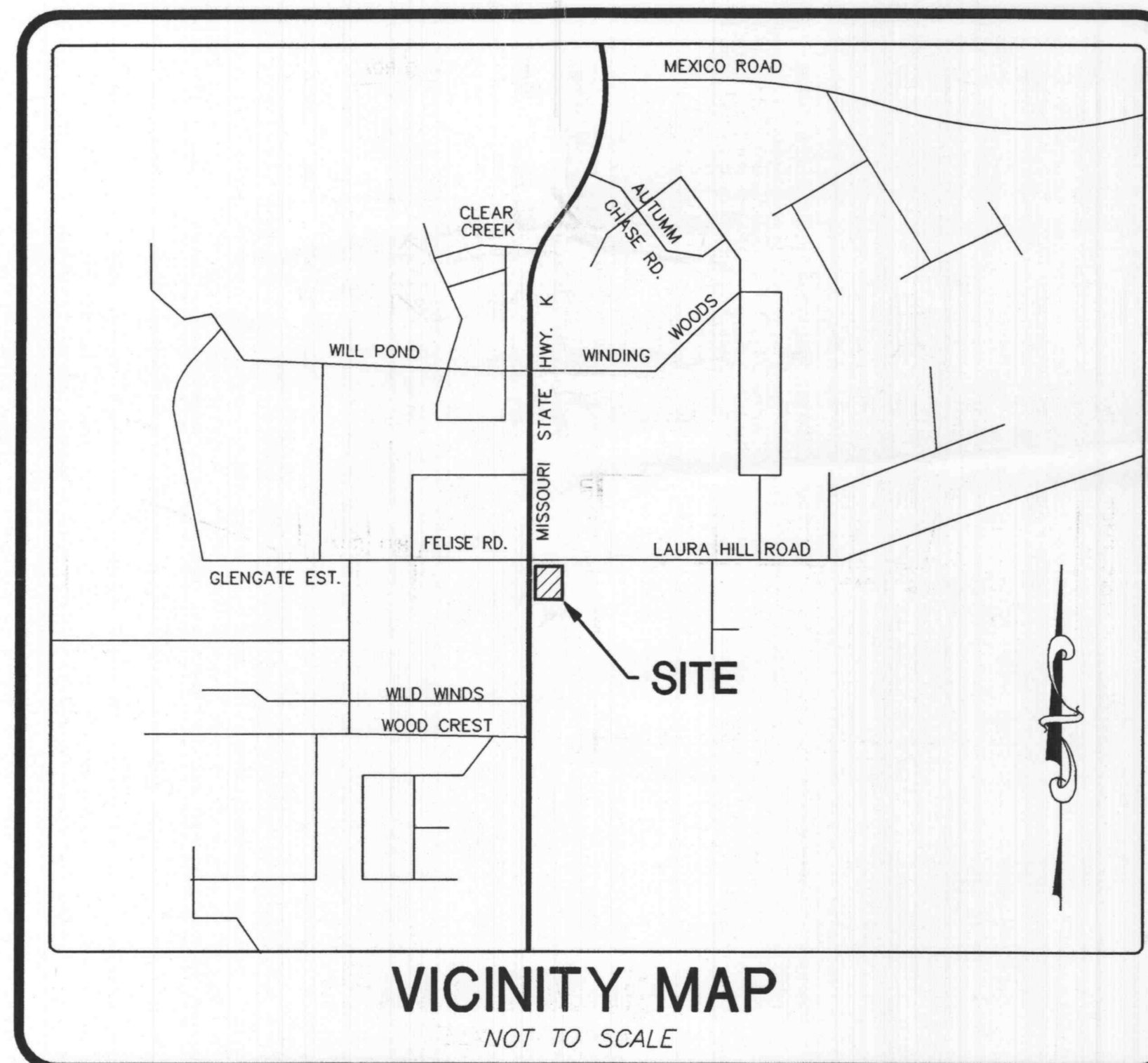

SHEET INDEX

- | | |
|-----|----------------------------------|
| 1. | COVER SHEET |
| 2. | BOUNDARY & TOPOGRAPHIC SURVEY |
| 3. | C-1 SITE PLAN |
| 4. | C-2 GRADING/EROSION CONTROL PLAN |
| 5. | C-3 UTILITY PLAN |
| 6. | C-4 STORM SEWER PROFILES |
| 7. | C-5 STANDARD DETAILS |
| 8. | C-6 STANDARD DETAILS |
| 9. | C-7 STANDARD DETAILS |
| 10. | L-1 LANDSCAPE PLAN |

NOTES:

- ALL NECESSARY INSPECTIONS AND/OR CERTIFICATIONS REQUIRED BY CODES AND/OR UTILITY SERVICE COMPANIES SHALL BE PERFORMED PRIOR TO ANNOUNCED BUILDING POSSESSION AND THE FINAL CONNECTION OF SERVICES.

ENGINEER:

WOLVERTON AND ASSOC., INC.
5600 OAKBROOK PARKWAY
SUITE 100
NORCROSS, GA 30093
PHONE: (770) 447-8999
FAX: (770) 447-9070

DEVELOPER:

RARE HOSPITALITY
8215 ROSWELL ROAD, BLDG. 600
ATLANTA, GEORGIA 30350
CONTACT: MR. JIM MITCHELL
PHONE: (770) 551-5476

