

NOTE: SPOT ELEVATIONS ALONG CURB LINE ARE TO TOP BACK OF CURB

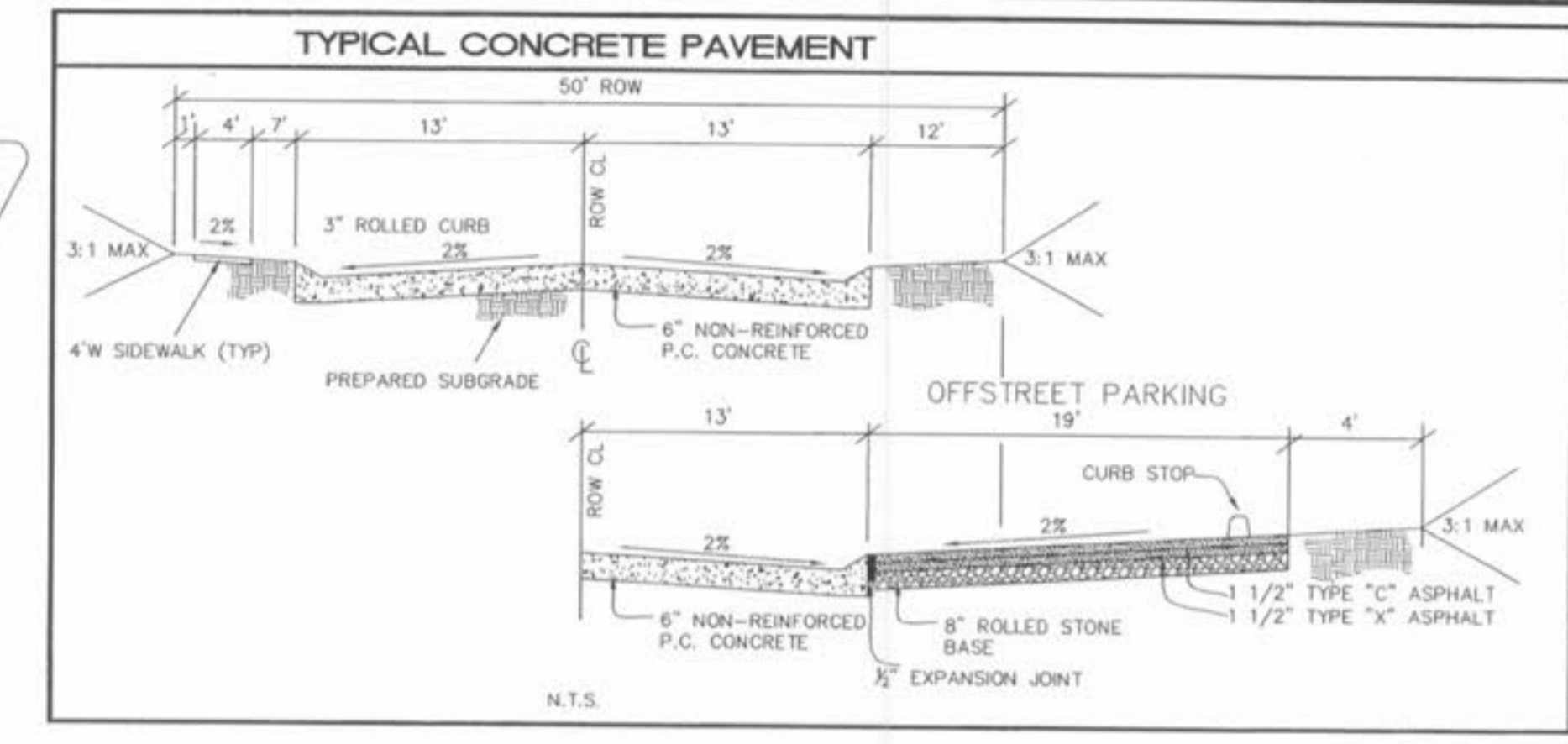

NOTE:  
White Magnolia Drive designed at 35 mph, posted at 30 mph.  
All other streets designed at 30 mph, posted at 25 mph.



NOTE:  
EARTH SUBGRADE MUST MEET CITY OF O'FALLON LOAD BEARING REQUIREMENTS. IF SOILS TESTING DETERMINES THAT THE SUBGRADE DOES NOT MEET CITY OF O'FALLON REQUIREMENTS, THEN THE SUBGRADE SHALL HAVE A LIME STABILIZATION BASE OR EQUAL AS APPROVED BY THE CITY OF O'FALLON.

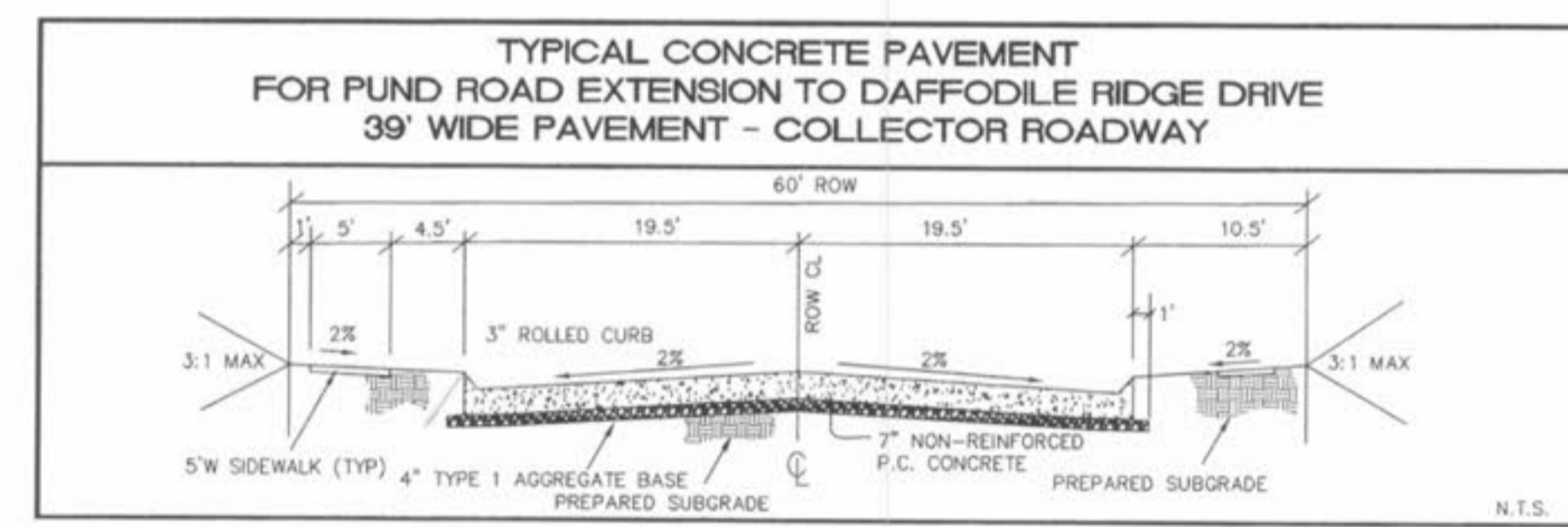
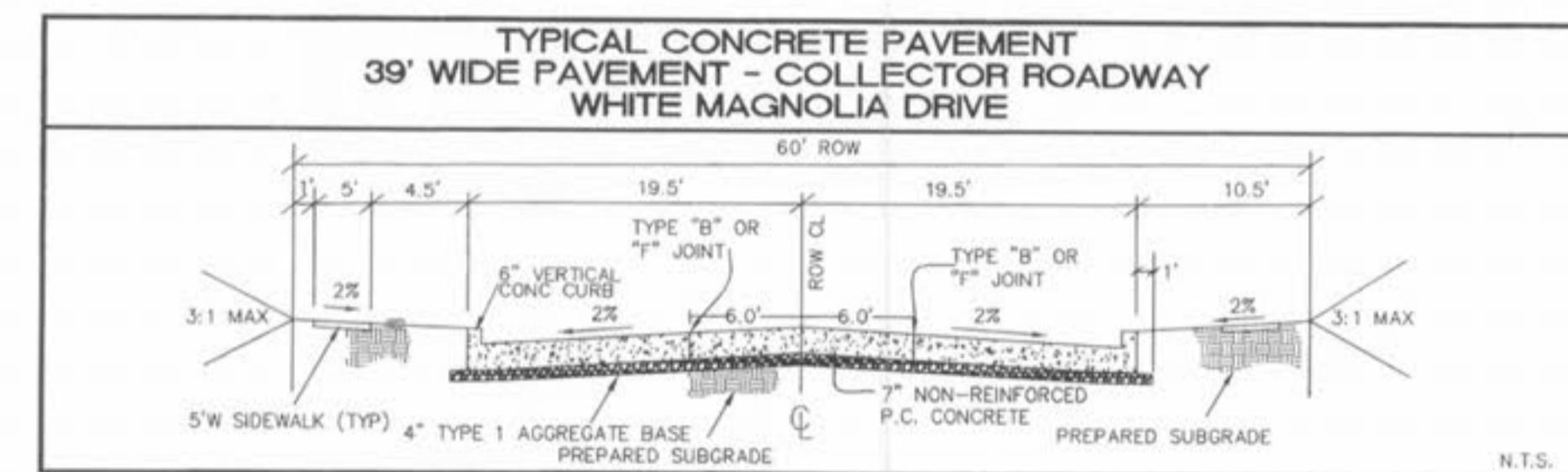

TYPICAL ROAD SECTIONS

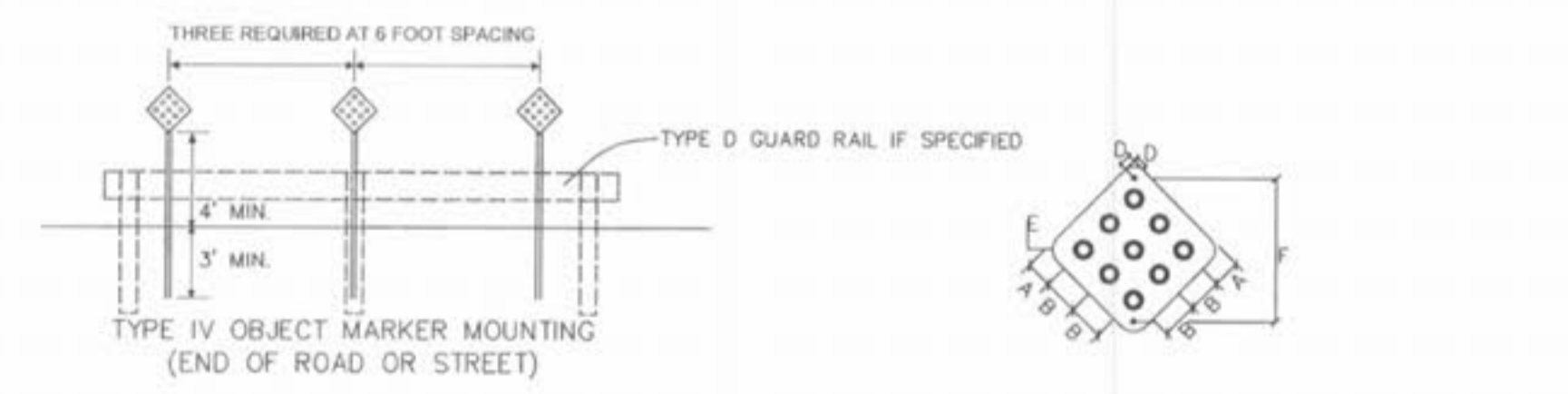
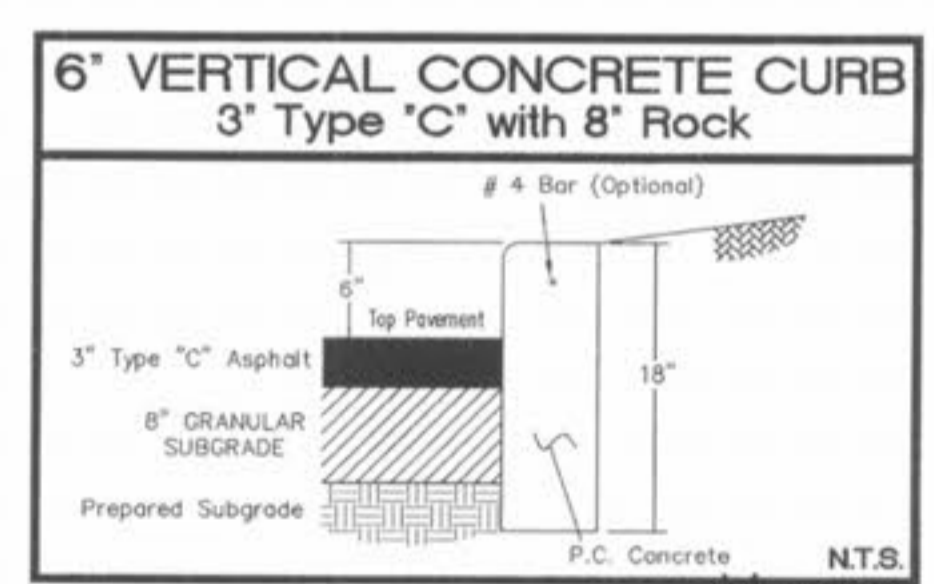
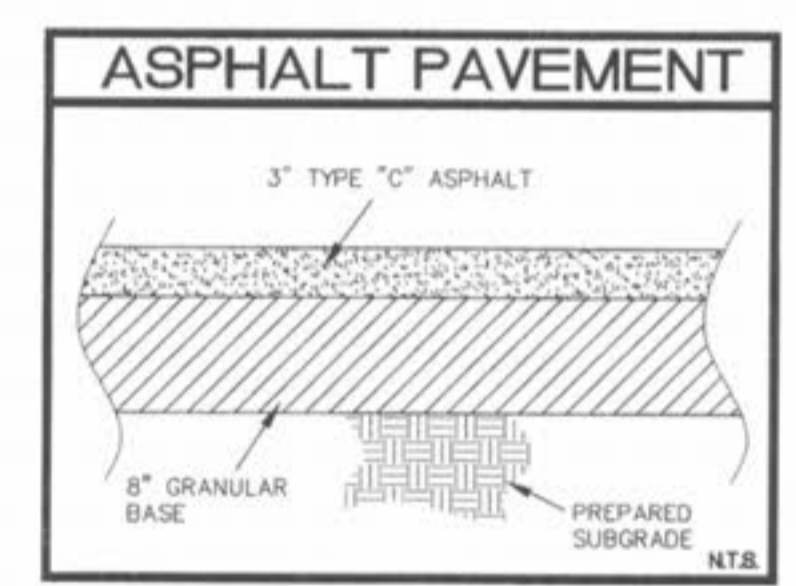

SIGN NO OM4  
OBJECT MARKER - SEE DETAIL THIS SHEET

SIGN	A	B	C	D	E	F
18" x 18"	3-11/16"	5-5/16"	3-1/4"	1-1/4"	1-1/2" R	22"

TYPE IV OBJECT MARKER  
RED REFLECTOR ON RED BACKGROUND  
THICKNESS OF FLAT SHEET FOR TYPE IV  
OBJECT MARKER SHALL BE 0.063"

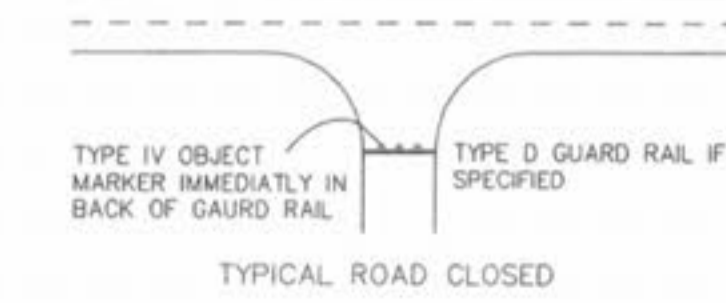

BARRICADE DETAIL  
N.T.S.

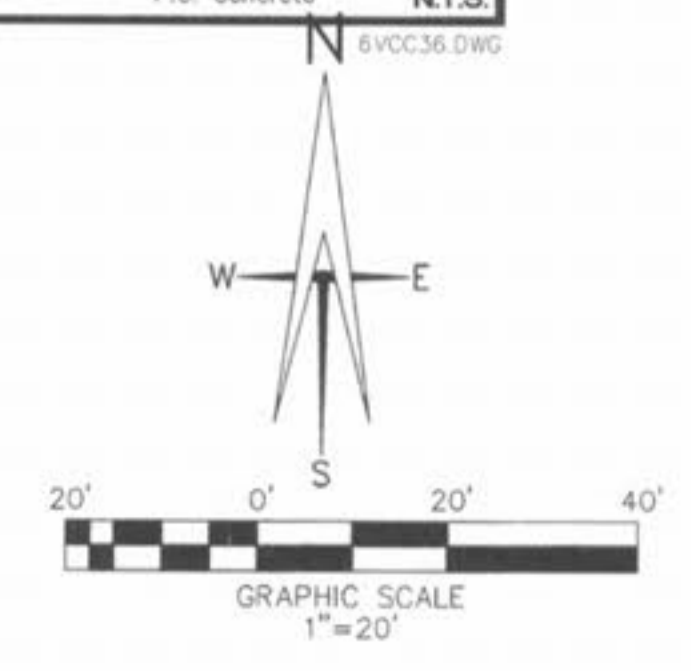

revised as per city comments  
06/17/04

MAGNOLIA  
CUL-SE-SAC WARPING  
AND TYPICAL SECTION

ST. CHARLES ENGINEERING & SURVEYING, INC.  
801 S. FIFTH STREET, SUITE 202  
ST. CHARLES, MO 63301  
TEL: (636) 947-0607 FAX: (636) 947-2448



ORDER NO.  
030498  
DATE  
1-26-04  
23