

DATUM ELEV
550.00

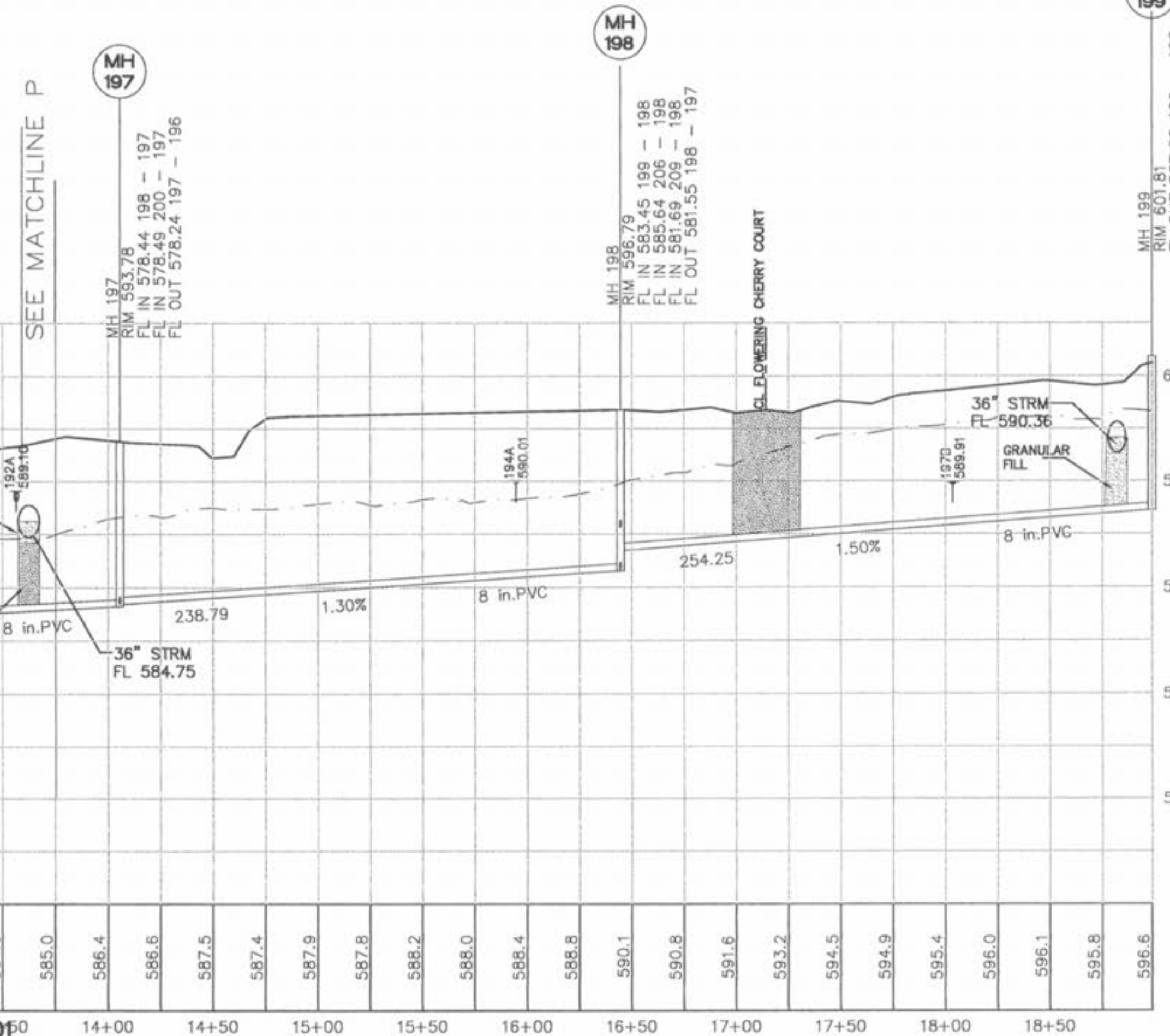

O'Fallon File
Number 3603.0P0

All sanitary lateral street crossings, if trenched, shall be backfilled with granular material (aggregate).
 Storm sewer pipes that cross over existing or proposed sanitary sewer trenches shall be cradled in concrete through the full width of the sanitary sewer trench. The trench shall be backfilled and compacted with granular fill to the bottom of the concrete cradle.
 If the storm and sanitary sewer are parallel and in the same trench or overdig, the upper pipe shall be placed on a shelf and the lower pipe shall be bedded in compacted granular fill to the flow line of the upper pipe.
 All storm sewer and sanitary sewer within the 1:1 shear plane of the proposed roads shall be granular backfilled.

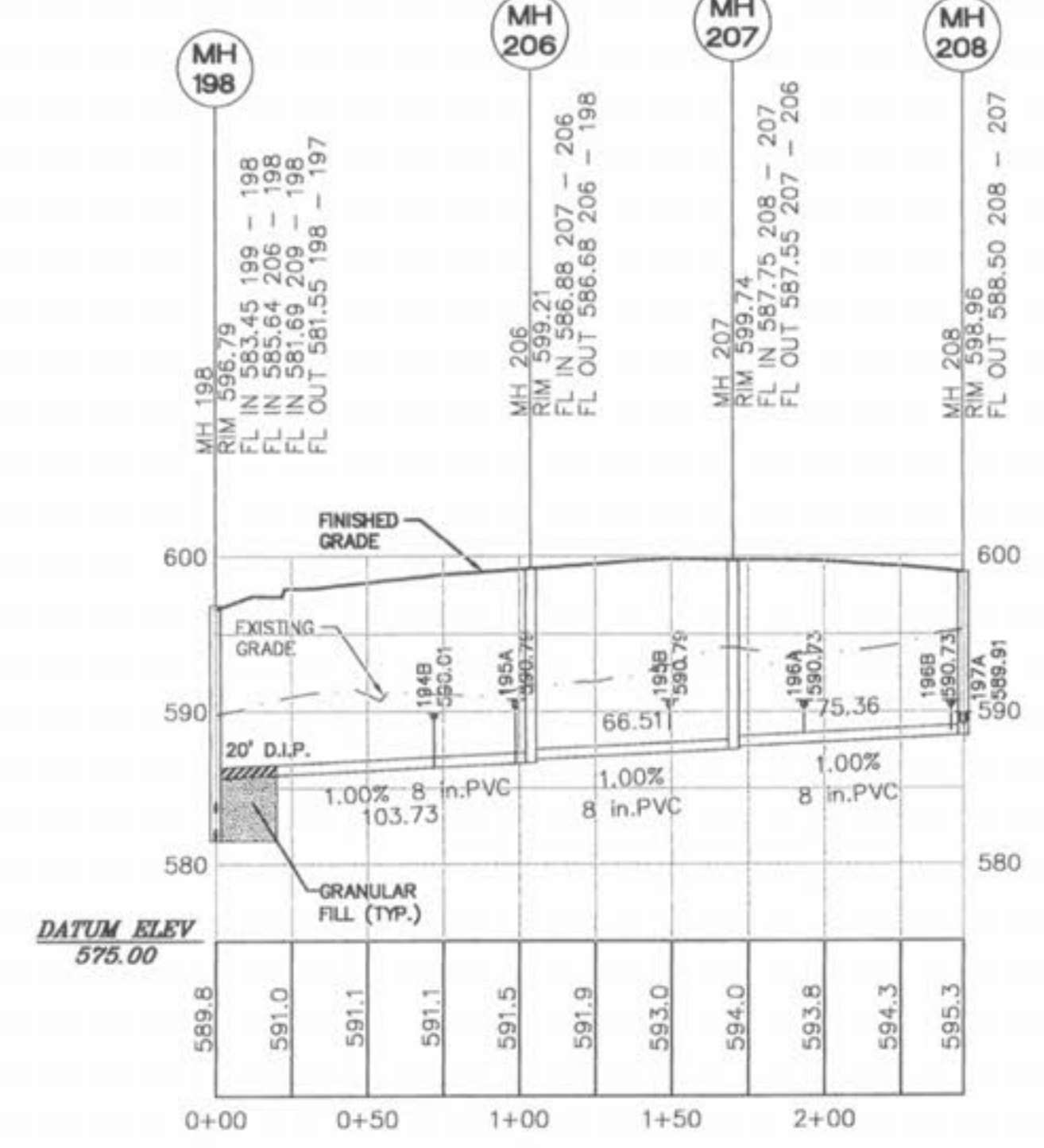

DATUM ELEV
575.00

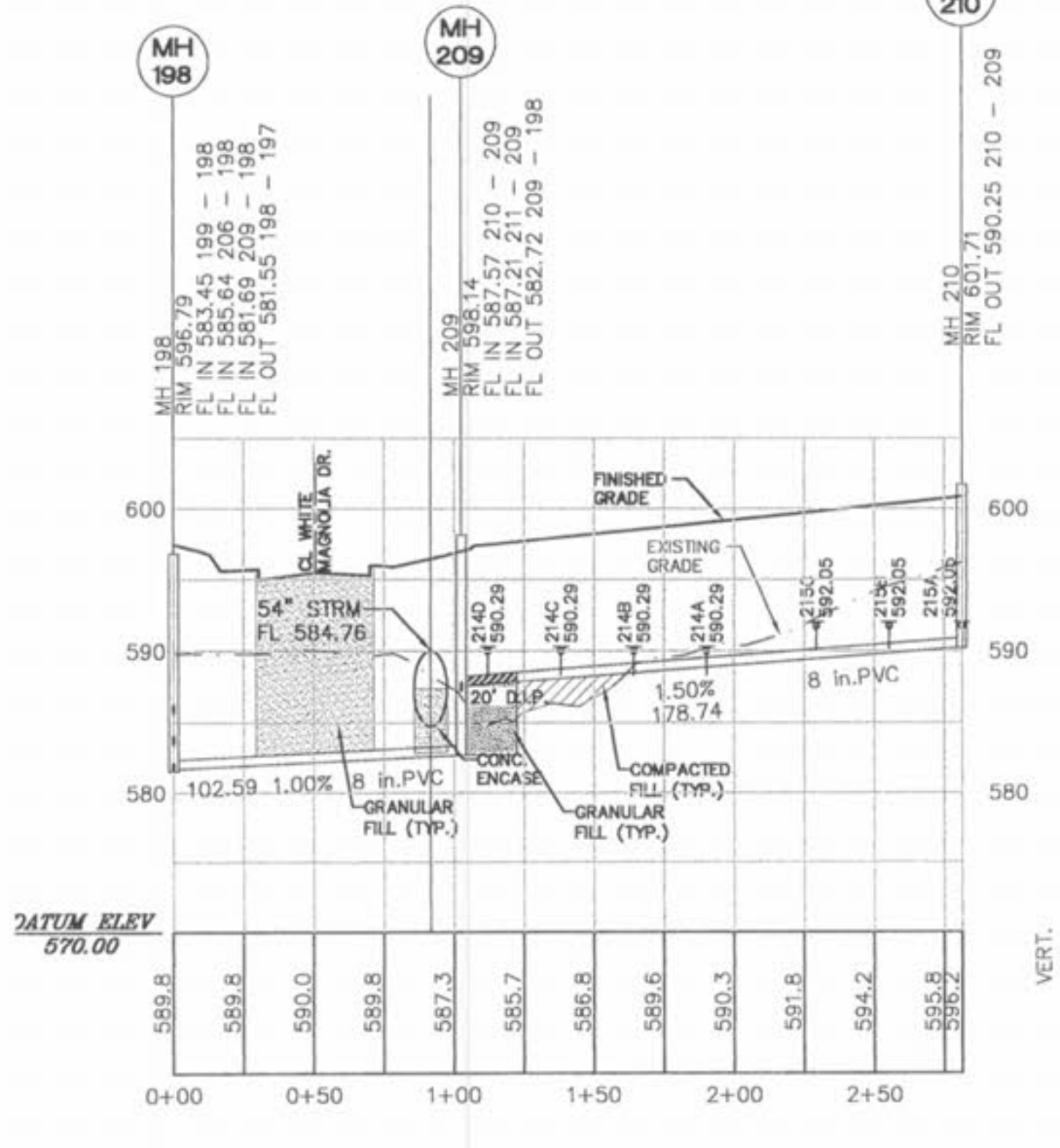

DATUM ELEV
570.00

VERT. SCALE:
10
HORIZ. SCALE:
50

SEE MATCHLINE P

MAGNOLIA SANITARY PROFILE

ST. CHARLES ENGINEERING & SURVEYING, INC.
801 S. FIFTH STREET, SUITE 202
ST. CHARLES, MO 63301
TEL: (636) 947-0607 FAX: (636) 947-2448



ORDER NO.
030498
DATE
1-26-04
30