

Note: Existing underground and overhead utilities and drainage structures have been plotted from available information and their locations must be considered approximate only. It is the responsibility of the contractor to notify the utility companies and to verify the locations of existing utilities before actual construction begins. Any discrepancies noted must be reported to the Engineer immediately.

|   |              |              |
|---|--------------|--------------|
| <b>GBA</b><br>GEORGE BUTLER ASSOCIATES, INC.<br>Engineers / Architects / Landscape Architects / Planners<br>Kansas City, Mo. / Lenexa, Ka. / O'Fallon, Mo. / Ames, Ia. / Oklahoma City, Ok. |              | DESIGN BY:   |
| DRAWN BY:   |              | PROJECT NO.: |
| SHEET NO.   | TOTAL SHEETS |              |
| REVISIONS   |              |              |
| BY  | DATE         |              |

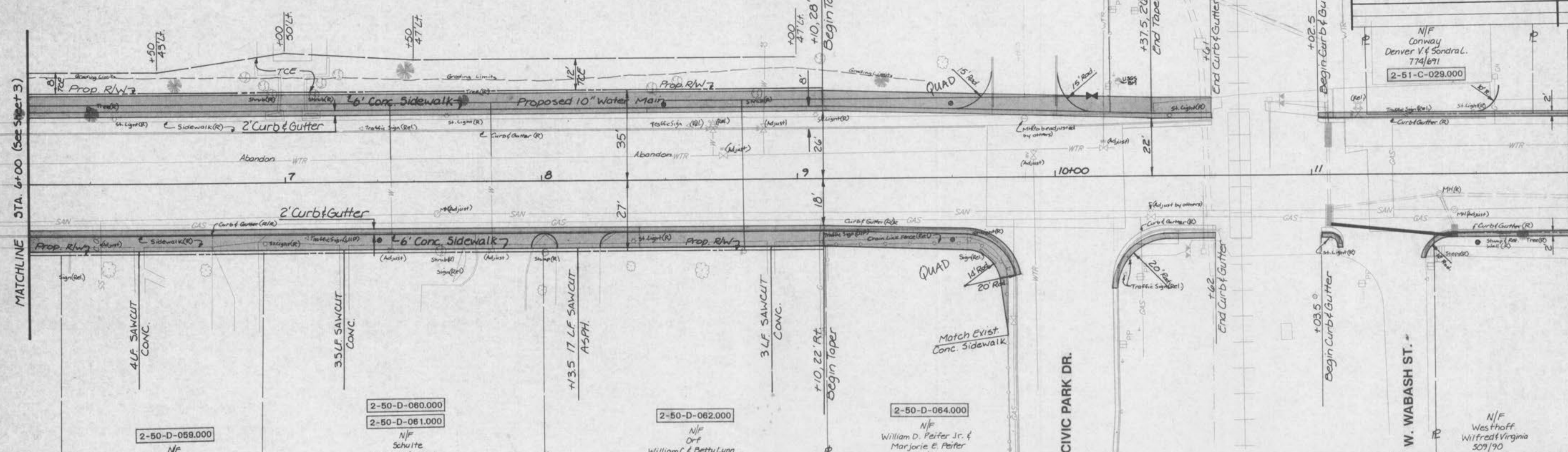
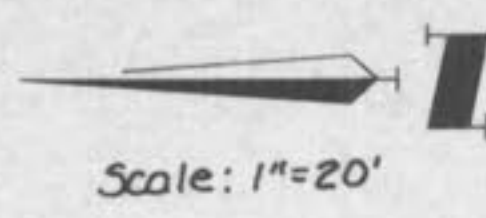

- 2-50-D-059.000  
N/F  
Paul F. Renaud  
079/391
- 2-50-D-060.000  
2-50-D-061.000  
N/F  
Schulte  
Robert E. & Ann M.  
1196/1783-1785
- 2-50-D-062.000  
N/F  
Orf  
William C. & Betty Lynn  
634/630
- 2-50-D-064.000  
N/F  
William D. Peifer Jr. & Marjorie E. Peifer  
531/483

Scale: 1"=20' Horizontal  
1"=10' Vertical

BM: TOP OF FIRE HYDRANT, NORTH BOLT TOWARD STREET, 110' NORTH OF ST. MARY'S SOUTH ENTRANCE. ELEVATION: 541.98

BM: USGS BENCHMARK 40' EAST OF THE CENTERLINE OF N. MAIN ST. (HWY. M), 53' NORTH OF THE CENTERLINE OF THE RAILROAD TRACKS AND 3.4' SOUTH OF A 6" CHAIN LINK FENCE. ELEVATION: 543.04

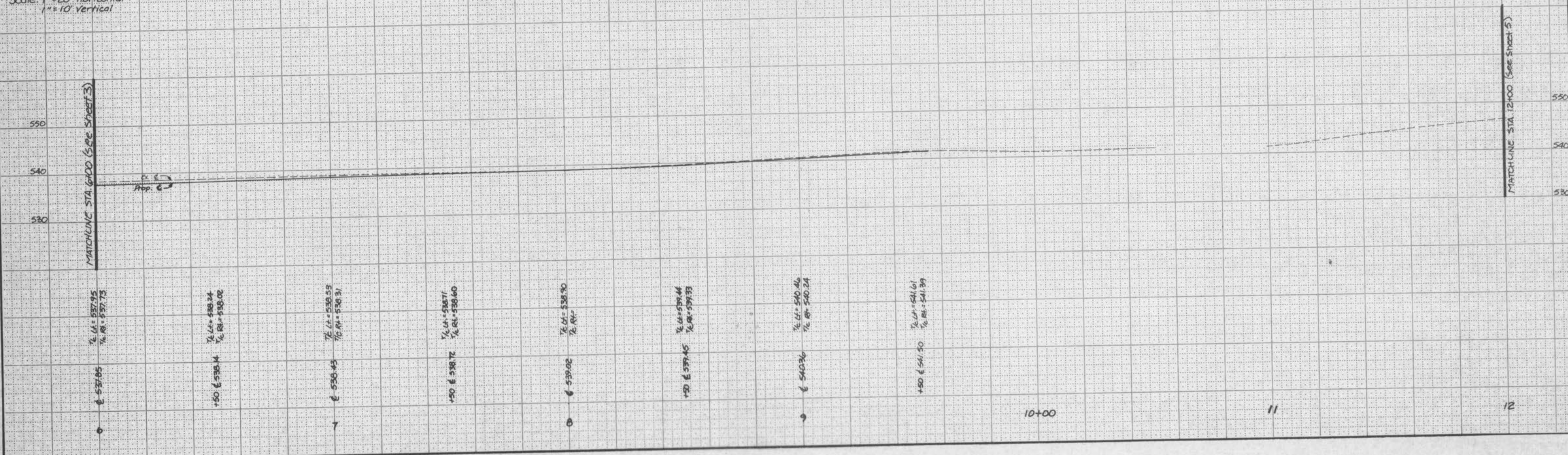

MATCHLINE STA. 6+00 (See Sheet 3)

MATCHLINE STA. 12+00 (See Sheet 5)

MATCHLINE STA. 6+00 (See Sheet 3)

MATCHLINE STA. 12+00 (See Sheet 5)

CIVIC PARK DR.

W. WABASH ST.