

9 HANDICAP SIGN DETAIL
 SCALE: N.T.S. REF. DWG. C2.0

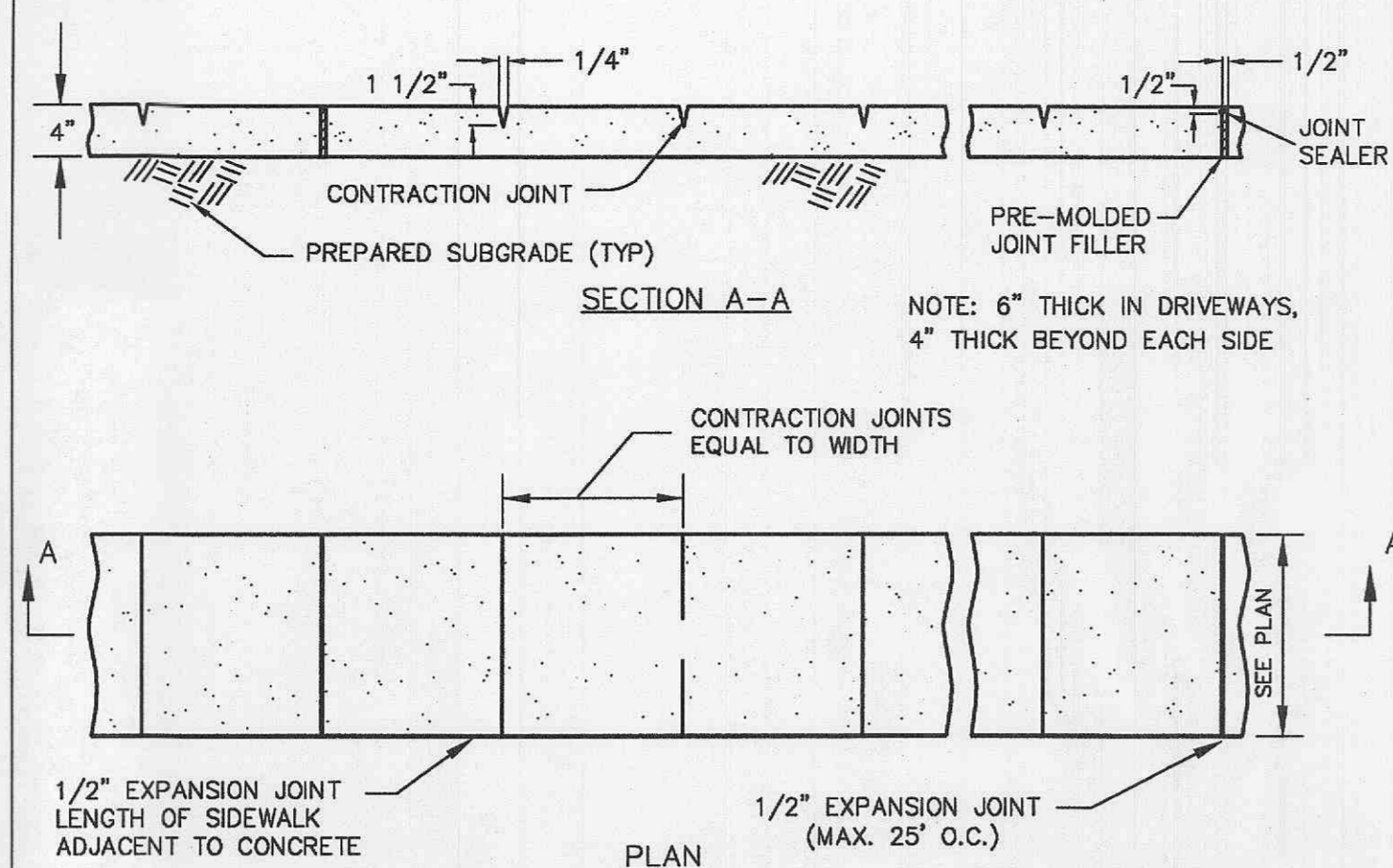

8 CONCRETE SIDEWALK DETAIL
 SCALE: N.T.S. REF. DWG. C2.0

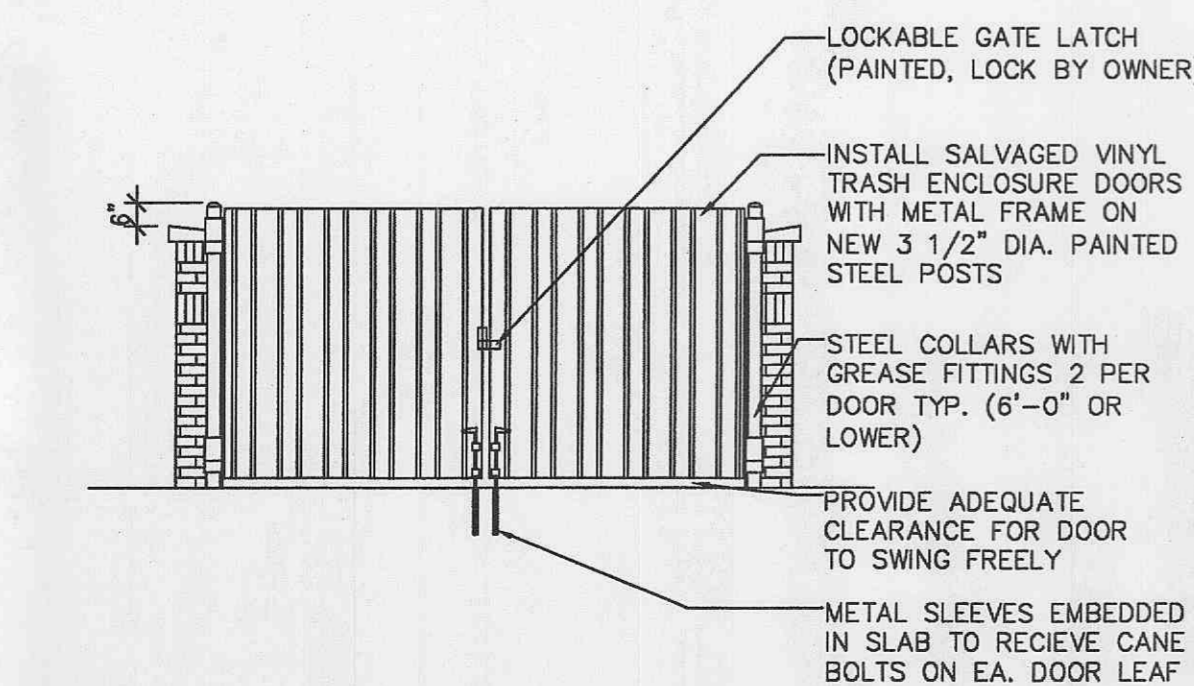
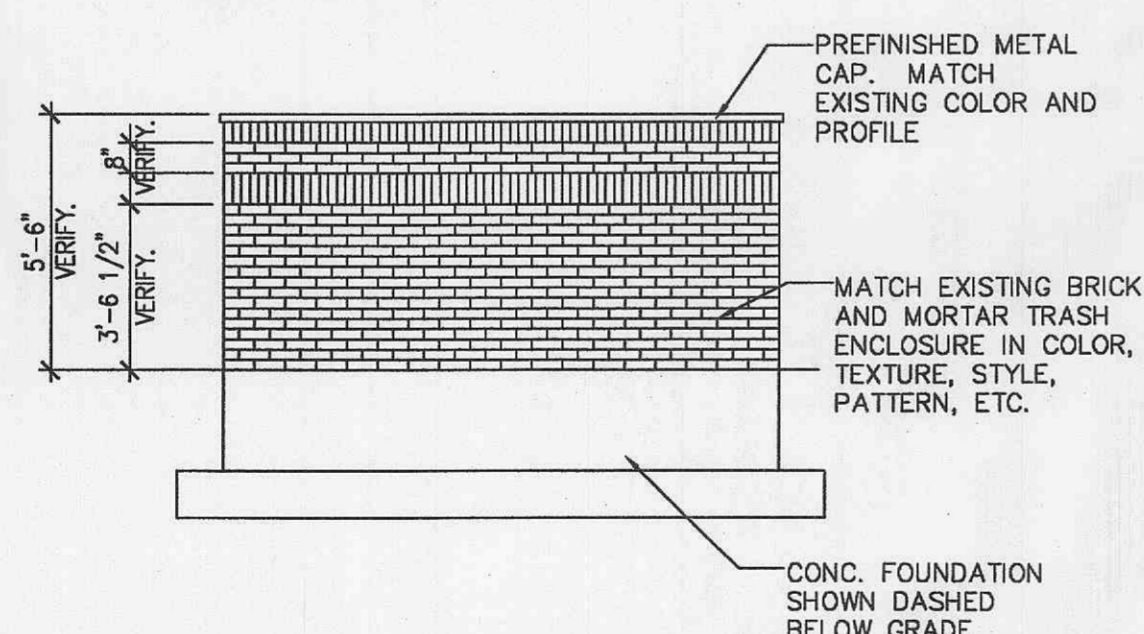
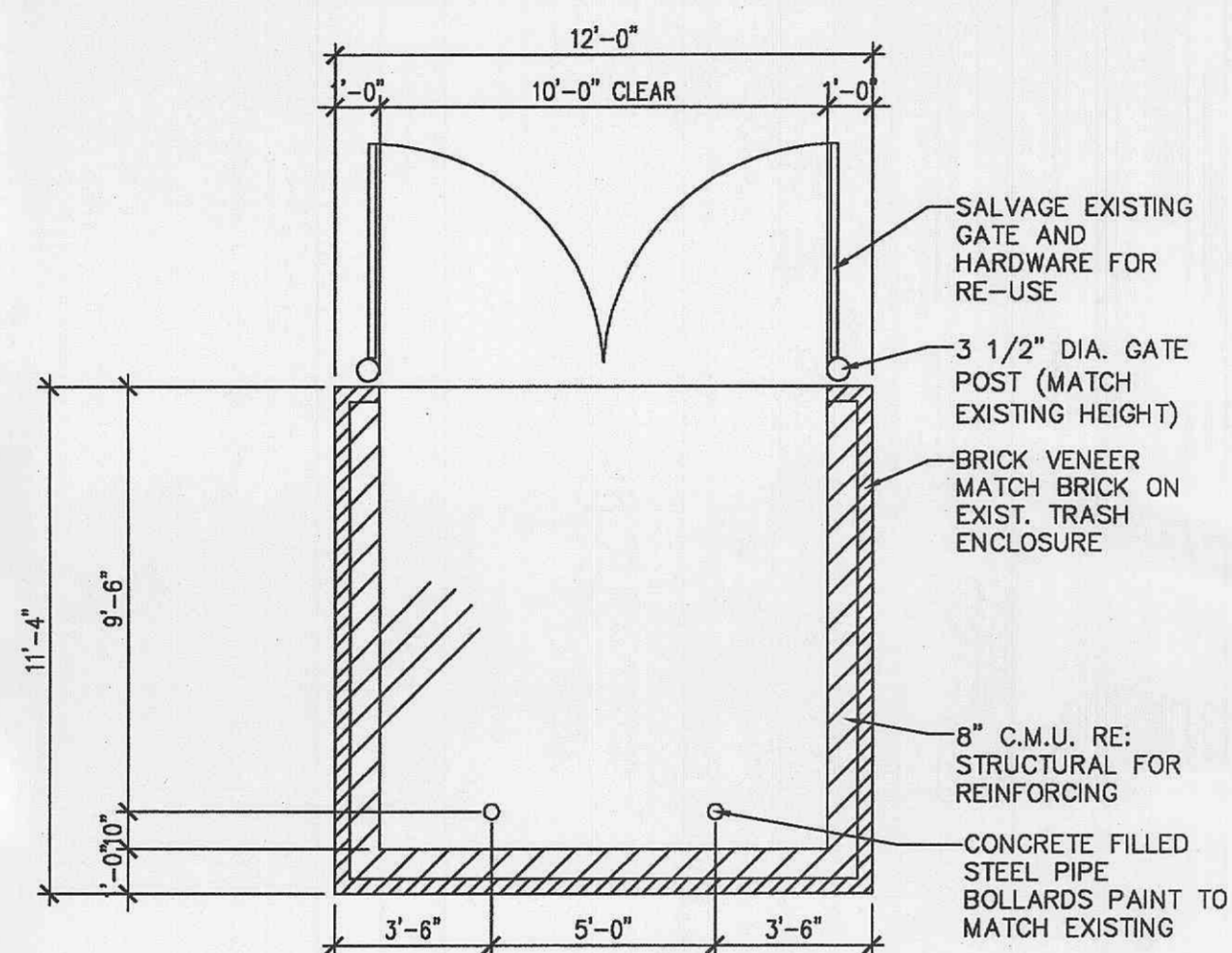

7 TRASH ENCLOSURE
 SCALE: N.T.S. REF. DWG. C2.0

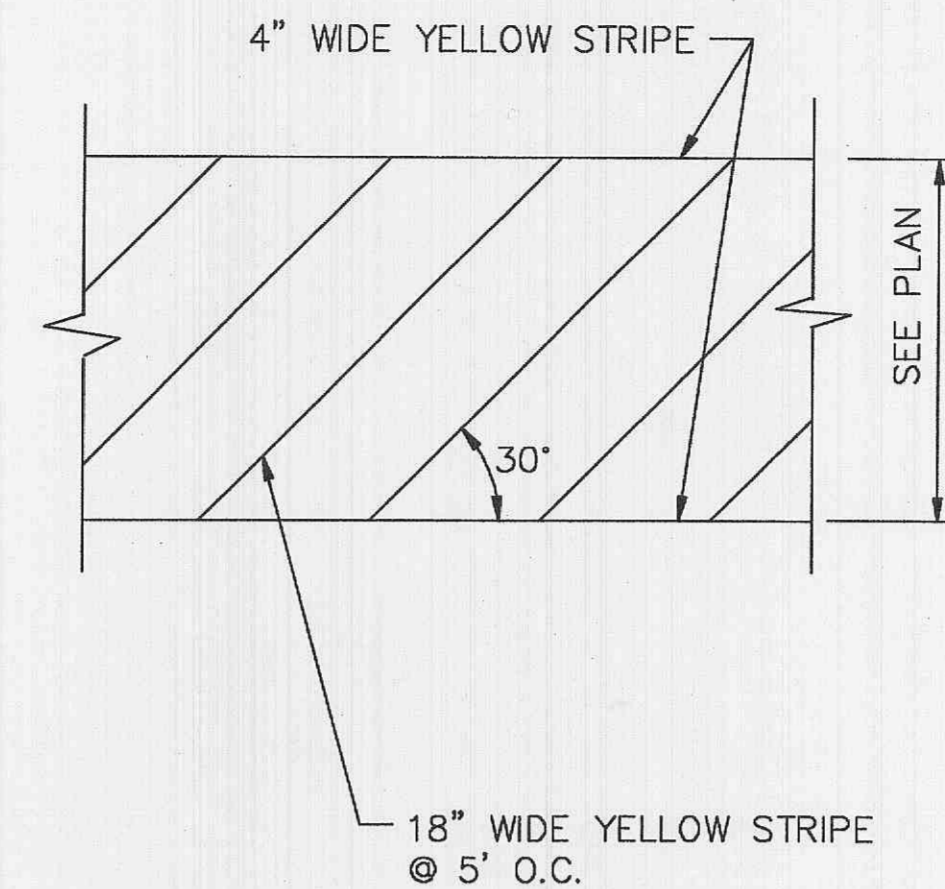

6 CROSSWALK STRIPING DETAIL
 SCALE: N.T.S. REF. DWG. C2.0

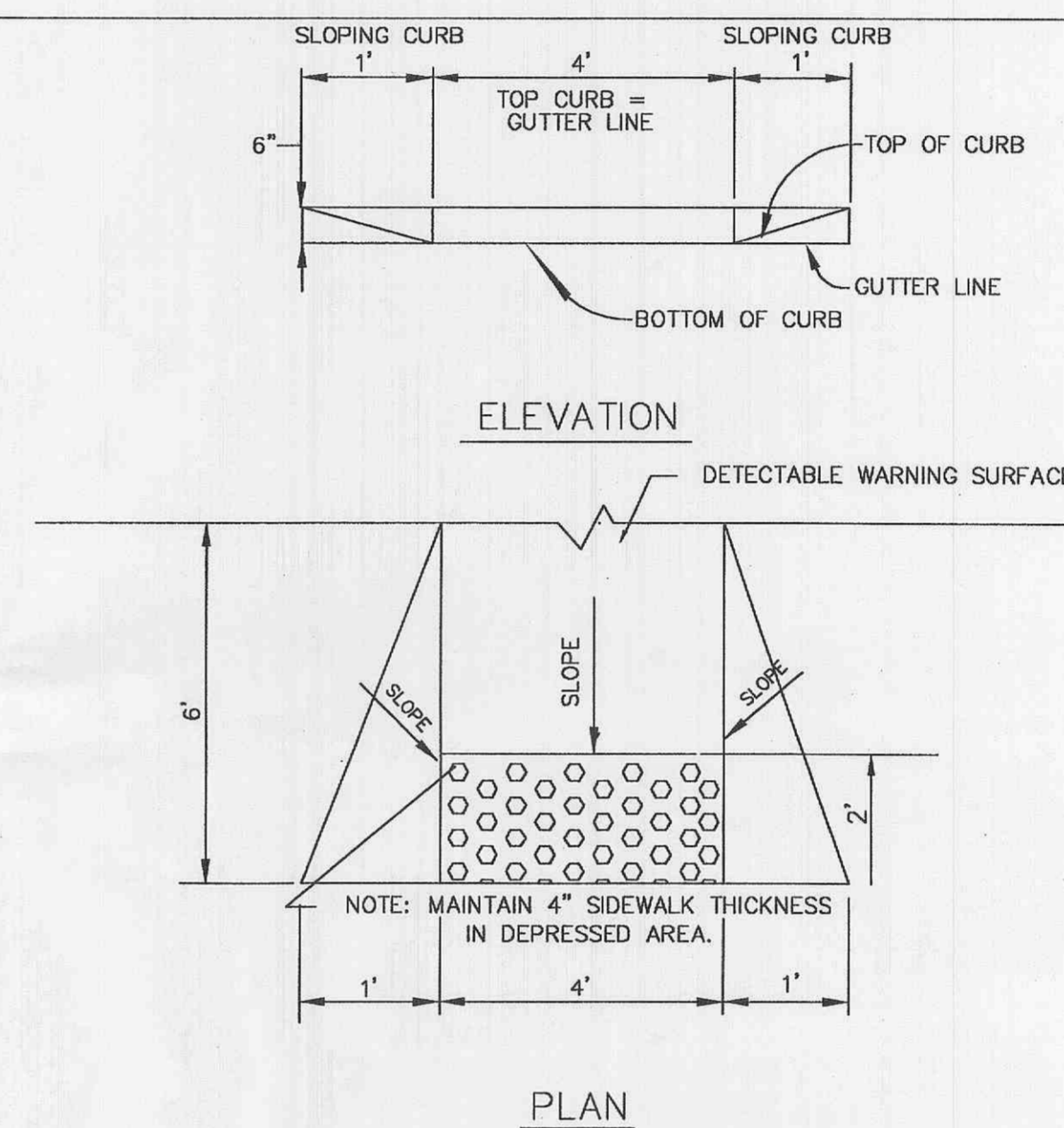

5 HANDICAP RAMP DETAIL
 SCALE: N.T.S. REF. DWG. C2.0

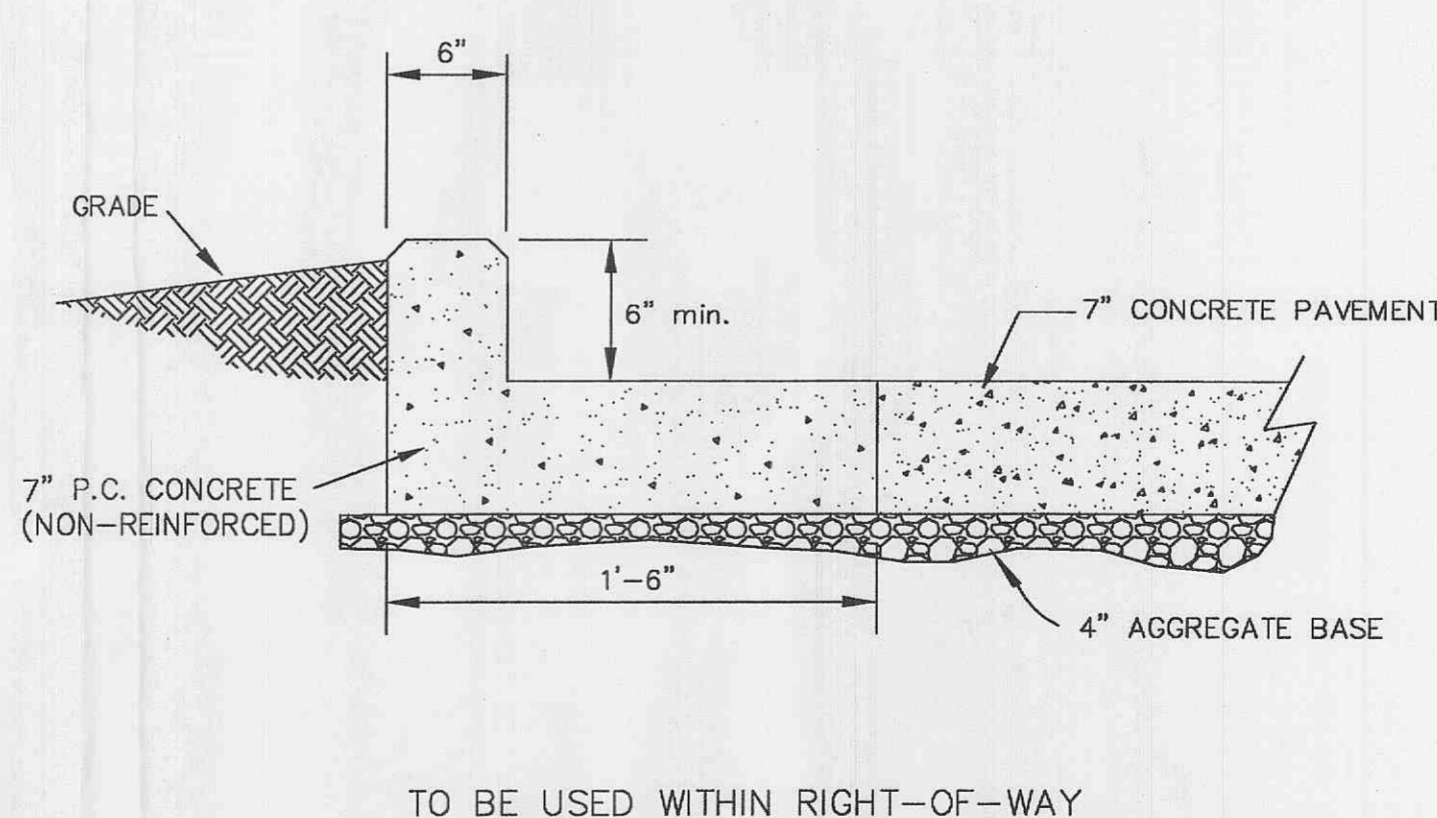

4 CURB AND GUTTER DETAIL
 SCALE: N.T.S. REF. DWG. C2.0

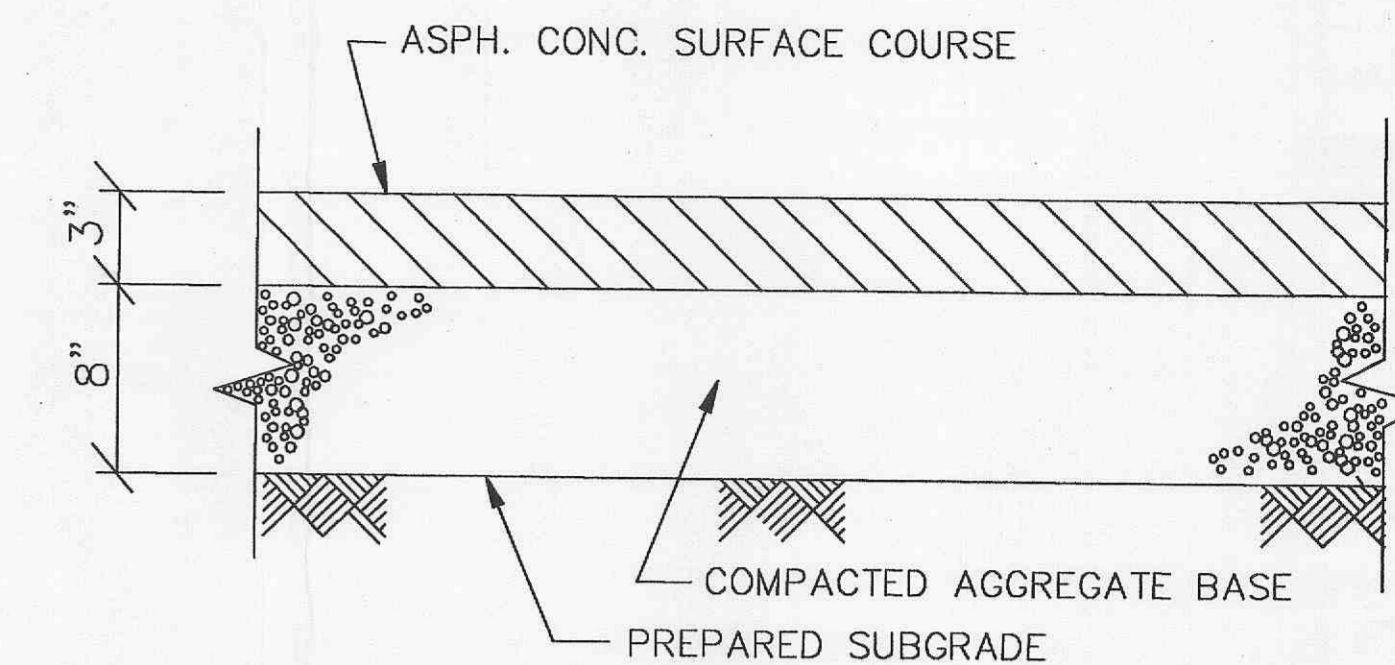

NOTE:
 1. FINAL PAVEMENT SECTION TO BE VERIFIED AND DESIGNED BY GEOTECHNICAL ENGINEER UNDER CONTRACT WITH THE DEVELOPER.
 2. THE MINIMUM ASPHALT PAVEMENT SECTION PER THE CITY OF O'FALLON IS 3" TYPE 'C' ASPHALT ON 8" AGGREGATE.

3 STANDARD DUTY ASPHALT PAVEMENT
 SCALE: N.T.S. REF. DWG. C2.0

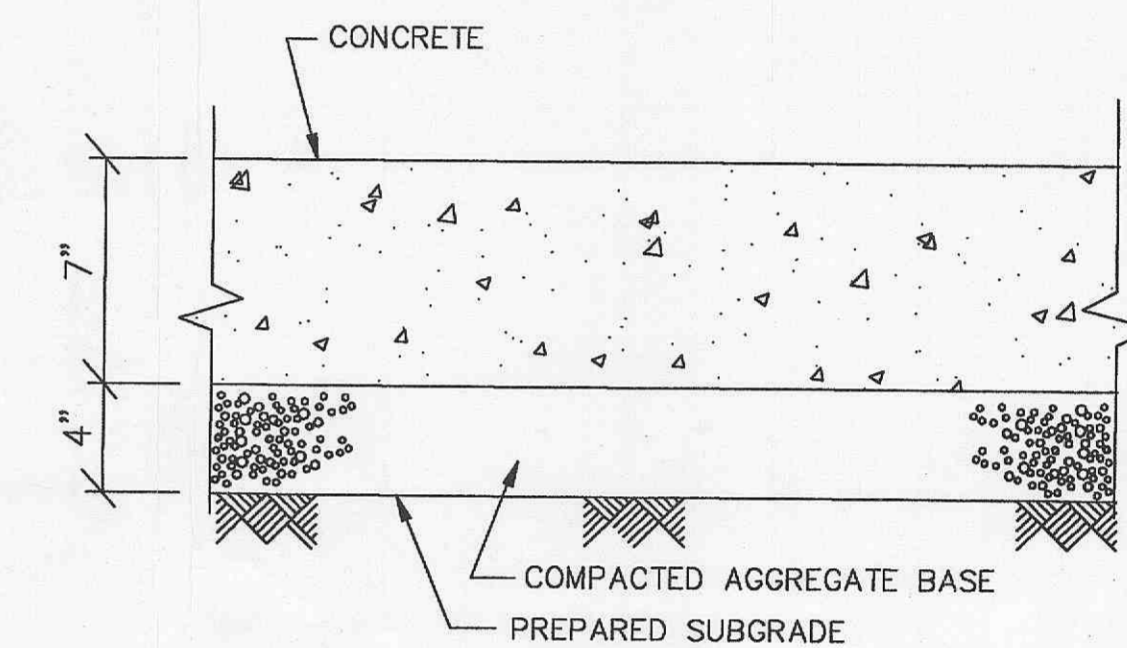

REFER TO GEOTECHNICAL REPORT FOR FINAL SPECIFICATIONS
 NOTE:
 1. FINAL PAVEMENT SECTION TO BE VERIFIED AND DESIGNED BY GEOTECHNICAL ENGINEER UNDER CONTRACT WITH THE DEVELOPER.

2 CONCRETE PAVEMENT
 SCALE: N.T.S. REF. DWG. C2.0

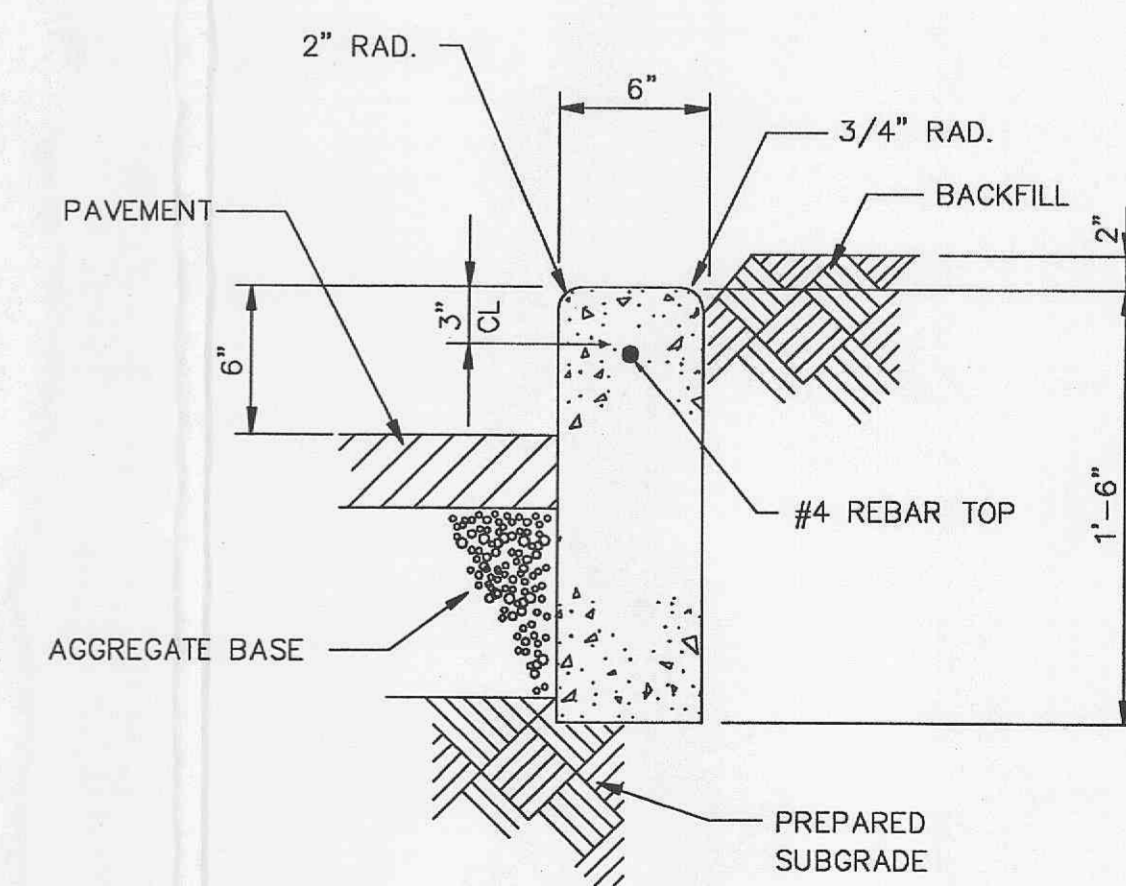

1 CONCRETE CURB DETAIL
 SCALE: N.T.S. REF. DWG. C2.0

REVISIONS	DATE	BY	COMMENTS
	10/10/06		

DEVELOPER/OWNER:
MEEGLE PROPERTIES, LLC
 1001 BOARDWALK SPRINGS PLACE
 O'FALLON, MO 63366
 (636) 561-9300

THE PROFESSIONAL WHOSE SIGNATURE AND PERSONAL SEAL APPEAR HEREON ASSUMES RESPONSIBILITY ONLY FOR WHAT APPEARS ON THIS PAGE, AND DISCLAIMS RESPONSIBILITY FOR ANY OTHER PARTS OF THIS PROJECT. ANY CHANGES, REVISIONS, REWORKS, OR OTHER CORRECTIONS TO THIS DRAWING SHALL BE MADE BY THE UNDERSIGNED PROFESSIONAL RELATING TO, OR IN REPLY TO, BE USED FOR ANY PART OR PARTS OF THE PROJECT TO WHICH THIS PAGE REFERS.

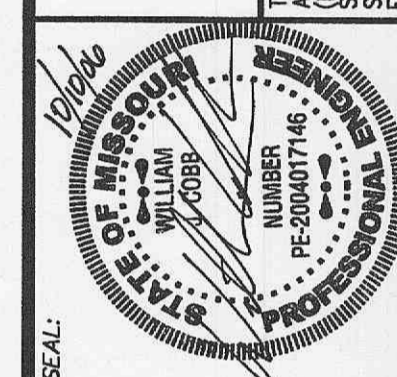

MARKETPLACE
 7321 VILLAGE CENTER DRIVE
 O'FALLON, MISSOURI

SITE DETAILS

planning • engineering • surveying • landscape architecture
Cole and ASSOCIATES
 INCORPORATED
 10777 sunset office dr. suite 10
 saint louis, missouri 63127
 p: 314 984 9887 f: 314 984 0587

DESIGNED BY: BC
 DRAWN BY: LM
 CHECKED BY: JTR

DATE: 08/24/2006

Job Number
06-182

Sheet Number

C3.0