

LAYOUT C2.0 SITE LAYOUT
LAYOUT C2.0 GRADING
DRAWING S:\JOBS\2006\06-182\C06-182.dwg\PLAN_C2.0_SITE_LAYOUT.dwg

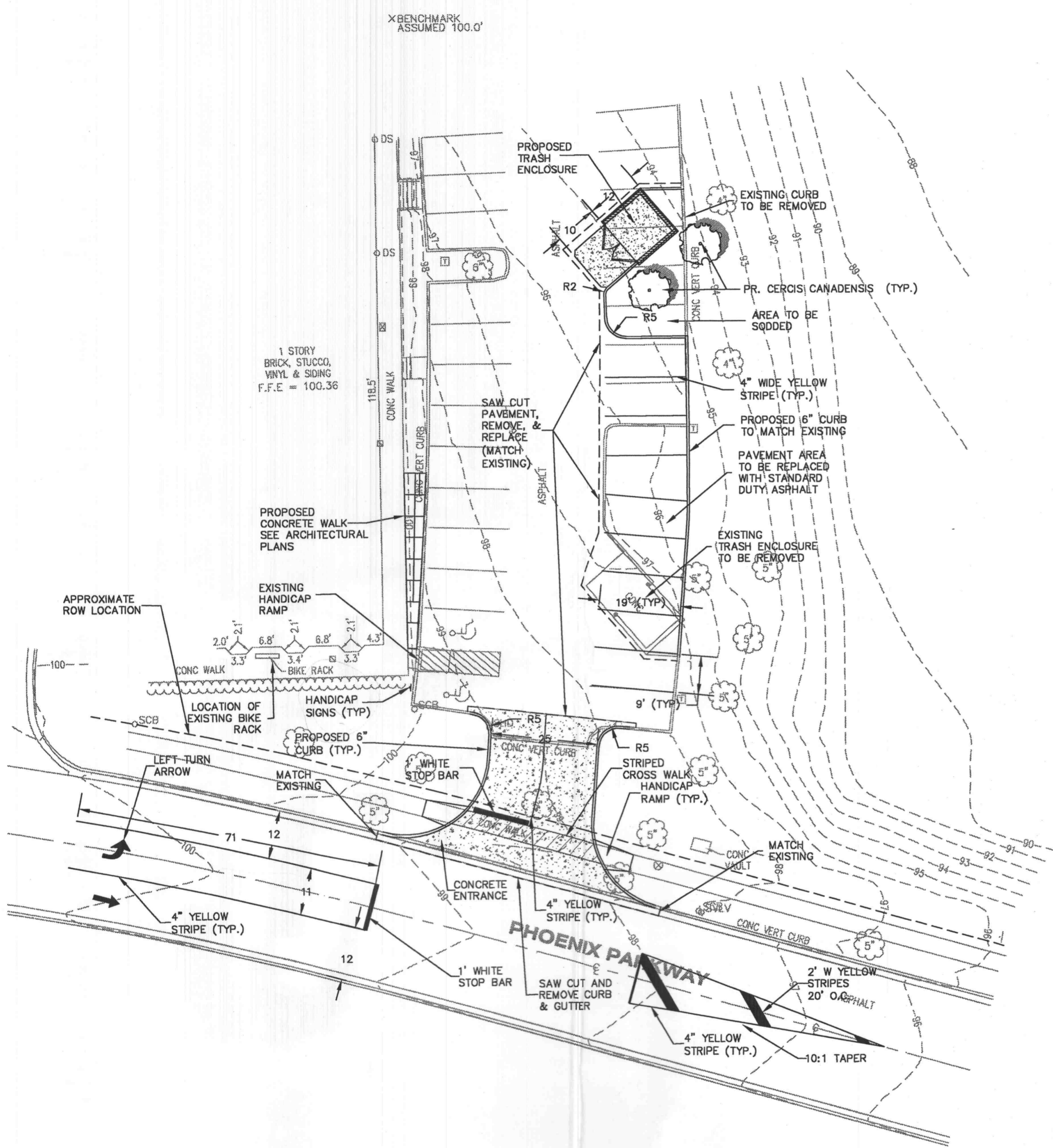

SITE LAYOUT

NOTE: EXISTING PAVEMENT REMOVAL IS TO BE TO THE NEAREST JOINT.

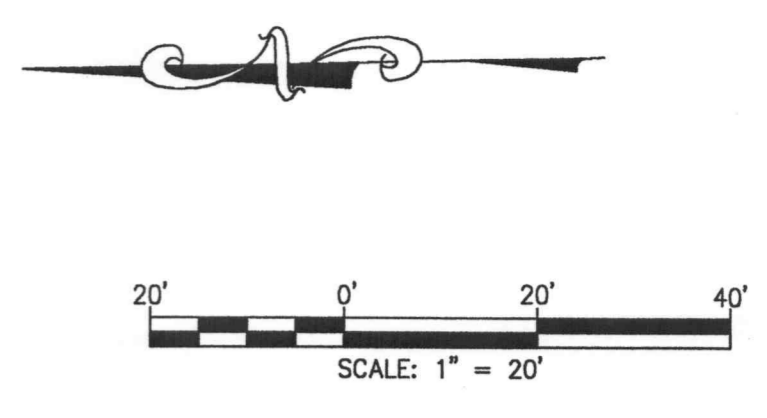
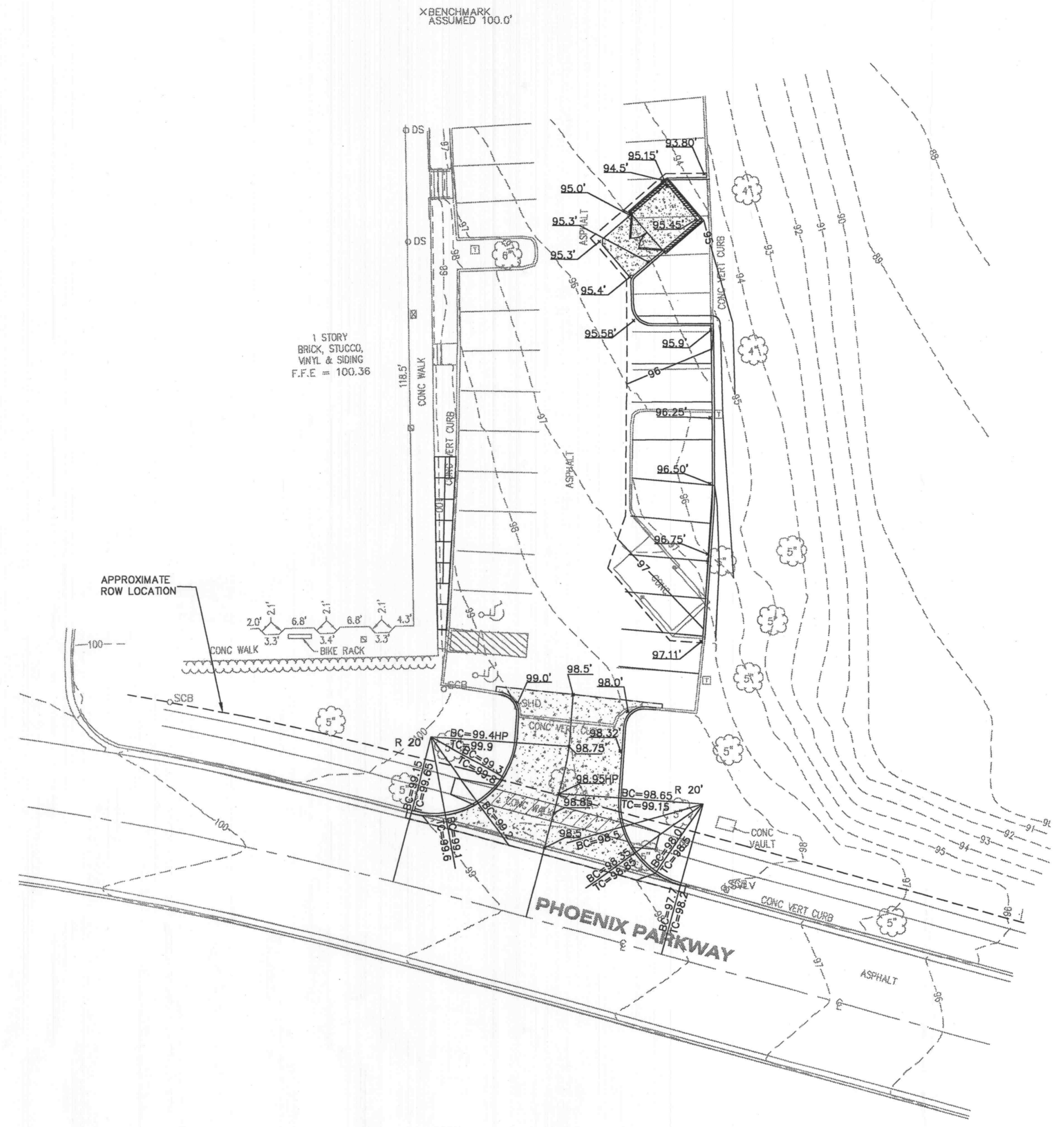

GRADING PLAN

REVISIONS	
DATE	DESCRIPTION
10/10/06	ISSUED FOR PERMITS

DEVELOPER/OWNER:
MC EAGLE PROPERTIES, L.L.C
1001 BOARDWALK SPRINGS PLACE
OF FALLON, MO 63366
(636) 561-9300

THE PROFESSIONAL WHOSE EXAMINEE AND PERSONAL SEAL APPEAR HEREON ASSUMES RESPONSIBILITY FOR ALL OTHER PLANS PURSUANT TO SECTION 327, 41 (RSMO). ANY RESPONSIBILITY FOR ANY OTHER PLANS SHALL BE THE RESPONSIBILITY OF THE PROFESSIONAL SEALING THEM. THIS SEAL IS NOT TO BE USED FOR ANY PART OR PARTS OF THE PROJECT TO WHICH THIS PAGE REFERS.

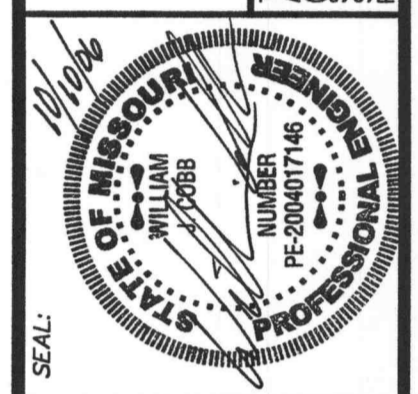

MARKETPLACE
7321 VILLAGE CENTER DRIVE
OF FALLON, MISSOURI

SITE LAYOUT AND GRADING

planning • engineering • surveying • landscape architecture

COLE
and ASSOCIATES
INCORPORATED

10777 sunset office dr. suite 10
saint louis, missouri 63127
p: 314 984 9887 f: 314 984 0587

DESIGNED BY	BC
DRAWN BY	LM
CHECKED BY	JTR
DATE	08/24/2006
Job Number	06-182
Sheet Number	C2.0