

- Underground utilities have been plotted from available information and therefore location shall be considered approximate only. The verification of the location of all underground utilities, either shown or not shown on these plans, shall be the responsibility of the contractor and shall be located prior to any grading or construction of improvements.
- Gas, water and other underground utilities shall not conflict with the depth or horizontal location of existing or proposed sanitary and storm sewers, including house laterals.
- All existing site improvements disturbed, damaged or destroyed shall be repaired or replaced to closely match preconstruction conditions.
- All fire hydrant boxes under proposed storm and sanitary sewer lines and paved areas including trench boxfills within and adjacent to the project shall be constructed to meet the requirements of the Sanitary Sewer District Engineer with grading and backfilling operations. The compacted fill shall be non-yielding and non-pumping during proofrolling and compaction.
- The contractor shall prevent all storm, surface water, mud and construction debris from entering the existing sanitary sewer system.
- All sanitary sewer pipelines and tops shall be constructed without elevations furnished by the engineer will be the responsibility of the sewer contractor.
- Excavations shall be provided for all sanitary sewers, storm sewers and all utilities in the record plat.
- All construction and materials shall conform to the current construction standards of the Docket Creek Sanitary District.
- The Docket Creek Sanitary District shall be notified at least 48 hours prior to construction for coordination of inspection.
- All sanitary sewer building connections shall be designed so that the minimum vertical distance from the low point of the basement to the top of a sanitary sewer at the corresponding building connection shall not be less than the diameter of the pipe plus the vertical distance of 2'-0" (2 feet).
- All sanitary sewer manholes shall be water-proofed on the exterior in accordance with Missouri Dept. of Natural Resources specification 105CM-B-1207(Y).
- All PVC sanitary sewer pipe shall conform to the requirements of ASTM D-3034 Standard Specification for 150 Polypropylene Chloride Sewer Pipe (SPP-35 or 40), with a minimum 1/2" thick granular stone bedding uniformly applied to the exterior of the pipe and a minimum 1/2" thick granular stone bedding uniformly applied to the interior of the pipe to the top of the pipe.
- All sanitary and storm sewer trench boxfills shall be water placed. Granular boxfill will be used under pavement areas.
- All pipe shall have positive drainage through manholes. No flat invert structures are allowed.
- Brick shall not be used on sanitary sewer manholes.
- Existing sanitary sewer service shall not be interrupted.
- Manhole access to existing residential driveway and streets.
- Pre-manufactured manholes shall be used at all PVC to pipe connections. Rubber boot / Manhole-type couplings will not be allowed.
- Any permits, licenses, easements or approvals required to work on public or private properties or roadways are the responsibility of the contractor.

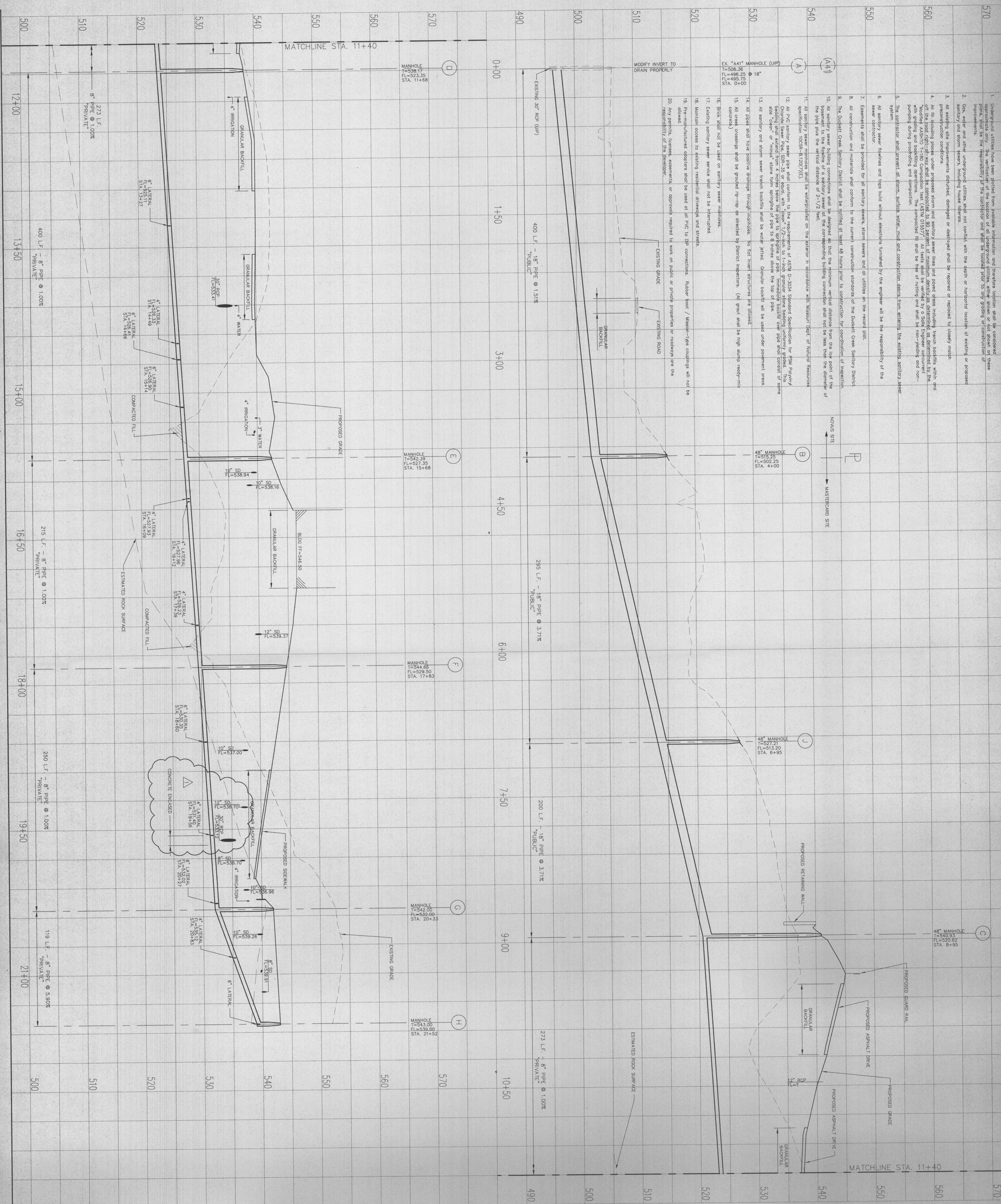

Reasons to
MasterCard
 MASTERCARD INTERNATIONAL
 Contract Number:
 HELLMUTH, OBATA + KASSABAUM, P.C.

PKNYC
 620 Avenue Of The Americas
 New York, New York 10011
 (212) 411-1200, (212) 853-1183

PKSTL
 211 North Broadway, Suite 600
 St. Louis, MO 63102, USA
 (314) 421-2800, (314) 421-1803
 An Equal Opportunity Employer
 In association with:
MAZZETTI & ASSOCIATES
 529 BROADWAY
 SAN FRANCISCO, CA 94108-3623
 T. 415.382.2266 F. 415.382.2267

EDM Incorporated
 STRUCTURE & DOME ENGINEERS
 220 Madison House Center
 St. Louis, MO 63102-1902
 T. 314.231.5485 F. 314.231.8167

CONSULTANT ABC
 CONSULTANT ABC
 T. ##### F. #####

Issue	Date	Description	Drawn	CHK
1	6-14-99	ISSUED TO PERMITS	ABC	ABC
2	6-14-99	ISSUED TO PERMITS	ABC	ABC
3	6-14-99	ISSUED TO PERMITS	ABC	ABC
4	6-14-99	ISSUED TO PERMITS	ABC	ABC
5	6-14-99	ISSUED TO PERMITS	ABC	ABC

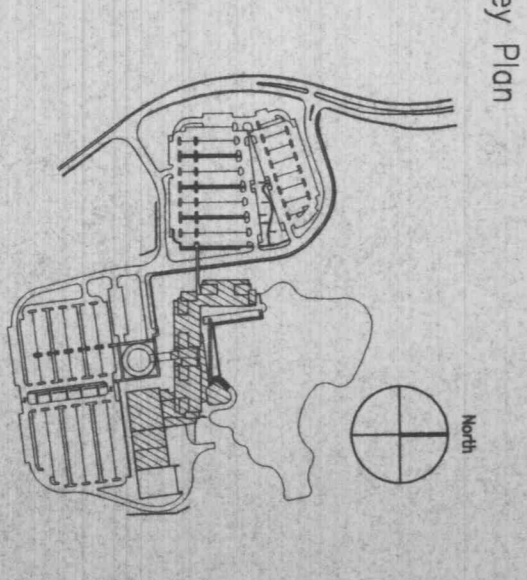

CONSTRUCTION DOCUMENT

Date: 20 JUN 99 Project Code:
 Drawn: CMB Checked: SWS
 CDD File: C14.DWG

Scale:
 1" = 30' HORIZ.
 1" = 5' VERT.

SANITARY SEWER PROFILES

Drawing Number
C.14