

PLANNING AND DEVELOPMENT FILE #2306
APPROVED AUGUST 2, 2007

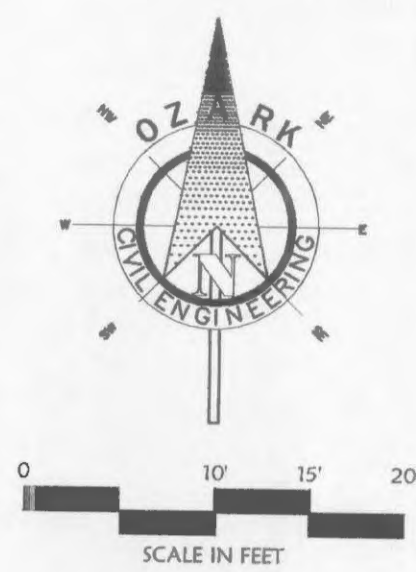

MODOT CALL NUMBER:
314-340-4100

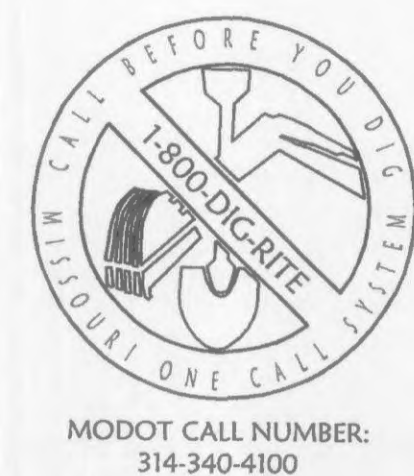

R3-2
NO LEFT TURN (2)



R4-7
KEEP RIGHT (3)

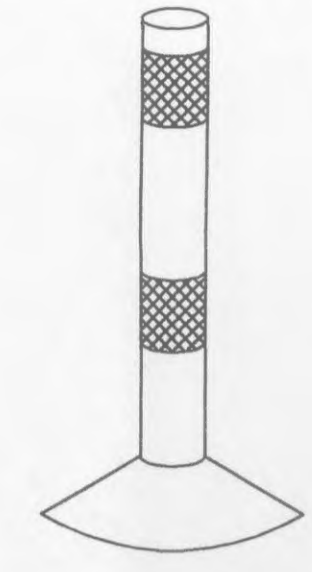

18" FLEXIBLE
DELINEATOR (4)

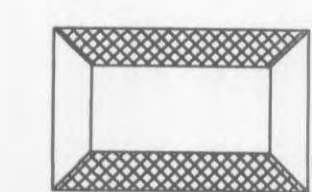

REFLECTIVE RAISED
PAVEMENT MARKER
(STIMSONITE MODEL 88) (5)

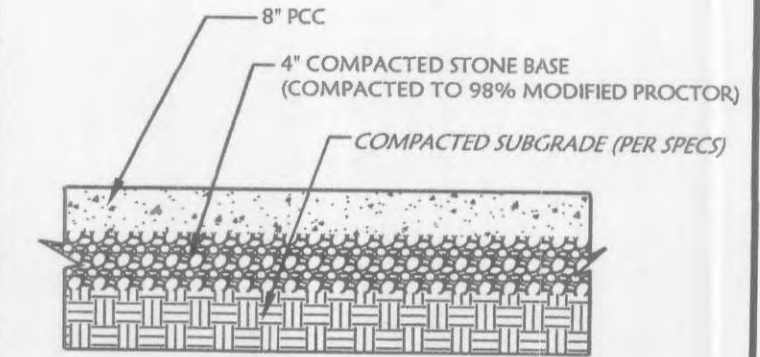

8" PCC PAVEMENT SECTIONS
FOR ENTRANCE ONTO K HIGHWAY
N.T.S.

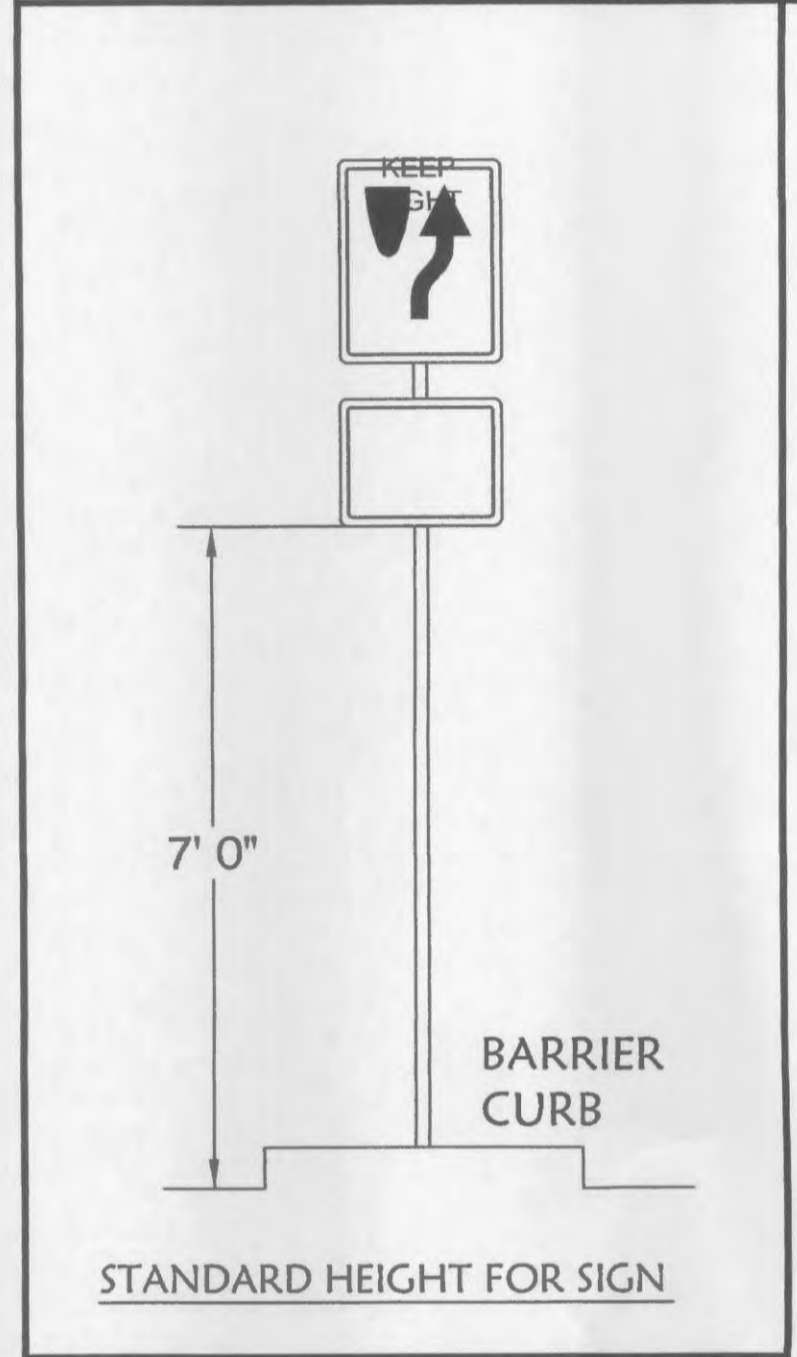

STANDARD HEIGHT FOR SIGN

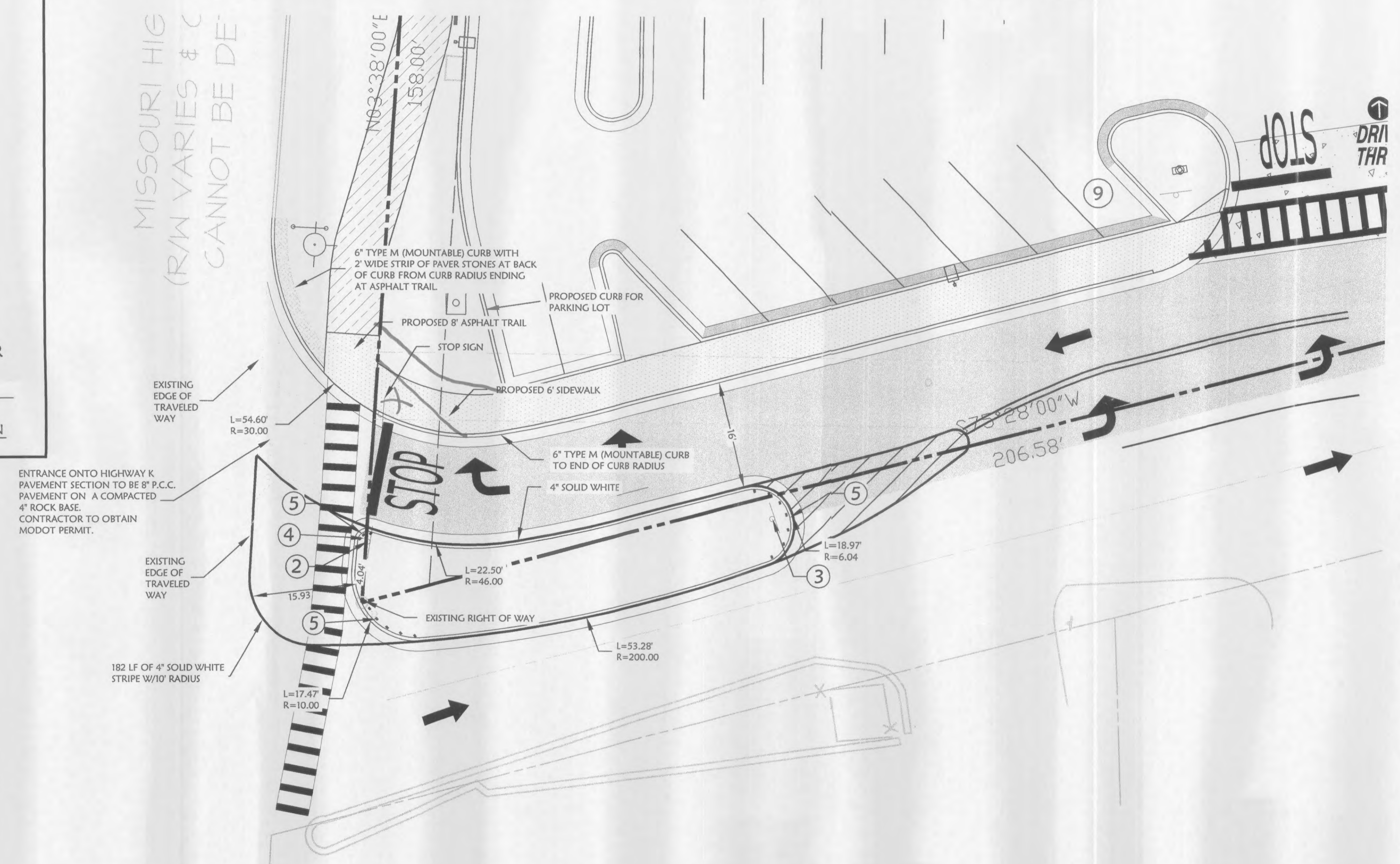

ENTRANCE ONTO HIGHWAY K
PAVEMENT SECTION TO BE 8" P.C.C.
4" ROCK BASE.
CONTRACTOR TO OBTAIN
MODOT PERMIT.

182 LF OF 4" SOLID WHITE
STRIPES W/10' RADIUS

NOTES:

1. ALL SIGNS TO BE MOUNTED ON PERFORATED SQUARE STEEL TUBE POST - STANDARD DRAWING 903.03.
2. SIGN HEIGHT TO BE 7' FROM BOTTOM OF SIGN TO EDGE OF PAVEMENT ELEVATION.
3. FLEXIBLE DELINEATORS TO BE LOCATED AT RADIUS POINTS.
4. REFLECTIVE MARKERS TO BE LOCATED ONE AT THE CENTER OF ISLAND NOSE. THEN 2' SPACING ON EITHER SIDE.
5. ALL SIGNS TO BE CONTRACTOR FURNISHED.
6. ALL STRIPING SHALL BE EPOXY.

SITE PROPOSED FEATURES	
---	BOUNDARY LINE
---	RIGHT OF WAY LINE
---	EASEMENT LINE
---	CONCRETE CURB AND GUTTER
---	FENCE
---	GUARD RAIL
---	RETAINING WALL
○	LOCATION OF BUILDING CONTROL POINT
○	PROPOSED PARKING SPACE COUNTER
○	DROP INLETS (SEE GRADING PLAN FOR TYPE)
○	SANITARY SEWER MANHOLE
○	FIRE HYDRANT WITH GUARD POSTS
○	UTILITY POLE
---	CONCRETE PAVEMENT
---	CONCRETE SIDEWALK
---	ASPHALT TRAIL
---	ASPHALT PAVING ON McDONALDS DRIVE
---	DRY CONCRETE CURB AND GUTTER

SITE GENERAL NOTES:	
COORDINATE LIST (IF ANY) ON THIS PLAN ARE FOR INFORMATION AND CHECKING PURPOSES ONLY. IT IS THE CONTRACTOR'S RESPONSIBILITY TO CALCULATE CONSTRUCTION STAKING COORDINATES ACCORDING TO THE DIMENSIONS SHOWN ON THESE PLANS. THE CONTRACTOR SHALL VERIFY THE ACCURACY OF THE COORDINATES SHOWN ON THE PLANS BEFORE CONSTRUCTION STARTS.	
EXCEPT WHERE INDICATED OTHERWISE, PAVING SHALL BE STANDARD DUTY BITUMINOUS PAVEMENT.	
UNLESS OTHERWISE NOTED, ALL CURB INDICATED SHALL BE 24" CONCRETE CURB AND GUTTER.	
ALL PARKING SPACES INDICATED AS HANDICAPPED SPACES SHALL RECEIVE HANDICAP PAVEMENT MARKINGS AND SIGNS AS INDICATED ON THE DETAIL SHEETS PER DETAIL 9029. STALLS LABELED "VAN" TO RECEIVE A "VAN ACCESSIBLE" SIGN IN ADDITION TO THE ABOVE.	
THE CONTRACTOR SHALL REFER TO THE ARCHITECTURAL PLANS FOR EXACT LOCATIONS AND DIMENSIONS OF THE VESTIBULE, GARDEN CENTER, SLOPED PAVING EXIT, PORCHES, RAMPS, TRUCK DOOR, PRECISE BUILDING DIMENSIONS AND EXACT BUILDING UTILITY ENTRANCE POINTS.	
PAINTED TRAFFIC ARROWS AND ALL SIGNS, PAVEMENT MARKINGS ETC. SHALL BE APPLIED ACCORDING TO REQUIREMENTS AS OUTLINED IN SECTION 38 OF THE M.U.T.C.D FOR STREET & HIGHWAYS.	
GENERAL CONTRACTOR SHALL COORDINATE AND COMPLY WITH ALL UTILITY COMPANIES INVOLVED IN PROJECT AND PAY ALL REQUIRED FEES AND COSTS.	
FOR SITE UTILITIES, SEE UTILITY PLANS.	
ALL RADIUS SHALL BE 4' UNLESS OTHERWISE NOTED.	
ALL DIMENSIONS, UNLESS OTHERWISE NOTED, ARE TO THE FACE OF CURB, FACE OF BUILDING OR CENTERLINE OF STRIPES.	
ALL SIGN POSTS AND BACKS AND BRACKET ARMS SHALL BE PAINTED BLACK USING CARBOLINE RUSTICORD PENETRATING SEALER 5G AND CARBOLINE 133 HB PAINT (OR EQUIVALENT AS APPROVED BY CITY AND MODOT).	
SIGNS DESIGNATING STREET NAME SHALL BE ON OPPOSITE SIDE OF THE STREET FROM TRAFFIC CONTROL SIGNS.	
ALL SIGN LOCATIONS AND SIZES SHOWN ON PLANS MUST BE APPROVED SEPARATELY THROUGH THE PLANNING DIVISION.	
ALL PAVING TO BE IN ACCORDANCE WITH I.T. CHARLES COUNTY STANDARDS AND SPECIFICATIONS EXCEPT AS MODIFIED BY THE CITY OF OFFALLEN ORDINANCES.	

STREET ADDRESS 101 McDONALDS LANE	
CITY OFALLON	STATE MISSOURI
COUNTY ST. CHARLES	
REGIONAL DWG. NO. 24/0130	
ISLAND DETAIL	

DATE	REV	DESCRIPTION
12/15/06	2	RESUBMITTAL WITH REVISIONS TO McDONALDS DRIVE
01/16/07	3	CITY COMMENTS 01/16/07
02/13/07	4	REMOVED LEFT TURN LANE ON McDONALDS DRIVE
5/30/07	5	REVISED LEFT TURN LANE ON McDONALDS DRIVE
5/19/07	6	SUBMITTAL FOR PLANNING COMMISSION
6/15/07	7	RESUBMITTAL FOR PLANNING COMMISSION
8/16/07	8	CITY SUBMITTAL
10/1/07	9	CITY COMMENTS 9-18-07
10/9/07	10	MODOT COMMENTS
2/18/07	11	CITY COMMENTS 11-06-07



*ASPHALT PAVEMENT SECTION TO BE 3" ASPHALT COURSE COMPACTED TO 95% DENSITY AND 18" COMPACTED STONE BASE COMPACTED TO 98% MODIFIED PROCTOR (PER GEOTECH SPECIFICATIONS).

(REFER TO McDONALDS PROJECT MANAGER FOR FURTHER DETAILS)

Clark
Civil Engineering Inc.
Civil Engineering Inc.
1008 N.W. 17th St., Ste. C, Bonita, AR 72712
(479) 464-8850 (F) (479) 464-9940 (P)
Regional Office: 1228 S. Hwy. 66, Bonita, MO 64625
(913) 310-0470 (F) (913) 310-0267 (P)

McDonald's
THESE PLANS AND SPECIFICATIONS ARE THE PROPERTY OF McDONALDS CORPORATION AND SHALL NOT BE REPRODUCED WITHOUT THEIR WRITTEN PERMISSION.
KANSAS CITY
10801 MASTIN BLVD., STE. 400, OVERLAND PARK, KS 66210

STATUS	DATE	BY
PRELIMINARY	-/-/-	-
PLAN CHECKED	-/-/-	-
AS-BUILT	-/-/-	-
PROJECT NO.	06-0620	

C-2.1