

**UTILITY GENERAL NOTES:**

ALL WATER LINES SHALL HAVE A MINIMUM OF 3'-6" COVER ABOVE TOP OF PIPE.  
 ALL SANITARY SEWER LINES SHALL HAVE A MINIMUM COVER OF 3'-0" COVER ABOVE TOP OF PIPE.  
 PROPOSED UTILITIES TO BE BURIED IN THE SAME TRENCH INSTALLATION SHALL BE COORDINATED AND APPROVED BY LOCAL UTILITY COMPANIES.  
 VERIFY LOCATION AND DEPTH OF EXISTING UTILITY BEFORE CONSTRUCTING PROPOSED UTILITY.  
 CONTRACTOR SHALL COORDINATE ANY DISRUPTIONS TO EXISTING UTILITY SERVICE WITH ADJACENT PROPERTY OWNERS.  
 ALL ELECTRIC, TELEPHONE AND GAS EXTENSIONS INCLUDING SERVICE LINES SHALL BE CONSTRUCTED TO THE APPROPRIATE UTILITY COMPANY SPECIFICATIONS. ALL UTILITY DISCONNECTIONS SHALL BE COORDINATED WITH THE DESIGNATED UTILITY COMPANIES.  
 CONSTRUCTION SHALL NOT START ON ANY PUBLIC UTILITY SYSTEM UNLESS WRITTEN APPROVAL HAS BEEN RECEIVED BY THE ENGINEER FROM THE APPROPRIATE GOVERNING AUTHORITY AND CONTRACTOR HAS BEEN NOTIFIED BY THE ENGINEER.  
 THE MINIMUM HORIZONTAL SEPARATION BETWEEN THE CLOSEST TWO POINTS OF THE WATER AND SEWER LINE IS TEN FEET (10'). THE MINIMUM VERTICAL SEPARATION BETWEEN THE CLOSEST TWO POINTS OF THE WATER AND SEWER LINE IS EIGHTEEN INCHES (18").  
 ALL TRENCHING, PIPE LAYING, AND BACK FILLING PROCEDURES SHALL BE IN ACCORDANCE WITH FEDERAL OSHA REGULATIONS.  
 PRIOR TO THE CONSTRUCTION OF OR CONNECTION TO ANY FORMAL DRAIN, SANITARY SEWER, WATER MAIN OR ANY OF THE DRY UTILITIES, THE CONTRACTOR SHALL DIG, VERIFY AND CALCULATE ALL POINTS OF CONNECTION AND ALL UTILITY CROSSINGS AND FROM QUARK CIVIL ENGINEERING AND THE OWNER/DEVELOPER OF ANY CONFLICT OR REQUIRED DEVIATIONS FROM THE PLAN, NOTIFICATION SHALL BE MADE A MINIMUM OF 48 HOURS PRIOR TO CONSTRUCTION. QUARK CIVIL ENGINEERING AND ITS CLIENTS SHALL BE HELD HARMLESS IN THE EVENT THAT THE CONTRACTOR FAILS TO MAKE SUCH NOTIFICATION.  
 ALL WATER LINE PIPE BEDDING SHALL BE INSTALLED PER DETAIL 1049 (SEE DETAIL SHEETS).  
 ALL SANITARY SEWER PIPE BEDDING SHALL BE INSTALLED PER DETAIL 1049 (SEE DETAIL SHEETS).  
 CONTRACTOR SHALL BE RESPONSIBLE FOR NOTIFYING THE CITY CONSTRUCTION DIVISION TO SCHEDULE A PRE-CONSTRUCTION MEETING AT LEAST 48 HOURS PRIOR TO STARTING ANY WORK ON THIS PROJECT. CONTRACTOR SHALL OBTAIN ALL NECESSARY PERMITS.  
 EXISTING UTILITIES ACROSS OR ALONG THE LINE OF THE PROPOSED WORK ARE SHOWN ONLY IN AN APPROXIMATE LOCATION ON THESE PLANS. CONTRACTOR SHALL CALL THE STATE ONE CALL SYSTEM OR DESIGNATED UTILITY COMPANY PRIOR TO CONSTRUCTION. CONTRACTOR SHALL OBTAIN OWNERS' PERMISSION AND AT NO ADDITIONAL COST, LOCATE ALL UNDERGROUND LINES AND STRUCTURES AS NECESSARY. CONTRACTOR SHALL BE RESPONSIBLE FOR ANY DAMAGE TO UNDERGROUND LINES OR STRUCTURES.  
 CONTRACTOR SHALL NOT TAP OR OTHERWISE PENETRATE EXISTING WATER AND SEWER MAIN LINES WITHOUT PRIOR APPROVAL FROM THE CITY'S INSPECTOR. CONTRACTOR IS RESPONSIBLE FOR AVOIDING SPILLAGE OF RAW SEWAGE. CONTRACTOR SHALL PROVIDE ALL SEWER FLEECING AND PUMPING EQUIPMENT NECESSARY TO AVOID SPILLAGE. CONTRACTOR SHALL NOT OPERATE VALVES ON EXISTING WATER MAINS.  
 THE EXISTING UTILITIES AND OBSTRUCTIONS SHOWN ARE FROM THE BEST AVAILABLE RECORDS AND SHALL BE VERIFIED BY THE CONTRACTOR TO HIS SATISFACTION PRIOR TO CONSTRUCTION. NECESSARY PRECAUTIONS SHALL BE TAKEN BY THE CONTRACTOR TO PROTECT EXISTING SERVICES AND MAINS, AND ANY DAMAGE TO THEM SHALL BE REPAIRED IMMEDIATELY BY THE CONTRACTOR'S EXPENSE.  
 IT SHALL BE DISTINCTLY UNDERSTOOD THAT FAILURE TO SPECIFICALLY MENTION WORK WHICH IS REQUIRED TO COMPLETE THE PROJECT SHALL NOT RELIEVE THE CONTRACTOR OF HIS RESPONSIBILITY TO PERFORM SUCH WORK.  
 CONTRACTOR SHALL MATCH TOP OF PROPOSED SANITARY SEWER MANHOLE TO PROPOSED GRADE. IF A DISCREPANCY OCCURS BETWEEN PROPOSED GRADE AND PROPOSED STRUCTURE TOP, THE GRADING SHALL GOVERN. IF THE DISCREPANCY IS MORE THAN 4 INCHES THE CONTRACTOR SHALL CONTACT THE ENGINEER OF RECORD.  
 ALL UTILITIES, INCLUDING STORM SEWER, SHOWN WITHIN PUBLIC EASEMENTS OR RIGHT OF WAYS SHALL BE CONSTRUCTED TO THE GOVERNING AGENCY'S SPECIFICATIONS. ALL OTHER UTILITIES SHALL BE CONSTRUCTED TO THE CITY OR TO THE GOVERNING AGENCY'S SPECIFICATIONS, WHICHEVER IS MORE STRINGENT. IF THERE IS A QUESTION AS TO WHICH SPECIFICATIONS SHOULD APPLY THE CONTRACTOR SHALL CONTACT THE ENGINEER OF RECORD.  
 IF SANITARY SEWER MANHOLE IS LOCATED IN A GRASS AREA OR BLOPE, CONTRACTOR SHALL CONTRACT MANHOLE TOP TO AN ELEVATION 6 INCHES HIGHER THAN THE PROPOSED GRADE. IF THIS CANNOT BE ACHIEVED THEN CONTRACTOR SHALL USE A WATER TIGHT MANHOLE COVER THAT MEETS OR EXCEEDS THE OWNER'S DEVELOPER'S STANDARD SITE SPECIFICATIONS.  
 ALL WATER MAINS SHALL BE HYDROSTATICALLY TESTED AND DISINFECTED BEFORE ACCEPTANCE. SEE SITE WORK SPECIFICATIONS.  
 CONTRACTOR SHALL COORDINATE WITH UTILITY COMPANIES ON ADJUSTING EXISTING UTILITY LINE AS REQUIRED BY CUT AND FILL AND SHALL AT NO ADDITIONAL COST TO THE OWNER.  
 CONTRACTOR SHALL NOTIFY ENGINEER OF RECORD AND ARCHITECT SHOULD ANY LIGHT POLE OR SIGN FOUNDATIONS CONFLICT WITH ANY UTILITY AND / OR STORM SEWER SYSTEM.  
 GENERAL CONTRACTOR SHALL PROVIDE 2" x 6" THICK CONCRETE APRON AT ALL CLEANOUTS, GATE VALVES AND METER BOXES ETC. OUTSIDE OF BUILDING AND IN PAVED AREAS.  
 GENERAL CONTRACTOR WILL BE RESPONSIBLE FOR ALL TAX AND THE ON FEES REQUIRED, AS WELL AS COST OF UNDERGROUND SERVICE CONNECTIONS TO THE BUILDING.  
 ELECTRICAL SERVICE TO PAD MOUNTED TRANSFORMER SHALL BE RUN UNDERGROUND, FROM ROAD RIGHT-OF-WAY TO TRANSFORMER LOCATION. ASSOCIATED COST BY GENERAL CONTRACTOR.  
 UTILITY CONTRACTOR SHALL FURNISH (2) - 4" TELEPHONE CONDUITS AS SHOWN ON PLAN, VERIFY LOCATION OF THE IN AT TELEPHONE COMPANIES SERVICE LINE, PROVIDE NYLON PULL CHAIN INSIDE CONDUIT.  
 DIMENSIONS SHOWN ARE TO CENTERLINE OF PIPE OR FITTING UNLESS OTHERWISE NOTED.  
 ALL FIRE HYDRANTS SHALL BE PROVIDED WITH AN APPROVED GATE VALVE A MAXIMUM OF 9'-0" FROM HYDRANT.  
 REFER TO PLUMBING SHEETS FOR LOCATION OF SEWER, DOMESTIC, AND IRRIGATION CONNECTIONS

SITE BENCHMARK:  
 X CUT IN CONCRETE APPROX. 37.5' NORTH OF  
 SOUTHWEST CORNER OF PROPERTY.  
 ELEVATION: 550.17

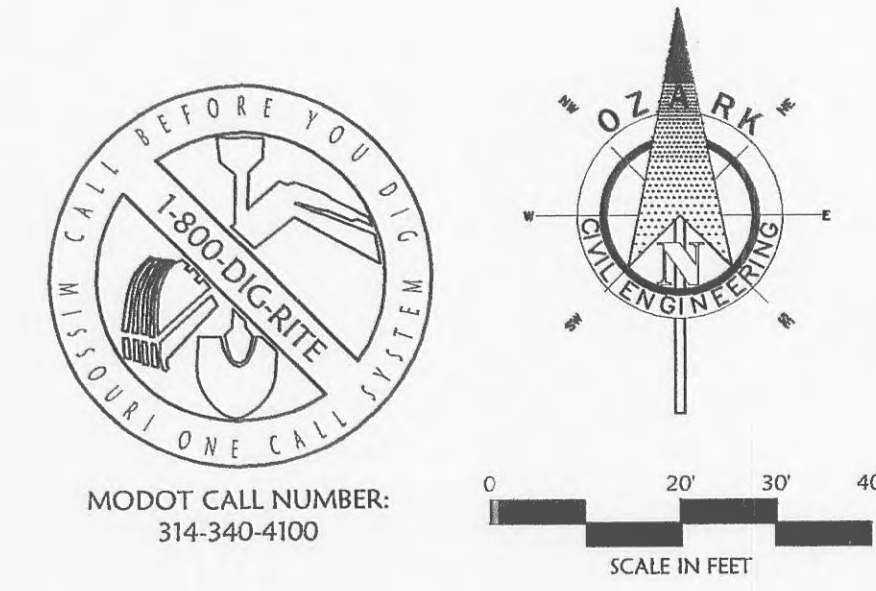

INTERSTATE HIGHWAY TO  
 (R/W VARIES & CENTERLINE  
 CANNOT BE DETERMINED)

MODOT CALL NUMBER:  
 314-340-4100

**UTILITY PROPOSED FEATURES**

---	BOUNDARY LINE
---	RIGHT OF WAY LINE
---	EASEMENT LINE
---	CONCRETE CURB AND GUTTER
---	FENCE
---	GUARD RAIL
---	RETAINING WALL
---	STORM DRAIN (SEE GRADING PLAN FOR SIZE)
---	SANITARY SEWER SERVICE
---	WATER SERVICE
---	UNDERGROUND ELECTRIC SERVICE
---	UNDERGROUND TELEPHONE SERVICE
---	OVERHEAD ELECTRIC SERVICE
---	OVERHEAD TELEPHONE SERVICE
---	FIBER OPTIC CABLE SERVICE
---	GAS SERVICE
---	DROP INLETS (SEE GRADING PLAN FOR TYPE)

**UTILITY NOTES**

XXX	Items labeled by the following symbols are shown on this sheet.
VS	MAINTAIN MINIMUM 18" VERTICAL SEPARATION
U01	1.5" TELEPHONE CONDUIT (PVC SCHEDULE 40)
U02	4" SCHEDULE 40 PVC CONDUIT
U03	POINT OF CONNECTION (PER LOCAL CODES)

**UTILITY DETAILS**

SD3/1	CLEANOUT DETAIL
SD3/2	TYPICAL EXTERIOR GREASE TRAP
SD6/8	FIRE HYDRANT ASSEMBLY

DATE	REV	DESCRIPTION
12/15/06	2	RESUBMITTAL WITH REVISIONS TO MCDONALD'S DRIVE
01/16/07	3	CITY COMMENTS
02/13/07	4	REMOVED LEFT TURN LANE ON MCDONALD'S DRIVE
5/30/07	5	REMOVED LEFT TURN LANE ON MCDONALD'S DRIVE
5/19/07	6	RESUBMITTAL FOR PLANNING COMMISSION
6/15/07	7	RESUBMITTAL FOR PLANNING COMMISSION
8/16/07	8	CITY SUBMITTAL
10/1/07	9	CITY COMMENTS 9-18-07
10/9/07	10	MIDDY COMMENTS
12/18/07	11	CITY COMMENTS 11-26-07
12/12/08	12	RELOCATED POWER POLE



\*ASPHALT PAVEMENT SECTION TO BE 3" ASPHALT COURSE COMPACTED TO 95% DENSITY AND 18" COMPACTED STONE BASE COMPACTED TO 98% MODIFIED PROCTOR (PER GEOTECH SPECIFICATIONS).

(REFER TO MCDONALD'S PROJECT MANAGER FOR FURTHER DETAILS)

NOTE:  
 ALL WORK IN STATE OF MISSOURI RIGHT OF  
 WAY REQUIRES PERMIT FROM MISSOURI  
 DEPARTMENT OF TRANSPORTATION.

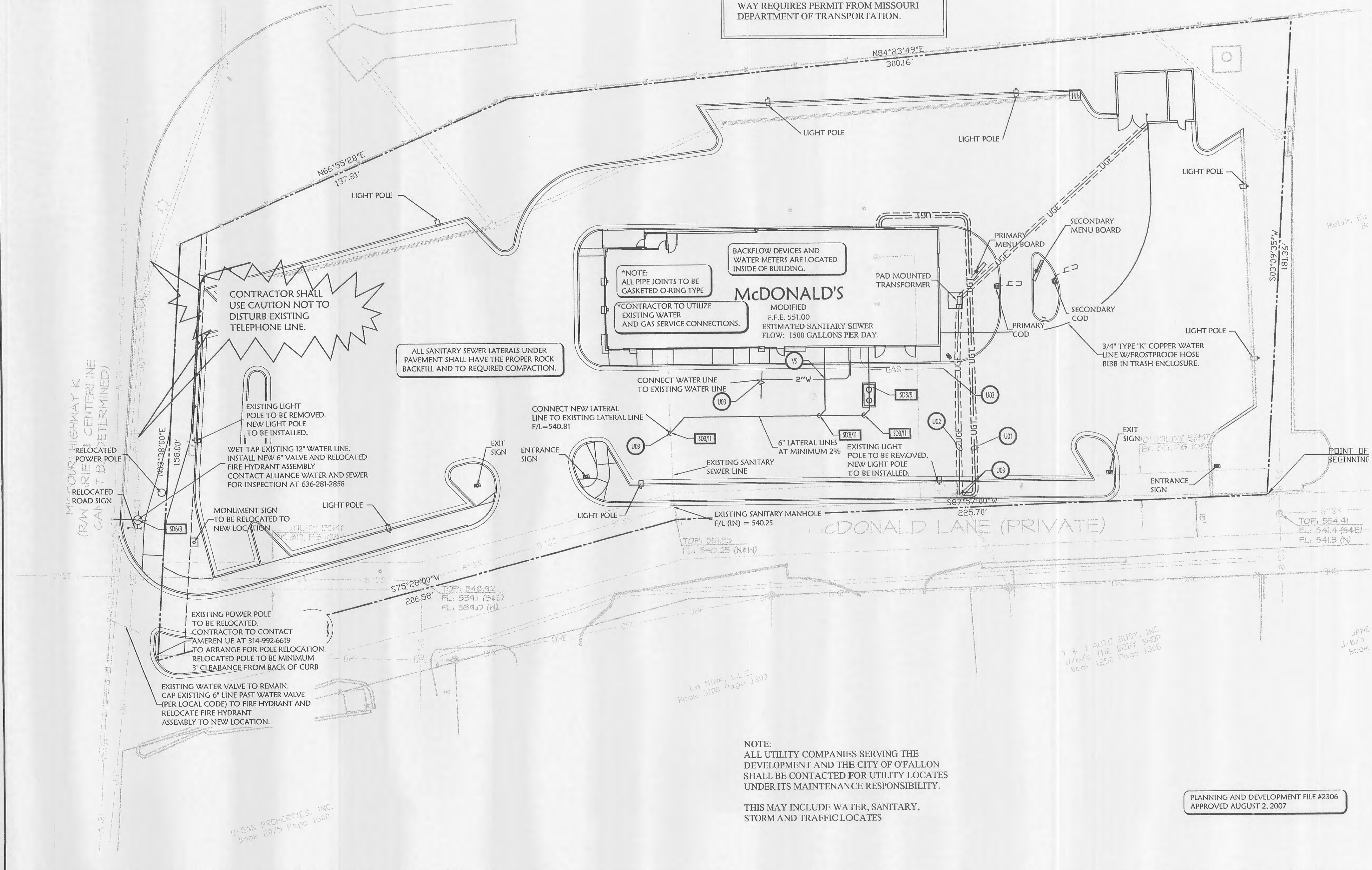

NOTE:  
 ALL UTILITY COMPANIES SERVING THE  
 DEVELOPMENT AND THE CITY OF FALLON  
 SHALL BE CONTACTED FOR UTILITY LOCATES  
 UNDER ITS MAINTENANCE RESPONSIBILITY.  
 THIS MAY INCLUDE WATER, SANITARY,  
 STORM AND TRAFFIC LOCATES

PLANNING AND DEVELOPMENT FILE #2306  
 APPROVED AUGUST 2, 2007

STREET ADDRESS		101 MCDONALD'S LANE	
CITY	STATE	PRELIMINARY	DATE
OFALLON	MISSOURI	-/-/-	-
COUNTY		PLAN CHECKED	-/-/-
ST. CHARLES		AS-BUILT	-/-/-
REGIONAL DWG. NO.	PROJECT NO.	06-0620	
24/0130	C-7		
UTILITY PLAN			

**Clark**  
 Civil Engineering Inc.  
 State Office: 1008 N.W. 11<sup>th</sup> St. Ste. C, Bentonville, AR 72712  
 (479) 464-8850 (V) / (479) 464-9040 (F)  
 Regional Office: 11285 Strong Line, Rd. Lamezia, KS 66215  
 (913) 310-0470 (V) / (913) 310-0261 (F)

**McDonald's**  
 THESE PLANS AND SPECIFICATIONS ARE THE PROPERTY OF MCDONALD'S CORPORATION AND SHALL NOT BE REPRODUCED WITHOUT THEIR WRITTEN PERMISSION.  
 KANSAS CITY  
 10801 WASTIN BLVD., STE. 400, OVERLAND PARK, KS 66210