

CURB DETAILS

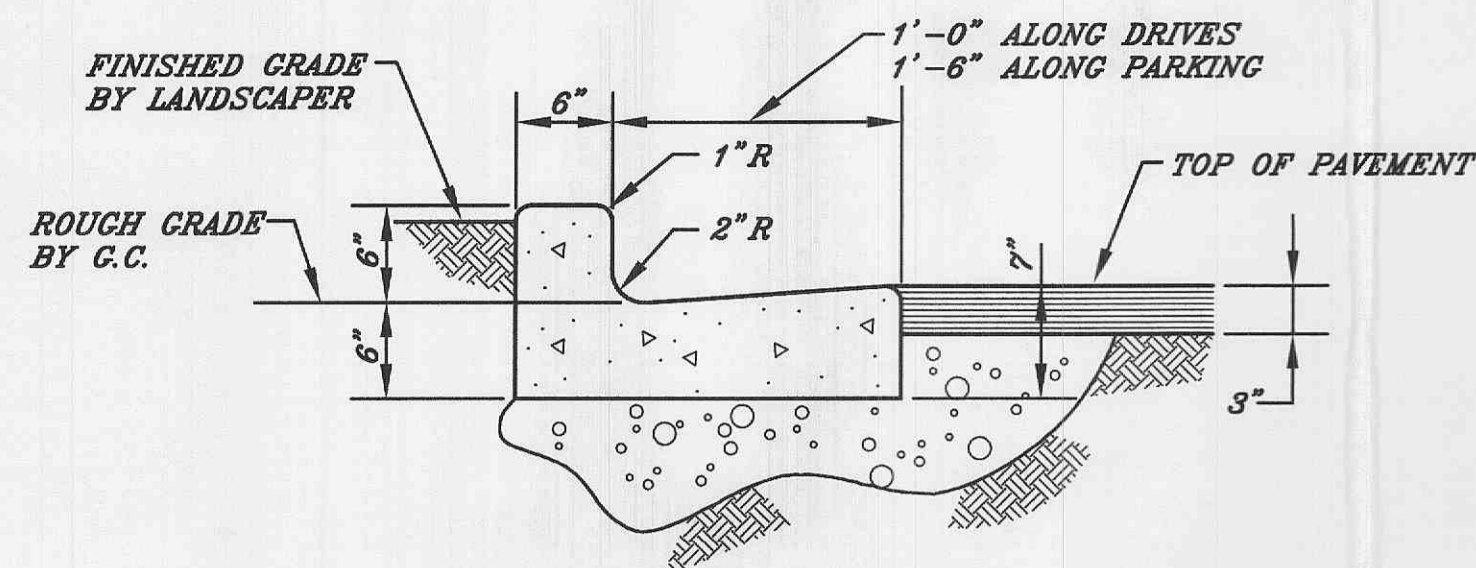

NOTE: PROVIDE EXPANSION JOINTS @ 20'-0" o.c. (MAX.)

CONCRETE CURB & GUTTER

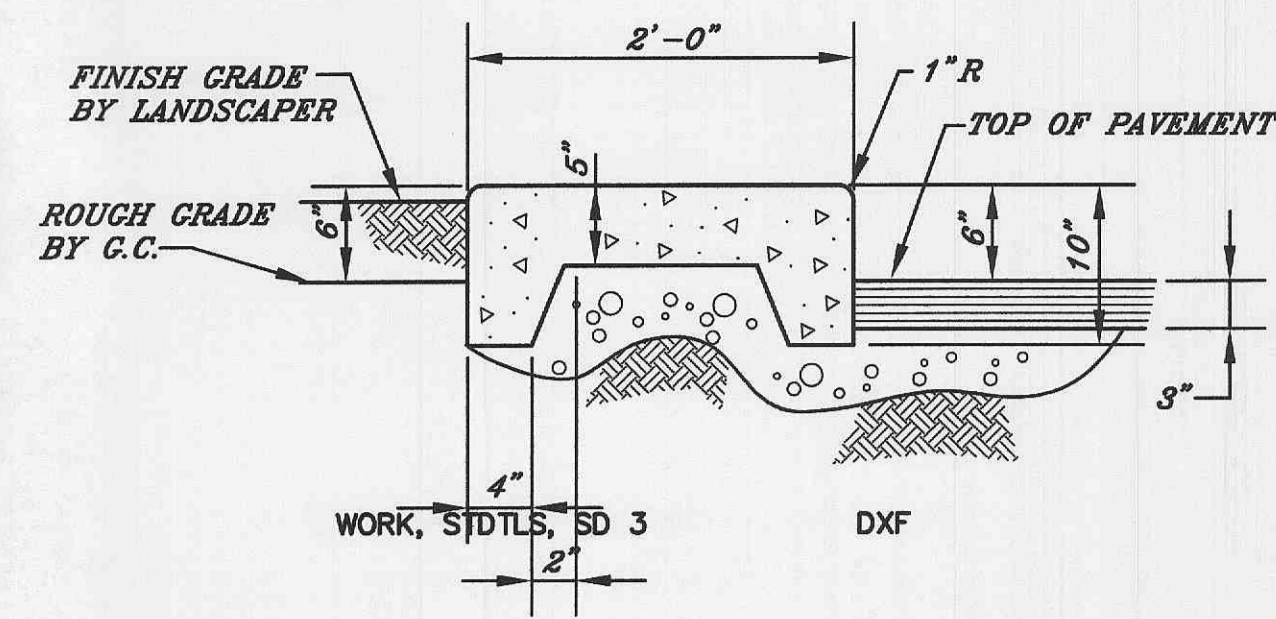

NOTE: PROVIDE EXPANSION JOINTS @ 20'-0" o.c. (MAX.)

10" X 24" CONCRETE CURB

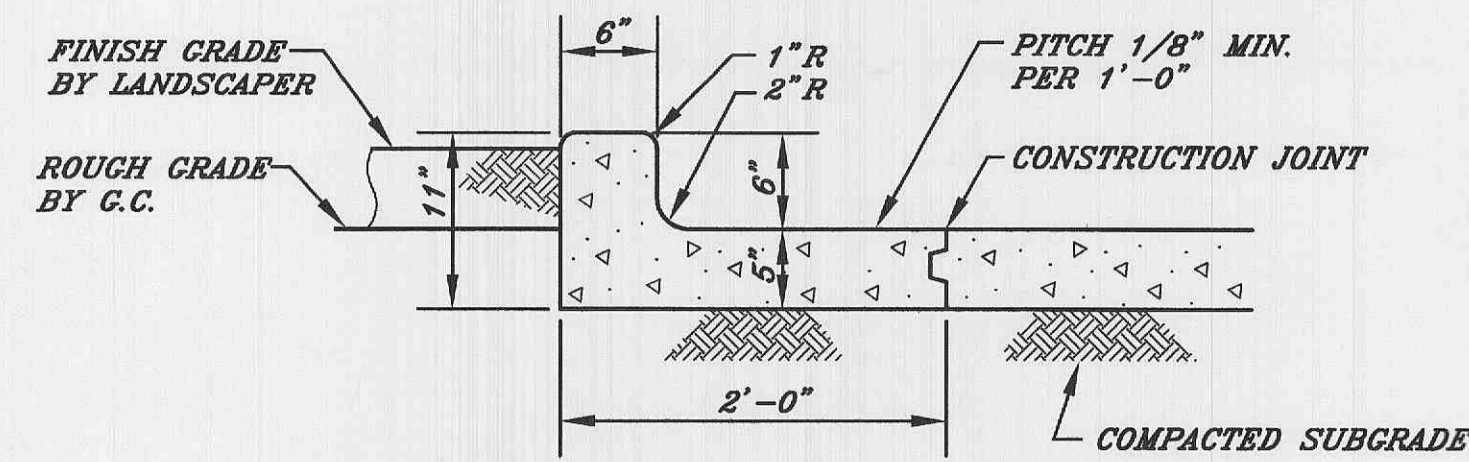

NOTE: PROVIDE EXPANSION JOINTS @ 15'-0" o.c. (MAX.)

INTEGRAL CURB FOR CONCRETE LOTS

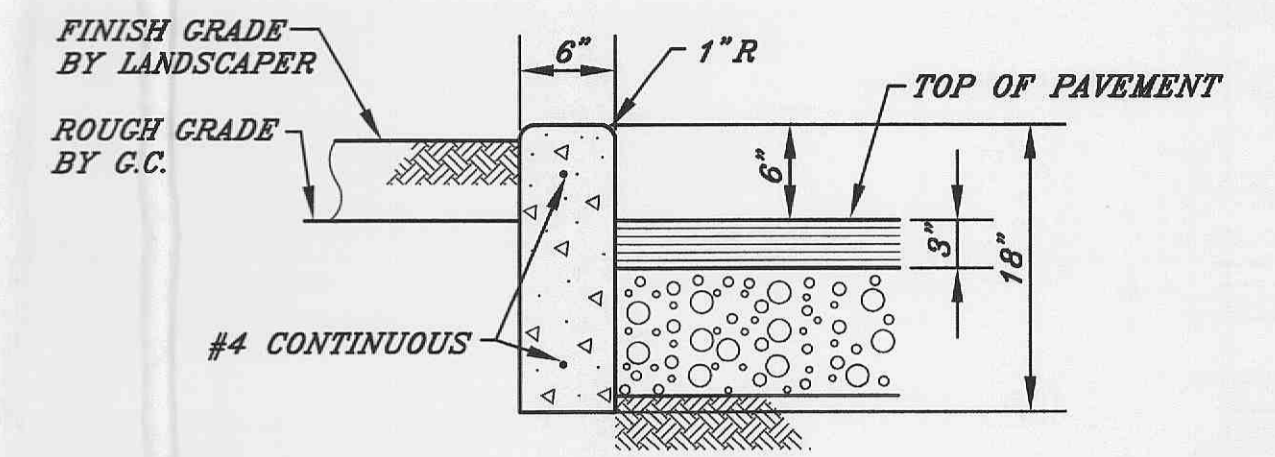

NOTE: PROVIDE EXPANSION JOINTS @ 20'-0" o.c. (MAX.)

6" X 18" CONCRETE CURB

NOTE: USE 1-1/4" PVC WEEP HOLES AT 10'-0" o.c. (MAX.) IN ALL INTERIOR CURBS.

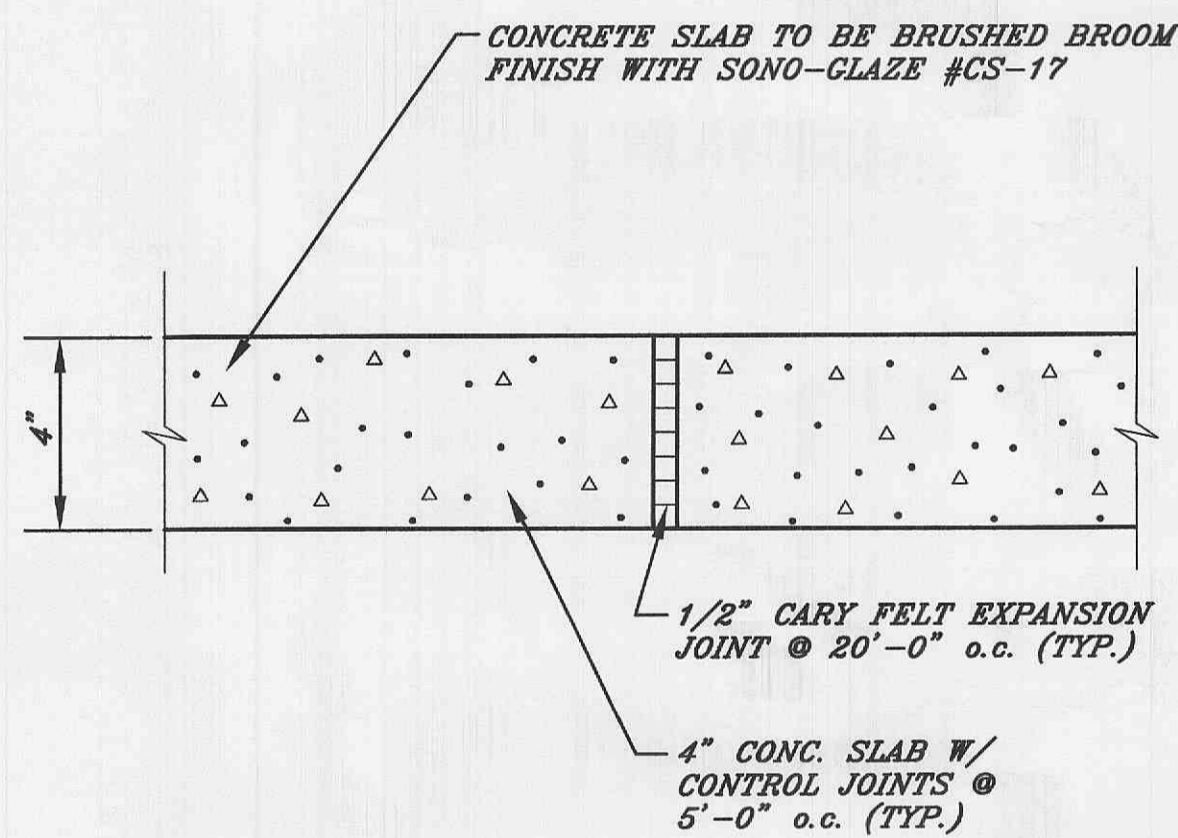

**SIDEWALK TREATMENT DETAILS
BRUSHED CONCRETE**

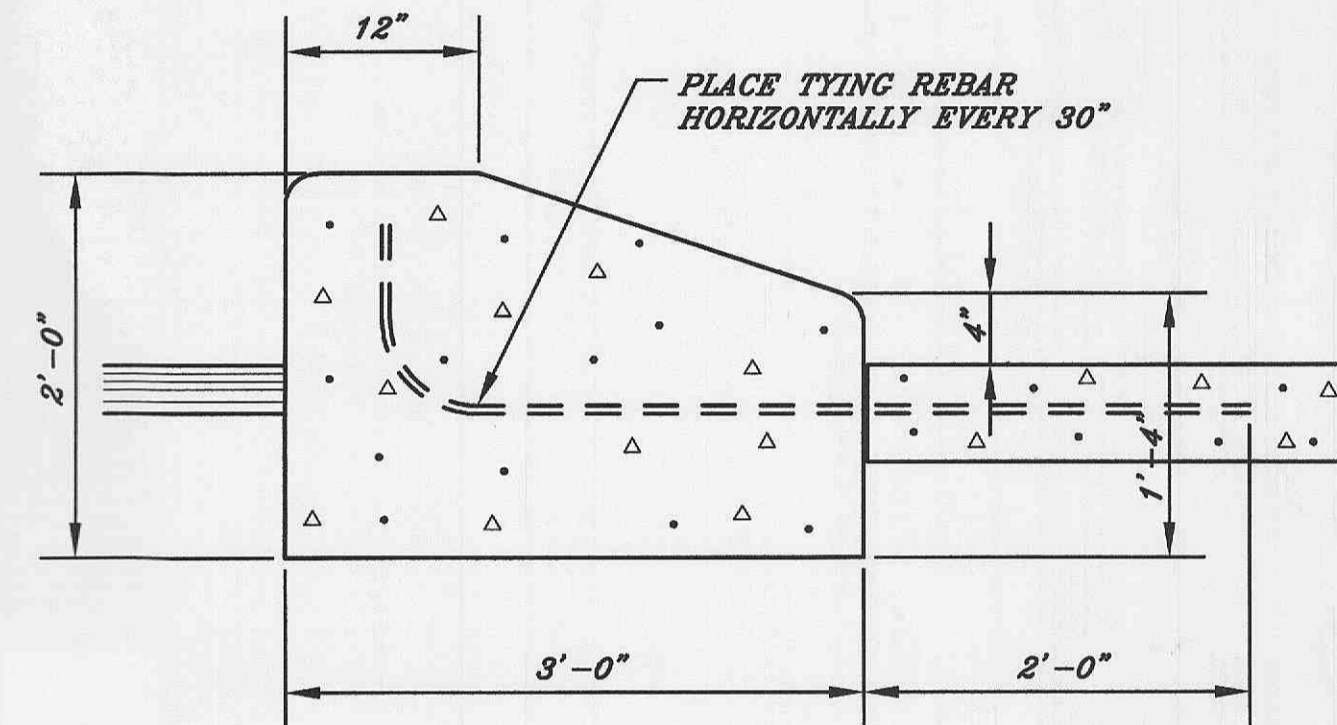

MOUNTABLE CURB

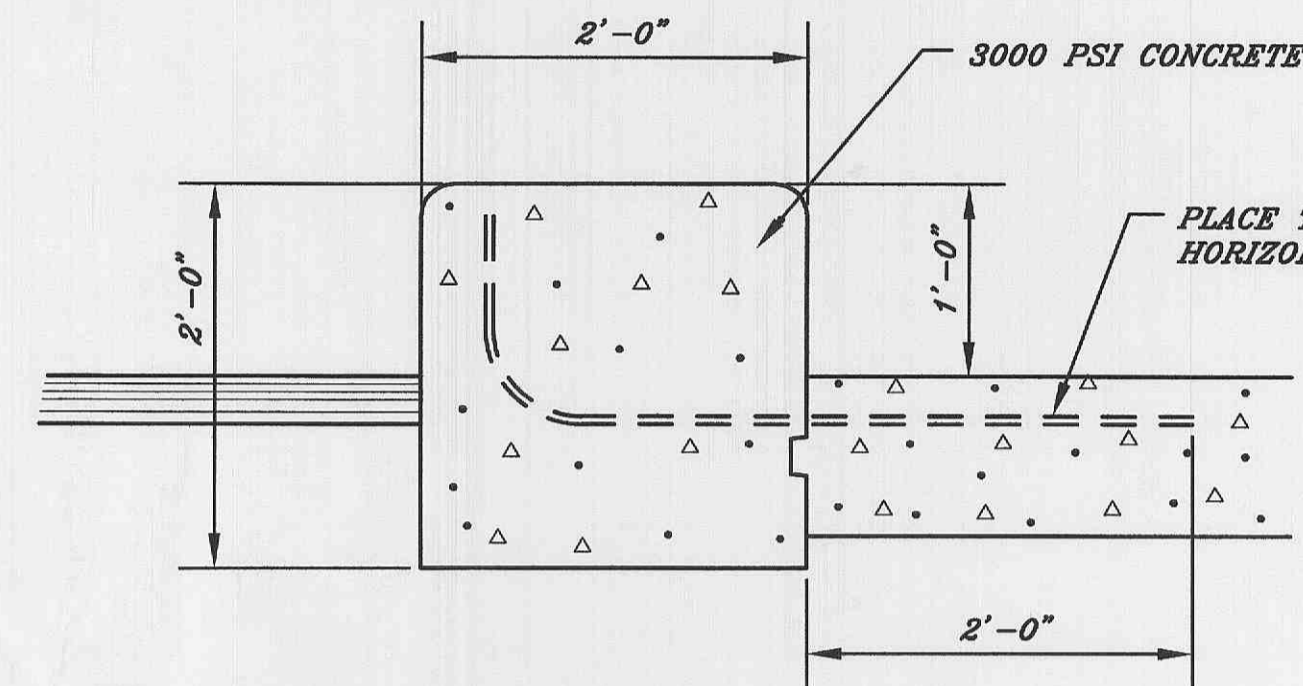

INTEGRAL TRUCK CURBING

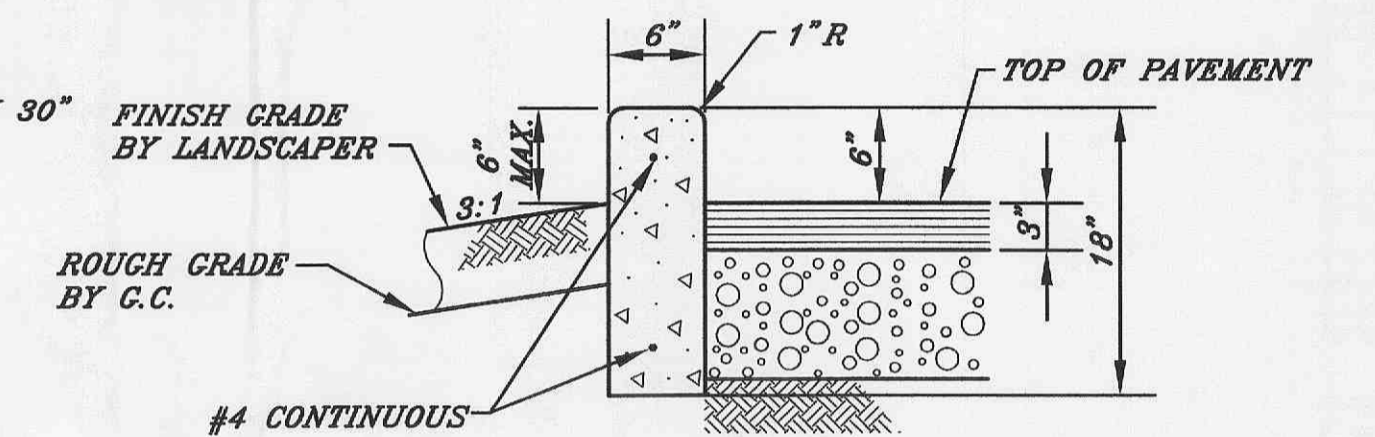

NOTE: PROVIDE EXPANSION JOINTS @ 20'-0" o.c. (MAX.)

EXPOSED 6" X 18" CONCRETE CURB

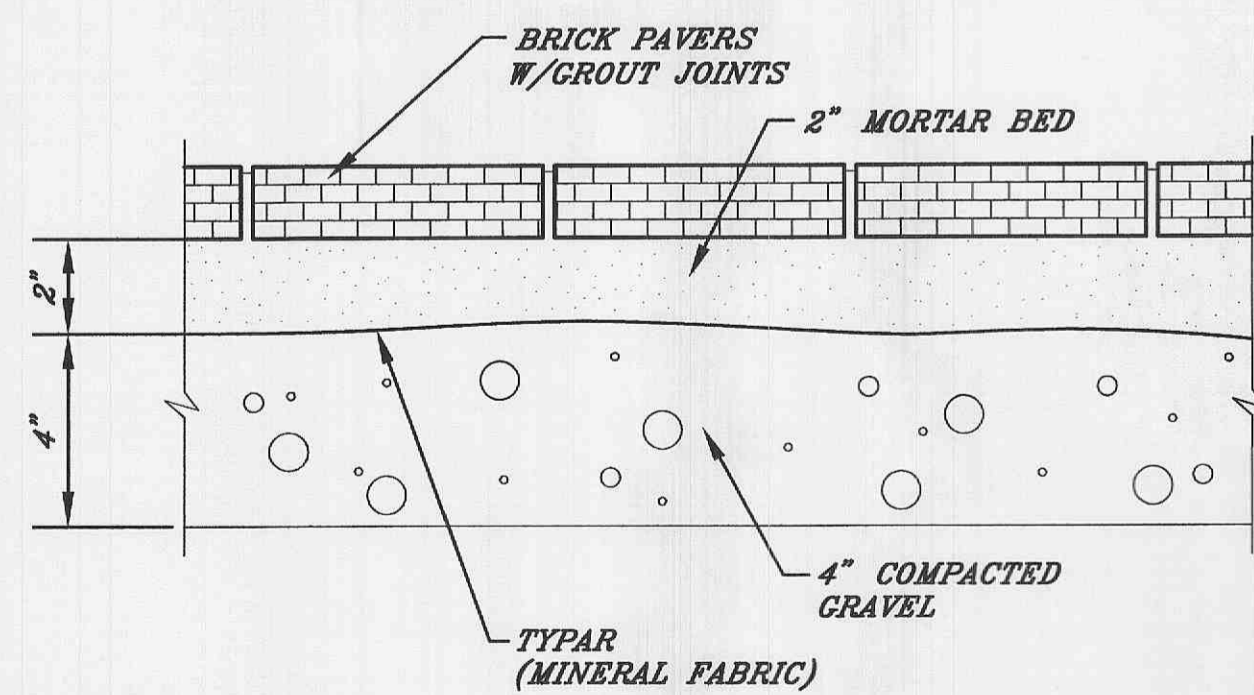

**SIDEWALK TREATMENT DETAILS
BRICK PAVERS IN SAND**

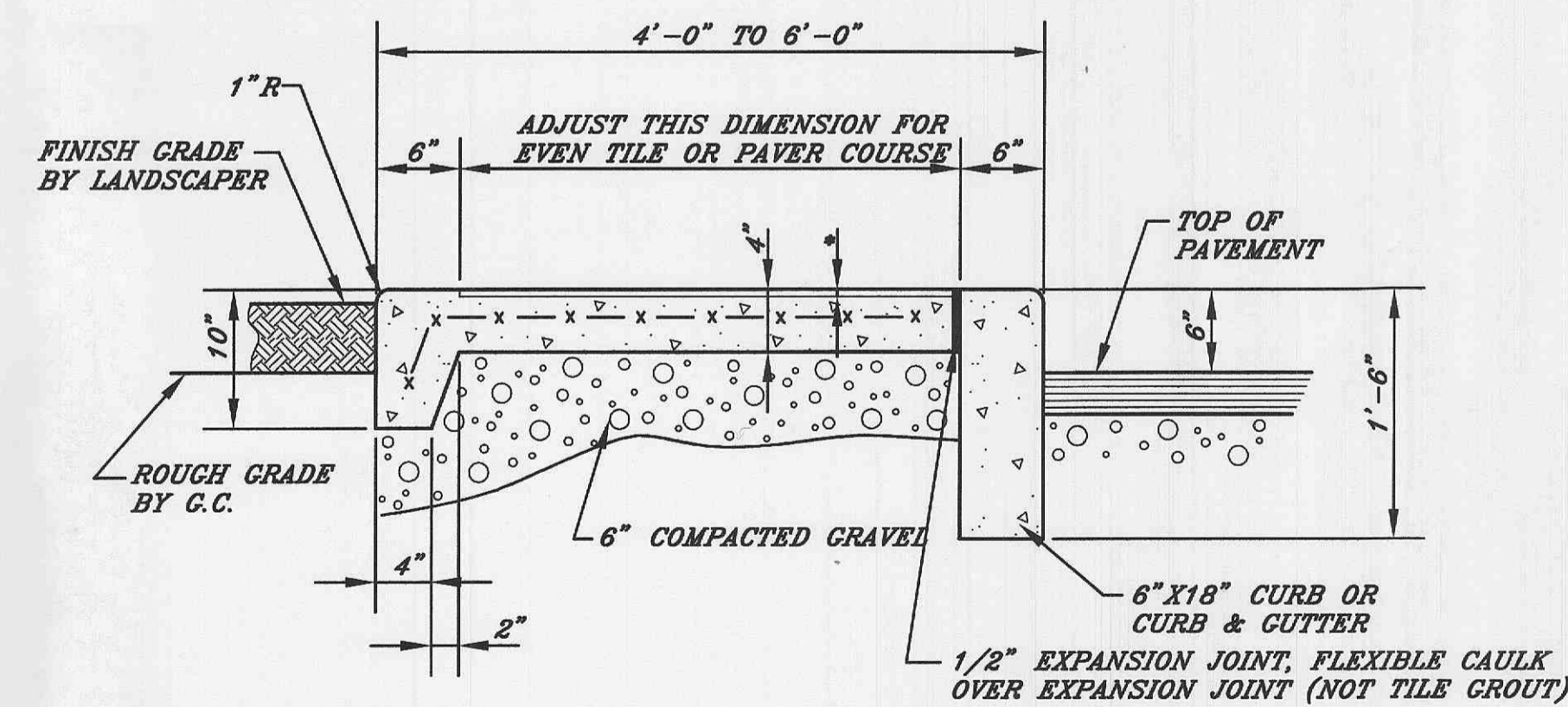

* NOTE: DIMENSION VARIES WITH WALK FINISH
**4' TO 6' SIDEWALK
(LANDSCAPE/WALK/PAVEMENT)**

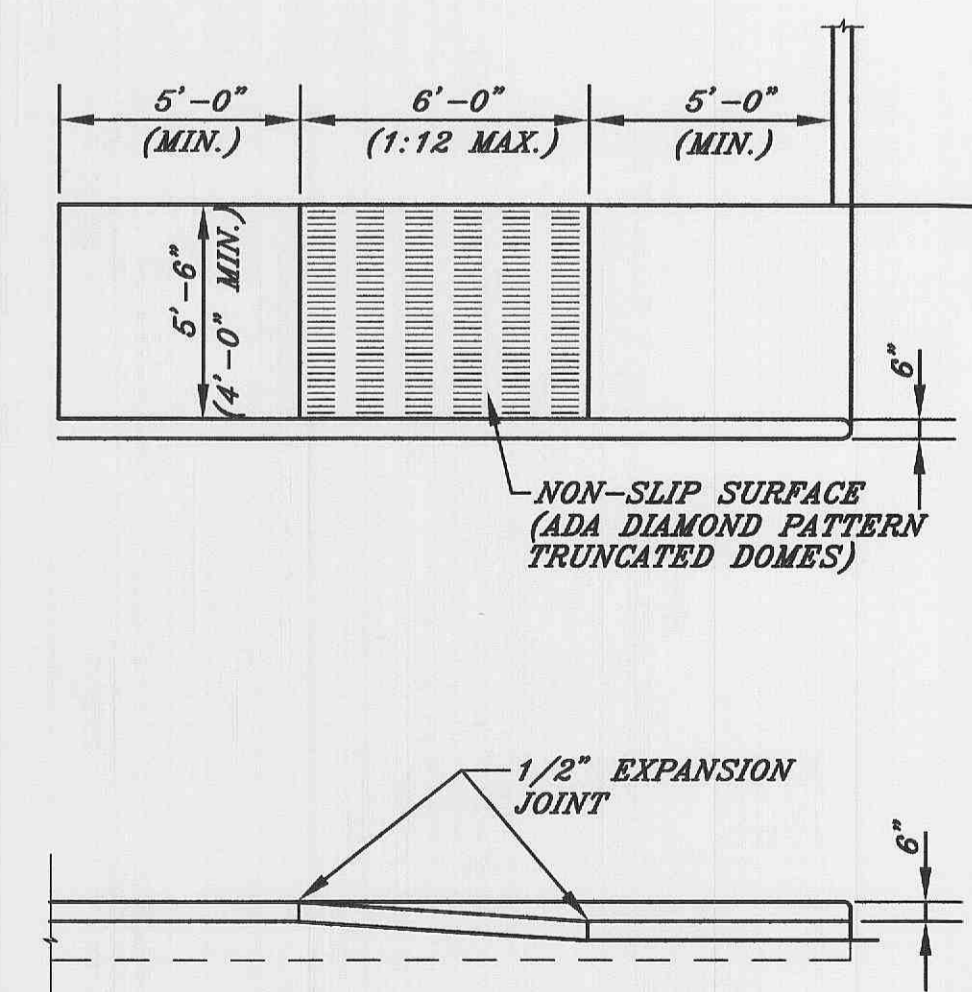

END RAMP CONDITION

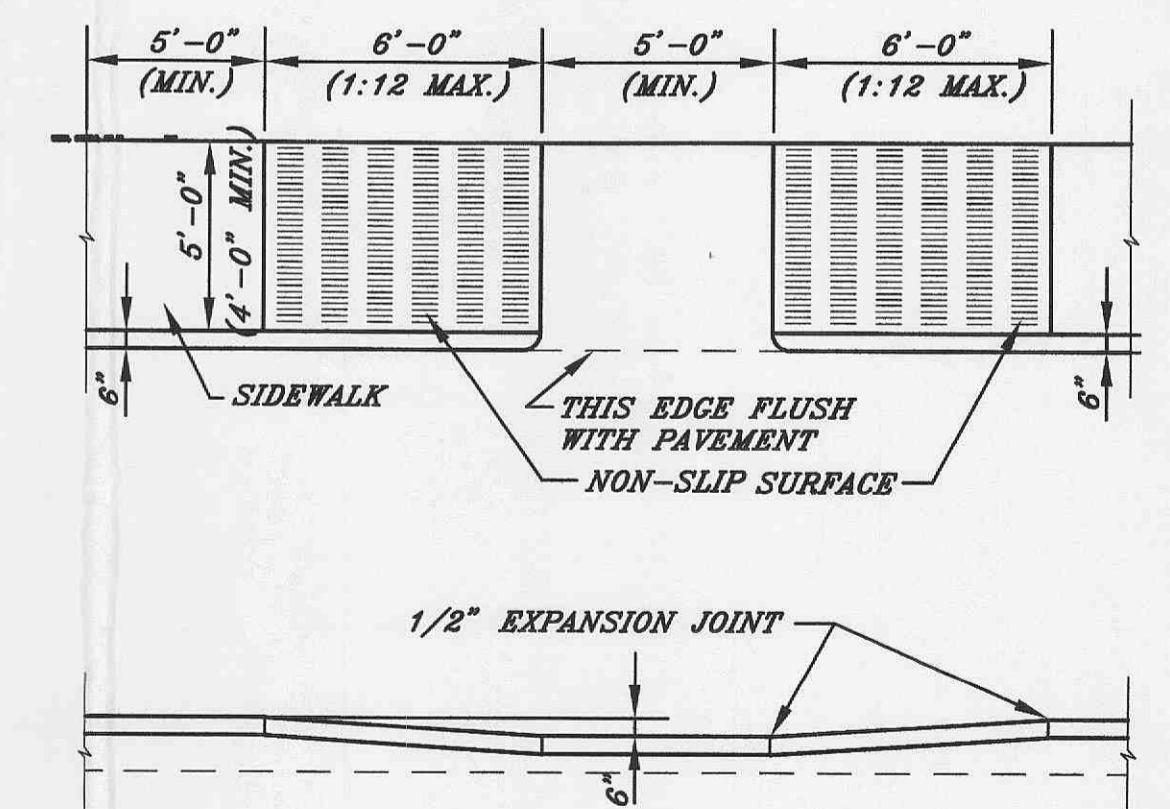

MID WALK RAMP CONDITION

SIDEWALK DETAILS

| | | | | | |
|---|---------|-------------------------|----|----|------------------|
| 2 | 07FEB95 | GENERAL REVISION/UPDATE | JM | JM | BY |
| 1 | 10JAN95 | GENERAL REVISION/REVIEW | JM | JM | BY |
| 1 | | REV. DATE | | | DESCRIPTION |
| | | NEW CONVENTION | | | SCALE |
| | | | | | UNITS OF MEASURE |

McDonald's
THESE DRAWINGS AND SPECIFICATIONS ARE THE PROPERTY OF MCDONALD'S CORPORATION AND SHALL NOT BE COPIED OR REPRODUCED WITHOUT THEIR WRITTEN PERMISSION.

| | | | |
|------------------------|---------------------------|--------------|---------------|
| MCDONALD'S CORPORATION | | SITE DETAILS | |
| TITLE | CURB AND SIDEWALK DETAILS | CHECKED BY | DATE CHECKED |
| DRAWN BY | DJH | APPROVED BY | DATE APPROVED |
| SITE NO. | 101-10101 | | |
| PROJECT NO. | | | |

SHEET NO. **SD1**