

NOTES:
 1. PROVIDE TACK COAT ALONG SAWCUT TO BIND EXISTING ASPHALT PAVEMENT TO NEW PAVEMENT. FOR AREAS WITH PATCHING AND OVERLAY, PROVIDE TACK COAT TO BIND EXISTING ASPHALT PAVEMENT WITH NEW PAVEMENT.

**DETAIL #01
 PAVEMENT SAWCUT**
 N.T.S.

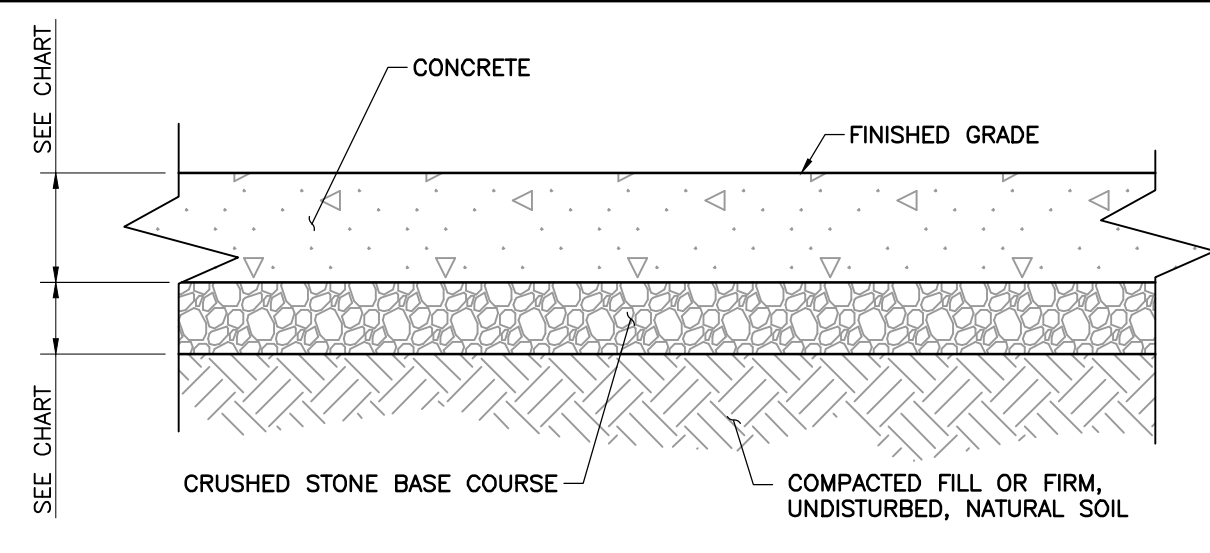

NOTES:
 1. SEE CHART IN ASPHALT PAVEMENT DETAIL FOR THICKNESSES.
 2. EXPANSION AND CONTROL JOINTS SHALL BE PER JOINT DETAILS
 3. CONCRETE SHALL BE CLASS "A" 4,000 PSI UNLESS OTHERWISE NOTED.
 4. PAVEMENT THICKNESSES SHOWN PER GEOTECHNICAL REPORT BY JACOBI GEOTECHNICAL ENGINEERING, INC. DATED SEPTEMBER, 2023. REFER TO THIS DOCUMENT FOR FURTHER SPECIFICATIONS AND/OR RECOMMENDATIONS.

**DETAIL #02
 CONCRETE PAVEMENT**
 N.T.S.

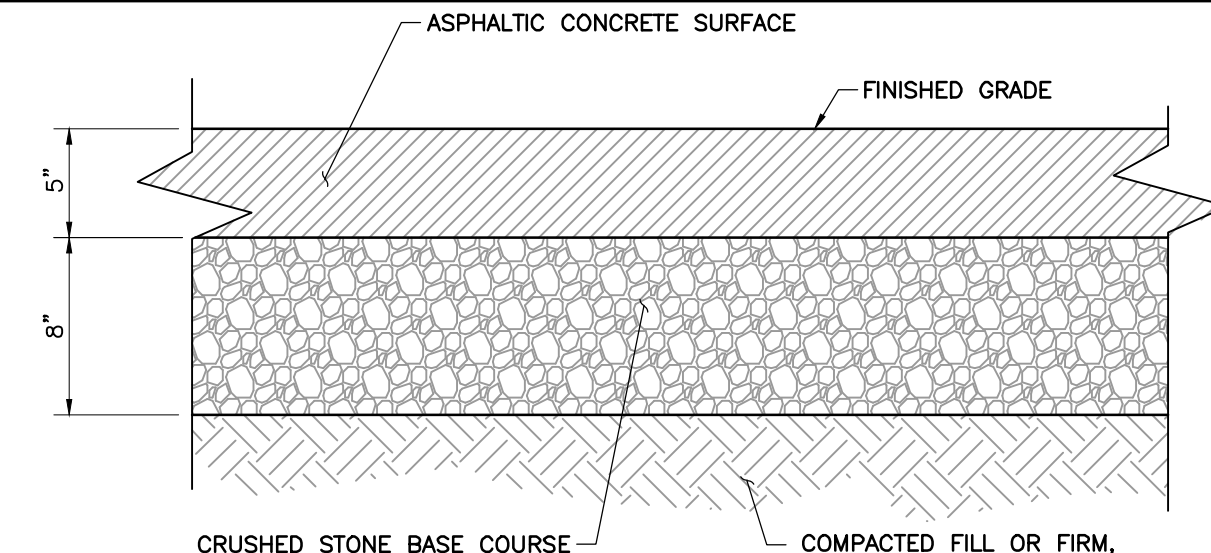

NOTES:
 1. PAVEMENT THICKNESSES SHOWN PER GEOTECHNICAL REPORT BY JACOBI GEOTECHNICAL ENGINEERING, INC. DATED SEPTEMBER, 2023. REFER TO THIS DOCUMENT FOR FURTHER SPECIFICATIONS AND/OR RECOMMENDATIONS.

**DETAIL #03
 ASPHALT PAVEMENT**
 N.T.S.

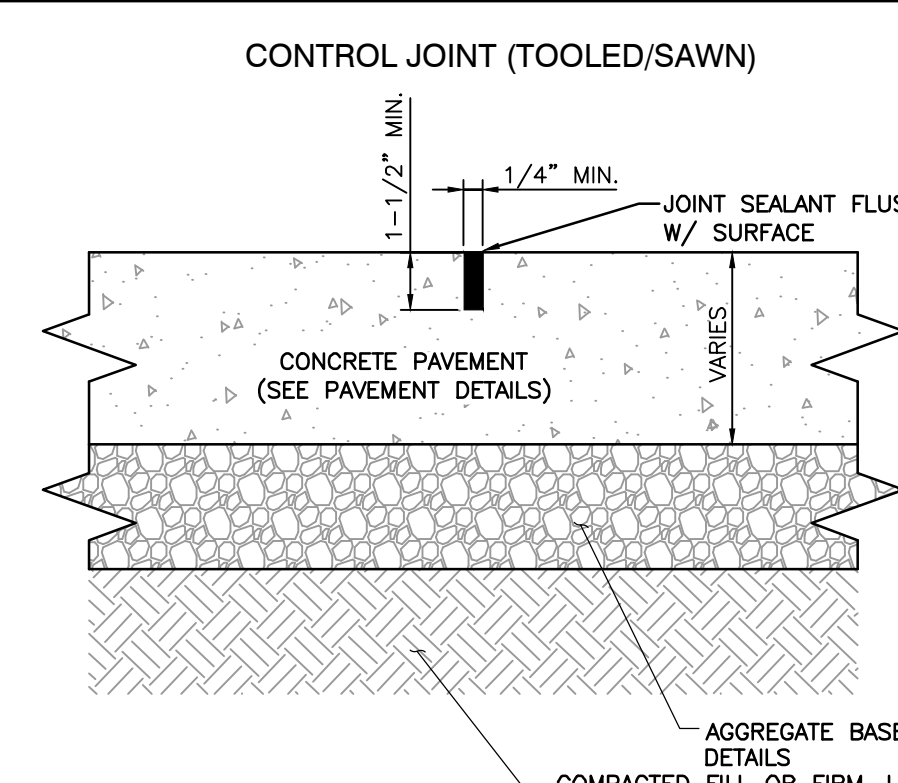

NOTES:
 1. MAXIMUM JOINT SPACING SHALL BE 15' CENTER TO CENTER.
 2. EXPANSION JOINTS ARE REQUIRED AT ALL LOCATIONS WHERE CHANGE OF MATERIAL OR THICKNESSES OCCUR OR ABUTTING STRUCTURES.

**DETAIL #04
 CONCRETE JOINTS**
 N.T.S.

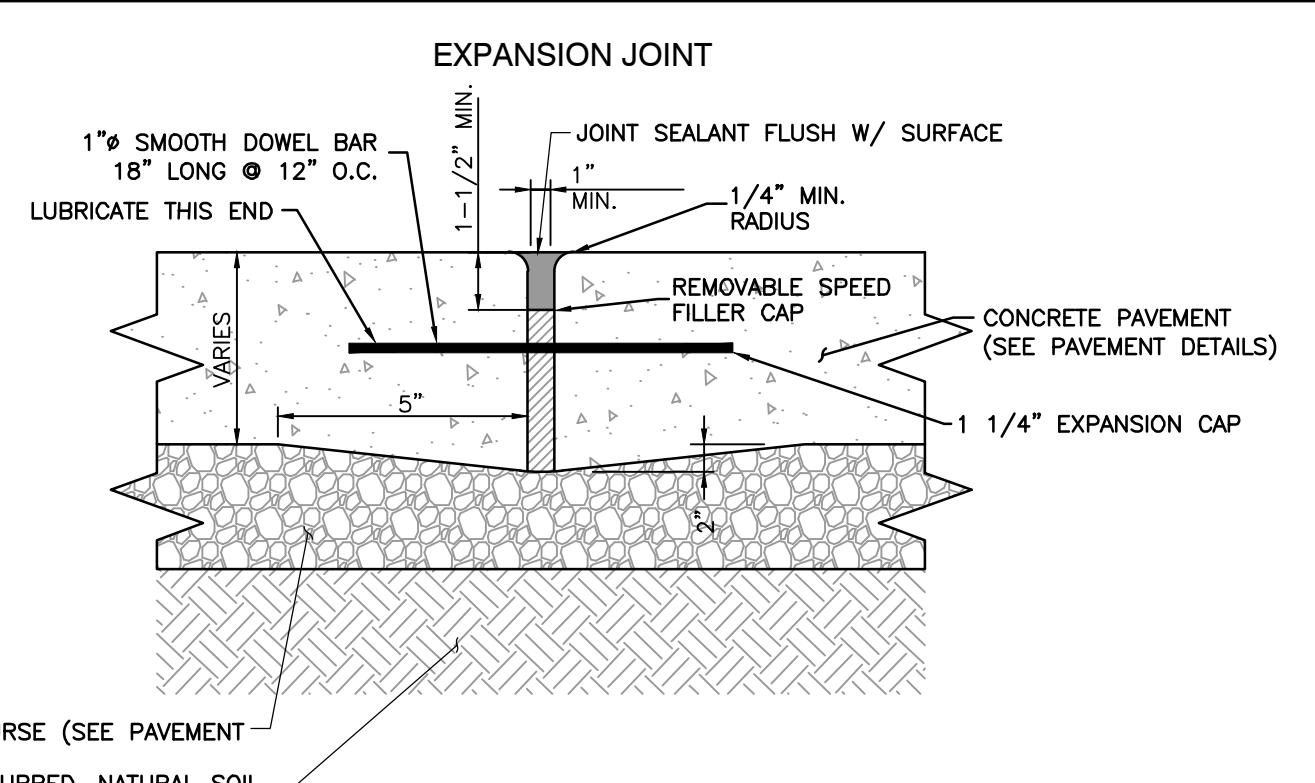

NOTES:
 1. MAXIMUM JOINT SPACING SHALL BE 15' CENTER TO CENTER.
 2. EXPANSION JOINTS ARE REQUIRED AT ALL LOCATIONS WHERE CHANGE OF MATERIAL OR THICKNESSES OCCUR OR ABUTTING STRUCTURES.

**DETAIL #04
 CONCRETE JOINTS**
 N.T.S.

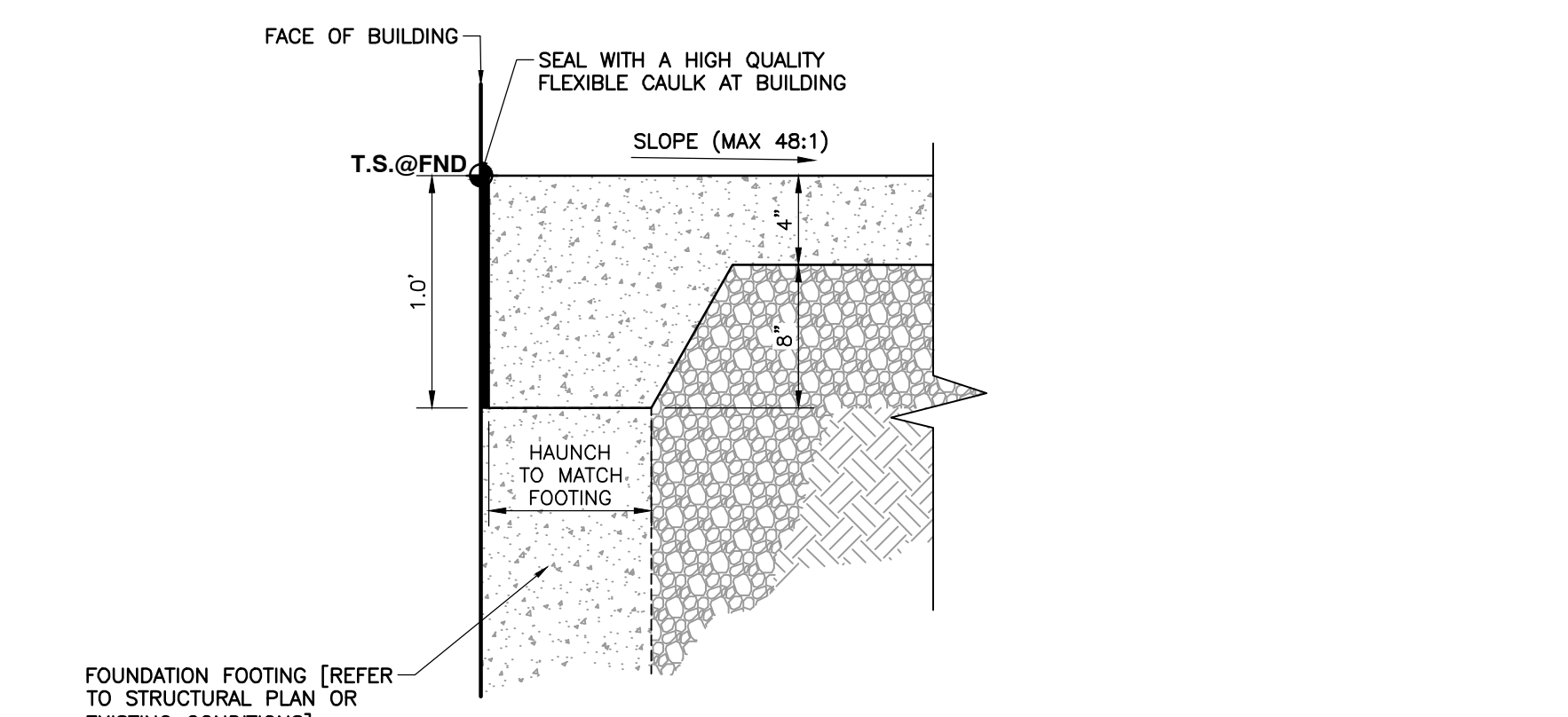

NOTES:
 1. PROVIDE 1/2" PREMOLDED EXPANSION JOINT @ 25' ON CENTER.
 2. PROVIDE TOOLED CONTRACTION JOINTS AT 5' ON CENTER.

**DETAIL #05
 COMBINATION CONCRETE CURB - SIDEWALK**
 N.T.S.

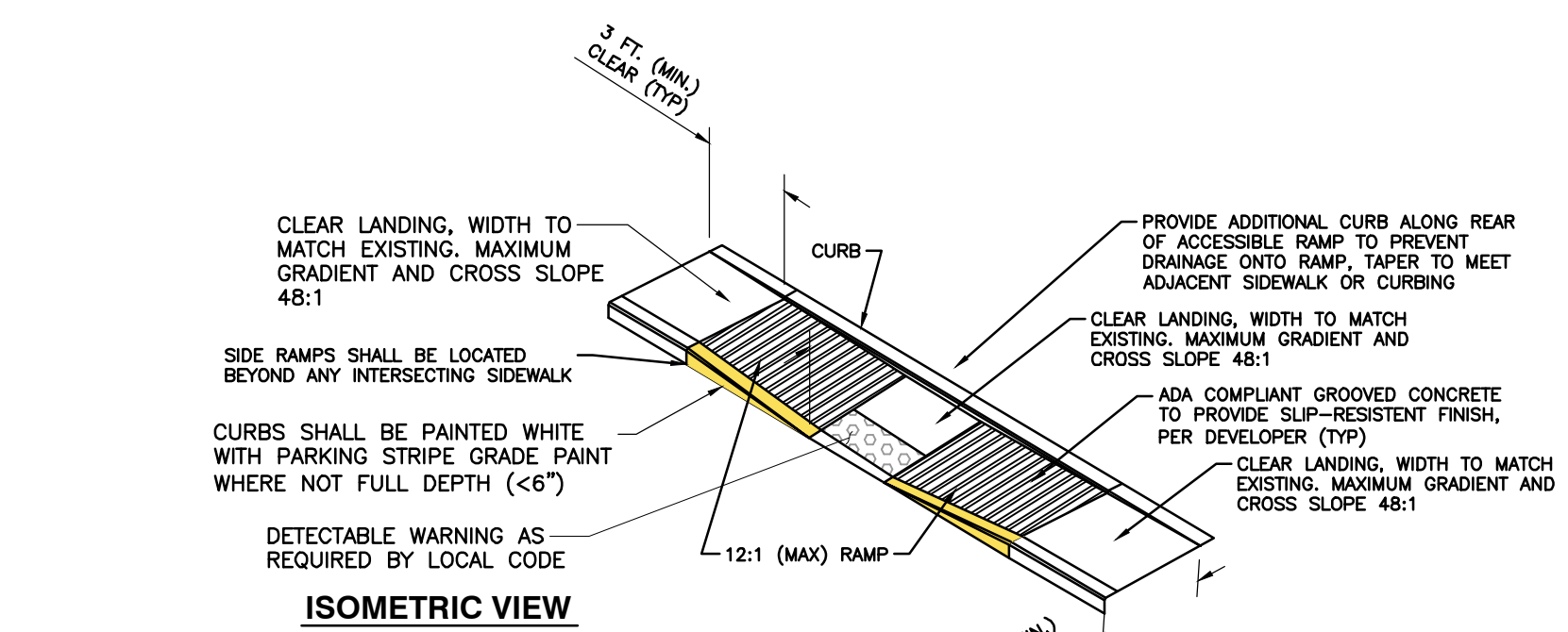

ISOMETRIC VIEW

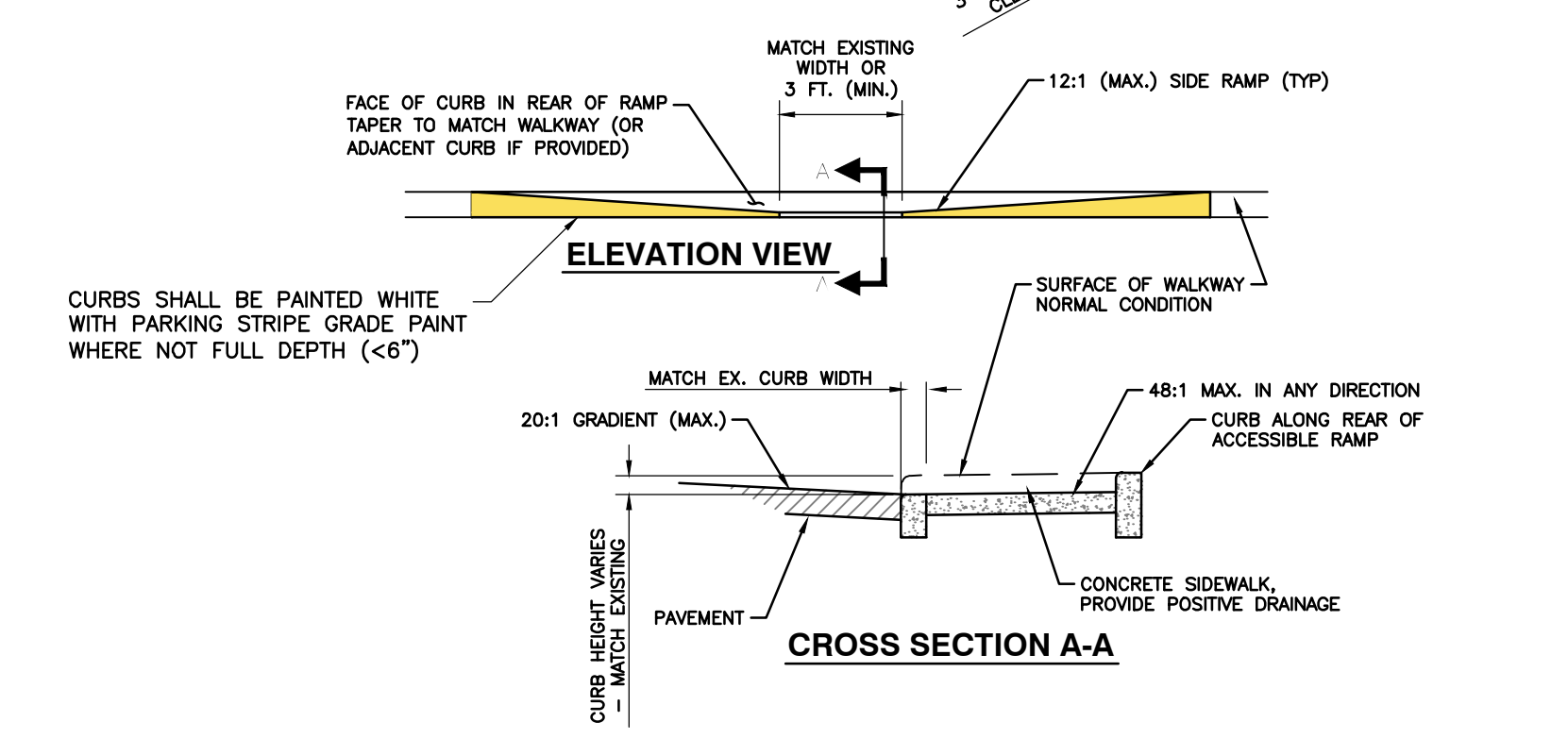

CROSS SECTION A-A

NOTES:
 1. ACCESSIBLE SPACE / LOADING AREA: MAXIMUM 48:1 SLOPE IN ANY DIRECTION.
 2. RAMP & PAVEMENT TRANSITION TO BE COMPLETELY FLUSH, NO LIP.
 3. WHEN RAMP OCCURS ON RADI, MINIMUM CLEAR LANDING WIDTH MUST BE MAINTAINED ON SHORTEST SIDE ALONG CURVE.
 4. CONSTRUCT PER A.D.A. & LOCAL STANDARDS.

**DETAIL #06
 ADA DEPRESSED CURB ACCESSIBLE RAMP**
 N.T.S.

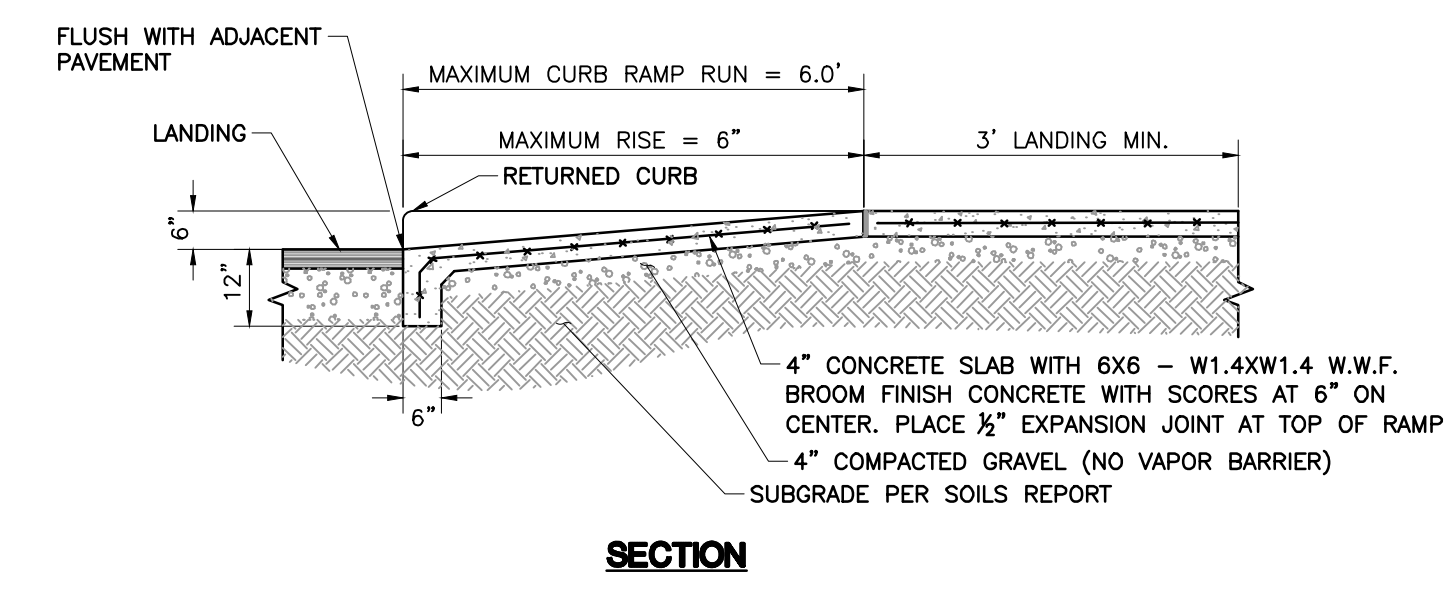

SECTION

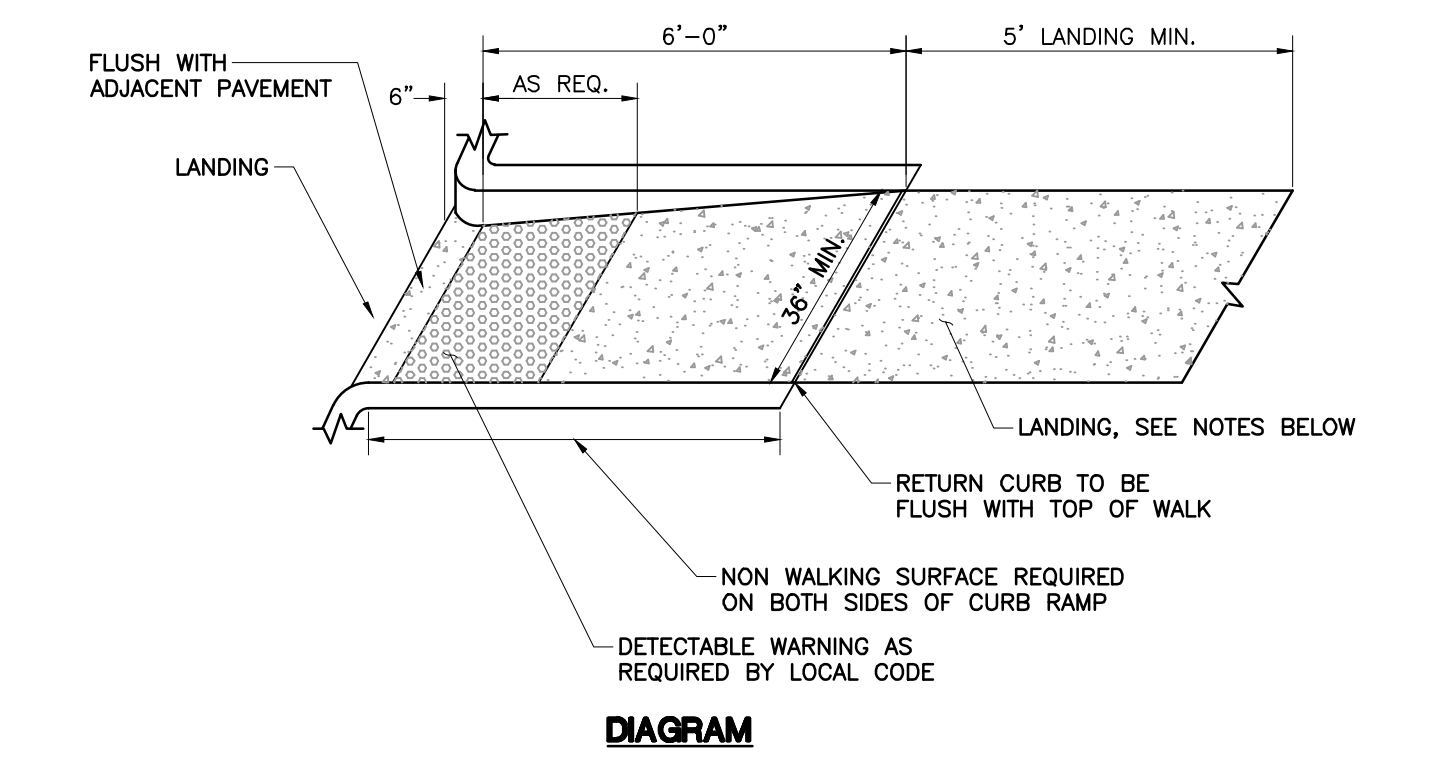

DIAGRAM

NOTES:
 1. LANDINGS SHALL BE LEVEL (LESS THAN 2% SLOPE IN ALL DIRECTIONS) AND PROVIDED AT THE TOP AND BOTTOM OF ALL ACCESSIBLE RAMPS.
 2. LANDING CLEAR WIDTH SHALL BE AT LEAST AS WIDE AS THE WIDEST RAMP RUN LEADING TO THE LANDING.
 3. LANDING CLEAR LENGTH SHALL BE 5' LONG MINIMUM.
 4. LANDINGS THAT REQUIRE A CHANGE IN DIRECTION BETWEEN RAMP RUNS SHALL HAVE A CLEAR LANDING 60" MINIMUM BY 60" MINIMUM.

**DETAIL #07
 ACCESSIBLE CURB RAMP**
 N.T.S.

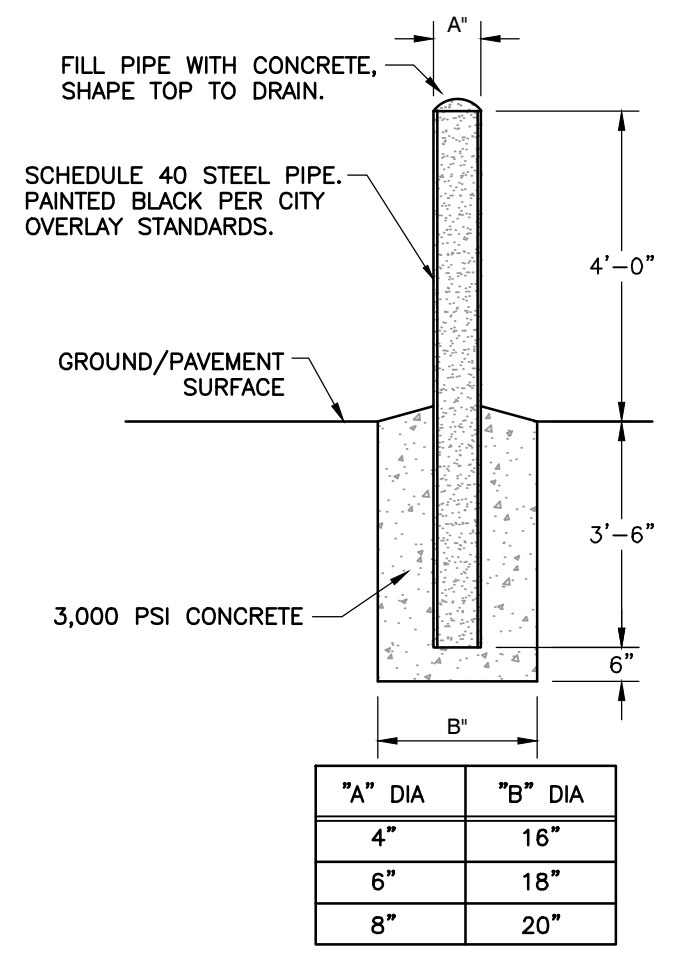

**DETAIL #08
 PIPE BOLLARD**
 N.T.S.

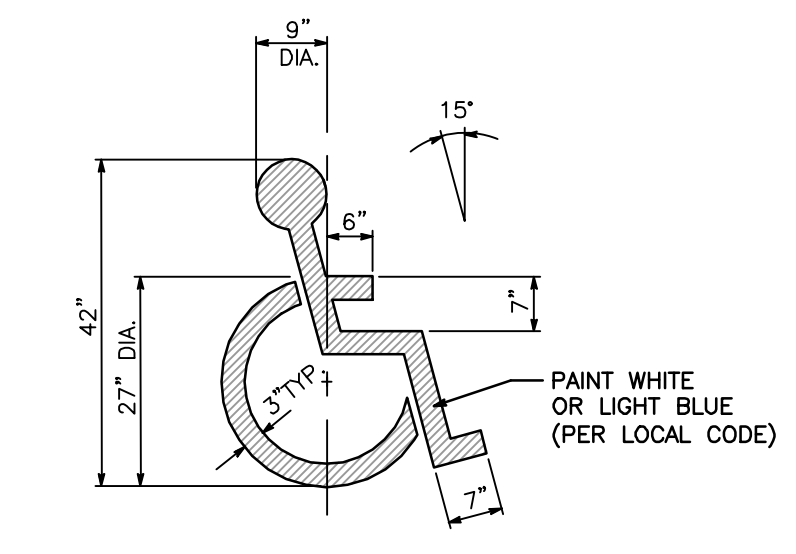

**DETAIL #09
 ACCESSIBLE PARKING SYMBOL**
 N.T.S.

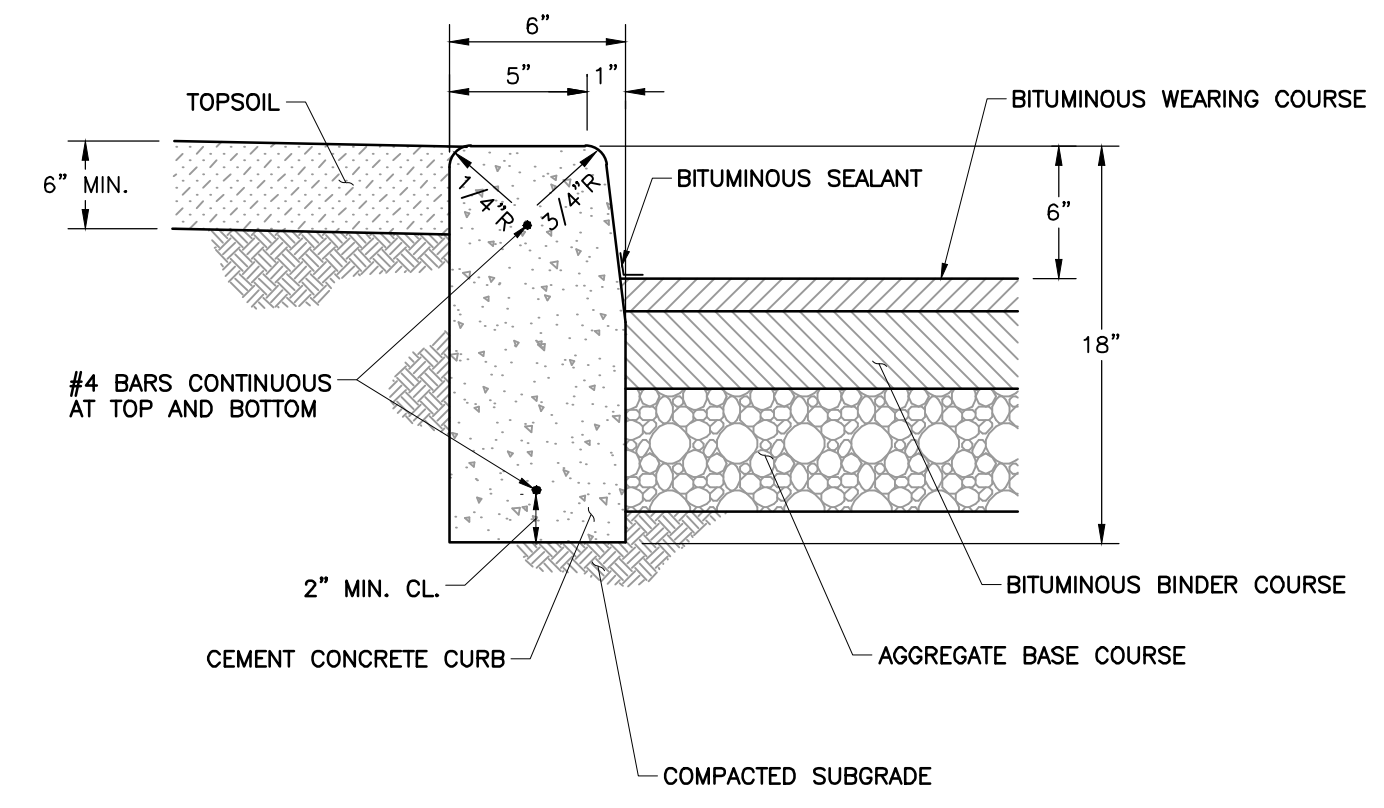

**DETAIL #10
 VERTICAL CONCRETE CURB**
 N.T.S.

**McDONALD'S
 CONSTRUCTION PLAN**
 A TRACT OF LAND BEING LOT 4 OF 'BRYAN ROAD COMMERCIAL, PLAT 1' RECORDED AS DOCUMENT 2023P-038185 IN THE ST CHARLES COUNTY RECORDS, BEING IN THE SOUTHWEST QUARTER OF FRACTIONAL SECTION 30, TOWNSHIP 47 NORTH, RANGE 3 EAST OF THE FIFTH PRINCIPAL MERIDIAN, CITY OF O'FALLON, ST. CHARLES COUNTY, MISSOURI

**Civil & Environmental
 Consultants, Inc.**
 3000 Little Hills Expressway, Suite 102
 St. Charles, MO 63301
 314-656-4566 · 866-250-3679
 www.cecinc.com

PATRICK T. BENNETT
 PROFESSIONAL ENGINEER
 LICENSE NUMBER: 05/01/2024
 MISSOURI PROFESSIONAL ENGINEER

MLL	GAS	FTB	388-966
DRAWN BY:	CHECKED BY:	APPROVED BY:	PROJECT NO:

Developer / Owner Information
McDONALD'S RESTAURANT
 NSN 43008 (024-1305)
 962 BRYAN ROAD
 O'FALLON, MISSOURI

P+Z No. 24-00803
 Approval Date 04/08/2024
 Permit No.

Page No.
C800