

0 1"
SCALE: 1" = 30'



MEADOWOOD ESTATES II, LP
MEADOWOOD ESTATES - PHASE II
LOT 4 - MEADOWOOD ESTATES SUBDIVISION
O'FALLON, ST. CHARLES COUNTY, MISSOURI

10/5/2022



Kelly A. Lohsandt

KELLY A. LOHSANDT
PROFESSIONAL ENGINEER
PE-2021032813

IF ORIGINAL SIGNATURE OR DIGITAL AUTHENTICATION IS NOT PRESENT THIS MEDIA SHOULD NOT BE CONSIDERED A CERTIFIED DOCUMENT.

Date

OCTOBER 5, 2022

Revised

Design: KAL Drawn: CGH

TEMPORARY TRAFFIC CONTROL PLAN

Sheet

C2.04

ESS&S PROJECT NO. 15511



W20-1
"ROAD WORK AHEAD" SIGN
NOT TO SCALE



W4-2R
"RIGHT LANE ENDS" SIGN
NOT TO SCALE

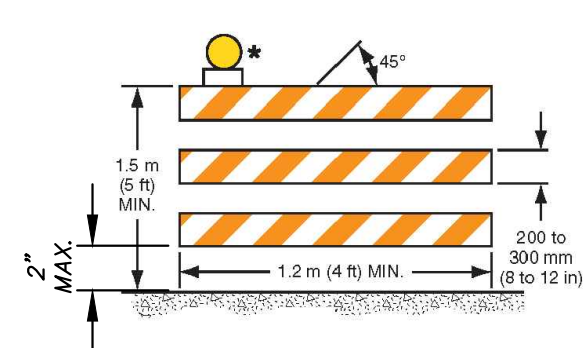

* WARNING LIGHTS (OPTIONAL)
** RAIL STRIPE WIDTHS SHALL BE 150 MM (6 IN.), EXCEPT THAT 100 MM (4 IN.) WIDE STRIPES MAY BE USED IF RAIL LENGTHS ARE LESS THAN 900 MM (36 IN.). THE SIDES OF BARRICADES FACING TRAFFIC SHALL HAVE RETROREFLECTIVE RAIL FACES.

TYPE 3 BARRICADE
NOT TO SCALE

LEGEND

- TYPE III BARRICADE W/ TYPE A WARNING LIGHTS
- TEMPORARY TRAFFIC CONTROL SIGN
- CHANNELIZER
- DIRECTION OF TRAVEL
- WORKSPACE

DESIGN DATA

TR HUGHES BOULEVARD SPEED LIMIT = 40 MPH

TEMPORARY TRAFFIC GENERAL NOTES

1. ALL TRAFFIC CONTROL DEVICES SHALL BE IN ACCORDANCE WITH THE MOST RECENT EDITION OF THE MANUAL ON UNIFORM TRAFFIC CONTROL DEVICES (MUTCD) AND ANY APPLICABLE SAFETY AND DESIGN CODES. ALL TEMPORARY TRAFFIC CONTROL PLANS SHALL BE IN ACCORDANCE WITH THE MOST RECENT EDITION OF THE MUTCD.
2. THE CONTRACTOR IS SOLELY RESPONSIBLE FOR JOB SITE, WORKER, AND TRAFFIC SAFETY.
3. CONTRACTOR MAY MODIFY THE TEMPORARY TRAFFIC CONTROL PLAN TO ACCOMMODATE THEIR CONSTRUCTION MEANS, METHODS, SEQUENCE, AND TECHNIQUES OR PROCEDURES. CONTRACTOR SHALL SUBMIT ALL PROPOSED MODIFICATIONS TO THE TEMPORARY TRAFFIC CONTROL PLAN TO THE CITY OF GREENSBORO FOR APPROVAL, IN WRITING, PRIOR TO IMPLEMENTATION.
4. CONTRACTOR SHALL DESIGNATE AN INDIVIDUAL AS THE WORK ZONE SPECIALIST (WZS) WHO IS KNOWLEDGEABLE, COMPETENT BY TRAINING AND/OR CERTIFICATION AND EXPERIENCE IN THE PRINCIPLES OF PROPER TEMPORARY TRAFFIC CONTROL IN ACCORDANCE WITH CHAPTER 6 OF THE MUTCD, AT THE PROJECT LEVEL WHO HAS THE PRIMARY RESPONSIBILITY, WITH SUFFICIENT AUTHORITY, FOR IMPLEMENTING THE TEMPORARY TRAFFIC CONTROL PLAN AND OTHER SAFETY AND MOBILITY ASPECTS OF THE PROJECT. CONTRACTOR SHALL SUBMIT PROOF THAT THEIR WZS HAS TRAINING IN WORK ZONE SAFETY.
5. CONTRACTOR SHALL MONITOR TRAFFIC FLOW THROUGH THE WORK ZONE AND MAKE ADJUSTMENTS TO THE TRAFFIC CONTROL PLAN, WITH THE APPROVAL OF THE AUTHORITY HAVING JURISDICTION, AS REQUIRED.
6. GRINDING TO REMOVE PAVEMENT MARKINGS ON PERMANENT PAVEMENT IS PROHIBITED.
7. PROVIDE PAVEMENT EDGE PROTECTION IN ACCORDANCE WITH MoDOT STANDARDS.

P:\GENERAL PROJECTS\15511-ES-MEADOWOOD-II-STEP\PLAN\CAD\15511_TTC_PLAN.DWG 10/19/2022