

REVISION NOTE:
 1. RAISED STORM SEWER UNIFORMLY WITH THE SITE GRADING 2 FEET, EXCEPT FOR CI 12, CI 5-FES 4, FES 140, CQS 2-EXISTING CURB INLET.

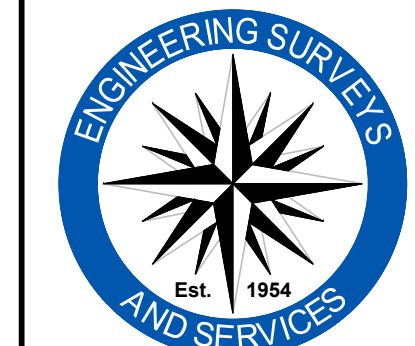

Engineering Surveys & Services
 Consulting Engineers, Land Surveyors, and Geoprosessionals
 Analytical and Material Laboratories
 1113 Ivy Street, Columbia, Missouri 65201
 573-449-2646 | www.ess-inc.com
 Other Offices:
 Jefferson City - Sedalia - Wildwood
 Missouri Engineering Corporation # 200400018

MEADOWOOD ESTATES - PHASE I
 LOT 1 - MEADOWOOD ESTATES SUBDIVISION
 OFALLON, ST. CHARLES COUNTY, MISSOURI

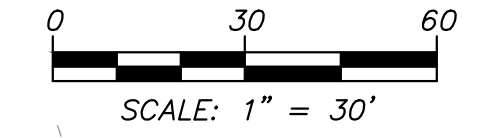
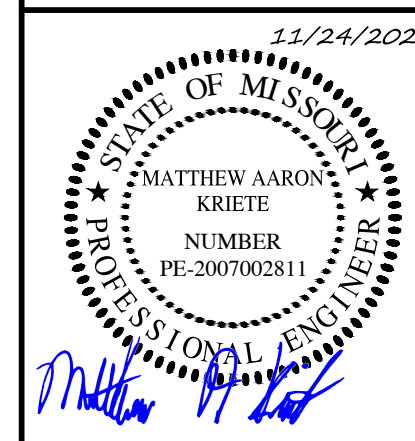

MATTHEW A. KRIETE
 PROFESSIONAL ENGINEER
 PE-2007002811

Date: **MAY 22, 2020**

Revised	
1	JULY 14, 2020 CITY COMMENTS
2	AUGUST 17, 2020 CITY COMMENTS
3	NOVEMBER 24, 2020 ESI #4

Design: KAH Drawn: MJS
STORM SEWER PLAN
 Sheet
C4.02
 ES&S PROJECT NO. 14480

OVER EXCAVATION NOTE
 OVER EXCAVATE DETENTION BASIN BY 5 FEET. REMOVE CUT AND REPLACE WITH TOPSOIL IN LIFTS LESS THAN 8 INCHES. COMPACT ACCORDING TO GEOTECH REPORT. CUT FROM BASIN TO BE DEPOSITED WITH OTHER CUT GENERATED FROM THE SITE.

PLANNING & ZONING #20-002498 APPROVED MAY 7, 2020