

- REVISION NOTE:
- ADDED CONCRETE SIDEWALK SLOPE PERCENTAGES.
 - REVISED SPOT ELEVATIONS WITH SITE GRADING.

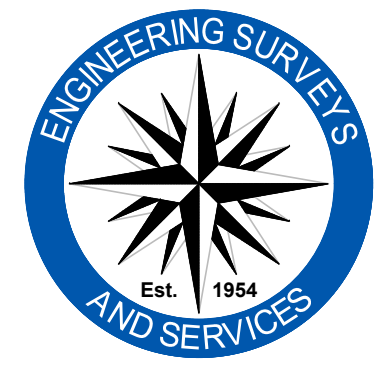

Engineering Surveys & Services
 Consulting Engineers, Land Surveyors, and Geoprosessionals
 Analytical and Material Laboratories
 1113 Ivy Street, Columbia, Missouri 65201
 573-449-2646 | www.ess-inc.com
 Other Offices:
 Jefferson City - Sedalia - Wildwood
 Missouri Engineering Corporation #200400018

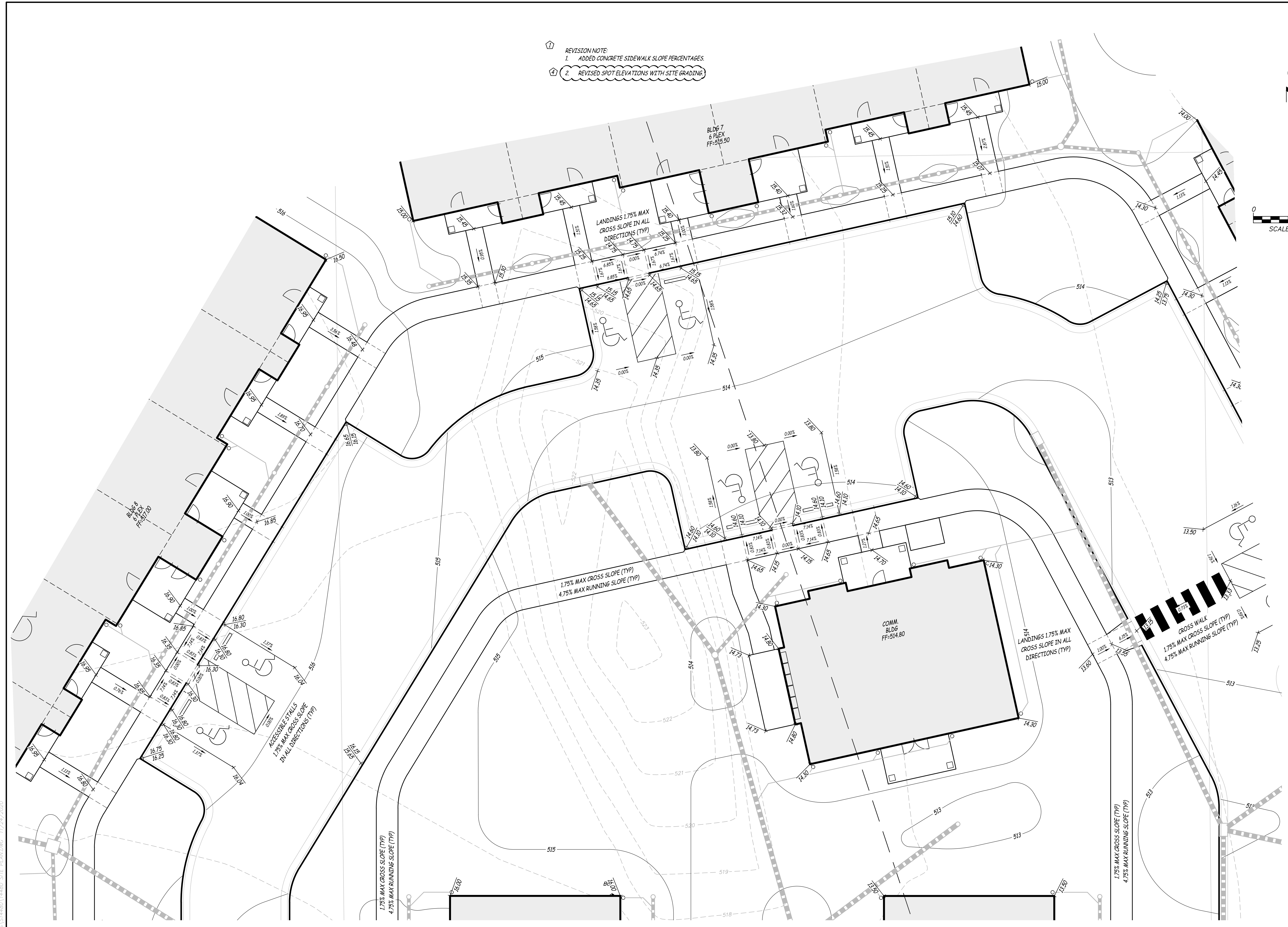
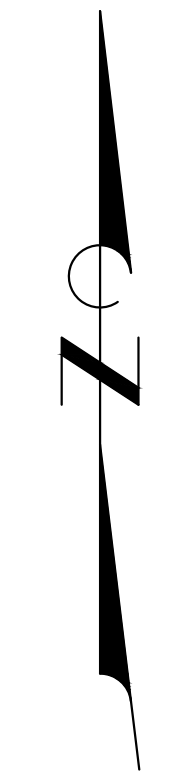
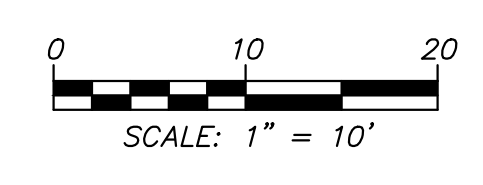

MEADOWOOD ESTATES - PHASE I
 LOT 1 - MEADOWOOD ESTATES SUBDIVISION
 OF FALLON, ST. CHARLES COUNTY, MISSOURI

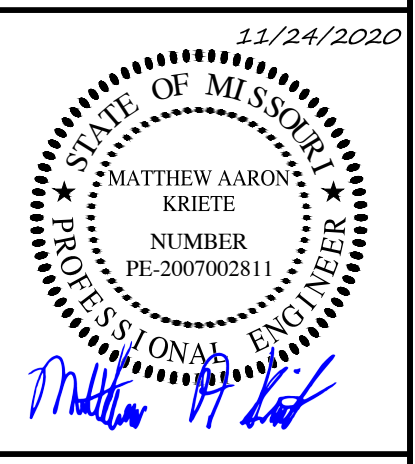

MATTHEW A. KRIETE
 PROFESSIONAL ENGINEER
 PE-2007002811

IF ORIGINAL SIGNATURE OR DIGITAL AUTHENTICATION IS NOT PRESENT THIS MEDIA SHOULD NOT BE CONSIDERED A CERTIFIED DOCUMENT.

Date
MAY 22, 2020

Revised	JULY 14, 2020
CITY COMMENTS	
NOVEMBER 24, 2020	
ESI #4	

Design: KAH Draw: MJS

ACCESSIBILITY PLAN

Sheet

C8.04

X:\CURRENTDRAWINGS\14480 SITE PLAN.DWG 11/24/2020